

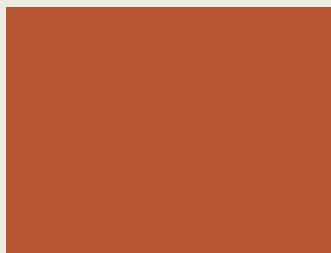

Replacing Your Café Knobs & Handles



Instrucciones En Español | Instructions En Français:
www.cafeappliances.com/kit-instructions

Instructions for Replacing Appliance Handles

IMPORTANT!

- The handle on your appliance may have a different orientation than what is shown, but the installation will be the same.
- Be extra careful of the appliance finish around the handle area, as it can scratch. During removal of the handle screws, hold onto the handle tightly so it won't fall and scratch the appliance. We recommend having another person help you hold the handle in place as you remove the screws.
- When the handle has been removed, check the fasteners that are attached to the appliance front to see if they are loose. If so, tighten them with a 3/16" Allen wrench before attaching the new handle. Note: Fastener shape may vary by appliance.
- For appliances with multiple handles, look at your current configuration before removing the handles, and make sure the replacement handles match that logo and set screw position.

Tools You Will Need:



1/8" Allen Wrench
(included with handle)



3/16" Allen Wrench
(not included)

I. Removing the Handle

1. Locate the set screws on the handle caps (they are usually on the less visible side).
2. Loosen the set screw on one end with the 1/8" Allen wrench while supporting the handle. Do not remove the set screw from the handle cap.
3. Keep supporting the handle while you loosen the set screw on the other handle cap. Lift the handle from the fasteners on the door and set aside.

II. Replacing a New Handle

1. Make sure the set screws are loosened. Place the handle over the fasteners of the door (we recommend putting the screw side of the handle toward the less visible side). Take care to support the handle so it doesn't fall and scratch the appliance finish. Make sure both the handle caps are resting on the face of the door.
2. Lock one end of the handle into position by tightening the set screw in the handle cap with the 1/8" Allen wrench. Be sure not to over tighten.
3. Keep supporting the handle as you lock the other end of the handle into position by tightening the set screw in the handle cap with the 1/8" Allen wrench. Be sure not to over tighten.

Repeat these instructions on all other handles.

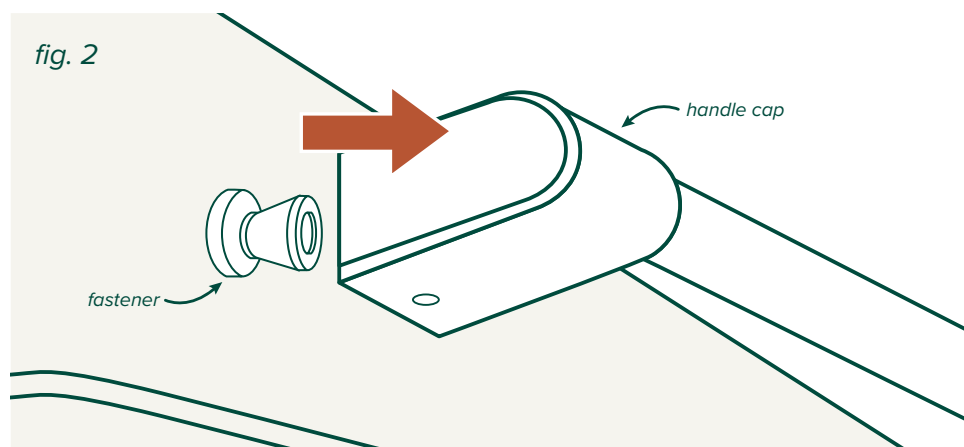
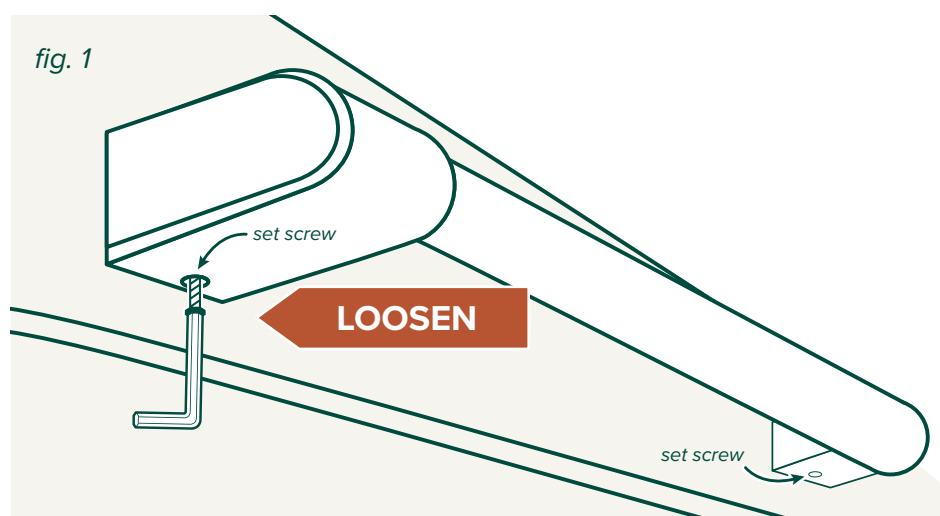

Instructions for Replacing Knobs with Bezels with Keyhole Center

IMPORTANT!

- Turn off power to your appliance before you remove or replace the knobs.
- Work with one knob at a time to ensure you don't mix up replacement pieces.
- Make sure you check the writing on each of your knobs (and/or bezels) and set them out in the order you will replace them. This will help ensure you don't put them on in the wrong order.

Tools You Will Need:



Phillips Head Screwdriver

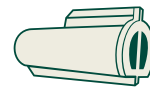

Bezel Alignment Tool
(provided with your knobs if necessary)

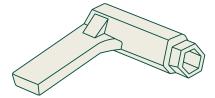

1/4" Hex Tool
(provided with your knobs if necessary)

fig. 1

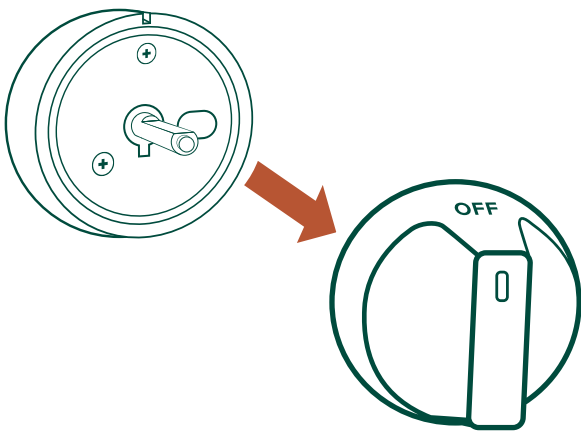

I. Removing the Current Knob

1. Make sure all knobs are in the OFF position.
2. Choose which knob you will work with first.
3. Remove the knob by grasping the sides and pulling away from the appliance until the knob is free from its shaft. You may have to wiggle it slightly as you pull (fig. 1).
4. Identify the bezel attachment screws from the bezel image (fig. 2).
5. If your knobs included a 1/4" Hex tool, you will use it to remove the two bezel attachment screws. Otherwise, use a Phillips head screwdriver to remove the two bezel attachment screws. Only remove the two bezel attachment screws. Do NOT remove any other visible screws.
6. You should be able to remove the bezel from the appliance front after the screws have been removed.

fig. 2

Your bezel will resemble one of these two configurations.
Remove only the screws indicated.

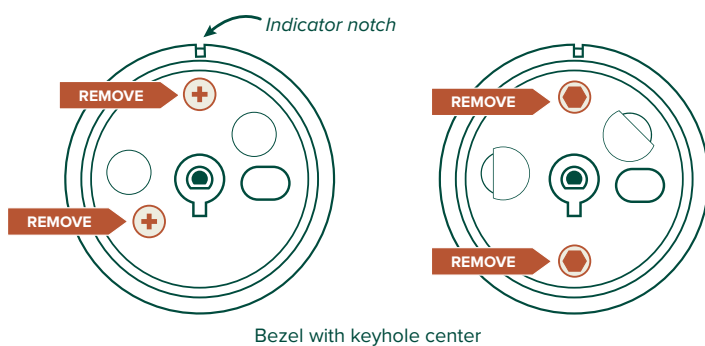

II. Installing the Replacement Knob and Bezel

1. Install the bezel first by positioning it around the shaft with the indicator notch at the top.
2. Position the bezel alignment tool over the shaft. Make sure the flat side of the tool is toward the bottom, matching the flat side of the shaft.
3. Press the bezel alignment tool onto the shaft until it is snug. (fig. 3)
4. Screw in the bezel attachment screws to hold the bezel in place.
5. Remove the bezel alignment tool.
6. Match the replacement knob with the knob you've removed—make sure they have the same writing and markings.
7. Hold the replacement knob so that OFF is at the top and it lines up properly with the shaft (fig. 4).
8. Push the knob onto the shaft as far as possible so it fits snugly.

Repeat the above removal and installation steps for each knob until they have all been removed and replaced.

fig. 3

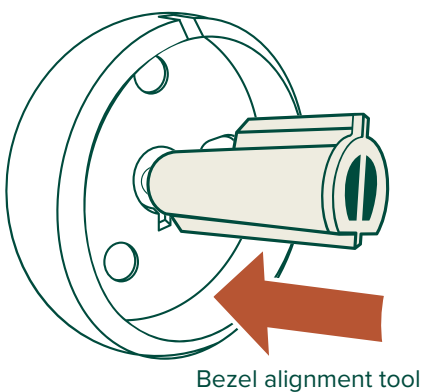

fig. 4

