



Snap to Vent

Quick
and
Easy
Install



Step 1

Disconnect snap connector from 90° or straight body.

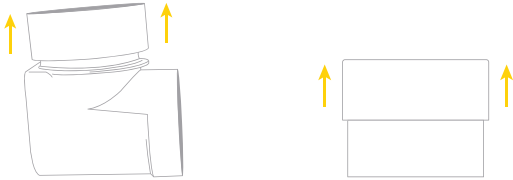

Step 2

Remove hose from package. Extend the hose at the ends all the way.

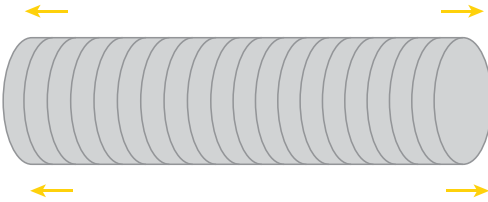

Step 3

Extend plastic fingers on snap connector towards center. Place hose in snap connector so that the fingers will collapse inside the hose. Take snap connector and hose together and press into the body (90° or straight) until you hear a click.

*Tip: Use both hands and grip it until it clicks.

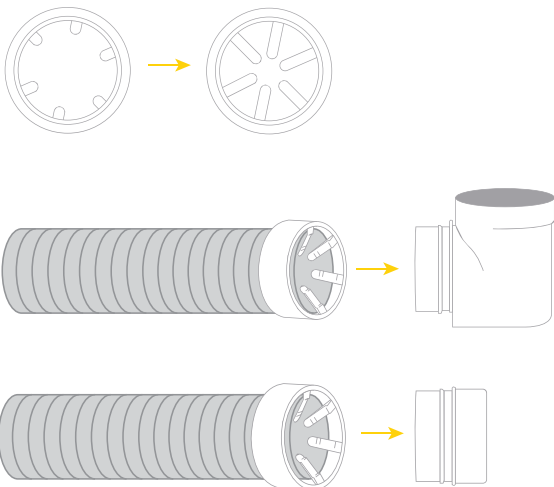

You should hear a click to confirm it is securely attached.

Step 4

Take clear seal ring and stretch it over your dryer vent exhaust or your wall vent.

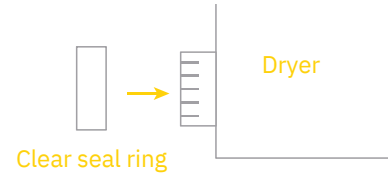

Step 5

Press connected Snap to Vent and hose assembly onto seal located on dryer vent exhaust or wall vent.

* Tip: Press evenly and as tightly as possible to get a secure connection.

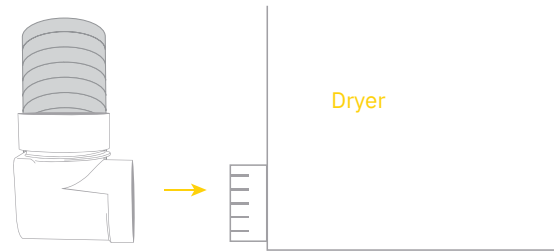

Step 6

Push dryer to wall until 90 degree elbow touches wall.

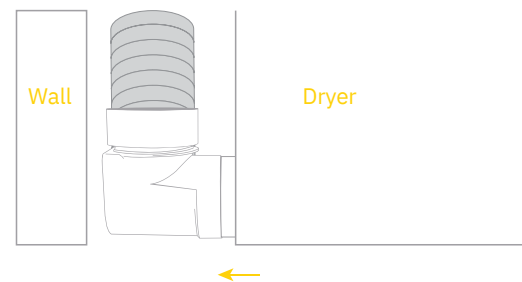

Dryer Vent Maintenance

It's recommended to clean your dryer vent at least once per year. Depending on how often you use your dryer, you may want to consider cleaning more. Snap to Vent makes this an easy process.

Thank you for purchasing Snap to Vent!

If you like this product we would love to have your support in building our small business by giving us a product review. Thank you!

For more information visit www.zigguratproducts.com
or e-mail us at support@zigguratproducts.com