

BEFORE YOU BEGIN



Scan for easy 3D instructions

Download the BILT app before you begin



ASSEMBLY REQUIRES AT LEAST 2 ADULTS. PLEASE FOLLOW THE STEP BY STEP GUIDE AND ENJOY YOUR IMMORTAL WEREWOLF!

IF ANY PART IS MISSING OR BROKEN, DO NOT ATTEMPT TO ASSEMBLE THE PRODUCT AND CONTACT SVI CUSTOMER SERVICE FROM 8:30AM TO 5:30PM PST AT 1-855-428-3921, EMAIL CUSTOMERSERVICE@SVIUS.COM, OR CALL HOME ACCENTS HOLIDAY CUSTOMER SERVICE FROM MON-FRI 8:00AM TO 7:00PM AND SAT 9:00 AM TO 6:00 PM EST AT 1-855-HDHOLIDAY (1-855-434-6543).

EASY ASSEMBLY AND OPERATION INSTRUCTIONS

22SV23409_Immortal Werewolf

READ AND SAVE THESE INSTRUCTIONS FOR FUTURE REFERENCE

IMPORTANT TIPS:

- Ensure that the item's adapter is plugged in at the Function Control Box and in the wall.
- Ensure that the switch on the function control box is on the desired setting.
- If not functioning properly (ex: Mouth doesn't move, eyes don't light up), ensure that cables are connected to their corresponding cable as shown in the instruction sheet.
- Be sure nothing is blocking movement or caught in moving parts.
- Ensure that the floor or surface that the item sits on is flat and level.
- Ensure that the volume is not all the way down.
- Be sure nothing is blocking the sensor.
- If the item still does not work, contact SVI Customer Service from 8:30am to 5:30pm PST at 1-855-428-3921, email customerservice@svius.com, or call Home Accents Holiday Customer Service from Mon-Fri 8:00am to 7:00pm and Sat 9:00 am To 6:00 pm EST at 1-855-HDHOLIDAY (1-855-434-6543).

PARTS LIST

- A. Base x 1
 - B. Right Foot x 1
 - C. Left Foot x 1
 - D. Right Lower Support Pole x 1
 - E. Left Lower Support Pole x 1
 - F. Lower Right Leg x 1
 - G. Lower Left Leg x 1
 - H. Right Calf x 1
 - I. Left Calf x 1
 - J. Right Upper Support Pole (Short) x 1
 - K. Left Upper Support Pole (Long) x 1
 - L. Right Thigh x 1
 - M. Left Thigh x 1
 - N. Lower Torso Frame x 1
 - O. Torso x 1
 - P. Left Arm x 1
 - Q. Shirt x 1
 - R. Right Arm x 1
 - S. Head x 1
 - T. Head Cap x 1
 - U. Base Extensions x 4
 - V. Left Hand x 1
 - W. Right Hand x 1
 - X. Left Rear Cap x 1
 - Y. Right Rear Cap x 1
 - Z. Pants x 1
 - Z1. Loop Screw x 1
 - Z2. Tether Cable x 1
 - Z3. Stakes x 4
 - Z4. Allen Wrench x 1
 - Z5. Adapter x 1
- * Power Adapter Spec
Input: 120VAC 50/60Hz
Output: 5.9V 2.0A

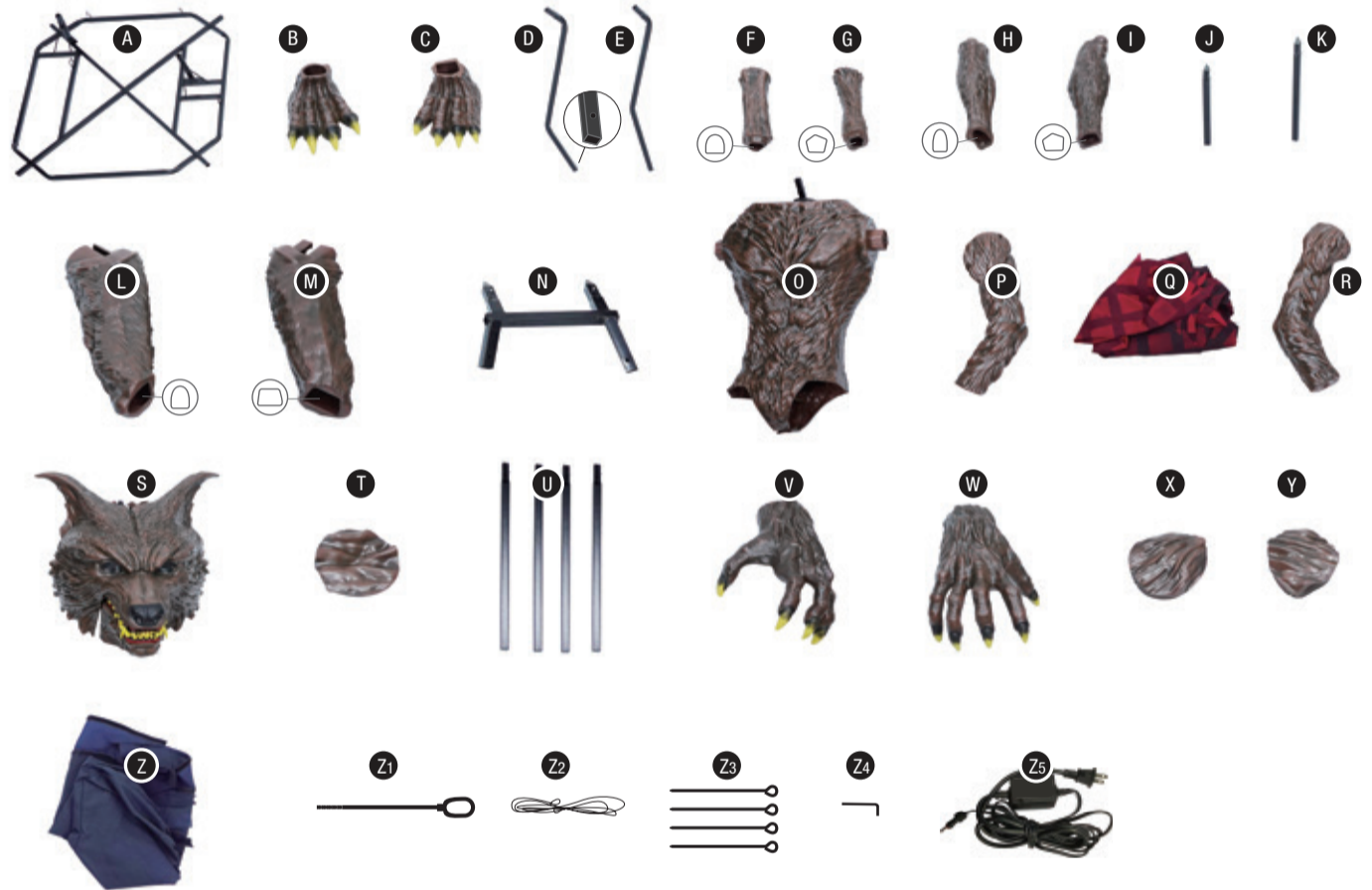

NOTE: Throughout the instructions, Right and Left are from the character's point of view. The notches in the (B, C) Feet need to be positioned over the (A) Base protrusions as shown.

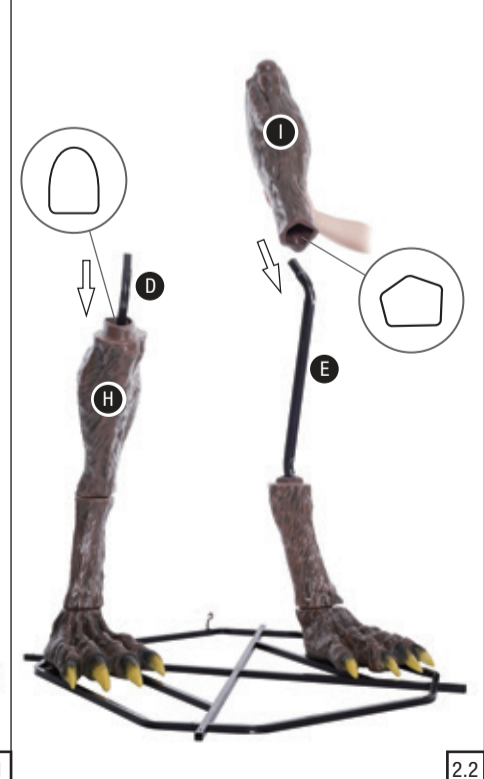
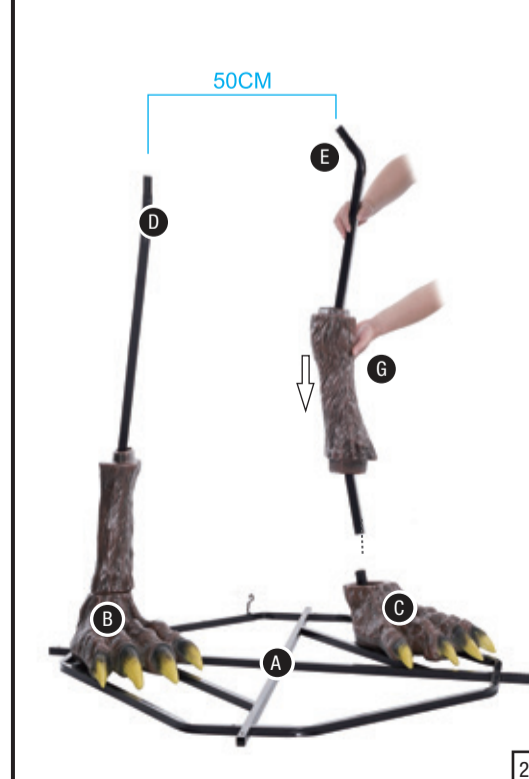
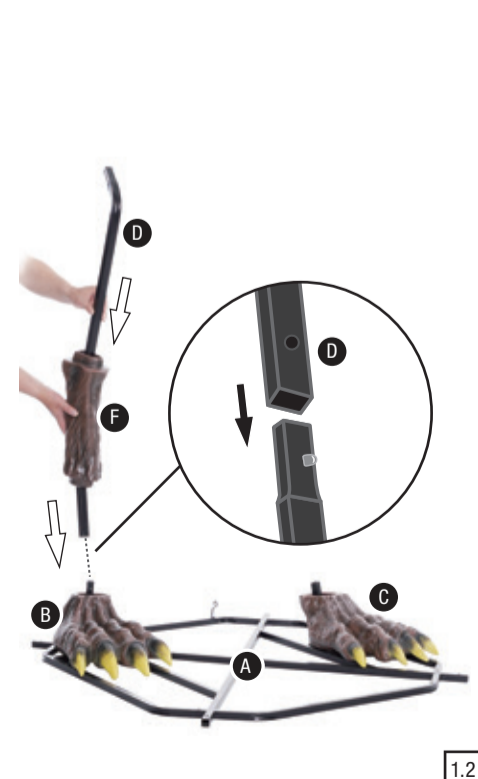
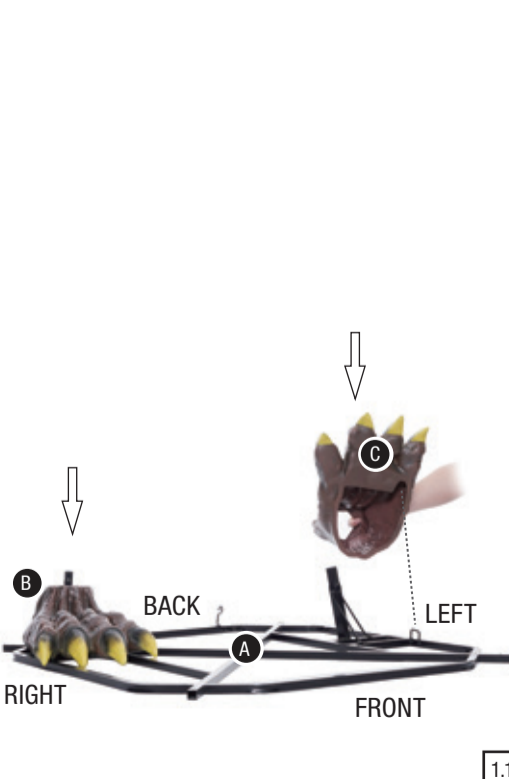
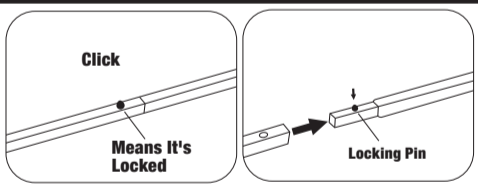

If there is difficulty in assembling the (N), try adjusting the upper legs until they are properly aligned.

NOTE: Slide the two (L, M) Thighs onto the (J, K) Upper Support Poles and then fit them onto the (H, I) Calves as shown.

3.1

3.2

3.3

NOTE: Lean the Immortal Werewolf against the box it came with for easier assembly. 2 adults are strongly recommended for this step.

4.1

Note: If there is difficulty attaching the (O) Torso to the (N) Lower Torso, try lifting the parts and adjusting the angle while connecting.

4.2

Note: Do NOT overtighten this bolt. Overtightening may result in damage to the product. Adjust the arm position to your preference. If a bolt is missing, check inside the box as it may have fallen out of the arm.

Note: Slip the left sleeve of the (Q) Shirt over the (P) Left arm.

Note: Make sure the screw hole at the top is aligned with the indent on the shoulder connector.

Note: Slip the right sleeve of the (Q) Shirt over the (R) Right Arm before connecting to the (O) Torso. Make sure the screw hole at the top is aligned with the indent on the shoulder connector.

5.1

5.2

5.3

5.4

6.1

Cable pairs are color-coded to ensure proper color-matching connections.

6.2

NOTE: It is strongly recommended that 2 adults assist with erecting the Immortal Werewolf.

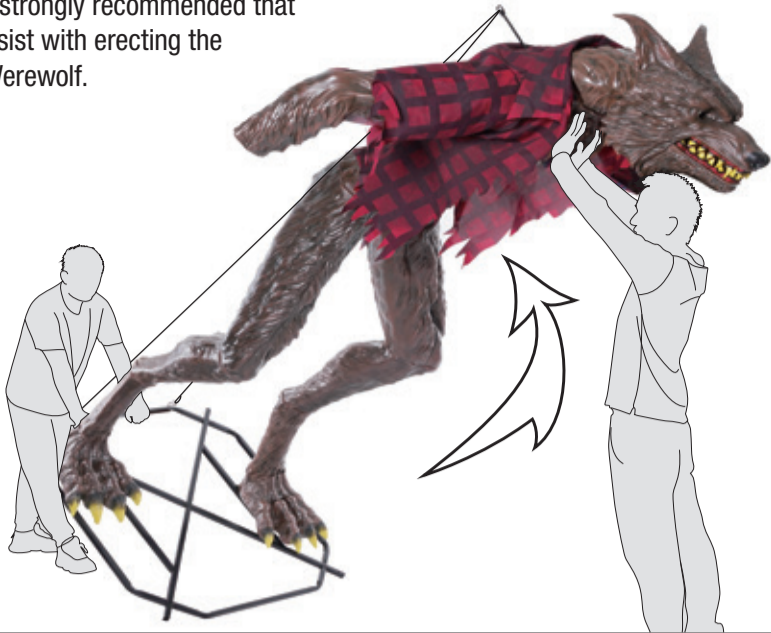

7.1



8.1

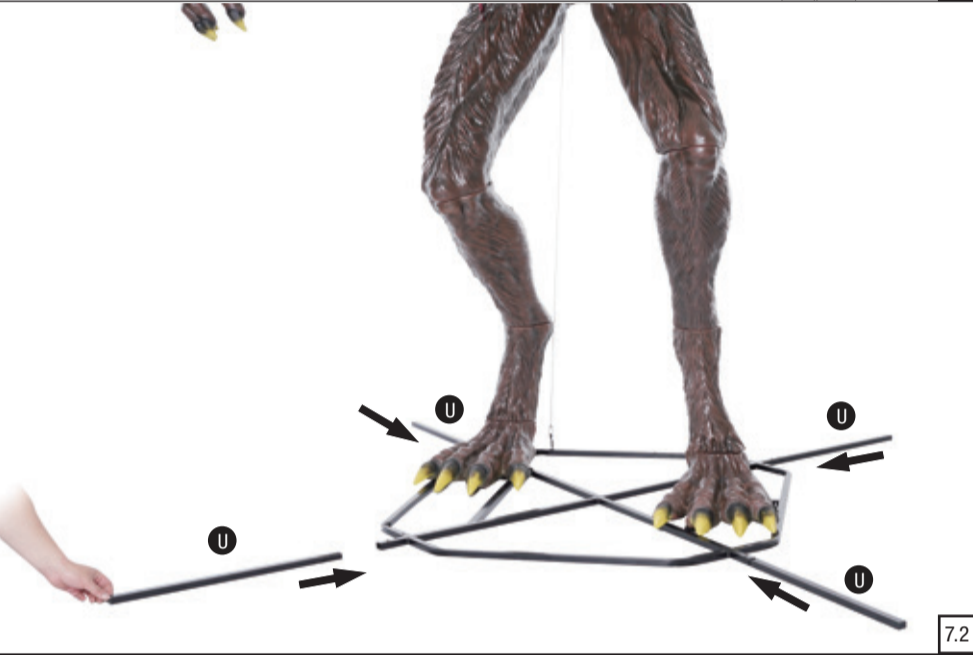

7.2

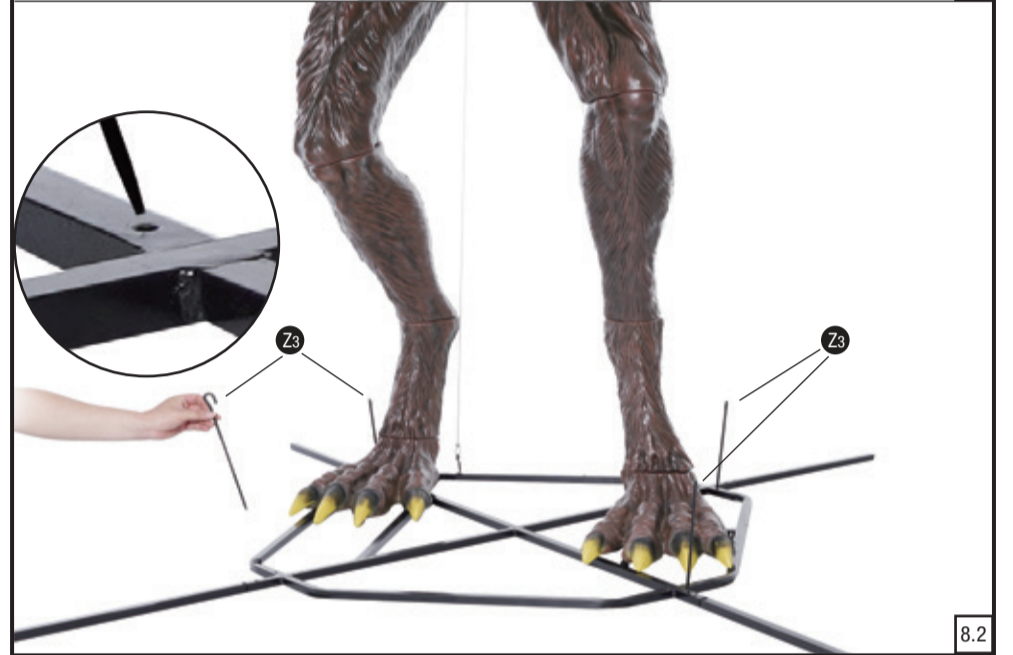

8.2

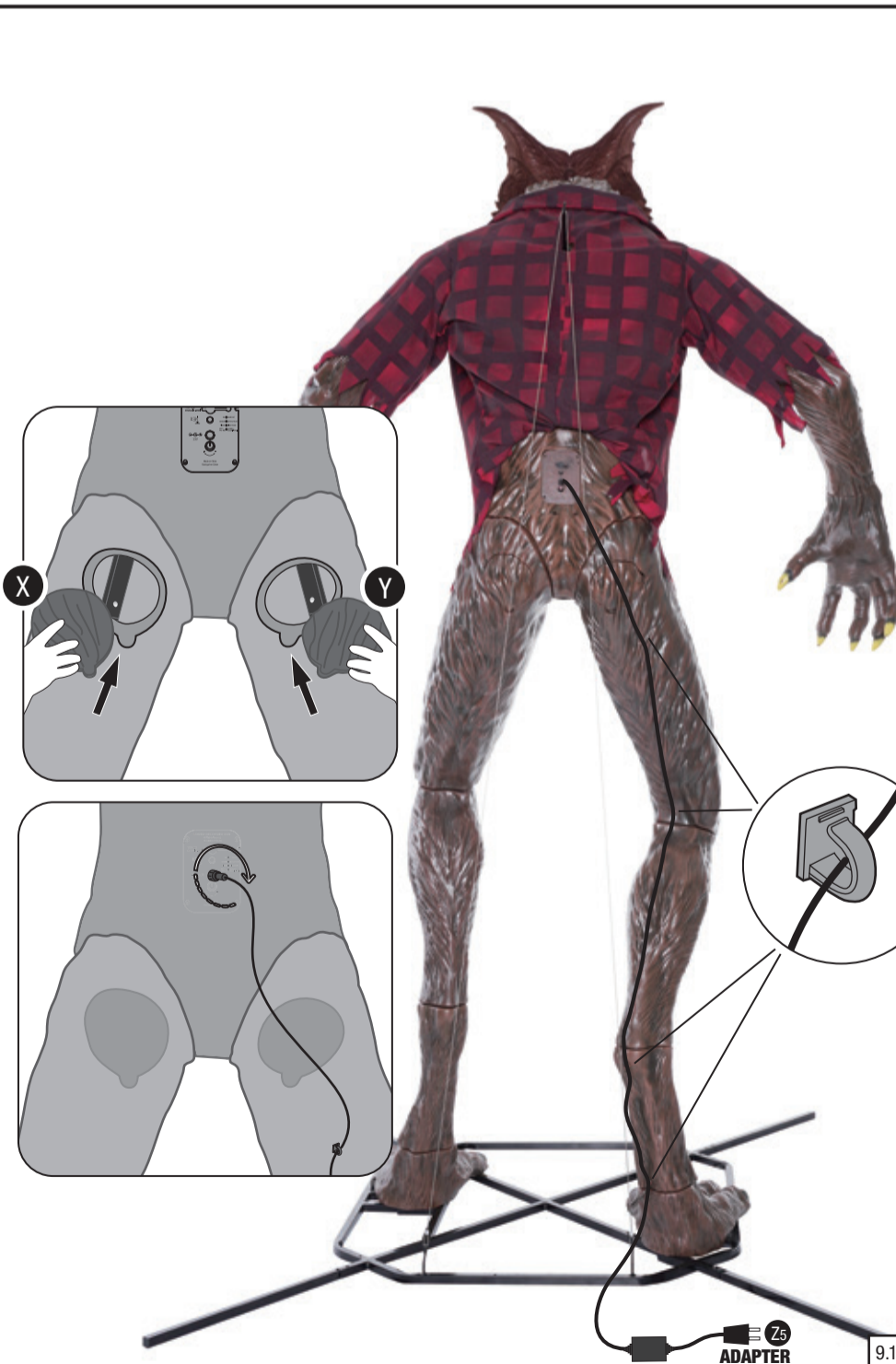

9.1



10.1



IR SENSOR
Be sure nothing is blocking the sensor.

YOUR IMMORTAL WEREWOLF IS NOW FULLY ASSEMBLED. PLUG IN AND TURN ON TO LET THE FUN BEGIN!

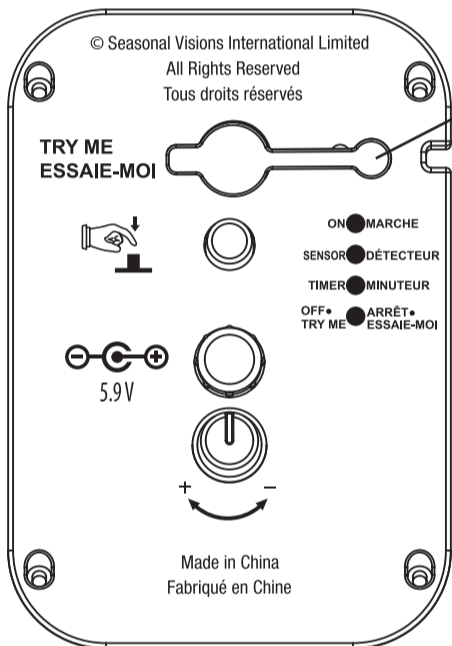

NOTE: Make sure the waterproof cap is covering the Try Me receiver at all times when not in use.

OPERATION INSTRUCTIONS:

The Immortal Werewolf is powered by an adapter. Plug in the power adapter into a standard power outlet. To turn on the Immortal Werewolf and cycle through the settings, press the button on the Function Control Box.

- Press button once for constant ON.
- Press button twice for Sensor setting.
- Press button three times for Timer Setting.
- Press button four times to turn OFF.

WARNING:

- Lay product down before a storm or strong winds.
- Don't climb or pull on product.
- Don't add to or modify product.
- Assemble and place the product on level surfaces only.
- Don't push or tilt product.

WARNING

This item is not a toy and should be used for decoration only. This item contains small parts that can be a choking hazard. Keep all plastic and wire parts away from children.

1. Please use the adapter supplied by manufacturer.
2. Please assemble item according to instructions. Connect all wires according to matching color.
3. Children should be supervised by adults. Item should not be grabbed, as it becomes a tipping hazard. Keep flammables away from the adapter, as it heats up during operation.

Please view all instructions carefully before assembling. Save this instruction sheet for future reference.

CARE AND STORAGE INSTRUCTIONS

When not in use, store this product in its original packing. Keep away from heat and moisture.

The item is activated by pressing the button on the bottom and has the following settings:

ON/MARCHE	This setting will activate the color changing lights of the item.
SENSOR / DÉTECTEUR	This switch mode will activate lights, sound, and animation when the Infra-red (IR) sensor is activated and will operate for 1 audio-cycle with each activation. The Infra-red (IR) sensor has a range of up to 2 m/6.5 ft. and will activate when someone comes within an 80-degree angle from left-to-right, as well as from above and below.
TIMER / MINUTEUR	This setting will operate the same as sensor mode within a 6HR On/18 HR Off period.
OFF • TRY ME / ARRÊT • ESSAIE-MOI	This setting will deactivate the lights, sound, and animation of the item. This mode also allows the item to be activated if triggered by using a Step Here Try Me Activation Pad (Not Included). The item will operate for one audio cycle with each Try Me activation.
	Raise or lower the volume using the volume control turn dial, turn all the way down to turn the volume off .

This device complies with Part 15 of the FCC Rules. Operation is subject to the following two conditions: (1) This device may not cause harmful interference, and (2) this device must accept any interference received, including interference that may cause undesired operation.

CAUTION: Changes or modifications not expressly approved by the party responsible for compliance could void the user's authority to operate the equipment.

NOTE: This equipment has been tested and found to comply with the limits for a Class B digital device, pursuant to Part 15 of the FCC Rules. These limits are designed to provide reasonable protection against harmful interference in a residential installation. This equipment generates, uses, and can radiate radio frequency energy and, if not installed and used in accordance with the instructions, may cause harmful interference to radio communications. However, there is no guarantee that interference will not occur in a particular installation. If this equipment does cause harmful interference to radio or television reception, which can be determined by turning the equipment off and on, the user is encouraged to try to correct the interference by one or more of the following measures: Reorient or relocate the receiving antenna, Increase the separation between the equipment and receiver. Connect the equipment into an outlet on a circuit different from that to which the receiver is connected. Consult the dealer or experienced radio/TV technician for help.
CAN ICES-003(B)/NMB-003(B)

