

QUICK START REFERENCE GUIDE

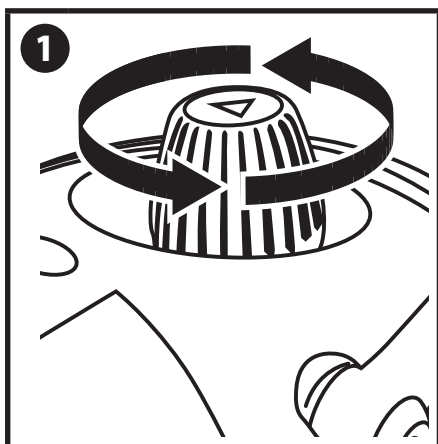

This is only a quick reference. Read the entire instruction manual prior to using the product.
Read all warnings and safety instructions in the instruction manual before use.



Unscrew the safety cap by turning counter clockwise.

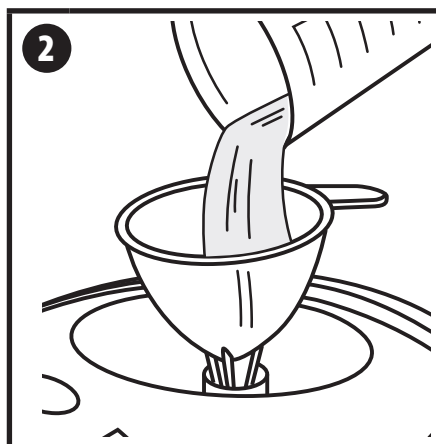

Fill the tank using the funnel provided. The tank holds up to 40 oz. /1200ml of water. DO NOT overfill the water tank or damage to the product may occur.



Only use distilled water, mineral build-up from tap water can shorten the life of the steamer.

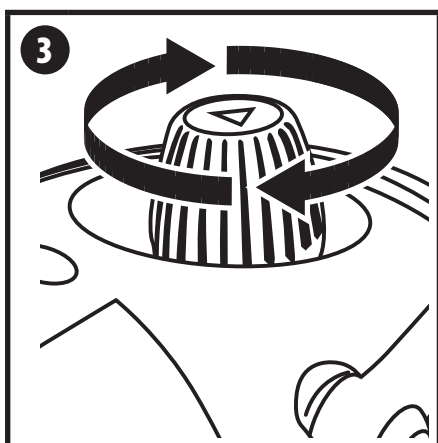

Once full replace the safety cap by turning clockwise, fasten tightly.

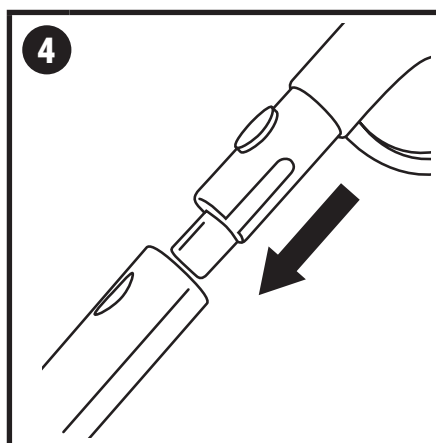

Attach the necessary cleaning adaptor and accessory to the steam gun nozzle.

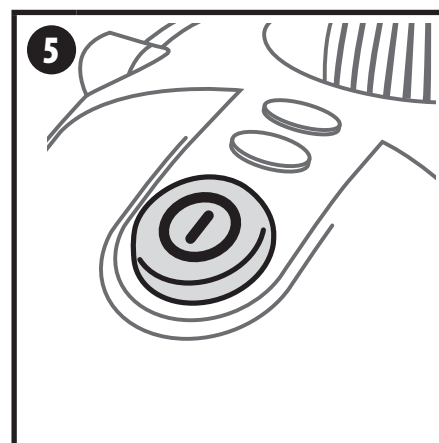

Plug the machine into the outlet and press the ON/OFF button to ON.

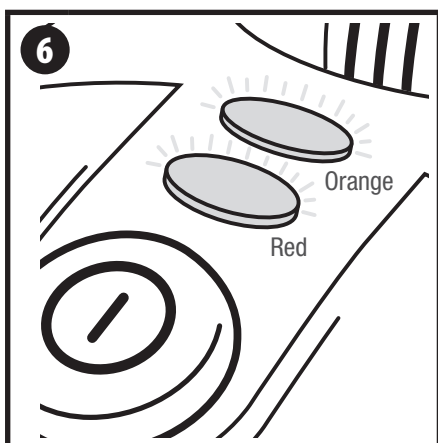

The Red power light and Orange steam light, indicating that the machine is building steam, should both illuminate.

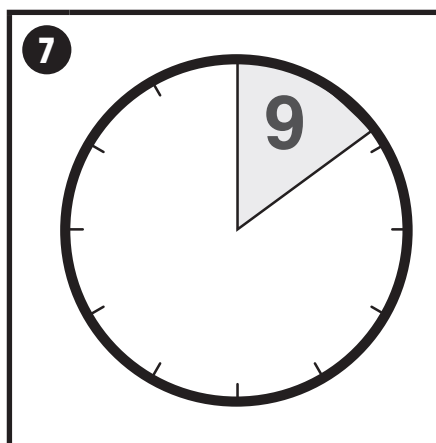

Allow approximately 9 minutes for the machine to build up steam pressure.

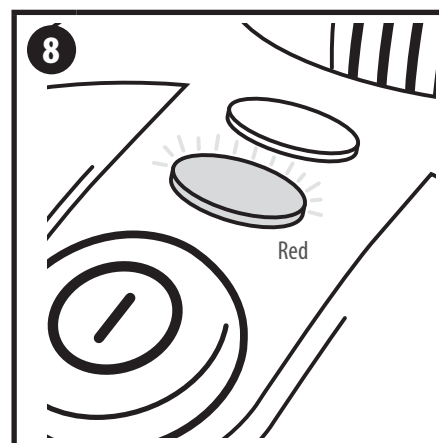

Once the orange steam pressure light turns off, the machine is ready to use.

FILLING THE WATER TANK



NEVER fill the tank while the machine is plugged in.

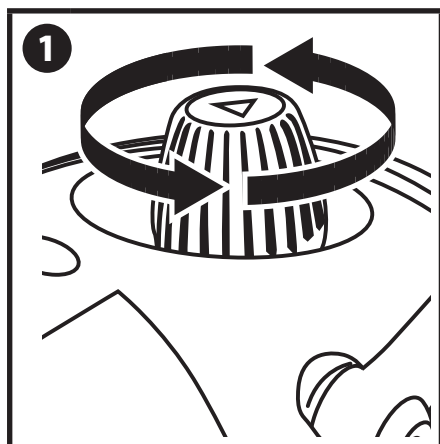

Unscrew the safety cap.

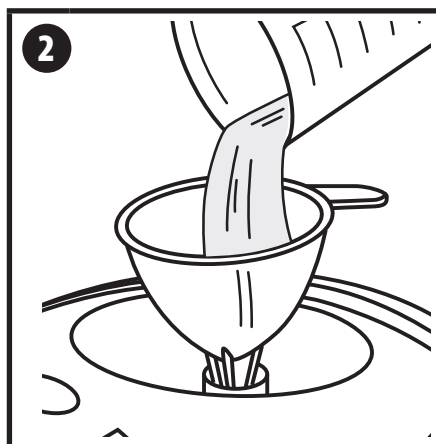

Fill the tank using the funnel provided. The tank holds up to 40 oz. /1200ml of water **DO NOT** overfill the water tank.

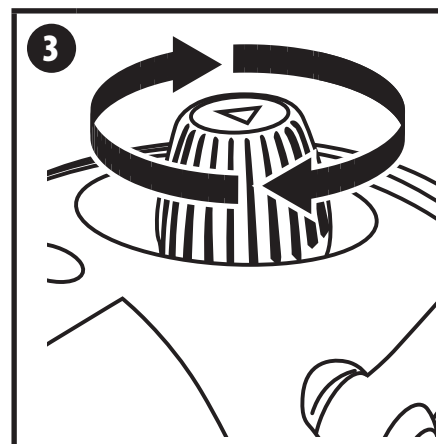

Fasten the safety cap tightly into place.

WATER USAGE AND STEAM TIME GUIDELINES

AMOUNT OF WATER	DURATION OF STEAM
13 oz. / 400ml	Approximately 15 min.
26 oz. / 800ml	Approximately 30 min.
40 oz. / 1200ml	Approximately 40 min.

REFILLING THE WATER TANK

If the unit has been in use, **ALWAYS** follow these safety precautions before removing the water tank safety cap:

- Switch the unit to the OFF position and unplug the unit. Allow at least 30 minutes for the unit to cool.
- Release all the steam pressure in the unit by pressing the steam nozzle flow trigger (the red safety switch must be in the ON position).



Failure to follow these precautions may result in burns from escaping steam when the water tank safety cap is removed.



Safety Cap will rotate but will not unscrew until unit is cool and pressure is released.



Attention

For household use only. Do not overfill reservoir as it may cause damage to the unit. Allow a 30 minute cool down period before refilling the reservoir.

STEAM GUN OPERATION

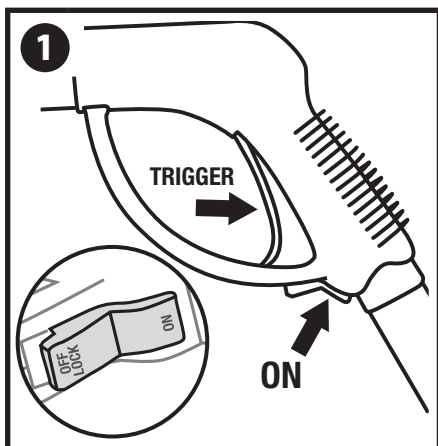

The steam output is controlled through the steam handle. The handle has both a steam trigger and red safety switch.

For intermittent steam generation press the red safety switch to the ON position. Pull the trigger to release steam.

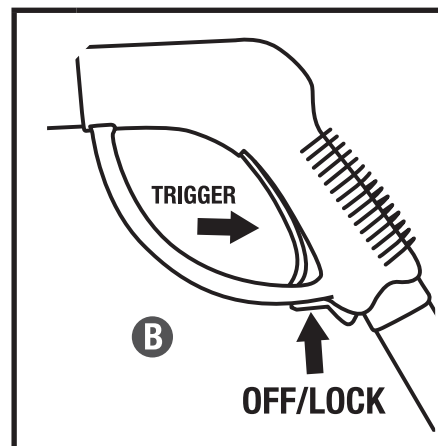
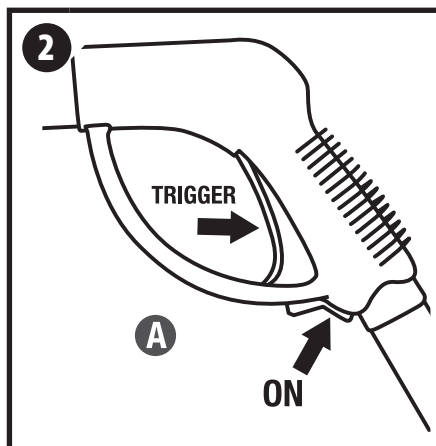

For continuous steam generation:

- (A) Start by pressing the red safety switch to the ON position, pull the trigger and then press the safety switch to LOCK. The trigger is now locked into continuous steam mode.
- (B) To unlock from continuous steam mode, release the trigger and press the red safety switch back to the ON position.

REBUILDING STEAM PRESSURE WHILE IN USE

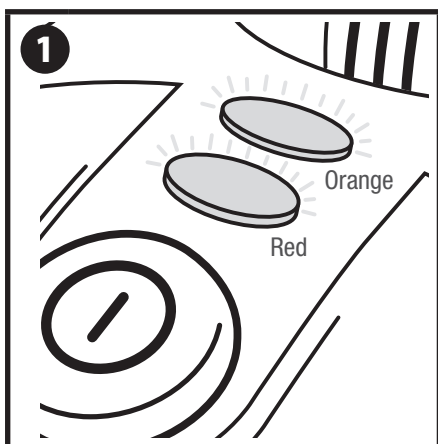

If the orange steam light comes on during use, it indicates the machine needs to re-build pressure in the tank. The machine may still be used while pressure rebuilds.



HOT STEAM AND PARTS.

May cause injury, including skin burns or property damage. Temperatures exceed 212° F (100° C).

Burns can occur from hot water or steam.

DO NOT touch the steam nozzle or attempt to connect accessories while unit is in use.

NEVER direct the steam at a person, pet or electrical device.

ASSEMBLING AND ATTACHING ACCESSORIES

ATTACHING THE STEAM PLATE TO THE STEAM GUN

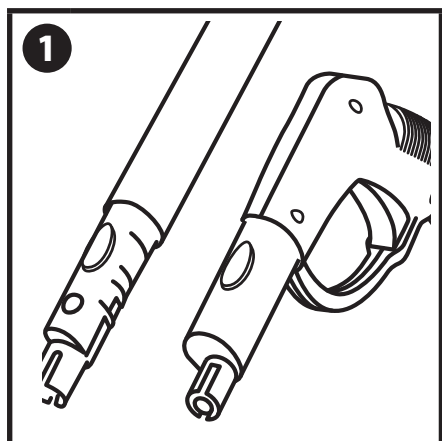

The Steam Plate adaptor will attach to either the steam gun nozzle or extension wand.

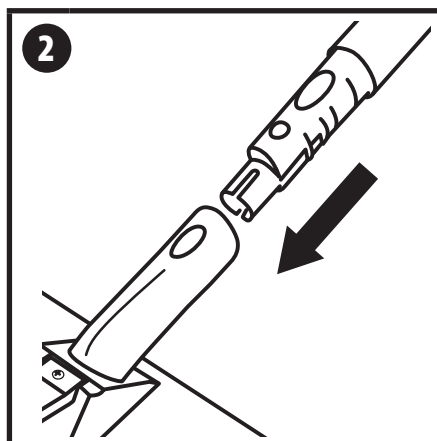

Slide the adaptor over the nozzle, aligning the oval hole with the lock/release button on the nozzle. Push the button to allow the attachment to slide into place.

WALLPAPER REMOVAL

Hold steam plate flat against wallpaper for 20 -30 seconds. Remove steam plate and scrape steamed section of wallpaper.



For best results it may be helpful to score wallpaper before steaming.

STRAIGHT ADAPTOR ACCESSORIES

ATTACHING THE SQUEEGEE, JET NOZZLE AND UTILITY BRUSHES TO THE STEAM NOZZLE



The straight adaptor is used to attach all accessories to the steam gun with the exception of the Large Brush. ALWAYS attach accessories before turning the unit on.

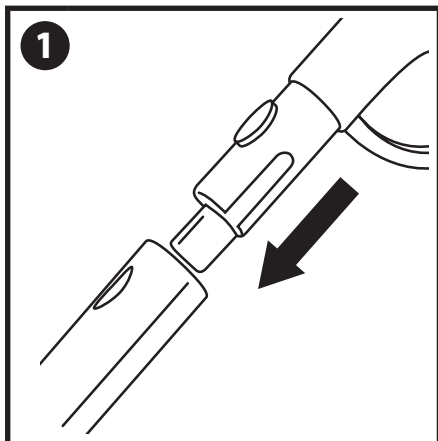

Slide the straight adaptor over the steam gun nozzle, align the oval hole with the lock/release button and push the button to allow the attachment to slide into place.

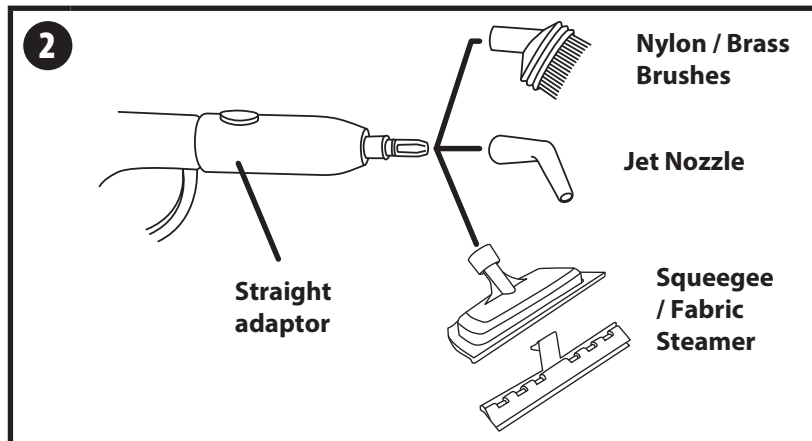

Slide the accessory onto the straight adaptor. See below for details on the different attachments.

CLEANING WITH THE ATTACHMENTS

SQUEEGEE

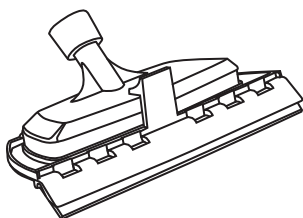

The **squeegee** is an excellent tool for cleaning bathroom shower doors and walls, fireplace doors and windows. Do not use on glass when temperature is below 32° F (0° C). Glass may crack in cold temperatures.

FABRIC STEAMER

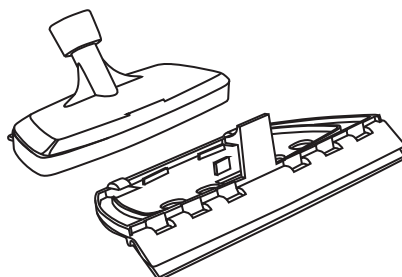

Remove the rubber lip and use for garment steaming and for killing dust mites in mattresses.

JET NOZZLE



The **jet nozzle** can be used to disinfect bathroom and kitchen fixtures and hard to reach places.

STIFF NYLON BRUSHES

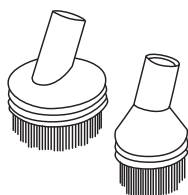

The **nylon brushes** can be used in hard to reach areas around sink and bathroom faucets.

BRASS BRUSHES

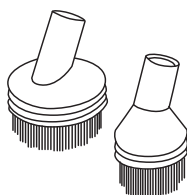

The **brass brushes** can be used to remove grease and grime found on grills and ovens.

ATTACHMENT STORAGE

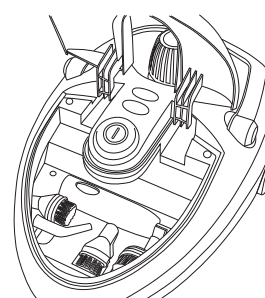

ANGLED ADAPTOR ACCESSORIES

ATTACHING LARGE BRUSH, ANGLED ADAPTOR, EXTENSION WANDS AND MICROFIBER MOP PAD



The angled adaptor is used to attach the Large Brush.
ALWAYS attach accessories before turning the unit on.

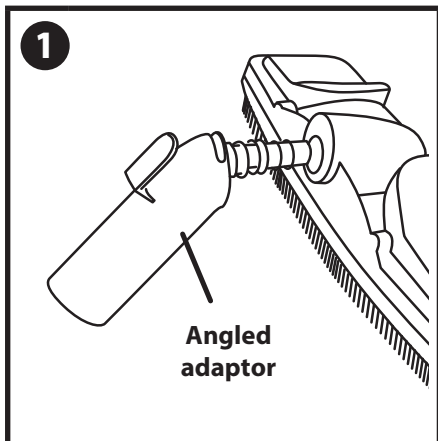

Slide the angled adaptor into the large brush receptacle. The adaptor must be angled down.

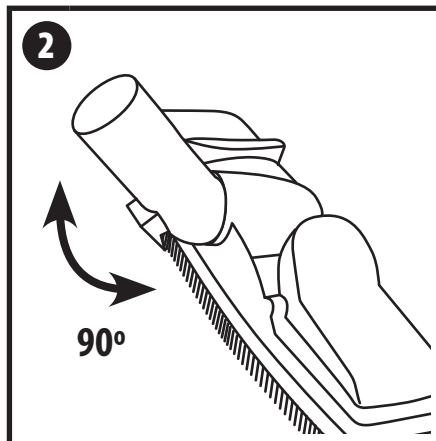

Rotate the adaptor 90° to set into place.
Align the brush adaptor with the end of the extension wand so that the oval hole on the adaptor aligns with the lock/release button on the wand.

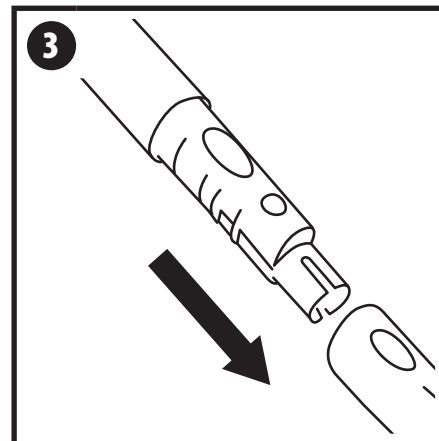

Press down on the lock/release button. While continuing to hold button down, slide brush head adaptor onto extension wand. Press firmly until button snaps into hole.

MICROFIBER MOP PAD



Never remove the mop pad while the machine is in operation or warm to the touch.

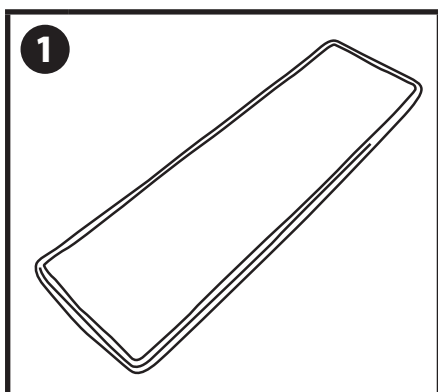

Lay microfiber mop pad on a flat surface.

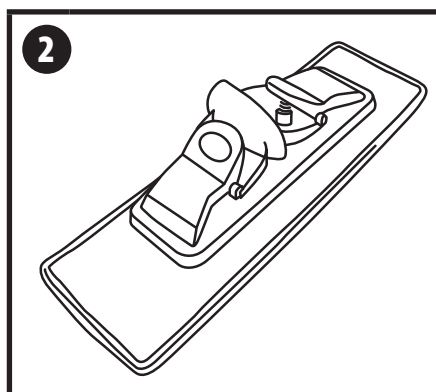

Place the large brush over the mop pad.

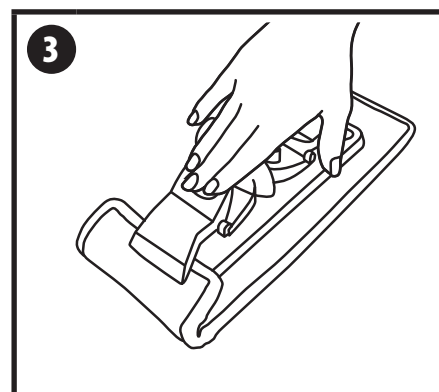

Press down on a clip on the brush and fold the end of the pad beneath the clip. Release the clip to fasten the pad into place. Repeat for the opposite side.

The large brush and mop pad are perfect for use on these hard floor surfaces:

- Stained Concrete
- Granite
- Linoleum
- Ceramic Tile
- Marble
- Vinyl



Attention

Do not use on unsealed hard wood, laminate flooring or unglazed ceramic surfaces.

Surfaces that are not properly sealed may be warped or damaged by exposure to heat and moisture. Always test a small area before beginning.