

Since the usage and finishing of the product is not under our control, we accept no liability for the success of the work and can therefore only guarantee the nature of our products as per the accompanying product data sheets and in accordance with our general terms and conditions of sale. The properties listed here represent no guarantee with respect to the eventual use of our products. We reserve the right to make changes due to technical advances. Any other technical information given in the course of a consultation must be confirmed in writing. Colours shown here are restricted by the printing techniques and may differ from those exhibited by the products themselves. We also reserve the right to make alterations to the product technology or design. Only the current version of this data sheet is valid. Such versions are accessible by anyone via the internet. The issue of the latest data sheet invalidates all those that have been published beforehand.

# TI-SHELF

1/2

## Tileable shelves from stainless steel for shower, bath and living areas

- Tile-laying instructions -



TI-SHELF DRG



TI-SHELF DRS



TI-SHELF DNG



TI-SHELF DNS



TI-SHELF RE



TI-SHELF BV



TI-SHELF TZ



TI-SHELF FE

### GENERAL

For general information on the product, please refer to the product information on TI-SHELF on-line at [www.dural.de](http://www.dural.de).

### TILE-LAYING INSTRUCTIONS

The TI-SHELF shelves are installed during tile-laying by embedding the perforated flange in the tile cement.

1. Treat the base surface as is required for tile-laying.
2. Apply tile cement with notch spacing appropriate to the tile size and begin tile-laying.
3. Apply the TI-SHELF to the upper edge of the lower tile and embed the perforated flange into the tile cement.
4. Continue with the tile-laying. In the process, notch the next higher tile in the area of the TI-SHELF shelf.
5. Cut the decorative insert and adhere using an adhesive incorporating a gentle gradient away from the wall.
6. Seal the wall connection joints with silicon. Seal the joints on the front edge using flex grout.

When using on non-tiled surfaces, the TI-SHELF shelves can be screwed to the base surface and the edge can be plastered.

DURAL GmbH

Südring 11

D-56412 Ruppach-Goldhausen

Tel. +49 (0) 2602/9261-0

Fax +49 (0) 2602/9261-50

info@dural.com

# TI-SHELF

2/2

## Tileable shelves from stainless steel for shower, bath and living areas

- Tile-laying instructions -

The TS-DNG and TS-DNS models can also be installed after the tile is laid. To do so, carefully remove the grout without possibly damaging the compound seal. Generously fill the joint with silicon and set the TI-shelf as far as possible into the joint. Remove excess silicon. Cut the decorative insert and adhere using an adhesive (such as DURA FIX) incorporating a gentle gradient away from the wall. Set the TI-SHELF as far as possible in the joint. Fasten to the wall connection and seal with silicon. Seal the joints on the front edge using flex grout.

### ATTENTION

TS-DNG and TS-DNS may be used as a corner solution only. Installation on a flat surface is not possible due to lacking stability.

The TI-SHELF series shelves are manufactured from top-quality rustproof stainless steel. The V2A stainless steel is basically insensitive to tile cement, grouting material or cement residue remover, which can come into contact with the material during tile-laying. Nevertheless, we recommend that you immediately thoroughly clean the shelves with clean water.

### CARE

TI-SHELF shelves do not require any special care beyond how you normally maintain a shower. Any cleaning should be made using a neutral household cleaner and without mechanical action.

### INDICATIONS

It is not possible to take every eventuality during the installation process into account. These installation instructions are provided as a recommendation and must be adapted to the specific conditions of the installation site in each individual case. The generally recognised rules of good engineering practice must always be observed! The following applies to all products/materials: usability in terms of mechanical and chemical loads should be carefully checked in each case before laying the tile.

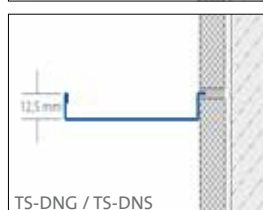
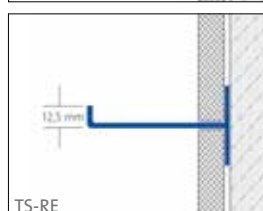
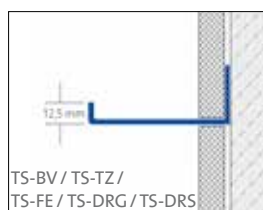

TI-SHELF DRG



TI-SHELF DRS



TI-SHELF DNG



TI-SHELF DNS



TI-SHELF RE



TI-SHELF BV



TI-SHELF TZ



TI-SHELF FE

DURAL GmbH

Südring 11

D-56412 Ruppach-Goldhausen

Tel. +49 (0) 2602/9261-0

Fax +49 (0) 2602/9261-50

info@dural.com