

Non UL "Extra-Flexible" Steel (5200 Series)

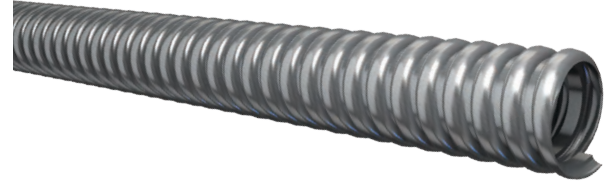

Description

- Non-UL Extra Flexible Steel Conduit
- High grade galvanized low carbon steel
- Interlocking design
- Corrosion resistant

Applications

- Flexible metal raceway for specific applications where UL and other agency approvals are not required
- Motor leads
- Made in USA of US and/or imported materials

| ORDERING INFORMATION | | | | | | PRODUCT DIMENSIONS/BEND RADIUS | | |
|----------------------|---------------------|-----------------|--------------------|--------------------|-----------------------------------|------------------------------------|------------------------------------|--------------------|
| Product Code | Trade Size (inches) | Trade Size (mm) | Coil Length (feet) | Reel Length (feet) | Approx. Weight/ 100 feet (pounds) | Internal Diameter (min/max) inches | External Diameter (min/max) inches | Bend Radius inches |
| 5201-42-00 | 3/8 | 12 | 250 | – | 8 | 0.375/0.393 | 0.560/0.610 | 2 |
| 5201-45-00 | 3/8 | 12 | – | 500 | 8 | 0.375/0.393 | 0.560/0.610 | 2 |
| 5201-60-00 | 3/8 | 12 | – | 1000 | 8 | 0.375/0.393 | 0.560/0.610 | 2 |
| 5203-30-00 | 1/2 | 16 | 100 | – | 16 | 0.625/0.645 | 0.860/0.920 | 3 |
| 5203-45-00 | 1/2 | 16 | – | 500 | 16 | 0.625/0.645 | 0.860/0.920 | 3 |
| 5203-60-00 | 1/2 | 16 | – | 1000 | 16 | 0.625/0.645 | 0.860/0.920 | 3 |
| 5204-30-00 | 3/4 | 21 | 100 | – | 21 | 0.812/0.835 | 1.045/1.105 | 4 |
| 5205-24-00 | 1 | 27 | 50 | – | 34 | 1.000/1.040 | 1.300/1.380 | 5 |
| 5206-24-00 | 1-1/4 | 35 | 50 | – | 42 | 1.250/1.300 | 1.550/1.630 | 6.25 |
| 5207-22-00 | 1-1/2 | 41 | 25 | – | 63 | 1.500/1.575 | 1.850/1.950 | 7.50 |
| 5208-22-00 | 2 | 53 | 25 | – | 84 | 2.000/2.080 | 2.350/2.450 | 10 |
| 5209-22-00 | 2-1/2 | 63 | 25 | – | 104 | 2.500/– | 2.860/3.060 | 12.5 |
| 5210-22-00 | 3 | 78 | 25 | – | 125 | 3.000/– | 3.360/3.560 | 15 |
| 5211-22-00 | 3-1/2 | 91 | 25 | – | 145 | 3.500/– | 3.860/4.060 | 17.5 |
| 5212-22-00 | 4 | 103 | 25 | – | 165 | 4.000/– | 4.360/4.560 | 20 |

NOTE: All dimensions and weights are subject to normal manufacturing tolerances.