

SHAKE WELL BEFORE USE

 **Clopay®**

# GARAGE DOOR PRO LUBE

SYNTHETIC SPRAY LUBRICANT

- Convenient to Use – Does Not Run or Drip Like an Oil.
- State of the Art, Patented Formula.  
US Patent #5614478
- The Perfect Synthetic Anti-Rust Lubricant.
- Does Not Contain Harmful Solvents.

**DANGER: EXTREMELY FLAMMABLE. VAPORS MAY CAUSE FLASH FIRE.**  
CONTENTS UNDER PRESSURE. Carefully read cautions on back panel.

PN 1088

NET WEIGHT 9 OZ. (255 g)

SHAKE WELL BEFORE USE

 **Clopay®**

## GARAGE DOOR PRO LUBE

### PRECAUTIONS:

**Physical Hazards:** Product contains extremely flammable gas under pressure. Vapor may flash, burn, or explode if ignited. Cans that short across electrical power circuits may arc, melt, explode, and burn. Vapor is heavier than air and may become concentrated to hazardous levels in low areas. Cans exposed to direct sunlight or otherwise heated above 120°F (49°C) may burst. Product and residue may make walking surfaces slippery, especially when wet.

**Safe Handling Procedures:** KEEP CAN OUT OF THE REACH OF CHILDREN. Use outdoors or in a well-ventilated area with a constant, abundant supply of fresh air. Do not allow product vapor to accumulate. Do not use, store, or dispose of near sources of heat, flames, sparks, or other hot surfaces. Keep can away from battery terminals. Do not smoke while product vapor is present. Do not get product or overspray on walking surfaces. Do not puncture or incinerate (burn) can. Store can in a cool, dry, well-ventilated area out of direct sunlight. Dispose of in accord with all applicable federal, state, and local regulations.

**Health Protection Measures:** Do not take internally. Do not get in eyes. Wash hands thoroughly with soap and water before touching eyes, eating, or smoking, and after using product.

**First Aid:** Always get prompt medical attention for ANY ill effects that persist or appear later. If in eyes, IMMEDIATELY flush area thoroughly with water, remove any contact lenses, then hold eyelids open and continue flushing eyes for about 15 minutes.

A synthetic spray lubricant, GARAGE DOOR PRO LUBE is convenient and easy to use. It WON'T run or drip off like an oil. GARAGE DOOR PRO LUBE is an anti-friction, anti-rust lubricant that provides a long-lasting, thin film on any surface. GARAGE DOOR PRO LUBE does not contain petroleum distillates, so it **WON'T ATTRACT DIRT**, and functions effectively under extreme conditions or temperatures (-80° to +600°F).

Home, auto and marine uses include:

- |                     |                    |
|---------------------|--------------------|
| • Garage doors      | • Fishing reels    |
| • Engine assembly   | • Bicycles         |
| • Motorcycle chains | • Shop tools       |
| • Guns              | • Hinges           |
| • Winches           | • Sliding doors    |
| • Locks             | • Window slides    |
| • Garden tools      | • And many more... |

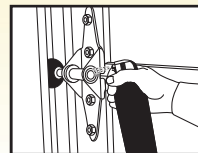

HINGES AND ROLLERS

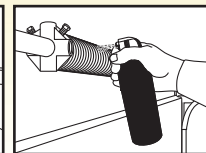

TORSION SPRING

### DIRECTIONS

1. Shake well until ball rattles before each use.
2. Remove safety tab (if first use), aim nozzle at area to be lubricated, press trigger to spray.
3. May be applied as a thin lubricant film, or more heavily as needed.

Made in the U.S.A. for Clopay Corporation  
Call 1-800-2clopay [www.clopaydoor.com](http://www.clopaydoor.com)  
DOES NOT CONTAIN CFCs OR HCFCs.

