



# CROWN KING

A CUTTING GUIDE FOR CROWN MOLDINGS

## Professionally Cut Crown Molding Joints . . . Easily and Precisely



The jig has two pieces: the gray jig molded for 45° spring angle moldings and a versatile and reconfigurable yellow insert for 38° and 52° spring angle moldings.

### INSERT POSITIONING



Positioned for 38° spring angle moldings

Positioning for 52° spring angle moldings

### JOINT DESCRIPTION

Interior wall corner

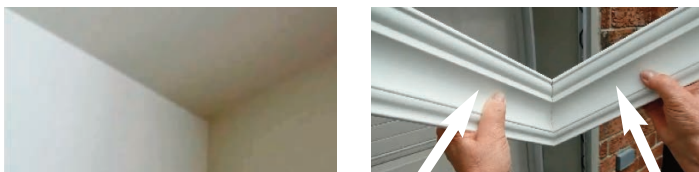

Interior (INT) Joint

Left Interior Right Interior

Exterior wall corner

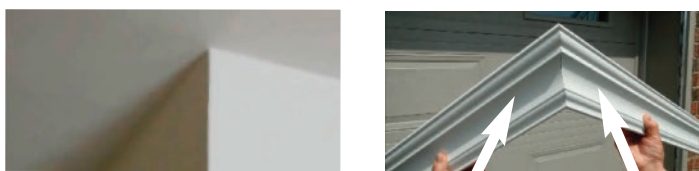

Exterior (EXT) Joint

Left Exterior Right Exterior

### JIG SET-UP

To check molding angle before cutting, place molding in jig; the wall face angle should be vertical and the top angle (ceiling) horizontal.



Correct Spring Angle

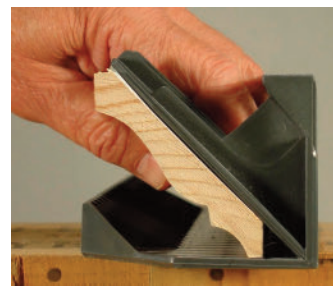

45° spring angle



52° spring angle



38° spring angle

### JIG ALIGNMENT

All interior (INT) and exterior (EXT) corner miters for left-side molding joints are made on the left side of the blade; cuts to the right-side molding joints are made on the right side of the blade.



TOP markings for LEFT side cutting



TOP markings for RIGHT side cutting



Left side jig positioning



Right side jig positioning



Clamping is optional and not required



### BASIC MITRE CUTTING EXAMPLE

Start with a left interior corner of a short wall and going clockwise measure the wall length; then measure around the following exterior corner to the next interior corner



THIS EXAMPLE SHOWS THE SET-UP FOR:

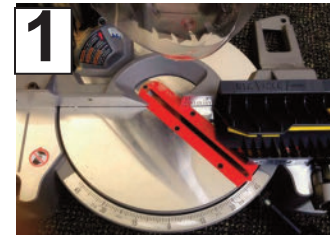

1 AN INTERIOR JOINT'S RIGHT SIDE CUT

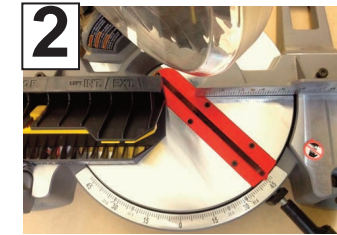

2 AN EXTERIOR JOINT'S LEFT SIDE CUT

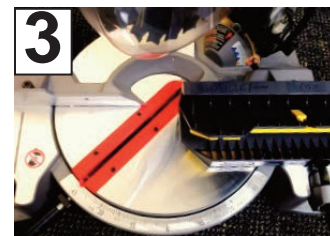

3 AN EXTERIOR JOINT'S RIGHT SIDE CUT

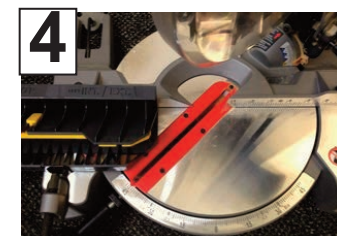

4 AN INTERIOR JOINT'S LEFT SIDE CUT

### FINISHED EXAMPLE



Interior Joint Right Side Exterior Joint Left Side Exterior Joint Right Side Interior Joint Left Side



### GENERAL TOOLS & INSTRUMENTS

80 White Street New York, NY 10013-3567  
PHONE (800) 697-8665 FAX (212) 431-6499  
www.generaltools.com  
880 User's Manual 10/07/2013  
©2013 GENERAL TOOLS & INSTRUMENTS

## 4 SIMPLE STEPS FOR CREATING THE CROWN

### 1. MEASURE THE CORNER ANGLES

Using a protractor measure the interior (INT) and exterior (EXT) corners

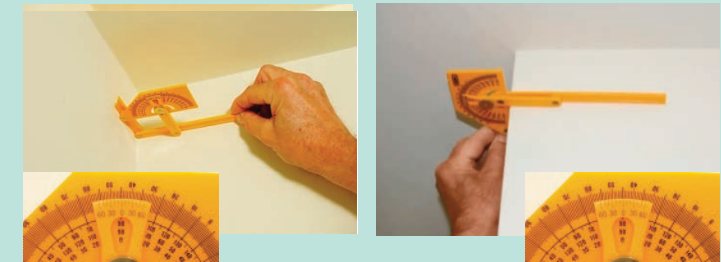

Both show a normal 90° angle

### 2. SET-UP THE SAW

Set the saw blade direction as indicated on the top of the jig. Then set the blade at 1/2 of the measured angle



### 3. MAKE THE CUTS\*

Position the jig and the molding on the miter saw table with the jig against the saw fence as far back from the saw blade as needed. Hold moldings securely in the jig and make the cut.



### 4. INSTALL THE MOLDING

The yellow angle insert can also be used as an installation guide; hold the insert against the wall to check 38° and 45° angles, or against the ceiling to check 52° angles.



\*Always use protective eyewear when using a Miter saw