

Something Wrong? Broken? Missing?

Any mistake was unintended & we certainly apologize for the human error and inconvenience. We do our absolute best to make it right - everytime.

For fastest service
Text: 612-709-9534

Send a photo of packing list or product description label on box

Include the letter or description of part needed or other issue

Part requests received by 2PM CST ship immediately that day (M-F)

You may also:
Email - Service@vertexproducts.com
Call - 612-709-9534

Please Choose **Discussion over Destruction**

No product is perfect and ONE bad review destroys even the best idea. If possible, please reach out to see if we can fix an issue before leaving negative reviews.

**GIVE US
5 STARS**

OR

**GIVE US
5 MINUTES**



Something POSITIVE?
Please share a positive
product review.



Something NEGATIVE
or need improvement?
PLEASE contact us directly

Be kind, be fair and be honest; while appreciating the well-intended hard work our team has dedicated.

Our jobs depend on our products and service to you.

We appreciate your business and support of our Made in America products.



Respectfully,
TheXceptional Team

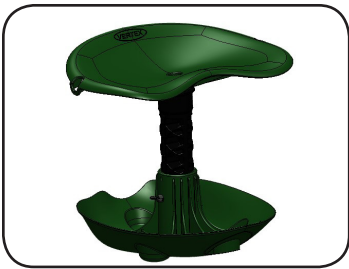

GB1200 Garden Rocker

®



✉ - service@vertexproducts.com
 📞 - vertexproducts.com
 📱 - 612-709-9534

STEP 1

Before beginning assembly, you should have:

Product Components

- A ROCKr™ Base
- B Seat
- C Seat Post

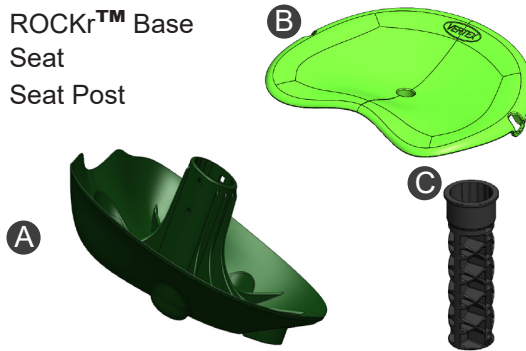

Hardware Pack

- H 1/4"-20 Long Screw **1X**
- J 1/4"-20 x 2" Bolt **1X**
- K Nylock Nuts **1X**
- L Wing Nut **1X**
- G Seat Install Tool **1X**

Part K may rest INSIDE part G during shipping

MISSING PARTS?

Send the following to
 service@vertexproducts.com
 or text 612-709-9534

1. Model Number & Place of Purchase
2. Letter & Description of missing part
3. Your Name and Address

Inquiries received by
 2 PM CST will be
 shipped same business day

STEP 2

A: Insert bolt as shown

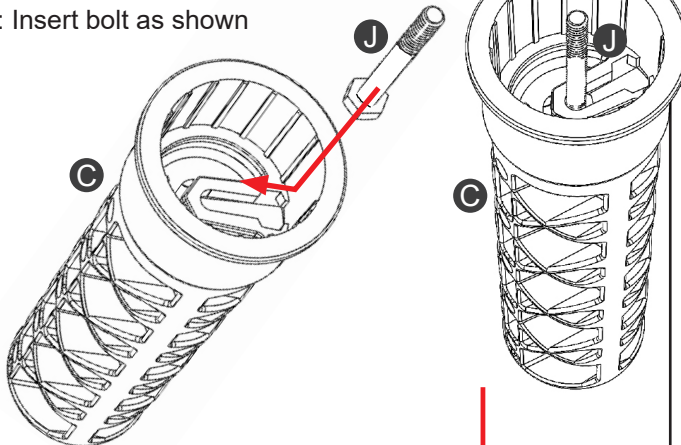

B: IMPORTANT!!! Align TAB on Seat Post to FRONT CENTER RIB as shown, tip upside down and press down on post until tube is fully seated.

TAB ON POST
 FRONT CENTER
 Rib On Seat

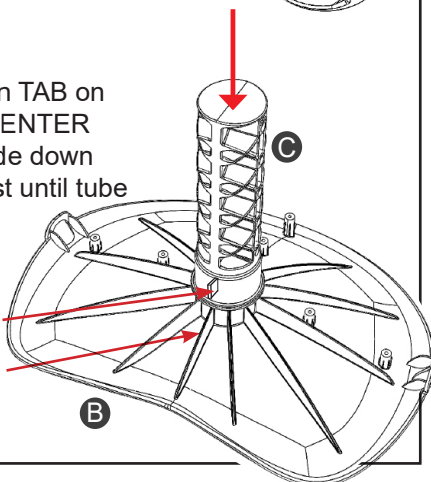

STEP 3

A: Insert nylock nut into tool as shown. Be careful to install nylock side first, as shown

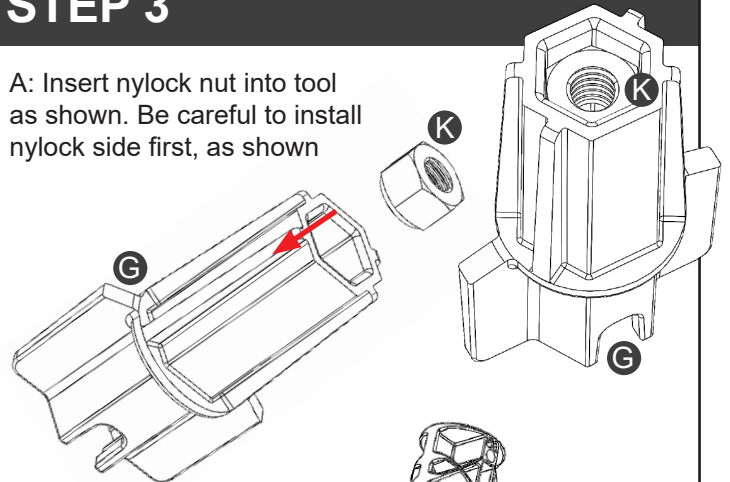

B: Hold seat and post upside down and using tool with nylock nut inserted install from bottom up and turn tool clockwise until nut is tight all the way to seat

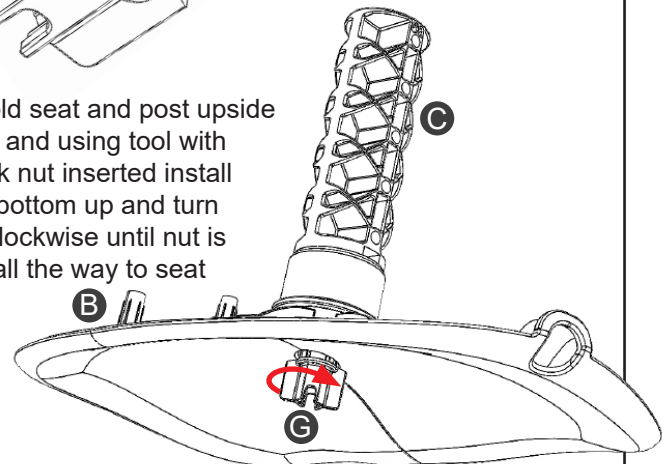

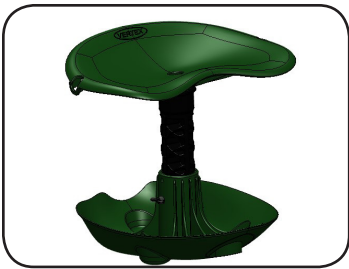

GB1200 Garden Rocker

®



✉ - service@vertexproducts.com
🌐 - vertexproducts.com
📞 - 612-709-9534

STEP 4

A: Turn assembly on its side so you can easily align the hole in the base with the hole in seat post and attach as shown

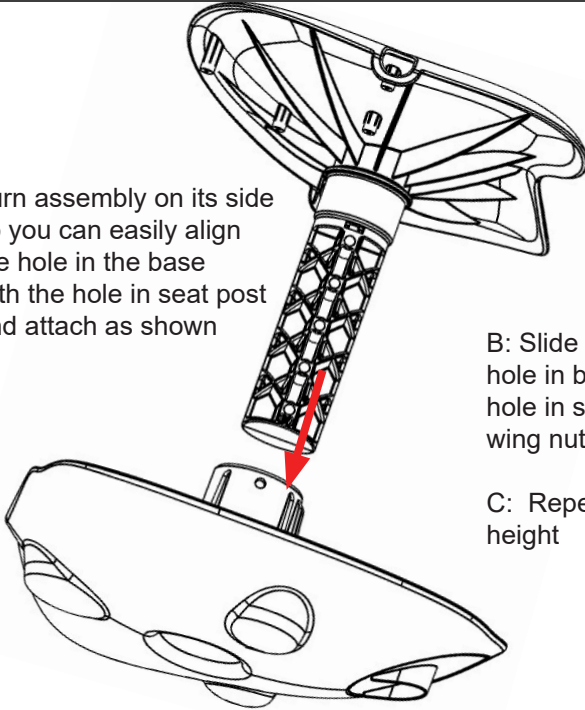

B: Slide adjustment bolt through hole in base and corresponding hole in seat post. Secure with wing nut.

C: Repeat for adjusting seat height

