

# American Planking Installation Instructions

## Read Carefully Before Installation

**Step 1)** Open boxes of planking in the room it will be installed. Wood **MUST** acclimate to the conditions of the room for a minimum of **72 hours**.

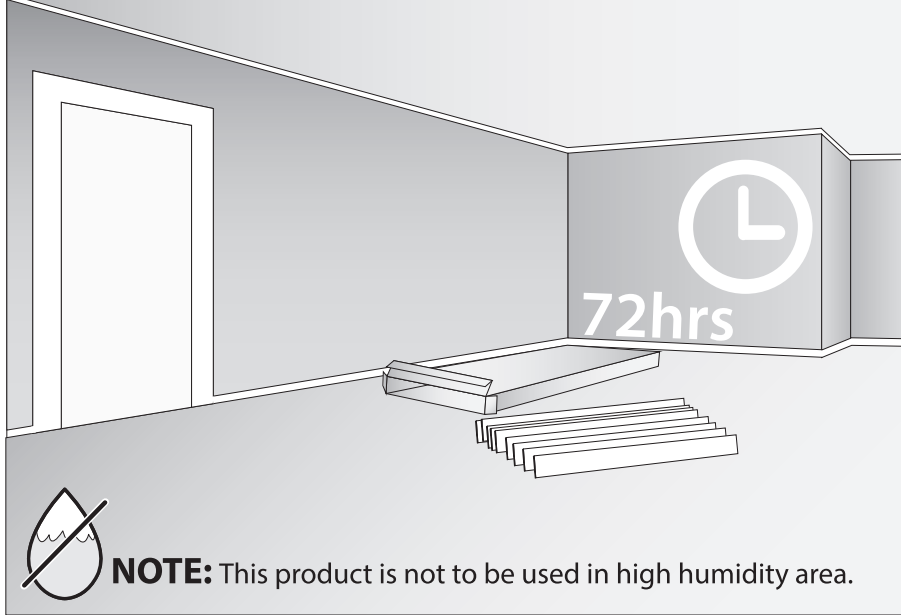

**NOTE:** This product is not to be used in high humidity area.

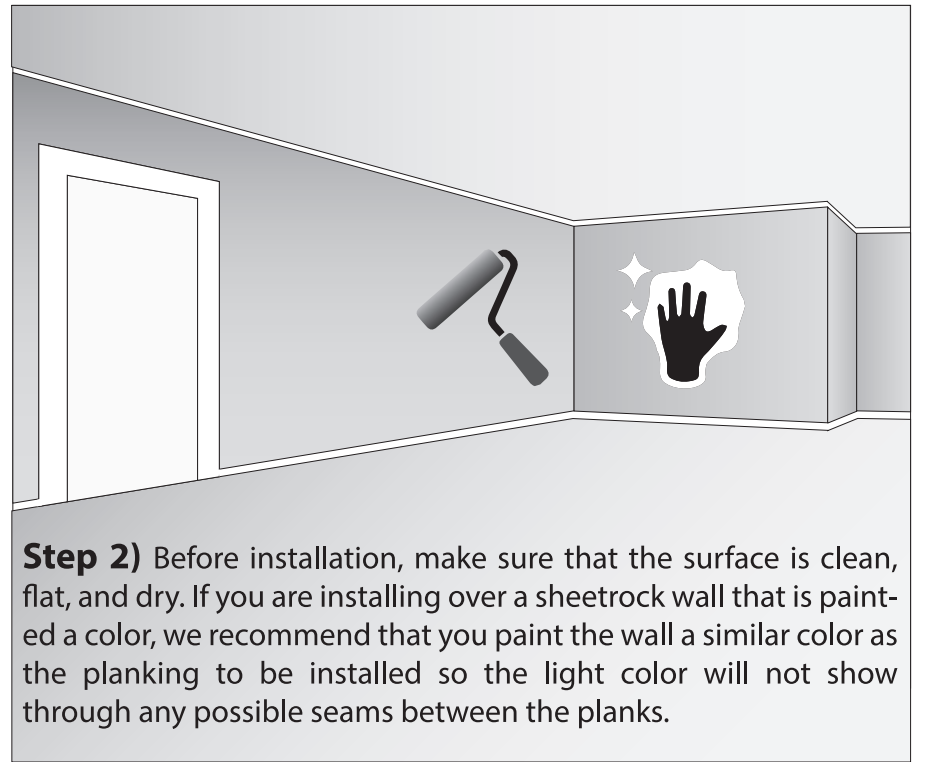

**Step 2)** Before installation, make sure that the surface is clean, flat, and dry. If you are installing over a sheetrock wall that is painted a color, we recommend that you paint the wall a similar color as the planking to be installed so the light color will not show through any possible seams between the planks.



### Proper Construction Adhesive Application

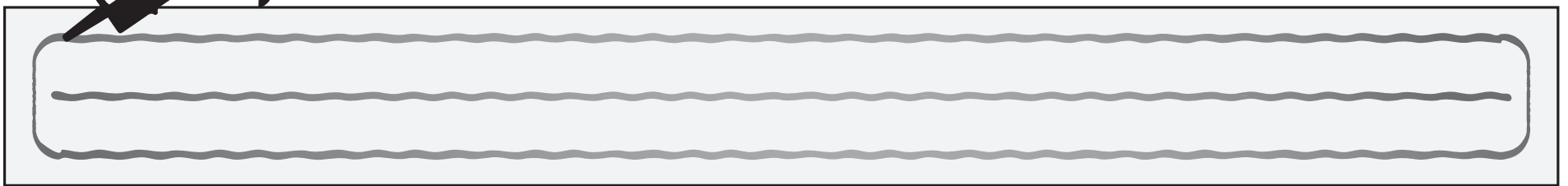

### Proper Brad / Nail Placement



**Step 3)** Recommended installation is with Heavy Duty **\*Liquid Nails\*** (construction adhesive) and to be nailed with a brad nail gun or a hammer and finishing nails. Each plank should have a bead of adhesive 1" from all outside edges and a single bead applied down the center of the plank (see above diagram). Recommended brad/nail length is 1-3/4". Apply brads/nails approx 1/2" from outside edges of planks and into studs when possible (see above diagram). If a brad gun is not available, use 3d x 1-3/4" finish nails along with a nail set to set the nail head slightly below the surface of the plank. It is not recommended to apply wood putty to the nail holes since the putty will collect in the weathered wood grain.

### Horizontal Installation

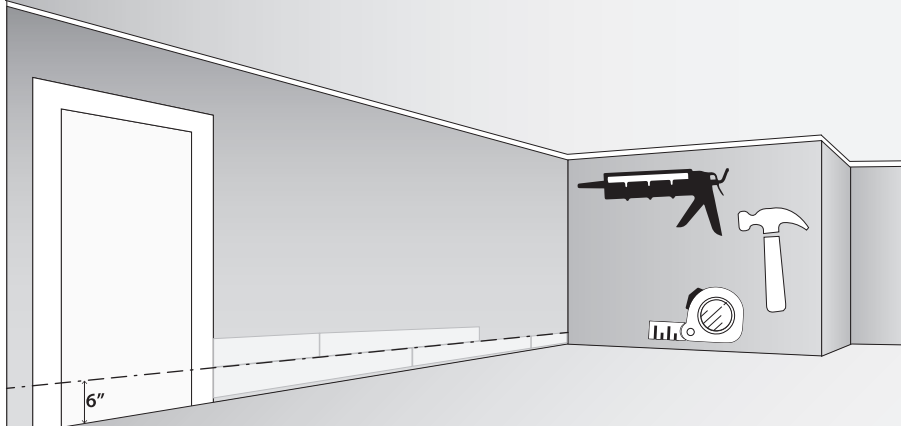

Starting on the floor, draw a level line at 6" from the floor. Next, attach the first plank in the left corner and add construction adhesive to the back of the plank then nail in place (see instructions above). Repeat this process until you reach the right wall cutting the pieces as needed. Stagger the next row of planks over the joints and cut pieces to fit as needed until you reach the ceiling. Finally add wood trim at the floor to finish your installation if desired.

### Vertical Installation Wainscoting

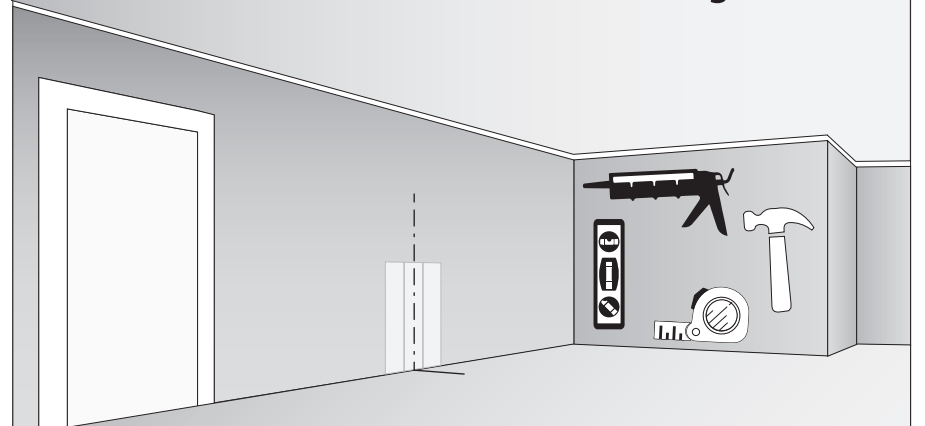

Start by finding the center of the wall and mark its location on the floor. Install the first plank on the wall centered on the mark with construction adhesive and nail in place with a brad gun (see instructions above). Use a level to make sure it is plumb. Next, attach planks on the left and right of first centered plank until you reach the corners of both walls. The width of the final plank at each corner will need to be trimmed to fit.

### Barnwood Gray touch up instructions

What you will need: \*\*Beher Semi Transparent Waterproofing Stain & Sealer Tinted to "Boot Hill Grey" (ST-159)  
Cotton Swabs or a small art brush

#### Step 1

Apply a small amount of \*\*Beher Semi Transparent Waterproofing Stain & Sealer Tinted to "Boot Hill Grey" (ST-159) to a cotton swab (or art brush). Lightly brush the stain over the area needing to be repaired. Repeat light coats of stain until the area blends into the original plank color.

**American Planking**  
520 Salem Ave. Holly Springs, MS 38635  
AmericanPlanking.com

\*Liquid Nails® is a registered trademark of PPG Architectural Coatings North America © 2017 PPG Industries. 400 Bertha Lamme Drive Cranberry Township, PA 16066.

\*\*Minwax® is a registered trademark of The Sherwin-Williams Company 101 W. Prospect Ave. Cleveland, OH 44115