



## #5642-61 Big Wheel® Cart Assembly Instructions

### Material Included

|                           |              |    |
|---------------------------|--------------|----|
| 1. Body                   | Plastic      | 1  |
| 2. Support Stand          | Plastic      | 1  |
| 3. Handle Cap             | Plastic      | 1  |
| 4. Axle Retainer          | Plastic      | 1  |
| 5. Axle                   | Steel        | 1  |
| 6. Wheel                  | Nylon/Rubber | 2  |
| 7. Washer                 | Nylon        | 4  |
| 8. Locking Cotter Pin     | Metal        | 2  |
| 9. #10 -- 16 x 3/4" Screw | Steel        | 4  |
| 10. 1/4" -- 14 x 1" Screw | Steel        | 6  |
| 11. 1/4" -- 14 x 3" Screw | Steel        | 10 |

**Tools Required:** Phillips Head Screwdriver, Flat Head Screwdriver, Crescent Wrench

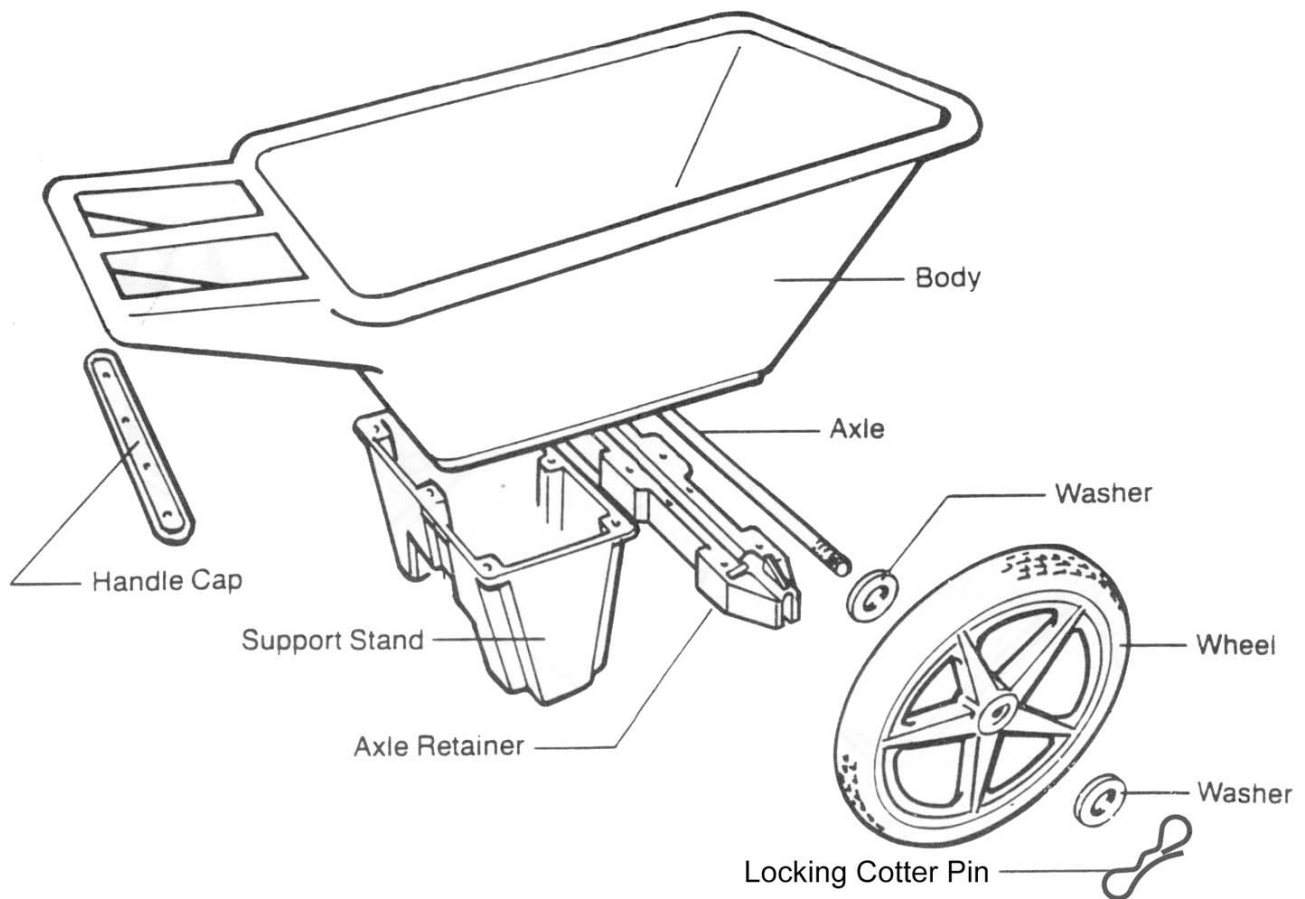

(OVER)

1. Remove all parts from inside cart and turn cart upside down.
2. Place handle cap on bottom of handle and secure with four (4) #10 -- 16 x 3/4" screws. See Figure 1.
3. Place support stand on bottom of cart toward rear of cart and secure with six (6) 1/4" -- 14 x 1" screws. Four holes in center of support stand are for optional caster kit (#5641) and are not used in this application. See Figure 2.
4. Insert axle through axle retainer and place assembly on bottom of cart. Center axle in axle retainer making sure hole in axle is visible. Secure retainer to body with ten (10) 1/4" -- 14 x 3" screws. See Figure 3.

**Caution:** See detail in Figure 3 for proper orientation of axle retainer to ensure proper side of axle retainer is in the up position.

5. Place one nylon flat washer on axle. Place wheel on axle. Place another nylon washer on axle. Place self-locking nut on axle and tighten with wrench. To keep axle from rotating, place screwdriver in hole in axle. See Figure 4.
6. Assemble other wheel, following same procedure as step 5.

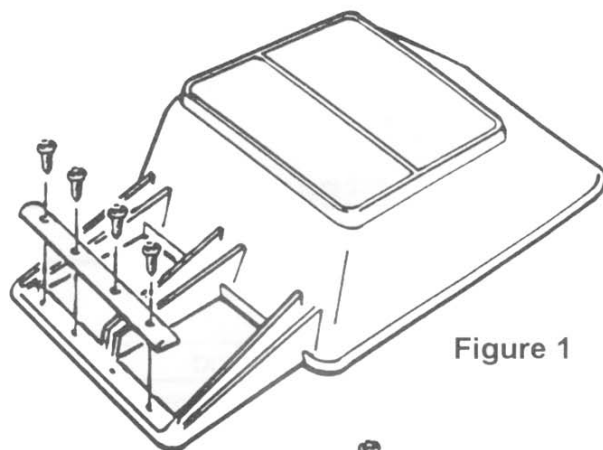

Figure 1

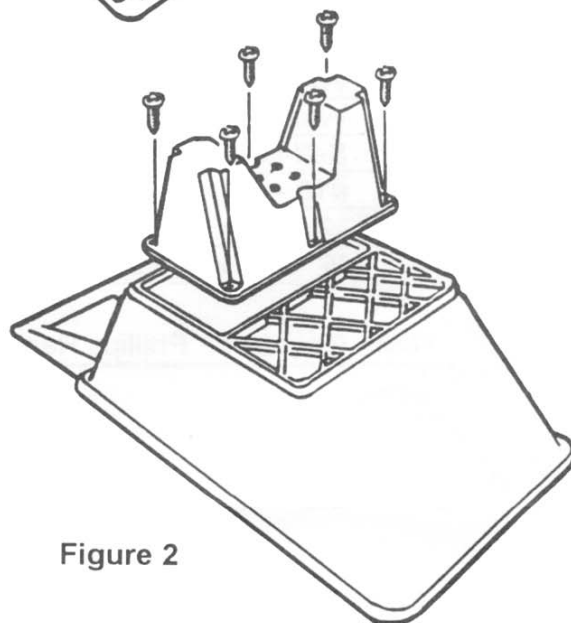

Figure 2

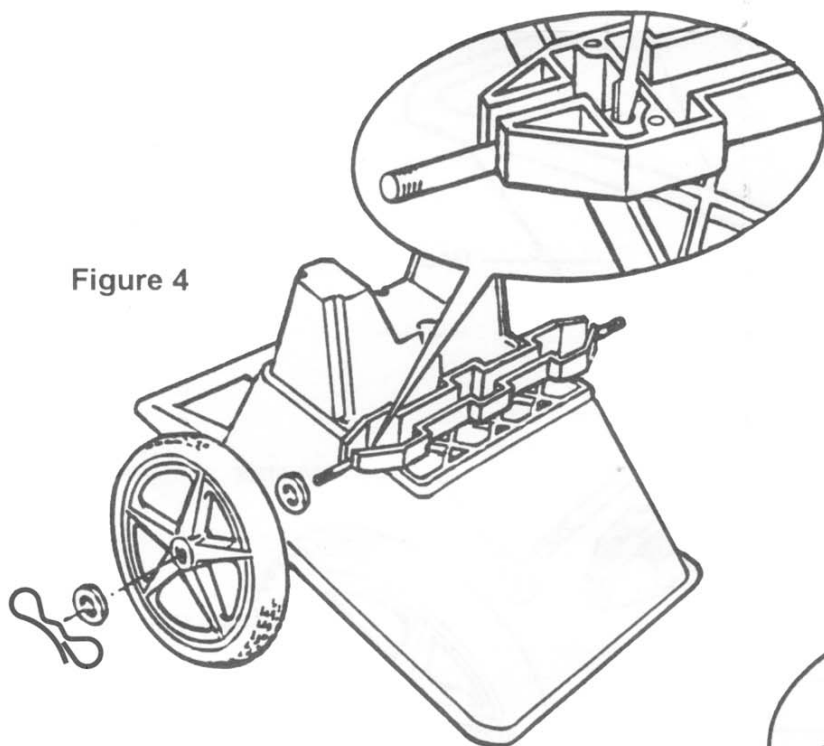

Figure 4

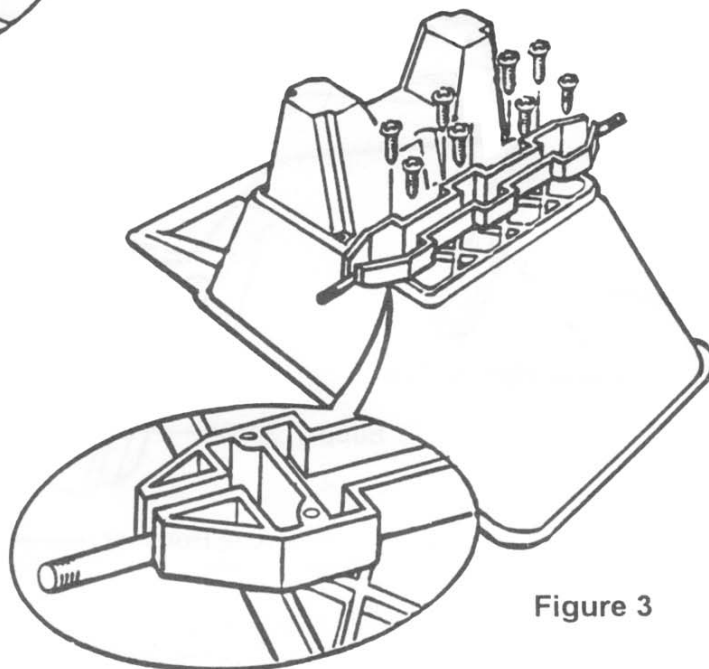

Figure 3