



READ AND UNDERSTAND ALL INSTRUCTION, WARNING, AND DANGER LABELS.
PARA INSTRUCCIONES EN ESPAÑOL, REFIÉRESE AL MANUAL DEL OPERADOR.



1

Identify FORWARD (A) and REVERSE (B) clutch cables. Hook Z-end of each cable into its proper directional engagement lever.

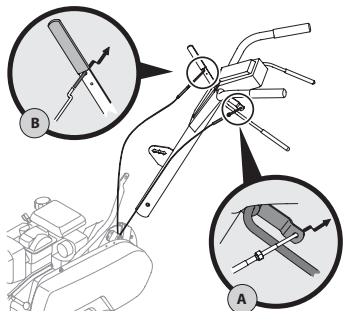

2

Remove hex bolt and washer from right side of frame (1), hold bracket on left side of frame and guide handle into place (2). Insert bolt, from the right, through cupped washer, frame, handle, and into bracket on left side.

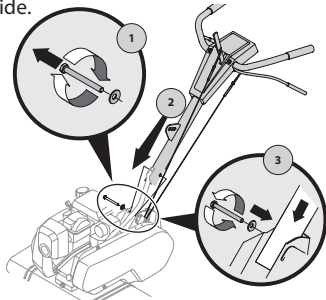

3

Tighten bolt securely.

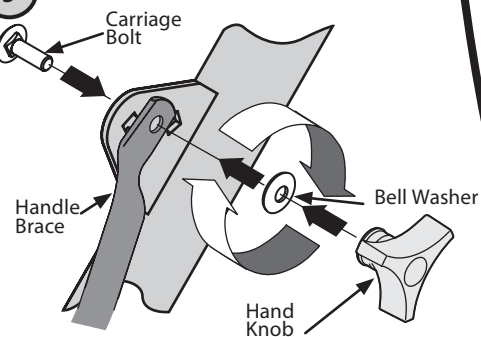

FAST START GUIDE

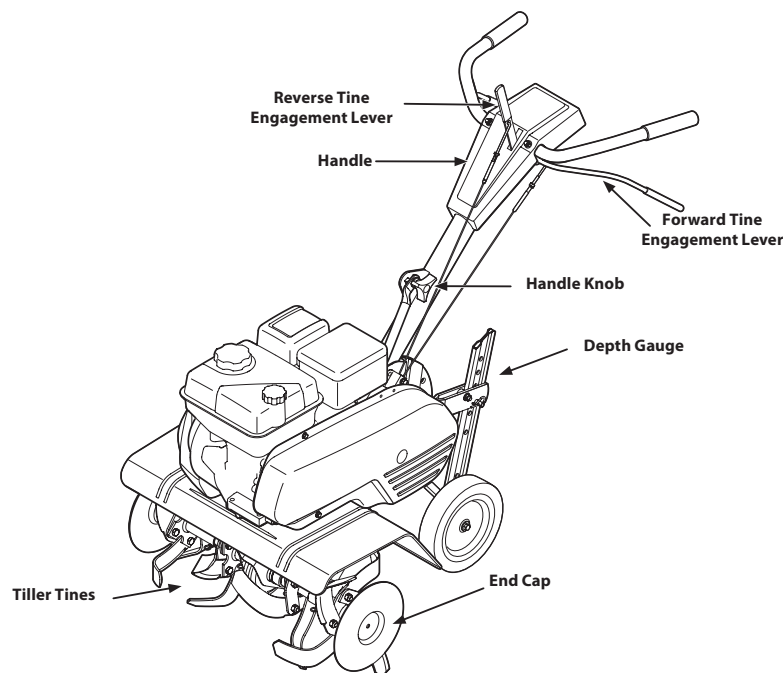

Tools Required:

- 1/2-inch wrench (or adjustable wrench)

4

Remove the 2 hex bolts from the depth stake assembly, insert assembly into frame, reinstall hex bolts, and secure depth stake with clevis pin and cotter pin.

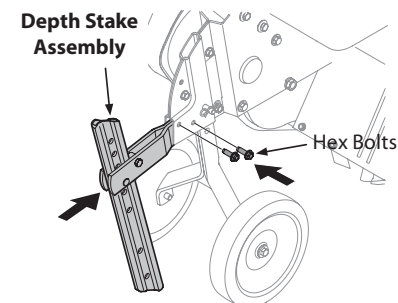

5

To adjust wheel height remove cotter pin from clevis pin, clevis pin from wheel yoke and slide depth stake in the yoke to the desired height. Reinstall hardware.

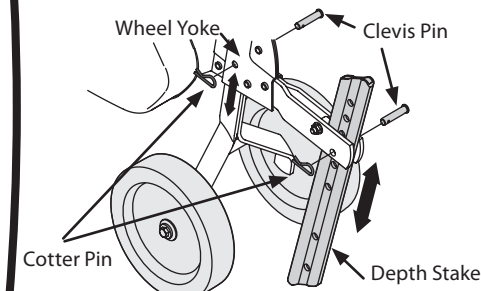

6

Adjust forward and reverse drive cables before operating by loosening hex nut and turning the cable collar one or two turns to increase or decrease tension on the cable. Retighten lock nut.

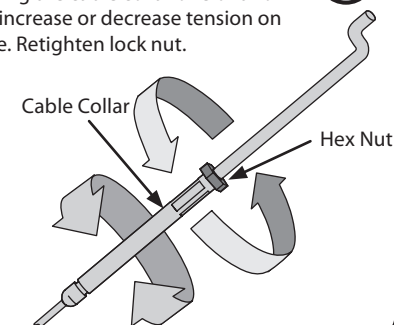

IMPORTANT: READ OPERATOR'S MANUAL AND ENGINE MANUAL THOROUGHLY AND FOLLOW THE IMPORTANT SAFE OPERATION PRACTICES BEFORE OPERATING .



Need Help? Call 1-888-TO-HELP-U



READ AND UNDERSTAND ALL INSTRUCTION, WARNING, AND DANGER LABELS.
PARA INSTRUCCIONES EN ESPAÑOL, REFIÉRESE AL MANUAL DEL OPERADOR.



FAST START GUIDE

1

Pour the entire contents of the oil bottle (included in carton) into the oil fill.



2

Fill fuel tank with clean, fresh gasoline until fuel reaches the fuel level indicator.

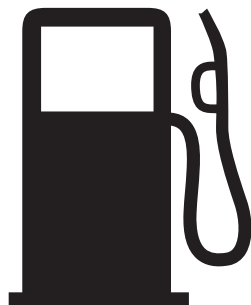

3

Move throttle control into the Fast  position.

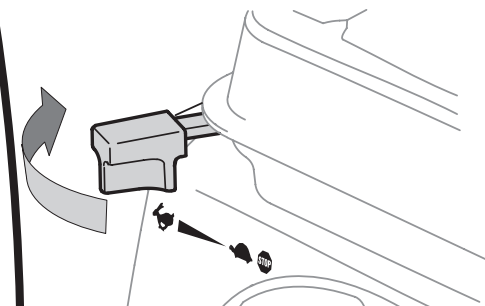

4

Move the choke control into the Choke  position.

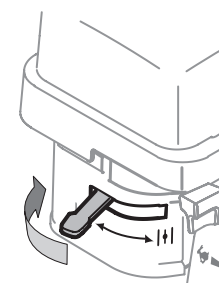

Grasp starter rope handle and pull with quick, full-arm stroke.

When engine starts, slowly move choke control into the Run  position.

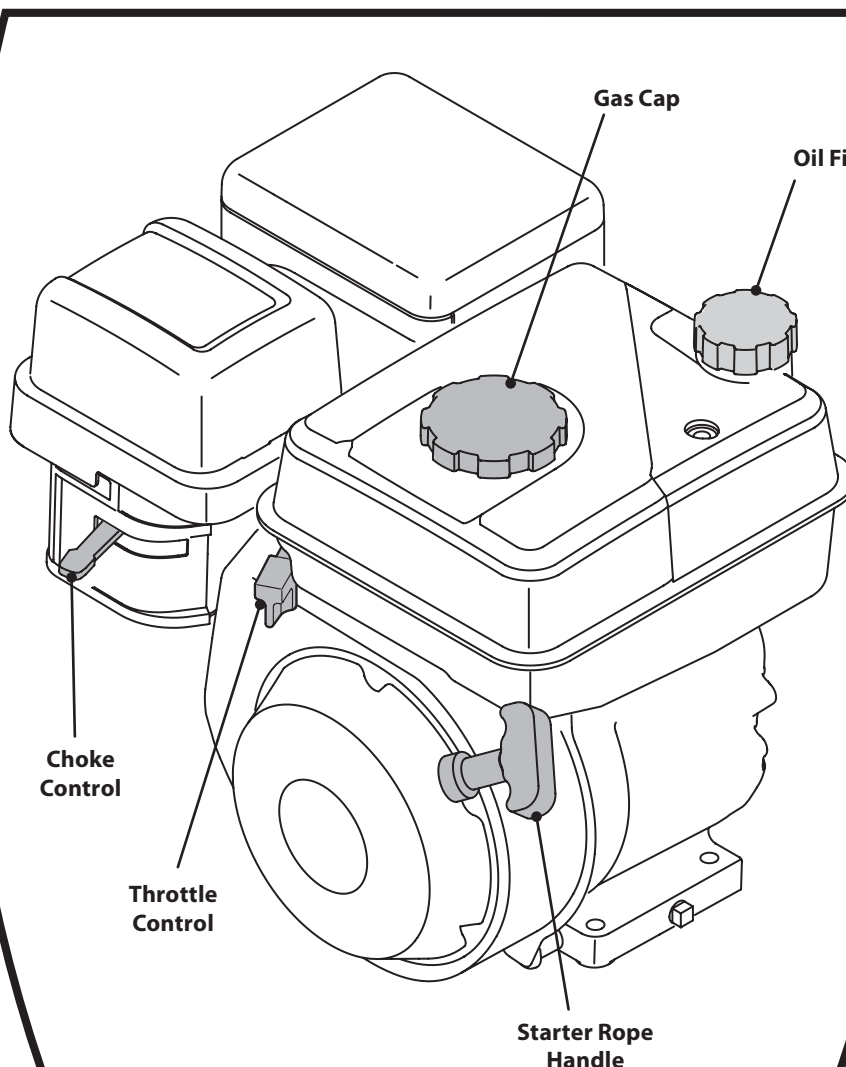
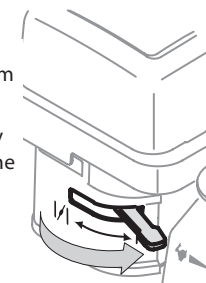

IMPORTANT: READ OPERATOR'S MANUAL AND ENGINE MANUAL THOROUGHLY AND FOLLOW THE IMPORTANT SAFE OPERATION PRACTICES BEFORE OPERATING .



Need Help? Call 1-888-TO-HELP-U