

YAUFEY

Home Dehumidifier

Please read the manual carefully
before using the product

PD161D

USER MANUAL

FOR CUSTOMERS

Thank you for purchasing our dehumidifier.

Yaufey has been committed to developing powerful and easy-to-use products to bring more convenience to your life. We highly recommend you to keep this user manual for future reference in case of unexpected problems.

Please read this user manual carefully to ensure proper use of the dehumidifier. This dehumidifier is perfect for reducing humidity in family bedrooms, bathrooms, basements, offices, storage rooms and more.

Yaufey dehumidifiers reduce the room humidity efficiently, creating a more healthy and comfortable environment for you and your family.

REQUESTING CUSTOMER SERVICE

If there are any problems of the product, please contact Yaufey Customer Service at support@yaufey.com with your Purchase Order ID. We'll help you solve the problems as soon as possible.

BEFORE FIRST USE:

To protect the product from any internal damages, please keep the product in the upright position throughout its journey.

Please take out the product and leave it standing in the upright position for **24 HOURS** before plugging it in.

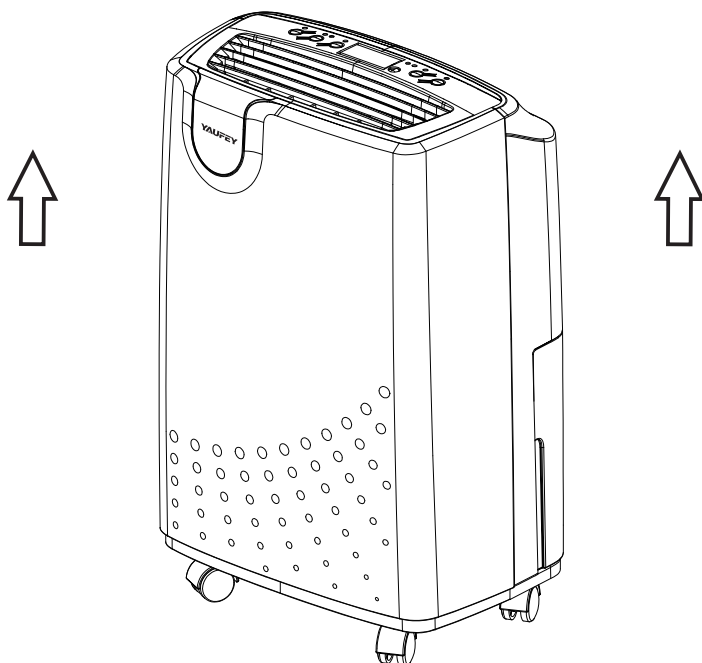

TABLE OF CONTENTS

Important Safety Instructions.....	1
Parts Description.....	3
Operations.....	4
Care & Cleaning.....	9
Troubleshooting.....	10
Specifications.....	13
Warranty & Contact Us.....	14

IMPORTANT SAFETY INSTRUCTIONS

IMPORTANT NOTICE FOR FIRST USE

To prevent any injuries to the user or other people, please follow the instructions below when using the dehumidifier. Any incorrect operations may cause harms or damages. This dehumidifier is for indoor use only.

- Make sure to turn off and unplug the dehumidifier before cleaning.
- Do not touch the plug with wet hands.
- Do not operate or turn off the dehumidifier by plugging in or unplugging the device. Use the control panel instead.
- Be sure to run the water hose slowly downward to let the water flow out smoothly.
- Do not use the dehumidifier if the power cord is broken or damaged.
- Do not place the dehumidifier in places where it may be splashed by water.
- Do not place the dehumidifier near a heat source.
- Do not install the dehumidifier in a location that may be exposed to combustible gas.
- Do not use the dehumidifier near flammable gas or combustibles, such as gasoline, benzene, thinner, and more.
- Do not use the dehumidifier in areas where chemicals are handled.
- Do not climb on or place objects on the dehumidifier.
- Do not place a heavy object on the power cord and make sure that the cord is not compressed.
- Place the dehumidifier on a level, sturdy section of the floor, and avoid placing on uneven or tilted sections.
- Disconnect the power if strange sounds, smell, or smoke comes from the dehumidifier.
- Do not take the water bucket out while the dehumidifier is working.
- Do not cover the intake or exhaust openings with clothes or towels.
- Care should be taken when using the dehumidifier in a room with the following people: infants, children, the elderly and people not sensitive to humidity.
- Never insert your finger or other foreign objects into grills or openings. Take special care to warn children of these dangers.
- Never try to take it apart or repair the dehumidifier by yourself.

IMPORTANT SAFETY INSTRUCTIONS

- Do not drink or use the water drained from the dehumidifier.
- Always insert the filters securely. Make sure to clean the filter once every month.
- Do not use the dehumidifier in very small spaces.
- If water enters the dehumidifier, please turn the dehumidifier off and disconnect the power, contact Yaufey Customer Service at support@yaufey.com in order to avoid a hazard.
- Please take care of your children to make sure that they do not play with the machine.
- This machine should not be used by people without civil capacity, including those who are physically and mentally impaired, or lack relevant knowledge and experience, unless they are instructed by a professional.

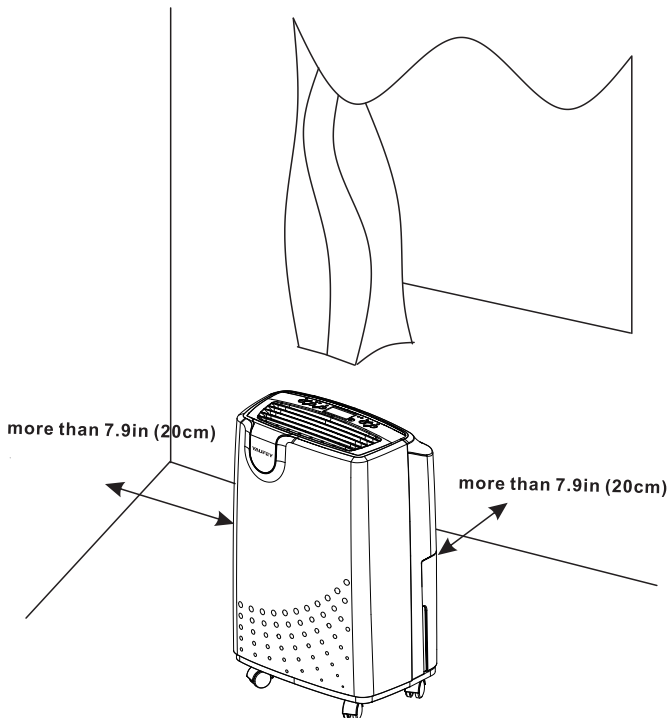

PARTS DESCRIPTION

FRONT

- Control Panel
- Air Outlet Grille

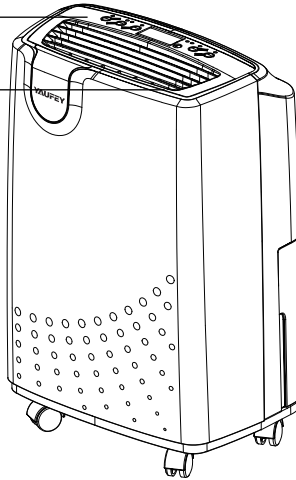

BACK

- Handle
- Filter
- Air Intake Grille
- Humidity Sensor
- Water Tank
- Drain Hose Outlet

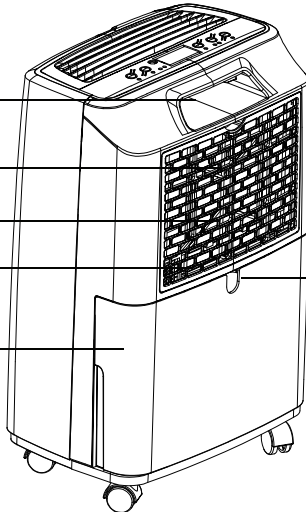

OPERATIONS

TIMER setting: Press and hold the Timer Button to change the delay timer at 1 hour increments up to 24 hours. After TIMER setting, the control will display the remaining time (8,7,6, etc.) until the unit either starts or stops. If you press the TIMER button again, the control will display the room temperature like before. After that, pressing the TIMER button again at any time will stop the TIMER function. For the Delay Start, the fan speed and humidity will maintain the same as the previous setting. Adjusting the timer setting to 0.0 will cancel the Auto Start/Stop function.

NOTE:

Before entering TIMER setting, please make sure the dehumidifier has been connected to the power source.

Before entering TIMER setting, please press Setting Button to set a desired room humidity first.

4. Speed Button

Control the fan speed. Press this button to select either High or Normal fan speed. A higher fan speed will result in quicker moisture removal. Set the fan control to high for maximum moisture removal. When the humidity has been reduced and quiet operation is preferred, set the fan control to normal.

5. “Tank Full” Indicator Light

When the water tank is full, the light will flash and the machine will automatically shut down. After the water in the water tank is emptied, please put the water tank back in place, then the indicator light will turn off, and the machine will restart.

6. Auto Defrost Feature

When the dehumidifier is running at a lower temperature, the system will automatically determine if there is frost, and if frost is present, it will automatically defrost.

Defrost action: The fan runs at a high speed while the compressor stops, and the LCD screen display the defrosting symbol.

CONTROL PANEL

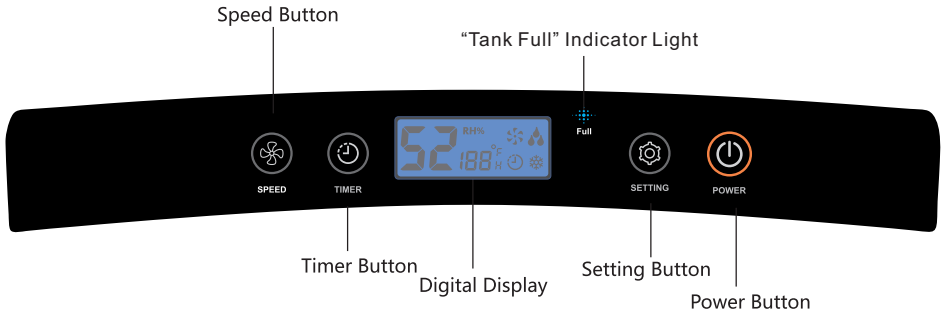

1. Power Button

Press this button to turn the dehumidifier on and off.

2. Setting Button

The humidity level can be set within a range of 30%RH to 80%RH in 5% increments. When the dehumidifier starts to work, it will first automatically detect and show the humidity (and temperature) in the room, then you can press and hold the Setting Buttons to change the humidity to 5% increments. (After you have set the desired humidity, the display will show the actual room humidity.) When the room humidity is over or below your set humidity, the dehumidifier will automatically begin to work or stop. When the humidity level is set at 30%RH, the dehumidifier will be at CONTINUOUS dehumidifying mode.

3. Timer Button

The TIMER function enables you to either Delay Start or Delay Stop the unit in the choice from 1 hour to 24 hours. If the unit is running, then selecting Timer will turn the unit off in the hours that will be set (Delay Stop). If the unit is off, then selecting Timer will turn the unit on in the hours that will be set (Delay Start).

OPERATIONS

Action Description

Power on:

The compressor will start to work after the fan works for a few seconds.

Power off:

The compressor will shut down at once and the fan will stop after a few seconds (when other malfunctions occur or humidity reaches the desired level, the fan will stop after ten seconds).

Tips: The compressor features "3 minutes delay protection" function. While the dehumidifier is powered, the compressor can only start again three minutes after its last shutdown.

Fault & Protection Codes:

Problems	Analysis of Causes	Solutions
Humidity always shows "25% RH" but there is a big difference from the actual humidity.	Does the humidity sensor fail?	Set the humidity to 30% RH and check if the dehumidifier can work normally. If it does, the machine is in a good condition.
		Repair or replace the humidity sensor.
Humidity always shows "99% RH" but there is a big difference from the actual humidity.	Is there some water on the surface of the humidity sensor?	The dehumidifier can work normally. The moisture removal effect is not affected.
		Please keep the machine working for a while to remove the water on the humidity sensor surface. The machine will work normally when the water is removed.
		Repair or replace the humidity sensor.

If the malfunctions still exist, please don't hesitate to contact Yuafey Customer Service at support@yuafe.com for help.

Notice:

Before turning on the machine, please be sure to have opened the air outlet. Otherwise, the machine will overheat. Do not unplug the power cord directly to turn off the machine.

OPERATIONS

REMOVING THE COLLECTED WATER

There are two ways to remove collected water:

1. Use the bucket

1. Take out the water bucket.
2. Empty the water bucket.
3. Put the water bucket back to its proper position.

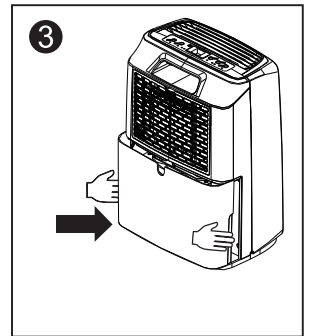
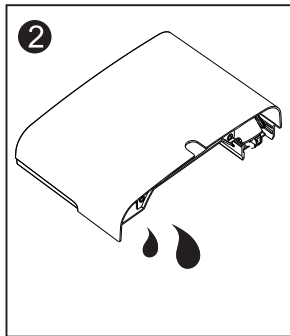
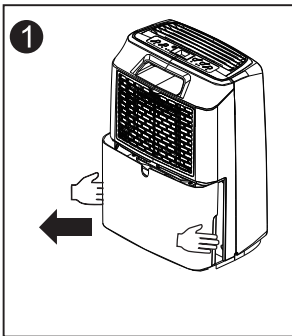

NOTE:

Put the empty bucket back into the unit and once seated correctly, the unit will start up again.

You should hear a click when the bucket is in the correct position. Do not remove the float in the bucket, otherwise the sensor will not be able to sense the water level properly, resulting in that the water will overflow from the bucket when the bucket is full.

Caution: Please place the water tank in the right position. Otherwise, it may cause full tank alert.

OPERATIONS

2. Continuous Draining

You can connect a drain pipe to the continuous drain port to continuously drain the water from the water tank.

(Note: The continuous drain port diameter is 0.63inch.)

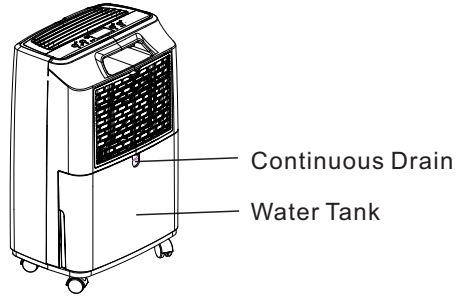

3. Continuous Drain Pipe Installation

Picture 1: Example of improper installation.

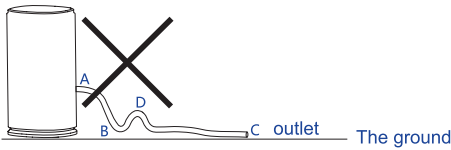

- The drain pipe arches upward at point D higher than point B. Air and water are prone to appear in the water pipe, which makes the water unable to be drained out smoothly through the pipe.

Picture 2: Example of improper installation.

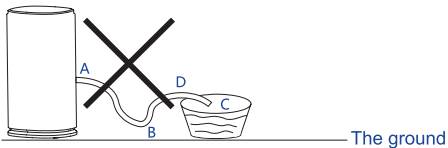

- The contacting point D between the drain pipe and the container is lower than the continuous drain port A, but higher than the lowest point B of the pipe. Air and water are prone to appear in the water pipe, which makes the water unable to be drained out smoothly through the pipe.
- The water outlet C of the drain pipe should not be inserted into the water.

Picture 3: Example of proper installation.

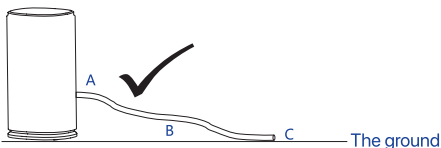

The picture is for reference only.

- The water passes through the continuous drain outlet A all the way to point B and point C. You can use a container to collect the water or drain it into the sewer. (The outlet C should be lower than the continuous drain outlet A at least 3.97 inches, and it is not recommended to extend the original drain pipe).

CARE AND CLEANING

CARE AND CLEANING OF THE DEHUMIDIFIER

WARNING

Turn off the dehumidifier and unplug it from the wall outlet before cleaning.

1. Clean the bucket

Clean the bucket with water every two (2) weeks.

2. Clean the air filter

Clean the filter with clean water at least once every 30 days.

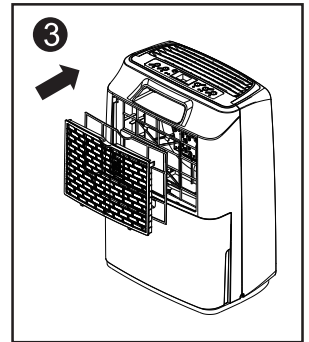
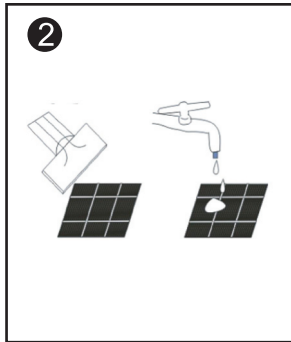
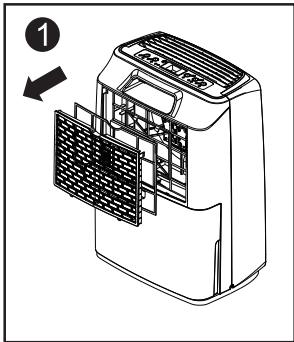

3. Storing the dehumidifier

When not using the dehumidifier for long periods of time.

- After turning off the dehumidifier, wait one day before emptying the bucket.
- Clean the main dehumidifier, bucket and air filter.
- Wrap the cord and bundle it with the band.
- Cover the dehumidifier with a plastic bag.
- Store the dehumidifier upright in a dry, well-ventilated place.

CAUTION:

DO NOT operate the dehumidifier without a filter. Because dirt and lint will clog it and reduce performance.

TROUBLESHOOTING

Before requesting Yaufey customer service, please check the following list for troubleshooting first. These abnormal conditions are not the result of defective workmanship or materials in this dehumidifier.

Problems	Possible Causes	Troubleshooting
Dehumidifier does not work	The power cord is unplugged.	Make sure that the unit's plug is inserted properly into the power outlet.
	Is the full tank indicator flashing? (The tank is full or it is in a wrong position.)	Empty the water in the water tank and then reposition the tank.
	Is the room temperature above 95°F (35°C) or below 41°F (5°C).	The machine cannot work in an overheat or cold environment. It will automatically shutdown to protect itself.
	Is the room temperature between 41°F(5°C) and 68°F(20°C) ?	When running under lower ambient temperature, the machine will automatically defrost, it is a normal phenomenon. Wait until the defrost process finish, it will restart dehumidifying again.
	The dehumidifier is in the defrosting process.	It is normal the compressor ceases while defrosting process. Wait until the defrost process finish, it will restart dehumidifying again.
	Does the room humidity is lower than or reach the preset humidity level? (The room humidity has reached the preset humidity level, the dehumidifier enters into Standby Mode and the the LCD and indicators will flash.)	Please set the humidity 5% lower than the room humidity or set the humidity to 30% RH.
	There is prevent frequent start function in the machine. Dose the machine stop working just now?	Please wait for more than 3 minutes.
	Room humidity is low.	The machine is designed to work in the humidity range of 30% RH to 80% RH. It will not work if the humidity is not within this range.

TROUBLESHOOTING

Dehumidifier does not dry the air as it should	The air filter is dirty.	Clean the air filter.
	Is the air inlet or air outlet obstructed?	Remove the obstruction from the air inlet or outlet.
	The dehumidifier size is too small for application.	Increase the quantity of dehumidifier. Or change a higher capacity dehumidifier.
	Poor air circulation.	Please leave about 7.9inch(20cm) around the product.
	Did not allow enough time to remove the moisture.	Allow enough time to remove the moisture. When first installed, allow at least 3-4 days to maintain the desired RH.
	The room has not been sealed properly.	Check that all doors, windows and other openings are securely closed.
	The room temperature is too low or the ambient temperature is below 41°F (5°C) (The machine will not work or it dehumidifies very slowly in low temperature).	Please wait the temperature rises above 5°C or higher.
The dehumidifier makes loud noise when operating	The dehumidifier is not positioned level.	Move the machine to a horizontal position.
	Is there blocking around the air inlet? The air filter is clogged.	Clean up the dirt on the air inlet and outlet.
	Is the filter installed correctly?	Please check to see if the filter package is removed and it is installed properly.
Dehumidifier operates continuously	Check if the dehumidifier is in CONTINUOUS MODE.	Don't set the humidity too low. Typically, 40-50% are good settings to use.
	Room humidity is too high.	Change humidity settings or replace the machine with a higher-capacity dehumidifier.
	Doors and windows are open.	Ensure that all doors, windows and other openings are closed.

TROUBLESHOOTING

Overflow of water on floor	The connection between the hose and port may be loose.	Connect the hose with the drain outlet tightly.
	The water tank is not installed properly.	Re-install the water bucket properly.
	The float of the water tank has sunk.	Move the float and make sure it can swing freely.
	The magnet on the float has come off.	Put the magnet in right position.

Please contact Yaufey Customer Service at support@yaufey.com if the dehumidifier still does not operate or operate abnormally when you have tried the above solutions.

SPECIFICATIONS

MODEL	PD161D
POWER SOURCE	120V ~ 60Hz
RATED POWER(95°F,90%RH)	200W
RATED CURRENT(95°F,90%RH)	2.0A
MOISTURE REMOVAL(65°F,60%RH)	8.5 Pints/Day(4.0L/Day)
MOISTURE REMOVAL(80 °F,60%RH)	13 Pints/Day(6.15L/Day)
MOISTURE REMOVAL(86 °F,80%RH)	25 Pints/Day(11.8L/Day)
MOISTURE REMOVAL(95 °F,90%RH)	31 Pints/Day(14.7L/Day)
INPUT POWER(65°F,60%RH)	120W
INPUT CURRENT(65°F,60%RH)	1.1A
IEF(65°F,60%RH)	1.30 liters/kWh
MOTOR FLA	0.19A
MOTOR COMPRESSOR	RLA:1.7A LRA:10.0A
REFRIGERANT	R134a/3.88ozs(110g)
MAXIMUM ALLOWABLE PRESSURE	363PSIG(2.5MPa)
HIGH PRESSURE	232PSIG(1.6MPa)
LOW PRESSURE	90PSIG(0.62MPa)

 WARNING:

This product can expose you to chemicals including Styrene and its compounds, which is known to the State of California to cause cancer and birth defects or other reproductive harm. For more information go to: www.P65Warnings.ca.gov

WARRANTY AND CONTACT US

Warranty

Yaufey offers a 12-month warranty to all of our products together with the original proof of purchase when a defect occurred, including those newly purchased and unused, from Yaufey or through an authorized reseller, wholly or substantially, or as a result of faulty manufacturing parts, or workmanship during the Warranty Period.

The warranty does not apply if damage is caused by other factors, including but without limitation of:

- (a) Normal wear and tear;
- (b) Abuse, mishandling, accident or failure to follow operating instructions;
- (c) Exposure to liquid or infiltration of foreign particles;
- (d) Servicing or modification of the product other than by Yaufey.

There are our general terms for the warranty service, but we always encourage our customers to contact us if any issues, regardless of warranty terms. If you are experiencing an issue with Yaufey product, you can reach out to us at support@yaufey.com, we will dedicate our efforts to resolve it for you.)

Extend Your Warranty by 1 Year

Register your product at www.yaufey.com to extend your 1-year warranty by an additional year.

*Please fill out all required fields and include your Order ID, Date of Purchased if applicable.

Customer Support

If you have any questions or concerns about our product, please feel free to contact our expert support team. Yaufey customer service is ready to help.

Yaufey Office

13211, Spring Street Baldwin Park, CA, US

Email: support@yaufey.com

Live Chat: www.yaufey.com

Support Hours

24 Hours available

YAUFEY

For FAQs and more information please visit:

www.yaufey.com



@Yaufey



@Yaufey



@Yaufey



@Yaufey



(Scan the QR Code for Live Chat)

We are expecting to see our products fulfill your life and hear your voice.

Your satisfaction means a lot to us.

Please tag us if you share a snap on your social media.

www.yaufey.com