

USE AND CARE GUIDE

Tilting Wall Mount for Flat Panel TVs *(UNIVERSAL MOUNTING PATTERN, FITS VESA 200/300/400/600)*

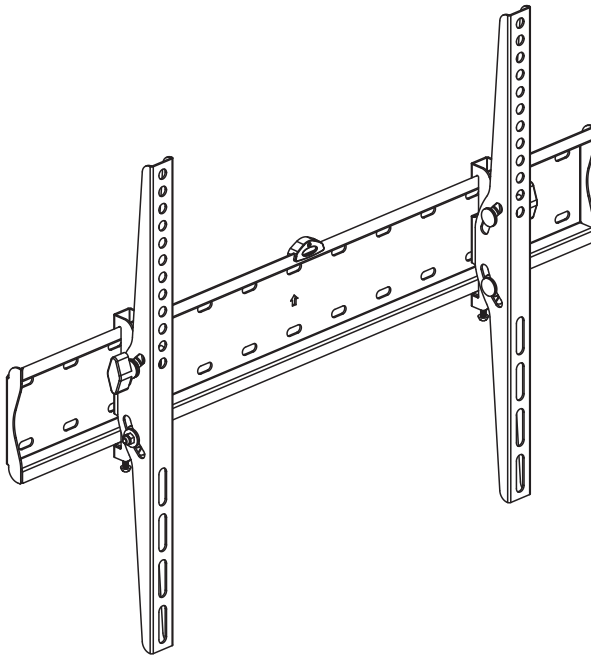

Questions, problems, missing parts? Before returning to the store,
call Commercial Electric Customer Service
8 a.m. - 7 p.m., EST, Monday - Friday, 9 a.m. - 6 p.m., EST, Saturday

1-877-527-0313

HOMEDEPOT.COM

THANK YOU

We appreciate the trust and confidence you have placed in Commercial Electric through the purchase of this wall mounting system. We strive to continually create quality products designed to enhance your home. Visit us online to see our full line of products available for your home improvement needs. Thank you for choosing Commercial Electric!

Table of Contents

Safety Information	2
Tools Required	2
Warranty	2
Hardware Included	3
Package Content	3
Installation	4-7

Safety Information

Before you begin, carefully read and understand the instructions in this manual. Please follow the instructions in the order presented in this manual and observe all warnings and cautions.



WARNING: A Warning alerts you to the possibility of serious injury or death if you do not follow the instructions.



CAUTION: A Caution alerts you to the possibility of damage to or destruction of the equipment if you do not follow the corresponding instructions.



WARNING: Failure to provide adequate structural strength for this component can result in physical injury and/or damage to equipment. It is the installer's responsibility to make sure the structure to which this component is attached can support three times the combined weight of all equipment. Reinforce the structure as required before installing the component.



WARNING: Safety measures must be observed at all times during the installation of this product. Use proper safety gear and tools during the installation process to prevent physical injury.



CAUTION: Do not install on a structure that is prone to vibration, movement, or chance of impact. Doing so could result in damage to the flat panel display and/or mounting surface.



CAUTION: Do not install near a heater, fireplace, direct sunlight, or any other source of direct heat. Doing so could result in damage to the flat panel display and could increase the risk of fire.



WARNING: This wall or ceiling mount is intended for use only with the maximum weights indicated. Use with products heavier than the maximum weights indicated may result in collapse of the mount and its accessories causing possible injury. This mount has been tested to support 100 lbs. (45.36kgs). Use with products heavier than the rated weights indicated may result in instability causing possible injury.

TOOLS REQUIRED (NOT INCLUDED IN THE PACKAGING)

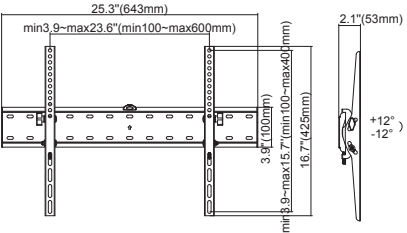
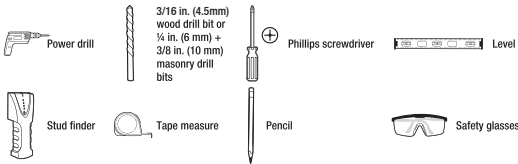

This mount has been tested to support a television with diagonal screen sizes between 37in. and 90in. (94 cm & 2.29 m) and a weight up to 100 lbs. (45.36kgs).

Warranty

The manufacturer warrants that it will replace or repair this item, free of charge, at the manufacturer's sole discretion, should it prove defective in materials or workmanship. This warranty does not apply to:

- Normal wear and tear
- Friction damage
- Coating defects
- Defects caused by loosened screws, nuts, or bolts
- Improperly mounting the bracket to the wall
- Improperly installing the bracket to the display
- Failure to properly follow installation instructions
- Modification or repairs not made or authorized by the manufacturer
- Loading beyond permitted load
- Intentional misuse

Contact the Customer Service Team at 1-877-527-0313 or visit www.HomeDepot.com.

Pre-Installation

HARDWARE INCLUDED

**NOTE:** Hardware not shown to actual size.

**NOTE:** The hardware included is suitable for mounting to walls made of masonry, solid concrete, or wood studs covered with drywall. If your mounting situation is different, please consult a qualified installer or contact customer service at 1-877-527-0313 or visit www.HomeDepot.com.

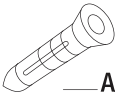

AA



BB



CC



DD



EE



FF

Part	Description	Quantity
AA	Nylon anchor	4
BB	Lag bolt washer	4
CC	Lag bolt	4
DD	Screw (sizes M6x30, M8x30, M8x50)	4 each
EE	Washer (sizes M8)	4
FF	M8 spacer	4

PACKAGE CONTENTS

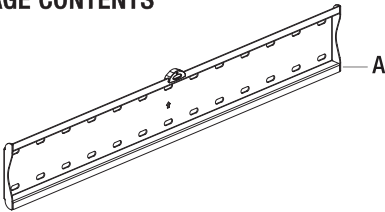

A

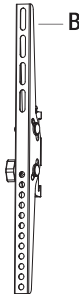

B

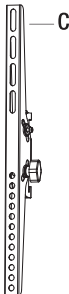

C

Part	Description	Quantity
A	Mounting plate	1
B	Left mounting bracket	1
C	Right mounting bracket	1

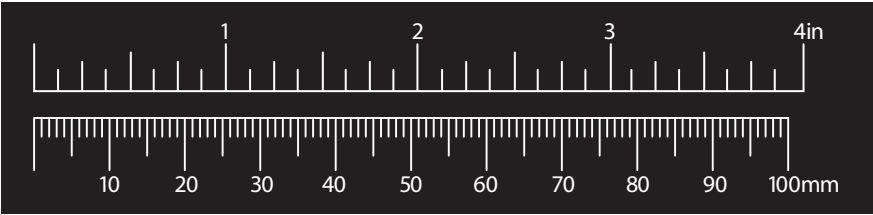

Installation

1 Identifying the screw diameter to use

To ensure proper mounting of the brackets to your TV, this mounting system includes several sizes (M6 and M8) of screws (DD), washers (EE), and spacers (FF) that can be used in various combinations. Combinations are determined by the back style of the TV (flat, curved, or recessed) and the diameter and depth of those holes.

- Select the screw diameter to use by inserting the various sized screws (M6 and M8) into the mounting holes in the back of your TV.

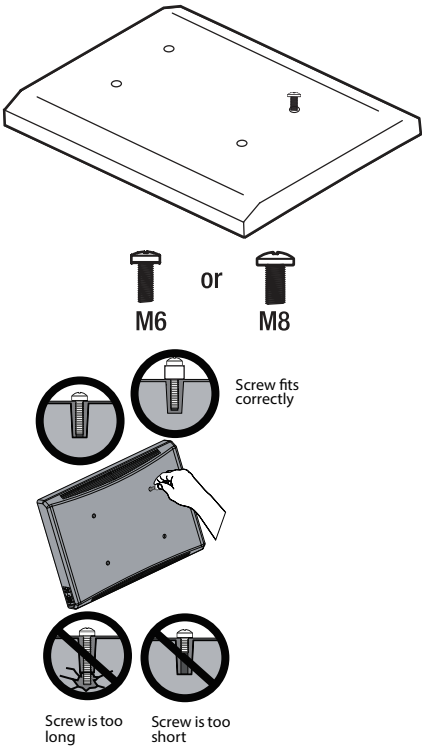

CAUTION: To avoid potential personal injuries and property damage, make sure that there are adequate threads to secure the brackets to your TV. If you encounter resistance, stop immediately and contact customer service. Use the shortest screw and spacer combination to accommodate your TV. Using hardware that is too long may damage your TV. However, using a screw that is too short may cause your TV to fall from the mount.

2 Identifying the screw length to use

- Insert a straw or toothpick into one of the mounting holes on the back of your TV. If your TV is curved or recessed, place the proper sized spacer on top of one of the mounting holes first.
- Use a pencil to mark the depth of the mounting hole.
- Determine the proper screw length to use by comparing the mark with the various screws provided.



CAUTION: When the screw is longer than the mark, choose a shorter screw.

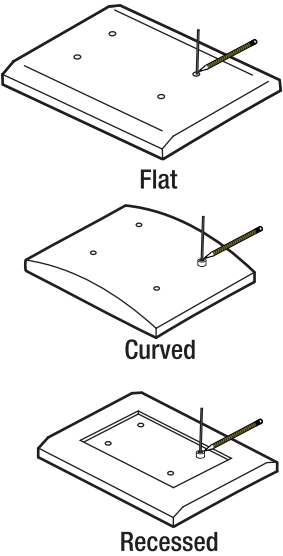

Correct



Incorrect



Installation (continued)

3 Attaching the mounting brackets to the TV

- Attach the mounting brackets (B, C) to the back of the TV using the screws (DD), washers (EE) and spacers (FF) you identified in step 1.

Note: If you use a Samsung TV with deeper VESA holes, please use M8x50 screws and Samsung spacers. (These spacers are included with Samsung TV.)



CAUTION: Tighten the screws so the brackets are firmly attached. DO NOT OVERTIGHTEN. This may damage your TV.

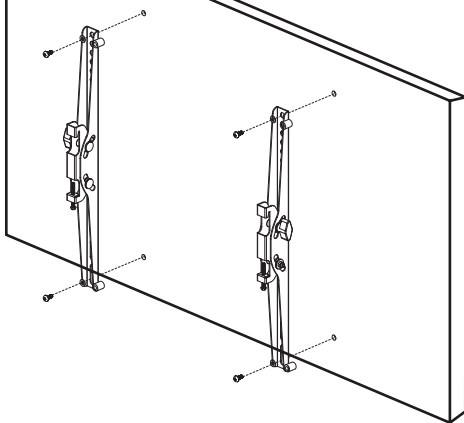
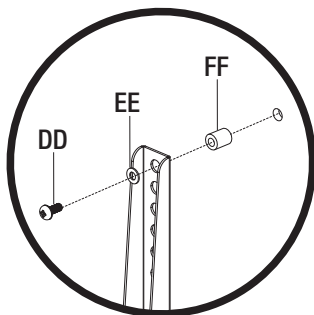

4 PLANNING WALL PLACEMENT



CAUTION: Ensure the wall you select is a weight-bearing wall. Failure to observe this precaution can result in serious physical injury and/or property damage. Consult a professional installer or contact customer service if you have any questions.

When selecting a wall to mount your display, keep the following in mind:

- Select a place with easy access to power outlets, cable input sources, and connections for speakers and accessories.
- Avoid direct sunlight, heat, and vibrations and do not place in direct flow of traffic.
- Select a weight-bearing wall. The wall must be able to safely support four times the combined load of the equipment and all attached hardware and components.

ENSURING WALL STABILITY

Carefully inspect the wall area you have selected. Examine the wall surface before you begin drilling.



WARNING: Do not drill near electrical wiring and water pipes.



CAUTION: Wood studs must be no smaller than 2 x 4 in. in size.

- For concrete walls, check for damaged or loose concrete and do not drill in those areas.
- For masonry wall, never drill into the mortar between blocks.
- For wood studs, locate the wall studs and drill in the center of the stud.

Determine wall-mount location

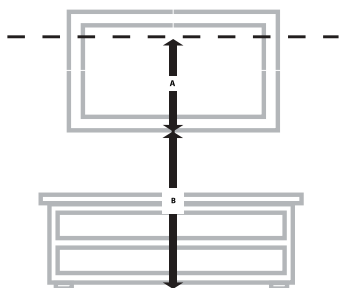

Your TV should be high enough so your eyes are level with the middle of the screen. 40 to 60 in. from the ground.

- 1 Measure the distance from the bottom of your TV to the top of one of the TV brackets you just installed in step 3. This is measurement **a**.
- 2 Measure the distance from the floor to where you want the bottom of the TV to be placed on the wall. Keep in mind that the bottom of the TV should be placed above any furniture (such as entertainment centers or TV stands). The TV should also be above items placed on top of the furniture (like a Blu-ray player or cable box). This measurement is **b**.
- 3 Add **a + b** then subtract 1.5 in. The total measurement is the height where you want the center of the wall plate to be on the wall.
- 4 Use a pencil to mark this spot on the wall.

5 Installing the mounting plate (concrete/masonry wall)

If you are installing this mounting system in wood studs, proceed to step 6.



CAUTION: Avoid drilling near electrical wiring and water pipes. The mounting system must be attached to a weight bearing wall and must be installed directly onto the center of the wood studs. Failure to observe all safety precautions can result in serious physical injury and/or property damage. Consult a professional installer or call customer service if you have any questions.



CAUTION: Do not drill into mortar between masonry blocks or into loose concrete.



CAUTION: Never drill into hollow masonry block.

- Use the mounting plate (A) as a template to mark the installation holes. Use a level to ensure the plate is level.
- Use a 1/4 in. (6 mm) masonry drill bit to slowly drill 2.4 in. (60mm) pilot holes. Then use a 3/8 in. (10 mm) masonry drill bit to expand pilot holes.
- Insert anchors (AA) into the holes. Ensure the anchors are completely flush to the concrete surface even if covered by a layer of joint compound or other material.
- Attach the mounting plate (A) using the lag bolts (CC) and lag bolt washers (BB) as shown.

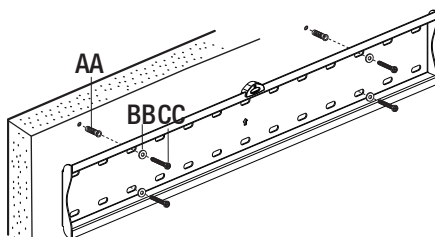
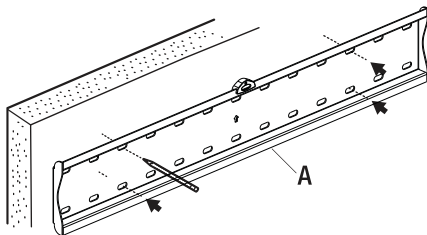

6 Installing the mounting plate (wood stud)



CAUTION: Avoid drilling near electrical wiring and water pipes. The mounting system must be attached to a weight bearing wall and must be installed directly onto the center of the wood studs. Failure to observe all safety precautions can result in serious physical injury and/or property damage. Consult a professional installer or call customer service if you have any questions.



CAUTION: Wood studs must be no smaller than 2 x 4 in. in size.

- Use a commercially-available stud finder to locate the stud centers in the wall. Studs are usually spaced 16 in. apart.
- Use the mounting plate (A) as a template to mark the installation holes. Use a level to ensure the plate is level.
- Use a $\frac{3}{16}$ in. (4.5 mm) wood drill bit to drill 2.2 in. (55 mm) pilot holes.
- Attach the mounting plate (A) using the lag bolts (CC) and lag bolt washers (BB) as shown.

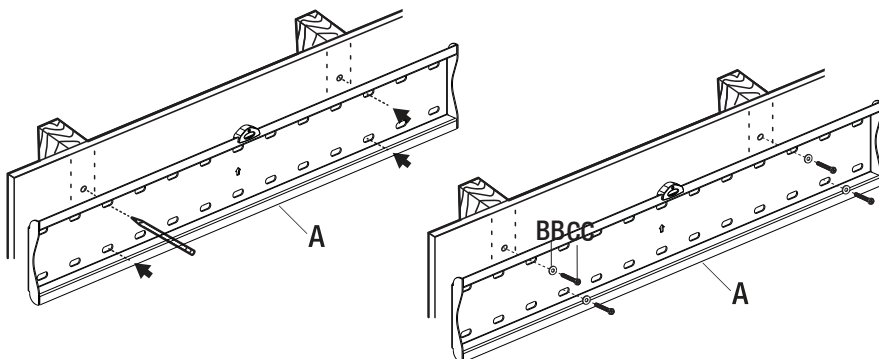

7 Mounting the TV to the mounting plate

- Holding the TV with the top of the screen tilted toward the wall, slide the upper notches of the mounting brackets (B, C) over the upper lip of the mounting plate (A).
- Tighten the two screws on the bottom of the mounting brackets (B, C) as shown to secure the TV.



HEAVY! You will need assistance with this step.

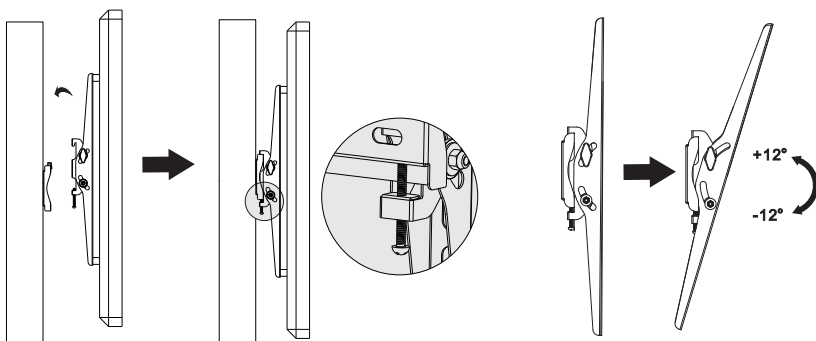



Questions, problems, missing parts? Before returning to the store,
call Commercial Electric Customer Service
8 a.m. - 7 p.m., EST, Monday-Friday, 9 a.m. - 6 p.m., EST, Saturday

1-877-527-0313

HOMEDEPOT.COM

Retain this manual for future use.