



Wood Components (Not to Scale)



D1 | JOIST - W4L13040
(1) | 1 3/8"x5 1/4"x89 1/2" (36x134x2274)



D2 | JOIST - W4L13041
(1) | 1 3/8"x5 1/4"x89 1/2" (36x134x2274)



D3 | JOIST END - W4L13042
(1) | 1 3/8"x5 1/4"x18 3/4" (36x134x477)



D4 | JOIST END - W4L13043
(1) | 1 3/8"x5 1/4"x18 3/4" (36x134x477)



G7 | BEAM END - W4L13048
(1) | 1"x5 1/4"x29" (24x134x736)

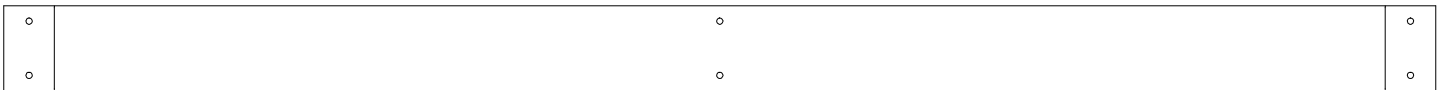

G8 | BEAM - W4L13049
(2) | 1"x5 1/4"x89 1/2" (24x134x2274)



G10 | BEAM - W4L13051
(1) | 1"x5 1/4"x71 1/8" (24x134x1807)



G11 | BEAM END - W4L13052
(1) | 1"x5 1/4"x19" (24x134x484)



G12 | BEAM - W4L13053
(1) | 1"x5 1/4"x61 1/4" (24x134x1555)



Wood Components (Not to Scale)



G13 | BEAM - W4L13054
(1) | 1"x5 1/4"x61 1/4" (24x134x1555)



D5 | SUPPORT BRACE - W4L13055
(2) | 1 3/8"x5 1/4"x4 5/8" (36x134x116)



G14 | BEAM END - W4L13062
(1) | 1"x5 1/4"x29" (24x134x736)



G15 | BEAM END - W4L13063
(1) | 1"x5 1/4"x19" (24x134x484)



G9 | BEAM - W4L13050
(1) | 1"x5 1/4"x71 1/8" (24x134x1807)



E1 | TOP JOIST - W4L13056
(2) | 1 3/8"x3 3/8"x81 1/2" (36x86x2070)



E2 | TOP JOIST - W4L13057
(2) | 1 3/8"x3 3/8"x71 1/2" (36x86x1817)



E3 | TOP JOIST - W4L13058
(2) | 1 3/8"x3 3/8"x61 1/8" (36x86x1553)



E4 | TOP JOIST - W4L13059
(2) | 1 3/8"x3 3/8"x50 3/4" (36x86x1289)



Wood Components (Not to Scale)



E5 | TOP JOIST - W4L13060
(2) | 1 3/8"x3 3/8"x40 3/8" (36x86x1025)

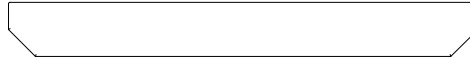

E6 | TOP JOIST - W4L13061
(2) | 1 3/8"x3 3/8"x30" (36x86x761)



F1 | CLEAT - W4L13044
(4) | 1 3/8"x2 3/8"x53" (36x60x1345)



G1 | RAIL - W4L13045
(1) | 1"x5 1/4"x78 7/8" (24x134x2002)



G2 | TOP RAIL - W4L13047
(2) | 1"x5 1/4"x78 7/8" (24x134x2002)

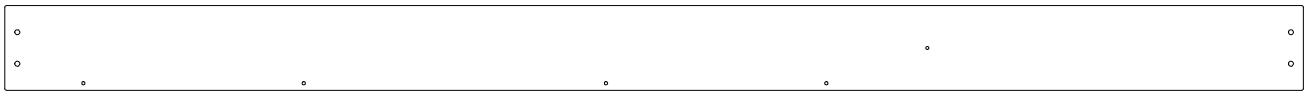

G3 | TOP RAIL - W4L13064
(1) | 1"x5 1/4"x81 1/4" (24x134x2063)



G4 | RAIL - W4L13065
(1) | 1"x5 1/4"x78 7/8" (24x134x2002)

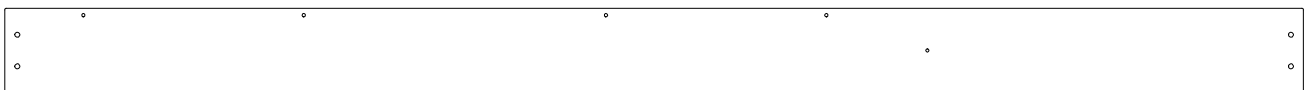

G5 | TOP RAIL - W4L13066
(1) | 1"x5 1/4"x81 1/4" (24x134x2063)



G6 | RAIL - W4L13067
(2) | 1"x5 1/4"x81 1/4" (24x134x2063)



H1 | RAIL - W4L13046
(12) | 1"x3 3/8"x78 7/8" (24x86x2002)



Wood Components (Not to Scale)

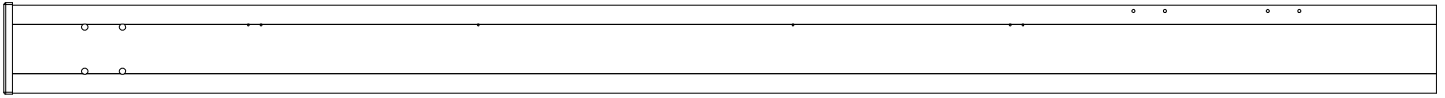

WP1 | PERGOLA POST - W2A02922
(1) | 5 1/2"x5 1/2"x89 1/2" (140x140x2274)

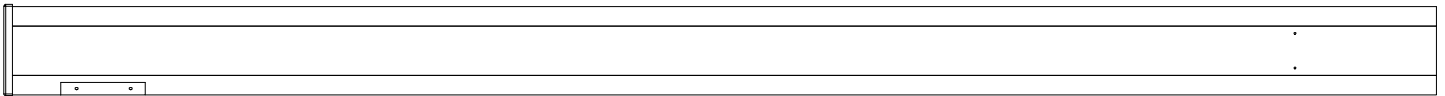

WP2 | PERGOLA POST - W2A02923
(1) | 5 1/2"x5 1/2"x89 1/2" (140x140x2274)

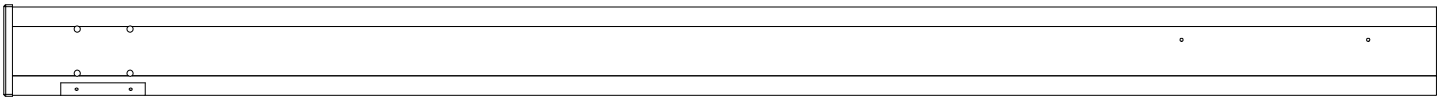

WP3 | PERGOLA POST - W2A02924
(1) | 5 1/2"x5 1/2"x89 1/2" (140x140x2274)



Wood Components (Not to Scale)

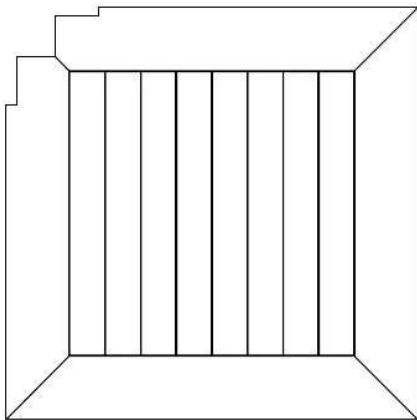

TT1 | TABLE TOP - W2A02925
(1) | 1 5/16"x30 1/8"x30 1/8" (34x765x765)

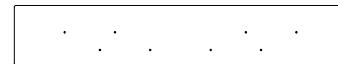

D7 | ARM REST - W4L13068
(2) | 1 3/8"x5"x26" (36x126x660)



Hardware Components



H100387 | SCREW PFH BLK
(68) | 8x1-1/4



H100200 | SCREW PFH BLK
(13) | 8x1 1/2



H100391 | SCREW PFH BLK
(26) | 8x2



H100120 | SCREW CONCRETE ANCHOR
(13) | 1/4x2



H100486 | BOLT WH BLK
(18) | 1/4x5/8



H100403 | LAG SCREW WH BLK
(18) | 1/4x1 1/2



H100407 | BOLT WH BLK
(13) | 5/16x1-1/2

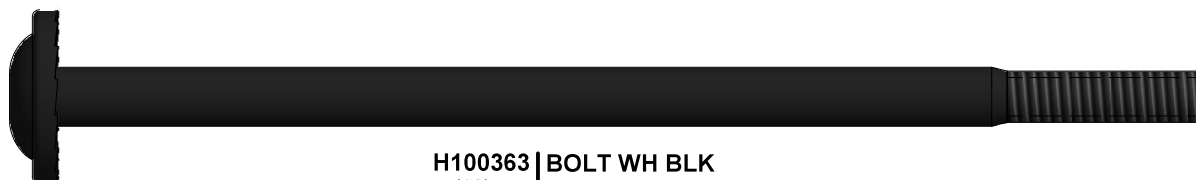

H100363 | BOLT WH BLK
(18) | 5/16X6



H100202 | SCREW PWH BLK
(164) | 8x5/8



H100392 | SCREW PWH BLK
(4) | 8x3/4

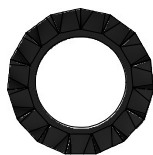

H100199 | WASHER LOCK EXT BLK
(30) | 12x19

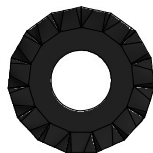

H100198 | WASHER LOCK EXT BLK
(76) | 8x19

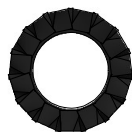

H100400 | WASHER LOCK EXT BLK
(17) | 8x15



H100399 | NUT BARREL WH BLK
(18) | 1/4x7/8

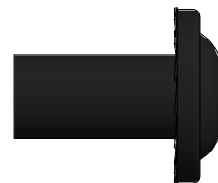

H100192 | NUT BARREL WH BLK
(13) | 5/16x7/8



H100193 | NUT BARREL WH BLK
(18) | 5/16x1-1/2



Hardware Components



H100197 | LAG SCREW WH BLK
(4) | 5/16x2 1/2



H100206 | LAG SCREW WH
(4) | 5/16x3



H100825 | LAG SCREW
(38) | 5/16x4 BLK



H100764 | SCREW SETTER
(1)



A100042 | TORX BIT
(2) | T-40



H100147 | TORX BIT
(2) | T-30

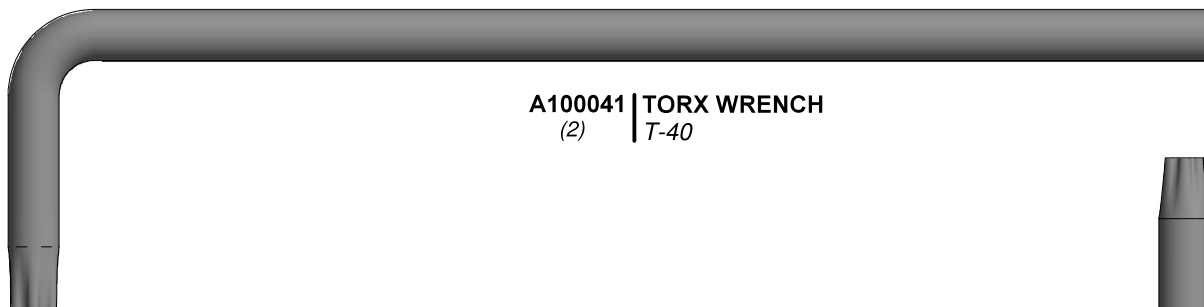

A100041 | TORX WRENCH
(2) | T-40



H100114 | TORX WRENCH
(2) | T-30



Accessory Components (Not to Scale)

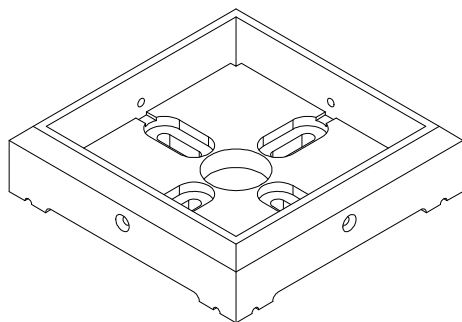

A100029 | FOOT 142 SQUARE POST
(3)



A100241 | BYD ID TAG (SMALL) WITHOUT AGES
(1)

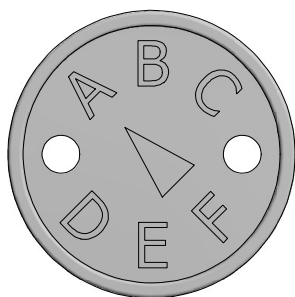

A100314 | "A" REVISION TAG
(1)

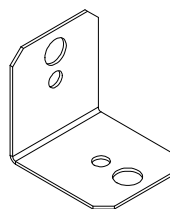

A4M00555 | 90° L-BRACKET - BLK
(8)

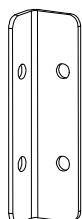

A4M01108 | L BRACKET 24x30x112 - BLK
(8)

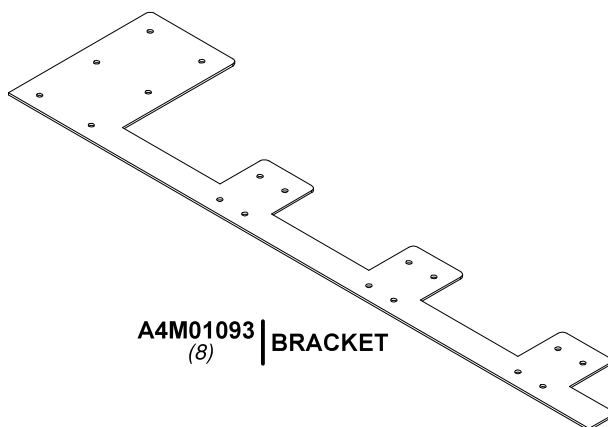

A4M01093 | BRACKET
(8)

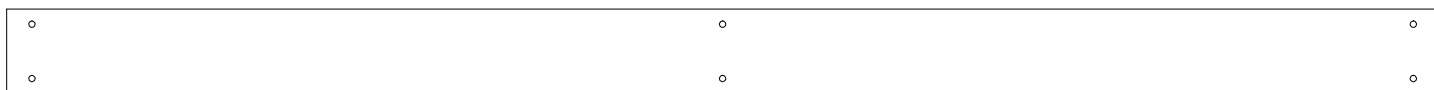

A4M01111 | METAL BEAM
(2)



Accessory Components (Not to Scale)

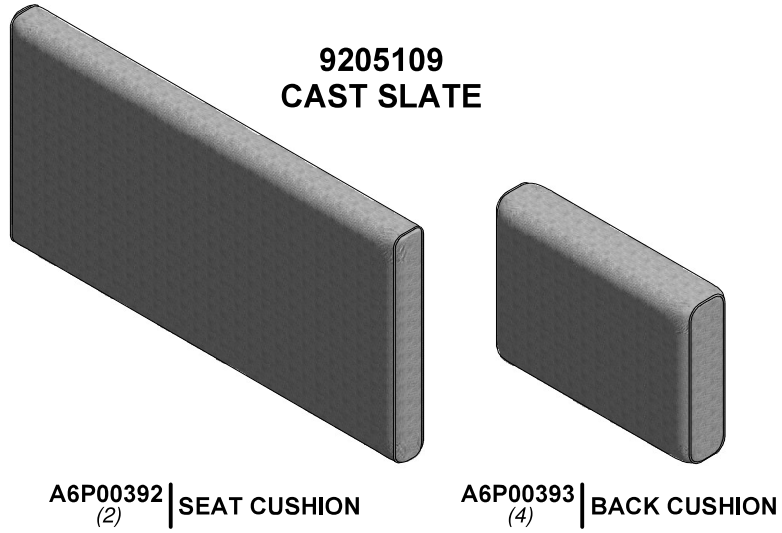

OR

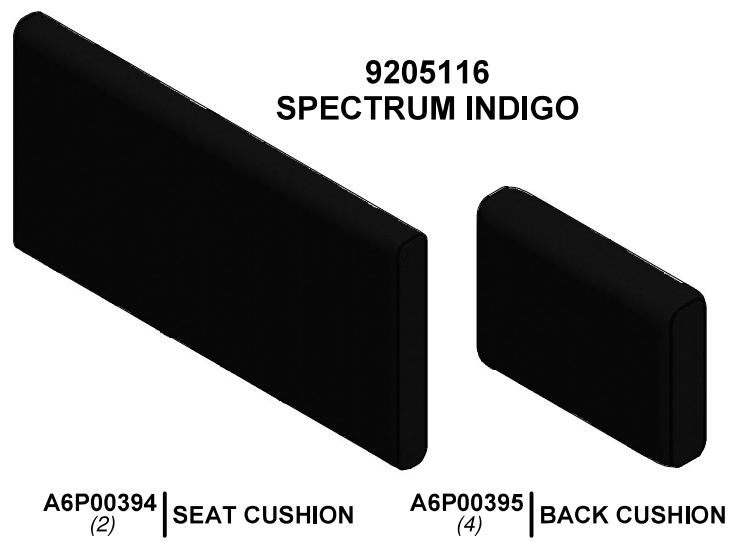



Accessory Components (Not to Scale)

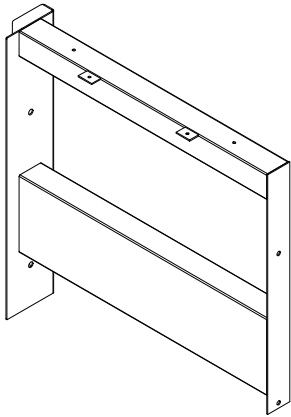

A4M01060 (1) | FRAME END - LEFT

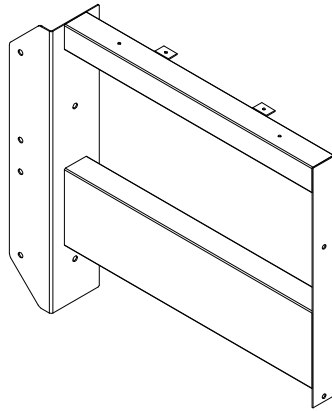

A4M01066 (1) | FRAME END - RIGHT

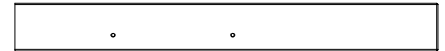

A4M01063 (1) | POST



A4M01069 (1) | POST



A4M01070 (1) | POST



A4M01105 (1) | ARM POST - RIGHT



A4M01106 (1) | ARM POST - LEFT

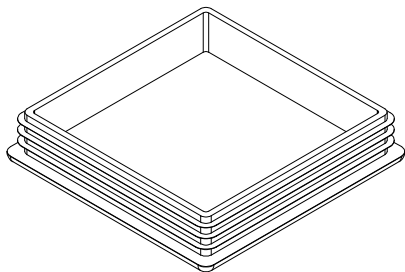

A6P00377 (5) | SNAP-IN SQUARE PLUG

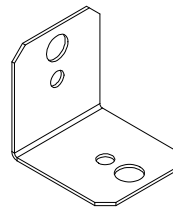

A4M00555 (2) | 90° L-BRACKET - BLK

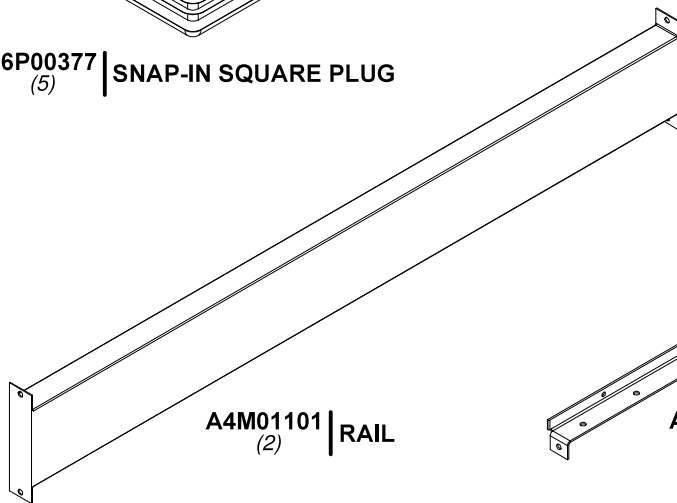

A4M01101 (2) | RAIL

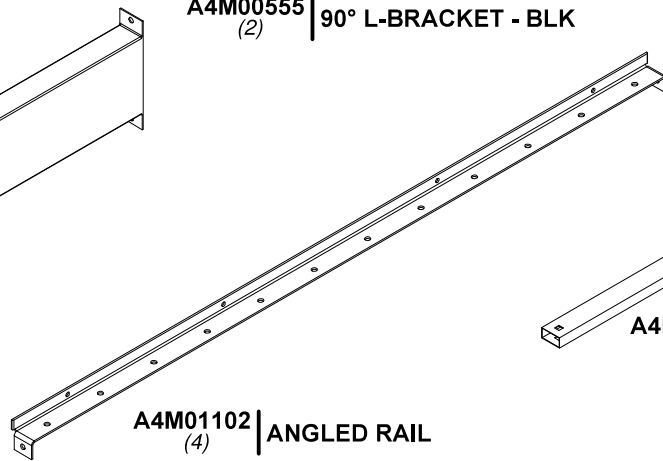

A4M01102 (4) | ANGLED RAIL

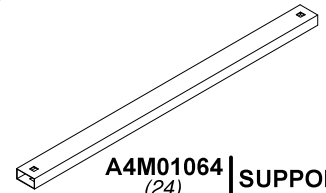

A4M01064 (24) | SUPPORT

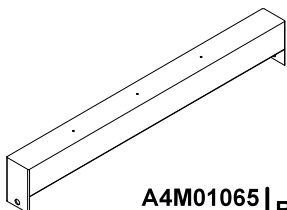

A4M01065 (2) | RAIL

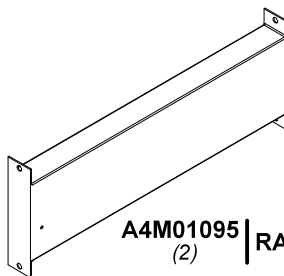

A4M01095 (2) | RAIL



Hardware Components



H100712 | BOLT CARRIAGE BLK
(50) | 5/16x1 1/2

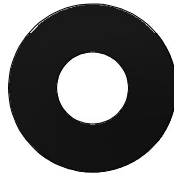

H100770 | WASHER FLAT
(52) | 5/16 BLK

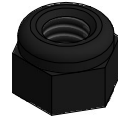

H100479 | NUT LOCK BLK
(50) | 5/16



H100471 | LAG SCREW WH BLK
(11) | 5/16x1 1/2



H100171 | BOLT WH BLK
(38) | 1/4x1



H100460 | LAG SCREW WH BLK
(11) | 1/4x1



H100824 | SCREW PWH BLK
(11) | 8x3



H100392 | SCREW PWH BLK
(4) | 8x3/4



H100202 | SCREW PWH BLK
(4) | 8x5/8



H100391 | SCREW PFH BLK
(7) | 8x2



STEP 1

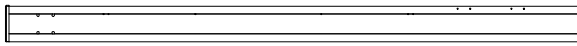

WP1 PERGOLA POST - W2A02922
(1) 5 1/2"x5 1/2"x89 1/2" (140x140x2274)

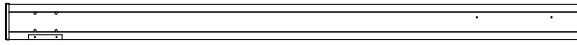

WP3 PERGOLA POST - W2A02924
(1) 5 1/2"x5 1/2"x89 1/2" (140x140x2274)

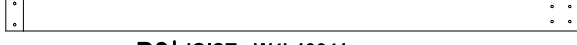

D2 JOIST - W4L13041
(1) 1 3/8"x5 1/4"x89 1/2" (36x134x2274)

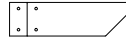

D4 JOIST END - W4L13043
(1) 1 3/8"x5 1/4"x18 3/4" (36x134x477)

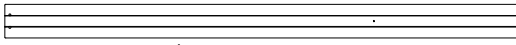

G5 TOP RAIL - W4L13066
(1) 1"x5 1/4"x81 1/4" (24x134x2063)

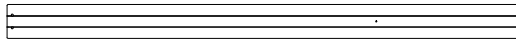

G6 RAIL - W4L13067
(1) 1"x5 1/4"x81 1/4" (24x134x2063)



A4M01108 L BRACKET 24x30x112 - BLK
(4)



H100486 BOLT WH BLK
(8) 1/4x5/8



H100400 WASHER LOCK EXT BLK
(8) 8x15



H100399 NUT BARREL WH BLK
(8) 1/4x7/8



H100403 LAG SCREW WH BLK
(8) 1/4x1 1/2



H100363 BOLT WH BLK
(8) 5/16x6



H100198 WASHER LOCK EXT BLK
(8) 8x19



H100199 WASHER LOCK EXT BLK
(8) 12x19



H100193 NUT BARREL WH BLK
(8) 5/16x1-1/2



ASSEMBLY TIP:

FOR EASE OF ASSEMBLY WE RECOMMEND USING SAW HORSES FOR THIS STEP.

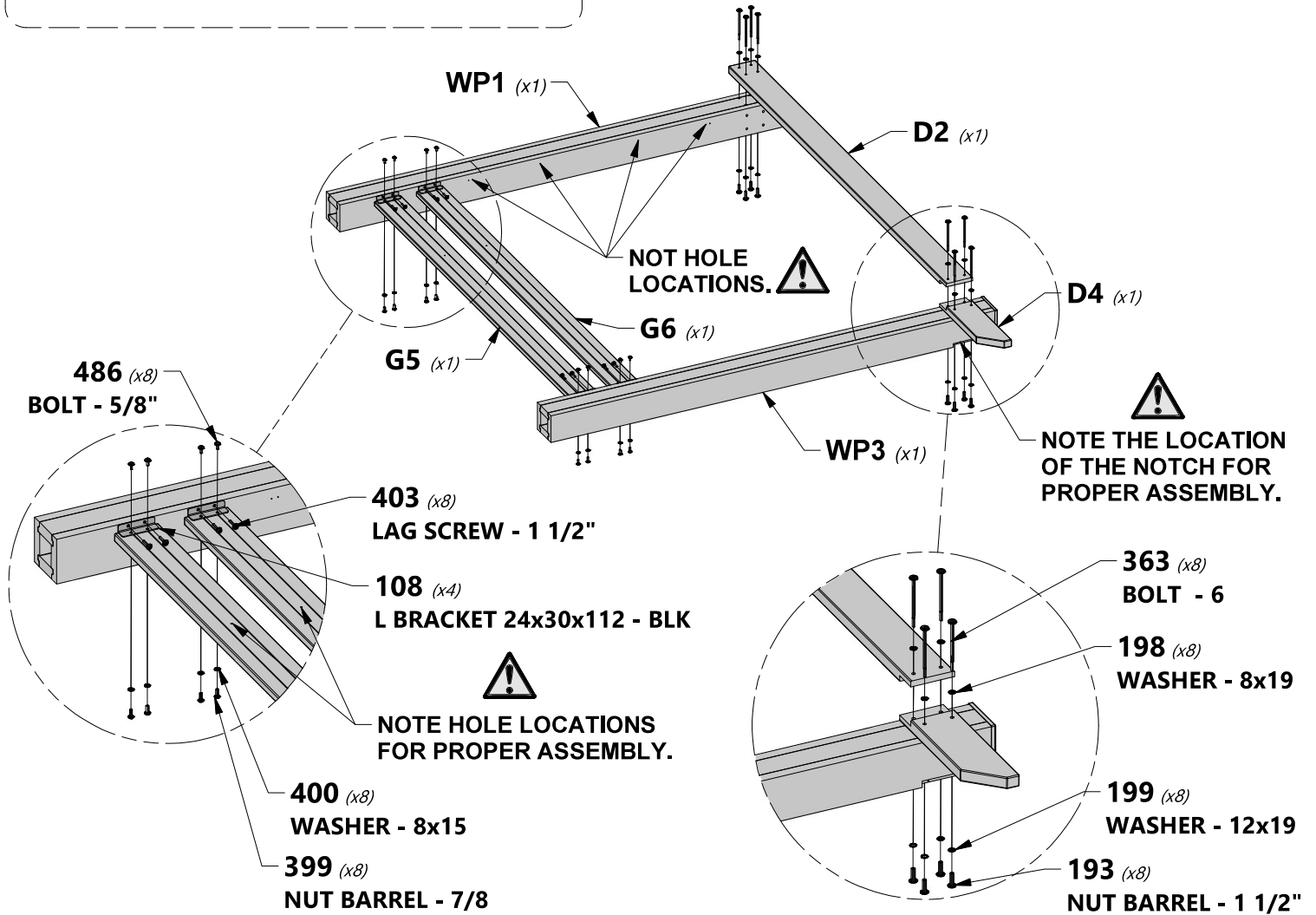



STEP 2



WP2 PERGOLA POST - W2A02923
(1) 5 1/2"x5 1/2"x89 1/2" (140x140x2274)



D1 JOIST - W4L13040
(1) 1 3/8"x5 1/4"x89 1/2" (36x134x2274)

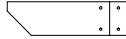

D3 JOIST END - W4L13042
(1) 1 3/8"x5 1/4"x18 3/4" (36x134x477)

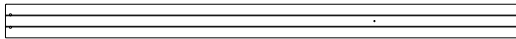

G3 TOP RAIL - W4L13064
(1) 1"x5 1/4"x81 1/4" (24x134x2063)



G6 RAIL - W4L13067
(1) 1"x5 1/4"x81 1/4" (24x134x2063)



A4M01108 L BRACKET 24x30x112 - BLK
(4)



H100486 BOLT WH BLK
(8) 1/4x5/8



H100400 WASHER LOCK EXT BLK
(8) 8x15



H100399 NUT BARREL WH BLK
(8) 1/4x7/8



H100403 LAG SCREW WH BLK
(8) 1/4x1 1/2



H100363 BOLT WH BLK
(8) 5/16x6



H100198 WASHER LOCK EXT BLK
(8) 8x19



H100199 WASHER LOCK EXT BLK
(8) 12x19



H100193 NUT BARREL WH BLK
(8) 5/16x1-1/2



193 (x8) NUT BARREL - 1 1/2"

199 (x8) WASHER - 12x19



NOTE THE LOCATION OF THE NOTCH FOR PROPER ASSEMBLY.

WP2 (x1) PERGOLA POST

399 (x8) NUT BARREL - 7/8

400 (x8) WASHER - 8x15

363 (x8) BOLT - 6

198 (x8) WASHER - 8x19

D3 (x1)

D1 (x1)

G6 (x1)

G3 (x1)

486 (x8) BOLT - 5/8"

403 (x8) LAG SCREW - 1 1/2"



NOTE HOLE LOCATIONS FOR PROPER ASSEMBLY.

108 (x4) L BRACKET 24x30x112 - BLK



STEP 3

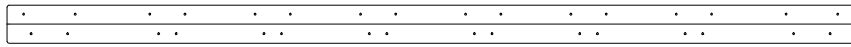

F1 | CLEAT - W4L13044
(4) | 1 3/8"x2 3/8"x53" (36x60x1345)



H100391 | SCREW PFH BLK
(24) | 8x2



NOTE DIRECTION
OF THE NOTCH.



LOCATE AND ALIGN
WITH PILOT HOLES FOR
PROPER ASSEMBLY.

391 (x24)
SCREW - 2"

F1 (x4)

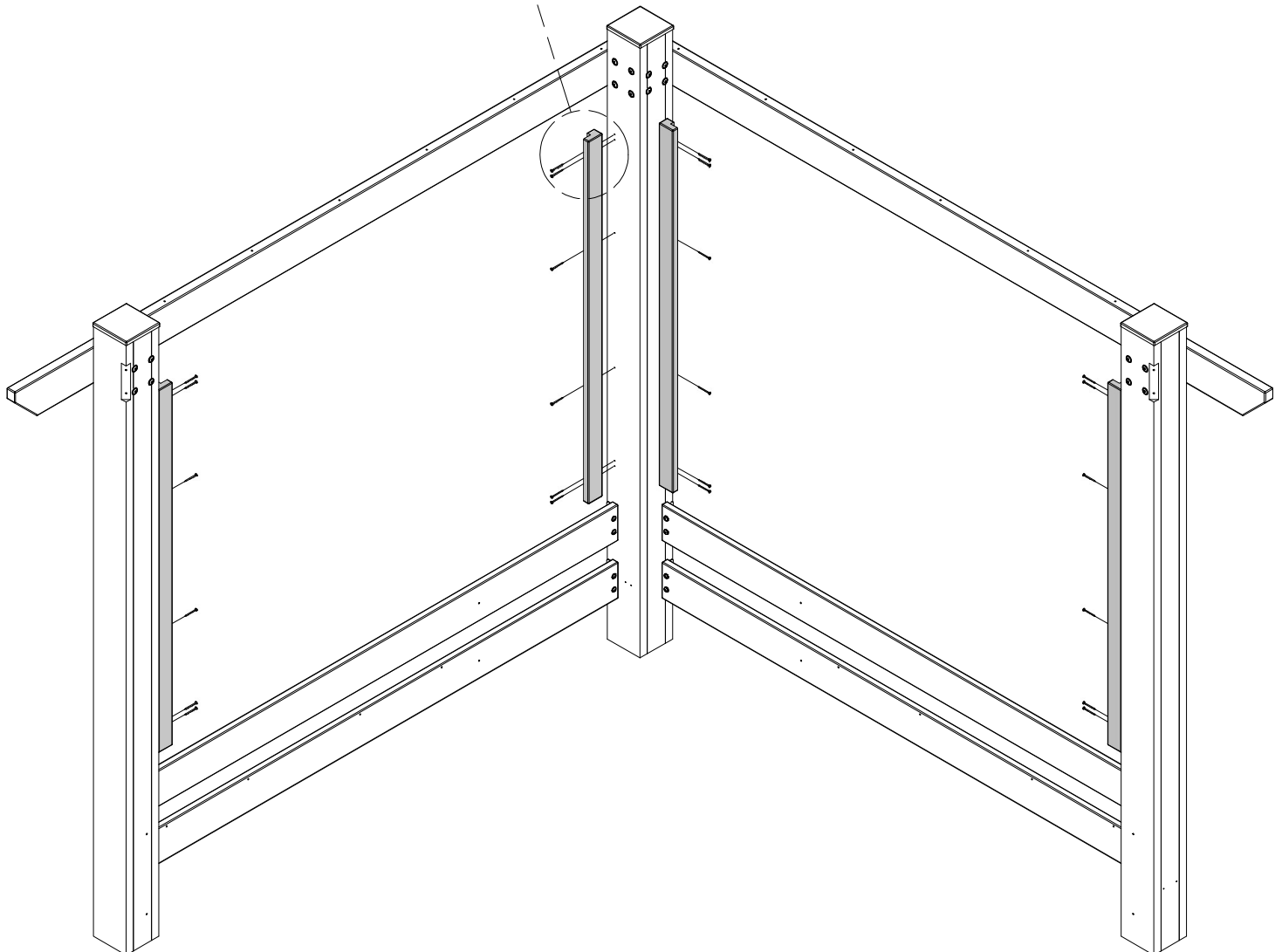



STEP 4

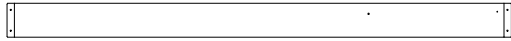

G1 | RAIL - W4L13045
(1) | 1"x5 1/4"x78 7/8" (24x134x2002)

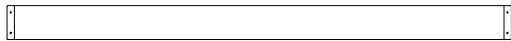

G2 | TOP RAIL - W4L13047
(2) | 1"x5 1/4"x78 7/8" (24x134x2002)

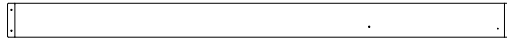

G4 | RAIL - W4L13065
(1) | 1"x5 1/4"x78 7/8" (24x134x2002)

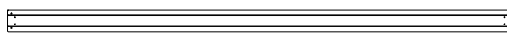

H1 | RAIL - W4L13046
(12) | 1"x3 3/8"x78 7/8" (24x86x2002)



H100387 | SCREW PFH BLK
(64) | 8x1-1/4

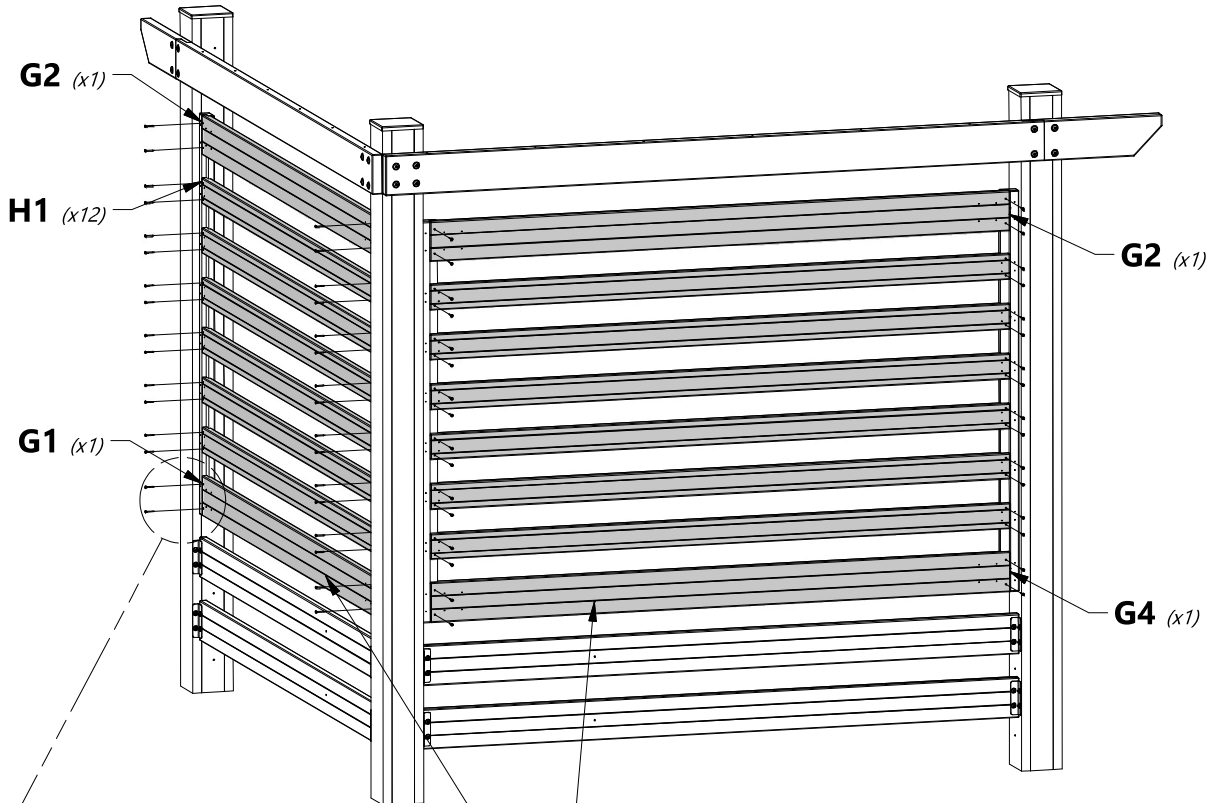

NOTE HOLE LOCATION FOR PROPER ASSEMBLY.

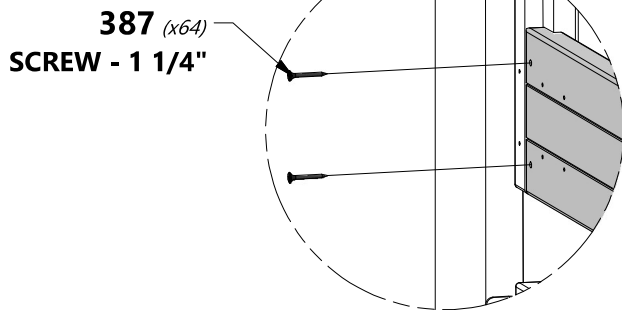



STEP 5

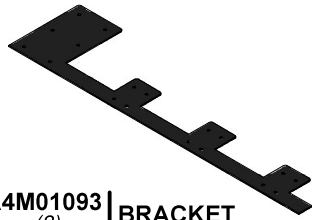

A4M01093 | BRACKET
(8)



H100202 | SCREW PWH BLK
(144) | 8x5/8

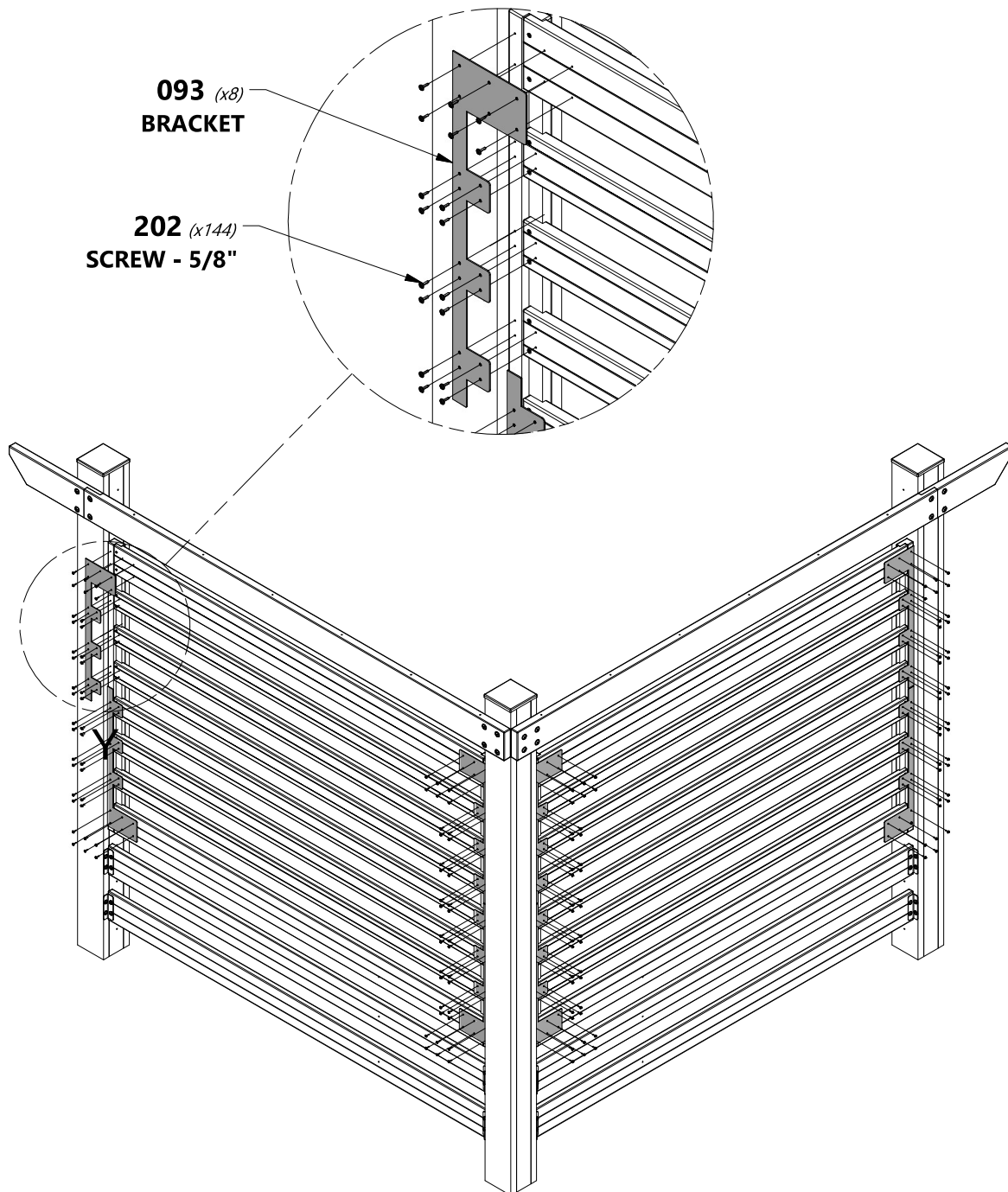



STEP 6

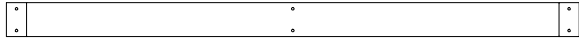

G8 | BEAM - W4L13049
(1) | 1"x5 1/4"x89 1/2" (24x134x2274)



G10 | BEAM - W4L13051
(1) | 1"x5 1/4"x71 1/8" (24x134x1807)



G9 | BEAM - W4L13050
(1) | 1"x5 1/4"x71 1/8" (24x134x1807)

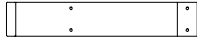

G7 | BEAM END - W4L13048
(1) | 1"x5 1/4"x29" (24x134x736)

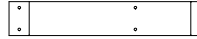

G14 | BEAM END - W4L13062
(1) | 1"x5 1/4"x29" (24x134x736)

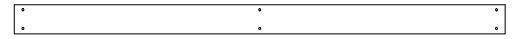

A4M01111 | METAL BEAM
(1)



H100407 | BOLT WH BLK
(6) | 5/16x1-1/2



H100198 | WASHER LOCK EXT BLK
(6) | 8x19



H100199 | WASHER LOCK EXT BLK
(6) | 12x19



H100192 | NUT BARREL WH BLK
(6) | 5/16x7/8

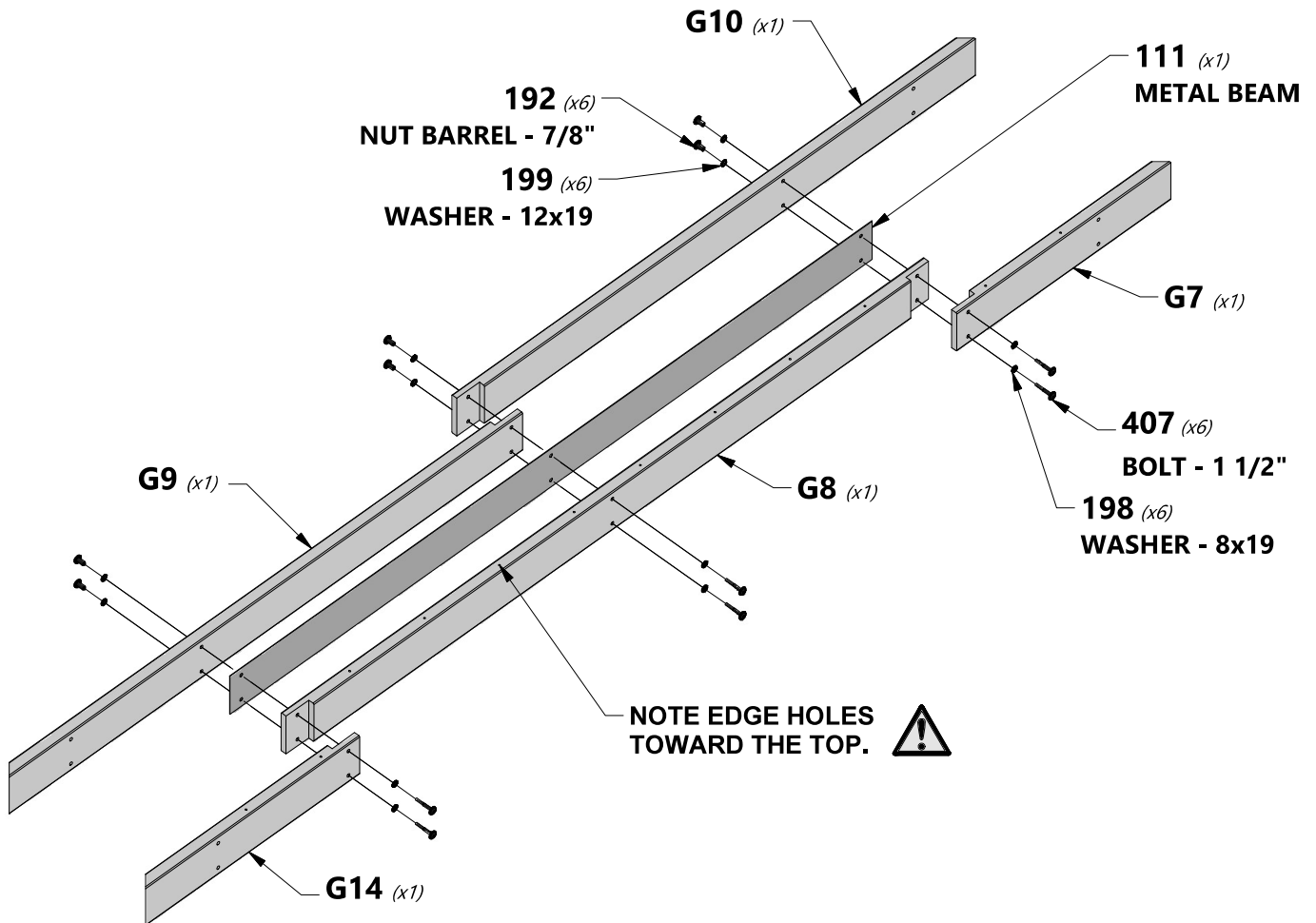



STEP 7

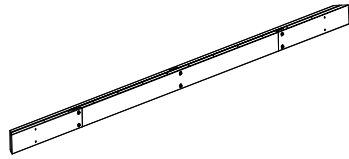

(1) **FRONT BEAM SUBASSEMBLY**
(FROM STEP 6).



H100206 | **LAG SCREW WH**
(4) | **5/16x3**



H100198 | **WASHER LOCK EXT BLK**
(4) | **8x19**

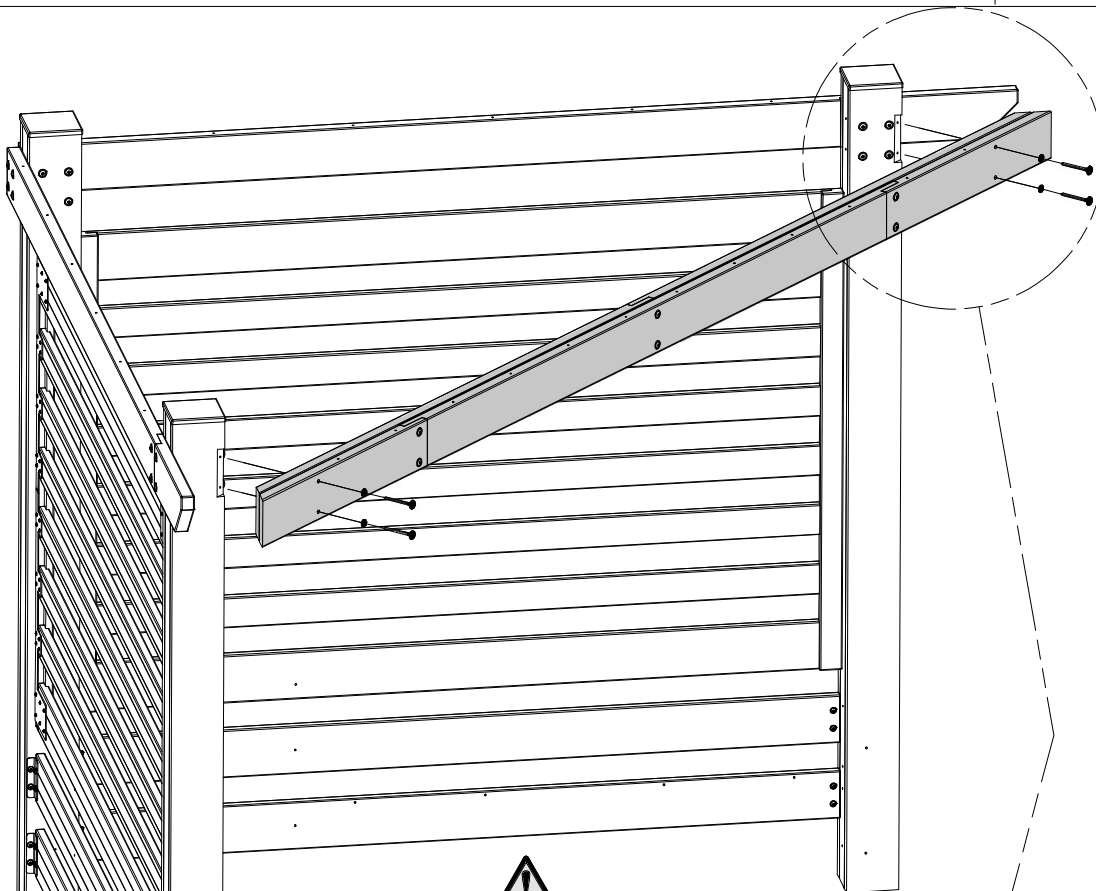

**ALIGN HOLES IN BEAM
WITH HOLE LOCATED
IN NOTCH.**



**EDGE HOLES TOWARD
THE TOP OF THE BEAM.**

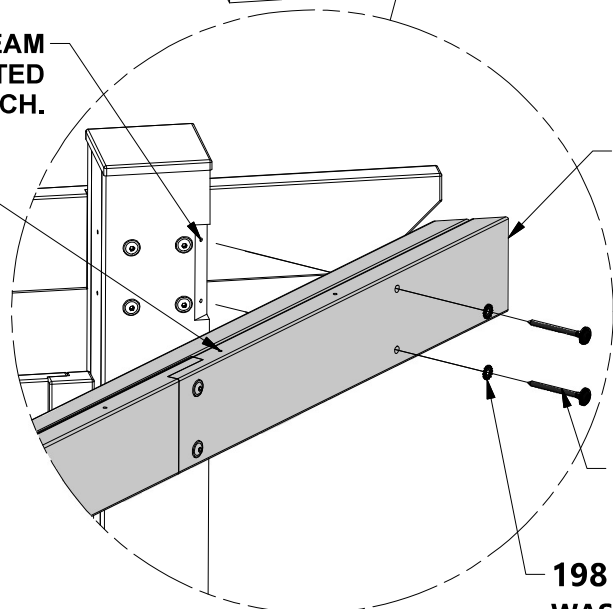

BEAM SUBASSEMBLY
(FROM STEP 6).

206 (x4)
LAG - 3"

198 (x4)
WASHER - 8x19



STEP 8

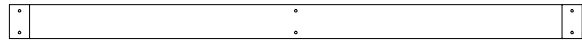

G8 | BEAM - W4L13049
(1) | 1"x5 1/4"x89 1/2" (24x134x2274)



G12 | BEAM - W4L13053
(1) | 1"x5 1/4"x61 1/4" (24x134x1555)

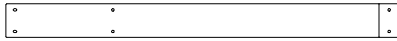

G13 | BEAM - W4L13054
(1) | 1"x5 1/4"x61 1/4" (24x134x1555)



G11 | BEAM END - W4L13052
(1) | 1"x5 1/4"x19" (24x134x484)

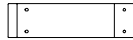

G15 | BEAM END - W4L13063
(1) | 1"x5 1/4"x19" (24x134x484)

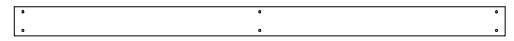

A4M01111 | METAL BEAM
(1)



H100407 | BOLT WH BLK
(6) | 5/16x1-1/2



H100198 | WASHER LOCK EXT BLK
(6) | 8x19



H100199 | WASHER LOCK EXT BLK
(6) | 12x19



H100192 | NUT BARREL WH BLK
(6) | 5/16x7/8

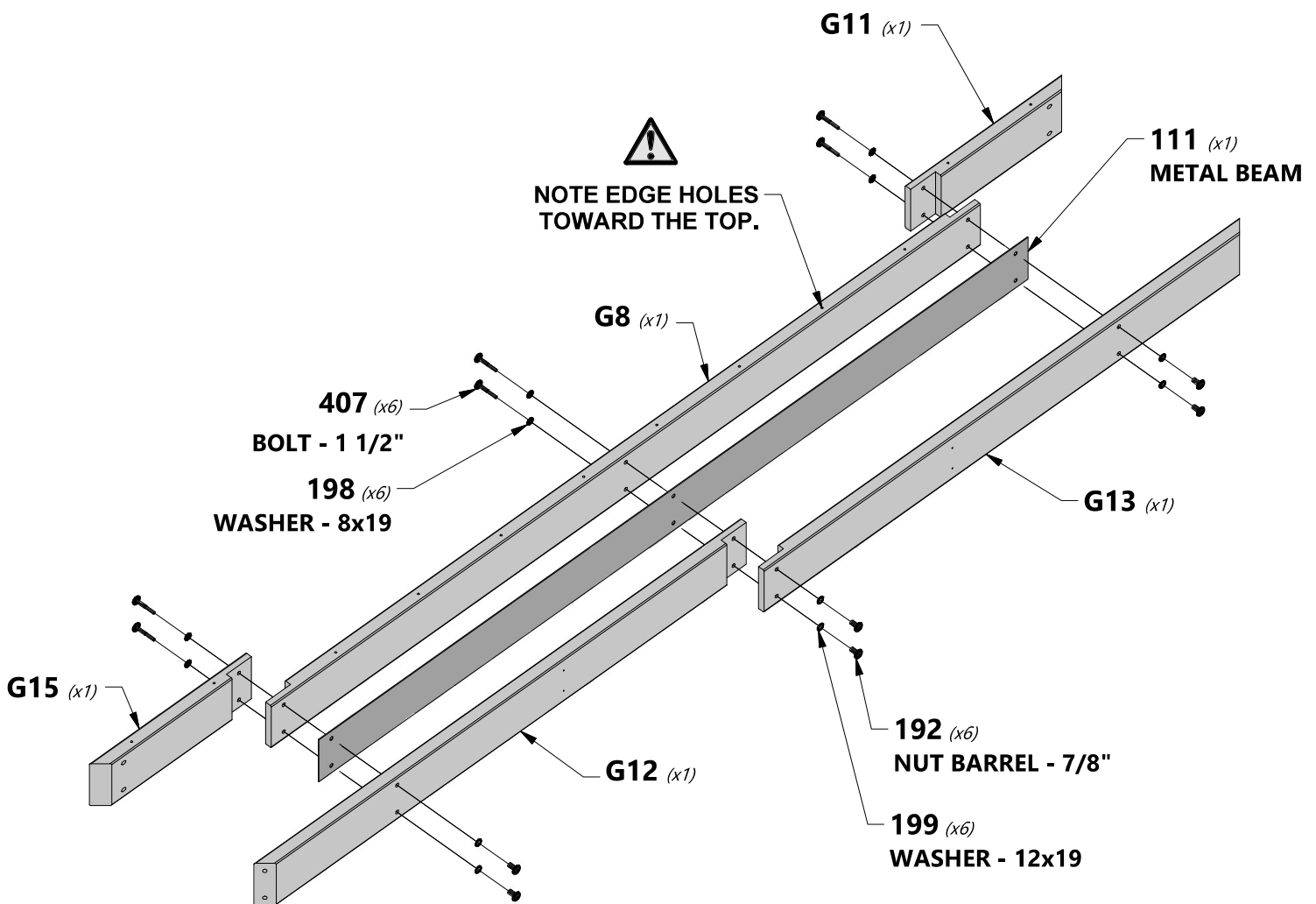



STEP 9



D5 | SUPPORT BRACE - W4L13055
(2) 1 3/8"x5 1/4"x4 5/8" (36x134x116)



A4M00555 | 90° L-BRACKET - BLK
(8)



H100202 | SCREW PWH BLK
(12) 8x5/8

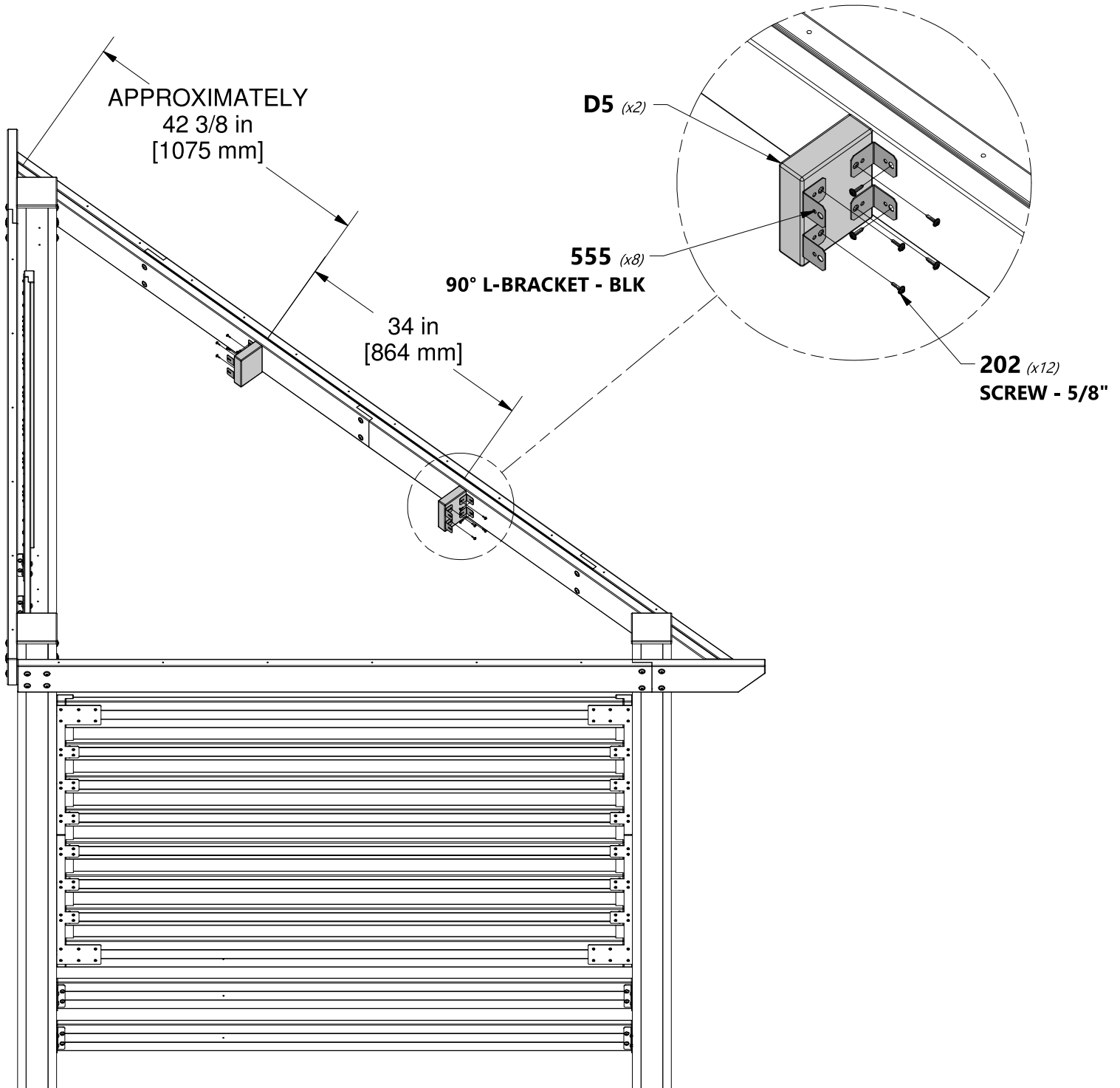



STEP 10

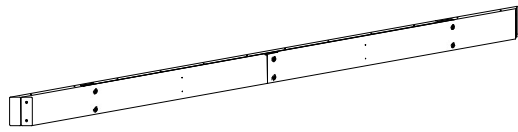

(1) REAR BEAM SUBASSEMBLY
(FROM STEP 8).



H100197 | LAG SCREW WH BLK
(4) | 5/16x2 1/2



H100198 | WASHER LOCK EXT BLK
(4) | 8x19



H100202 | SCREW PWH BLK
(4) | 8x5/8

EDGE HOLES TOWARD
THE TOP OF THE BEAM.

BEAM SUBASSEMBLY
(FROM STEP 8).

198 (x4)
WASHER - 8x19

197 (x4)
LAG SCREW - 2 1/2"

202 (x4)
SCREW - 5/8"



STEP 11

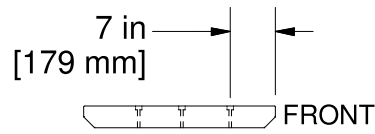

E1 | TOP JOIST - W4L13056
(2) | 1 3/8"x3 3/8"x81 1/2" (36x86x2070)

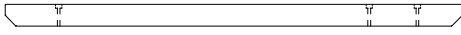

E2 | TOP JOIST - W4L13057
(2) | 1 3/8"x3 3/8"x71 1/2" (36x86x1817)



E3 | TOP JOIST - W4L13058
(2) | 1 3/8"x3 3/8"x61 1/8" (36x86x1553)

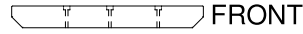

E6 | TOP JOIST - W4L13061
(2) | 1 3/8"x3 3/8"x30" (36x86x761)



E5 | TOP JOIST - W4L13060
(2) | 1 3/8"x3 3/8"x40 3/8" (36x86x1025)



E4 | TOP JOIST - W4L13059
(2) | 1 3/8"x3 3/8"x50 3/4" (36x86x1289)



H100825 | LAG SCREW
(36) | 5/16x4 BLK



H100198 | WASHER LOCK EXT BLK
(36) | 8x19

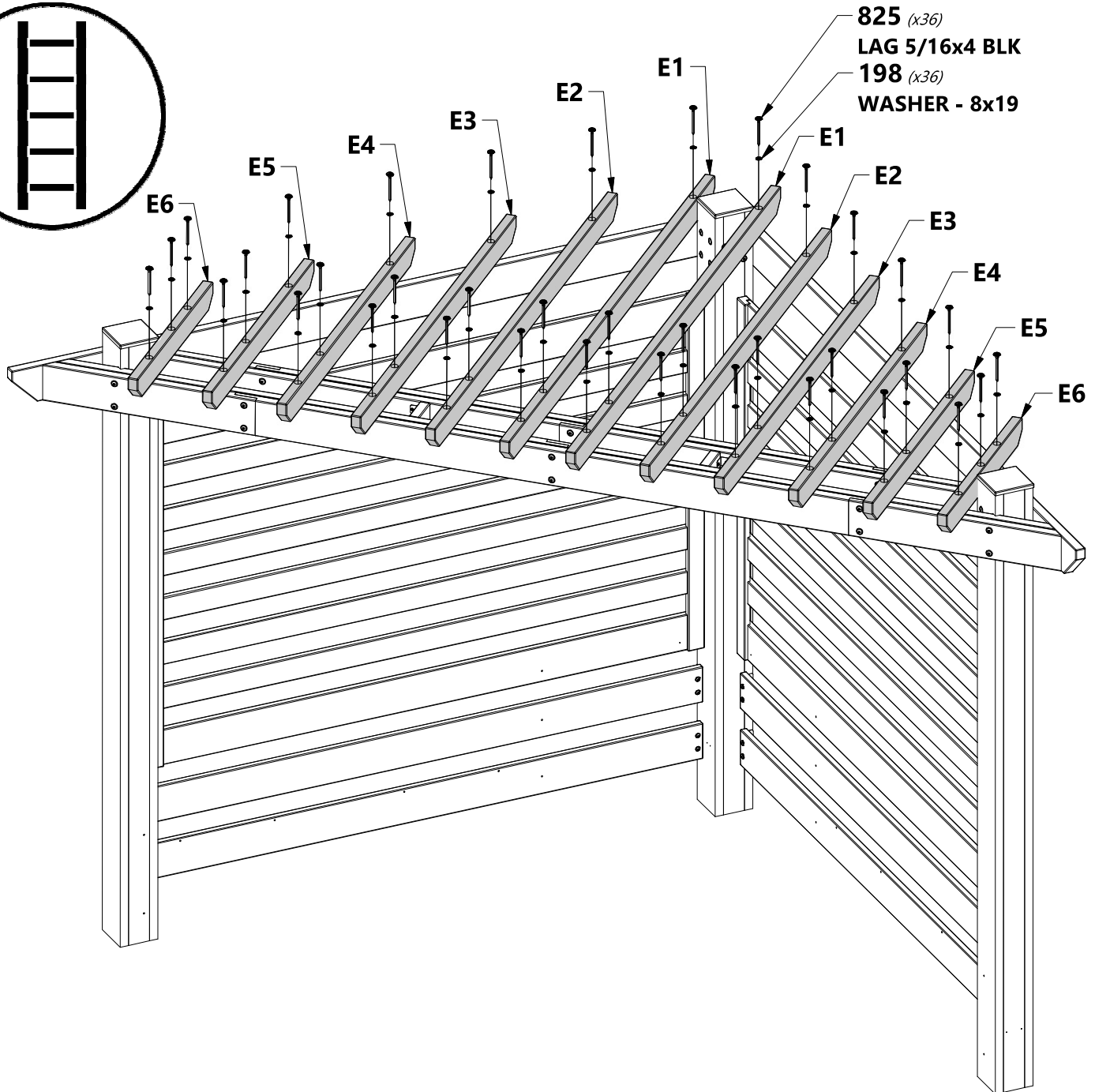
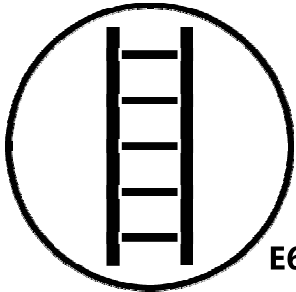



STEP 12

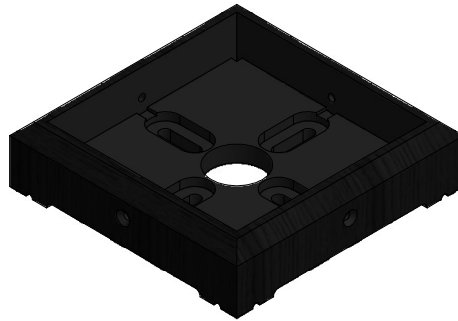

A100029
(3) | FOOT 142 SQUARE POST



NOTE:

1. DECIDE WHERE TO PLACE THE PERGOLA. NOTE THIS MOUNTING PROCEDURE IS MEANT TO BE USED ON CONCRETE ONLY.
2. PLACE THE PERGOLA EXACTLY WHERE IT WILL BE ANCHORED WHEN COMPLETED AND SLIDE A FOOT UNDER EACH POST.

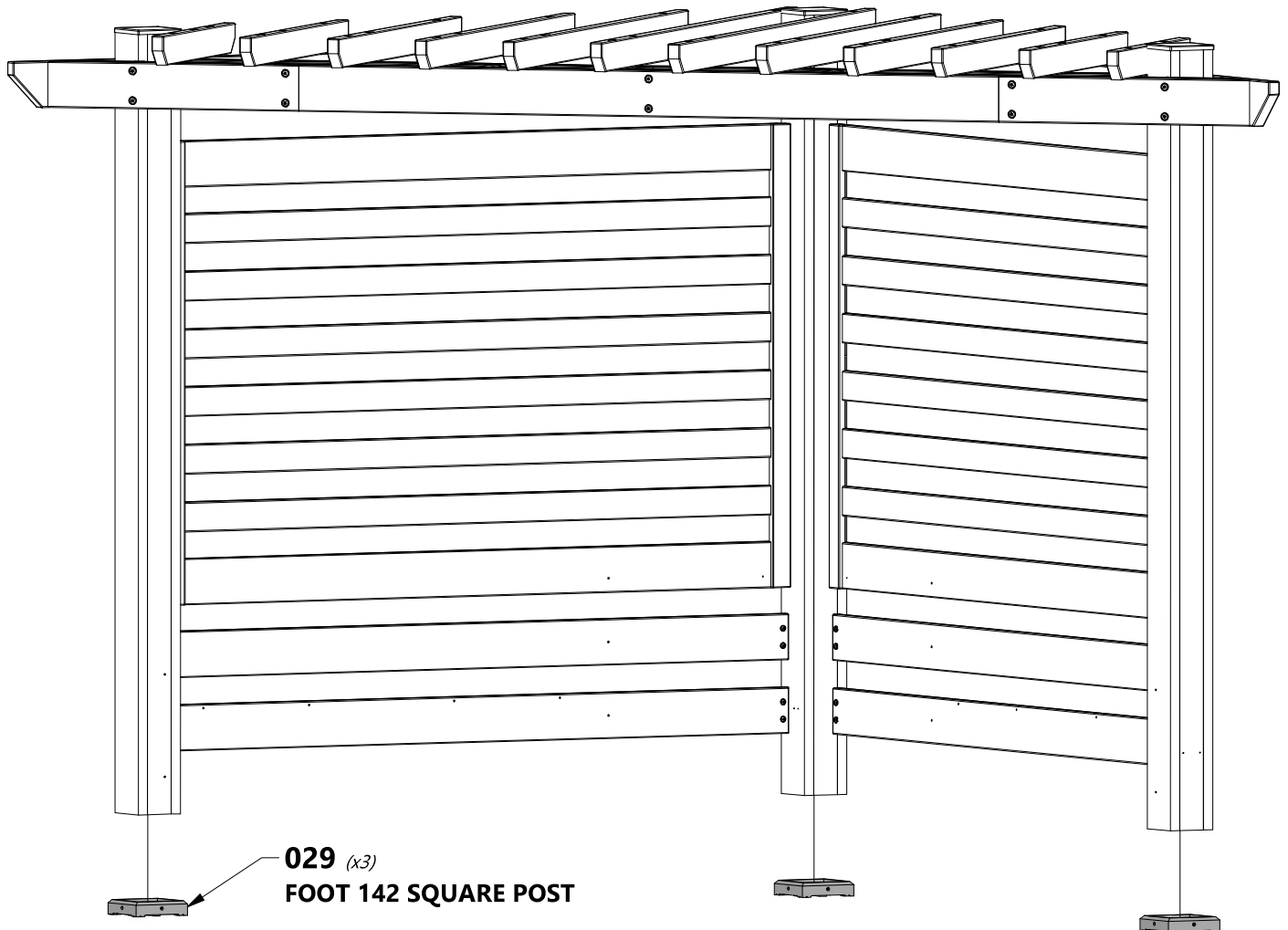



STEP 13



H100120 | SCREW CONCRETE ANCHOR
(12) | 1/4x2



NOTE:

USE CHALK TO TRACE AROUND THE EDGES OF EACH FOOT.

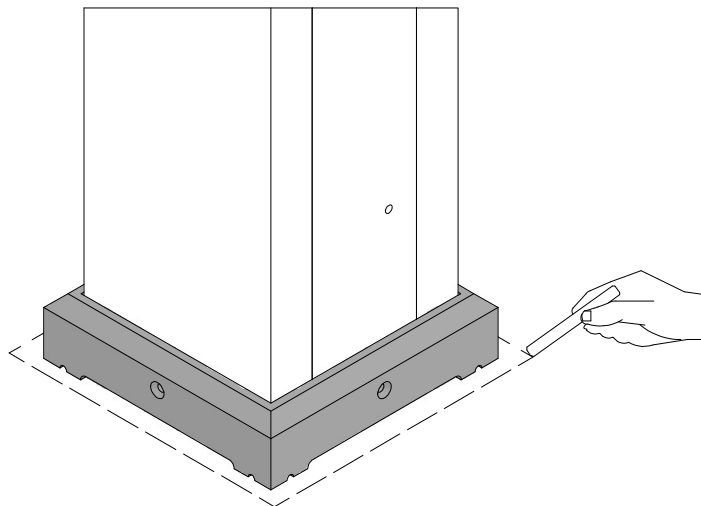

NOTE:

- 1. MOVE THE PERGOLA ASIDE. PLACE EACH FOOT INSIDE OF THE LINES DRAWN IN THE PREVIOUS STEP. USING A 3/16" CONCRETE DRILL BIT, PILOT DRILL ATTACHMENT HOLES INTO THE CONCRETE PAD.**
- 2. USE THE 1/4"x2" CONCRETE ANCHORS TO ATTACH EACH FOOT TO THE CONCRETE SURFACE.**

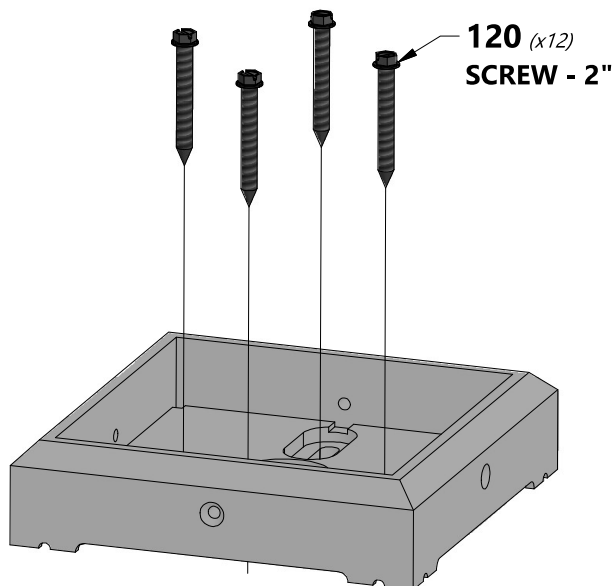



STEP 14



A100314 (1) "A" REVISION TAG



H100200 SCREW PFH BLK (12) 8x1 1/2



H100392 SCREW PWH BLK (4) 8x3/4

A100241 (1) BYD ID TAG (SMALL) WITHOUT AGES



NOTE:

MOVE THE PERGOLA BACK IN TO PLACE, SETTING EACH POST INSIDE A FOOT AND MOUNT.

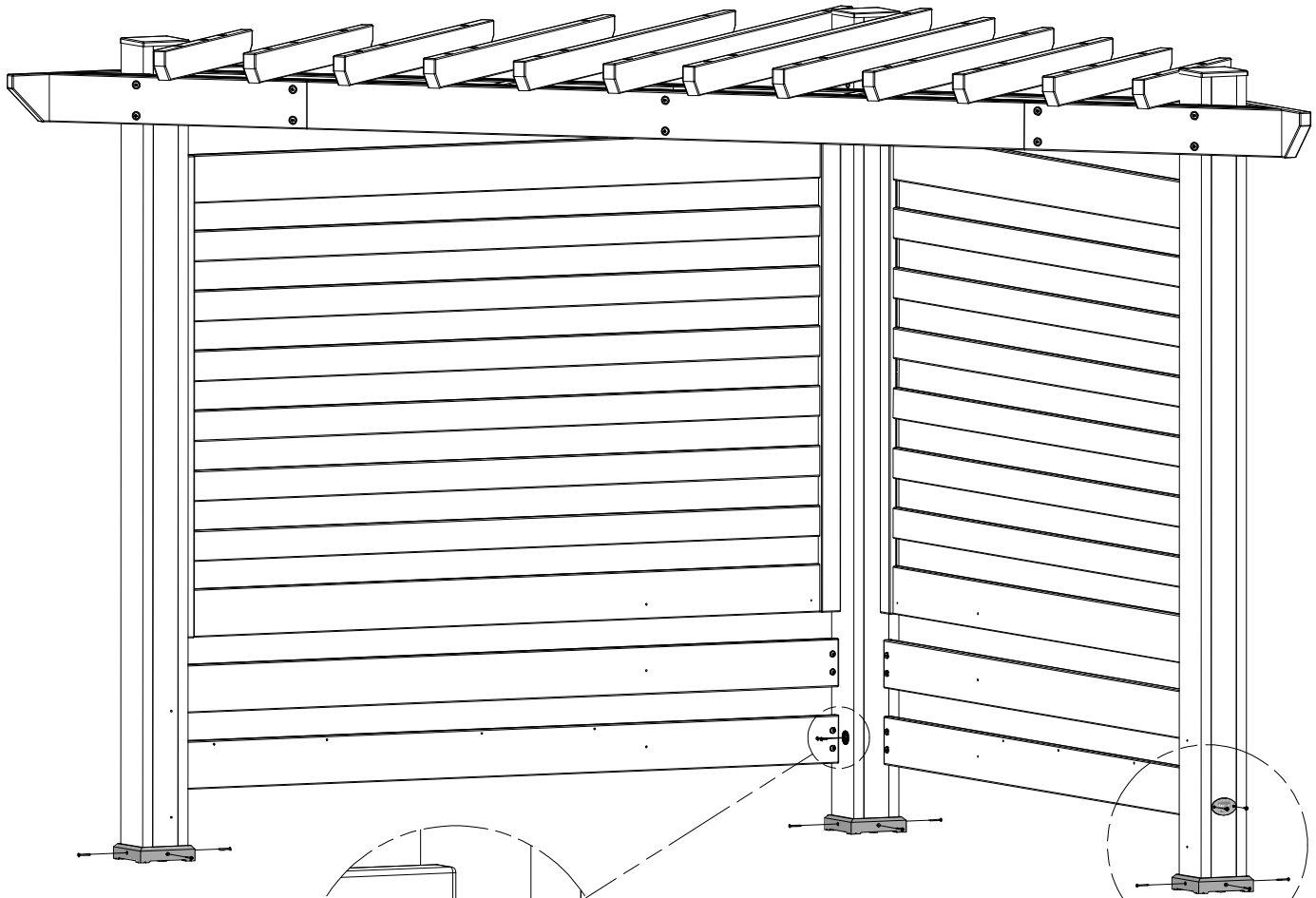

392 (x2) SCREW - 3/4"

314 (x1) "A" REVISION TAG

241 (x1) BYD ID TAG

392 (x2) SCREW - 3/4"

200 (x12) SCREW - 1 1/2"



STEP 15

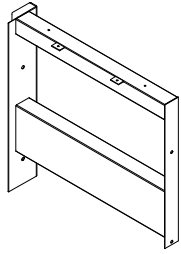

A4M01060
(1) | **FRAME END - LEFT**

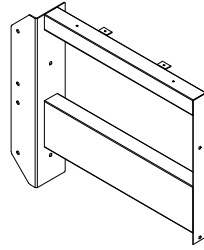

A4M01066
(1) | **FRAME END - RIGHT**

A6P00377
(2) | **SNAP-IN SQUARE PLUG**

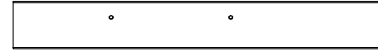

A4M01105
(1) | **ARM POST - RIGHT**



A4M01106
(1) | **ARM POST - LEFT**



H100171
(4) | **BOLT WH BLK**
1/4x1

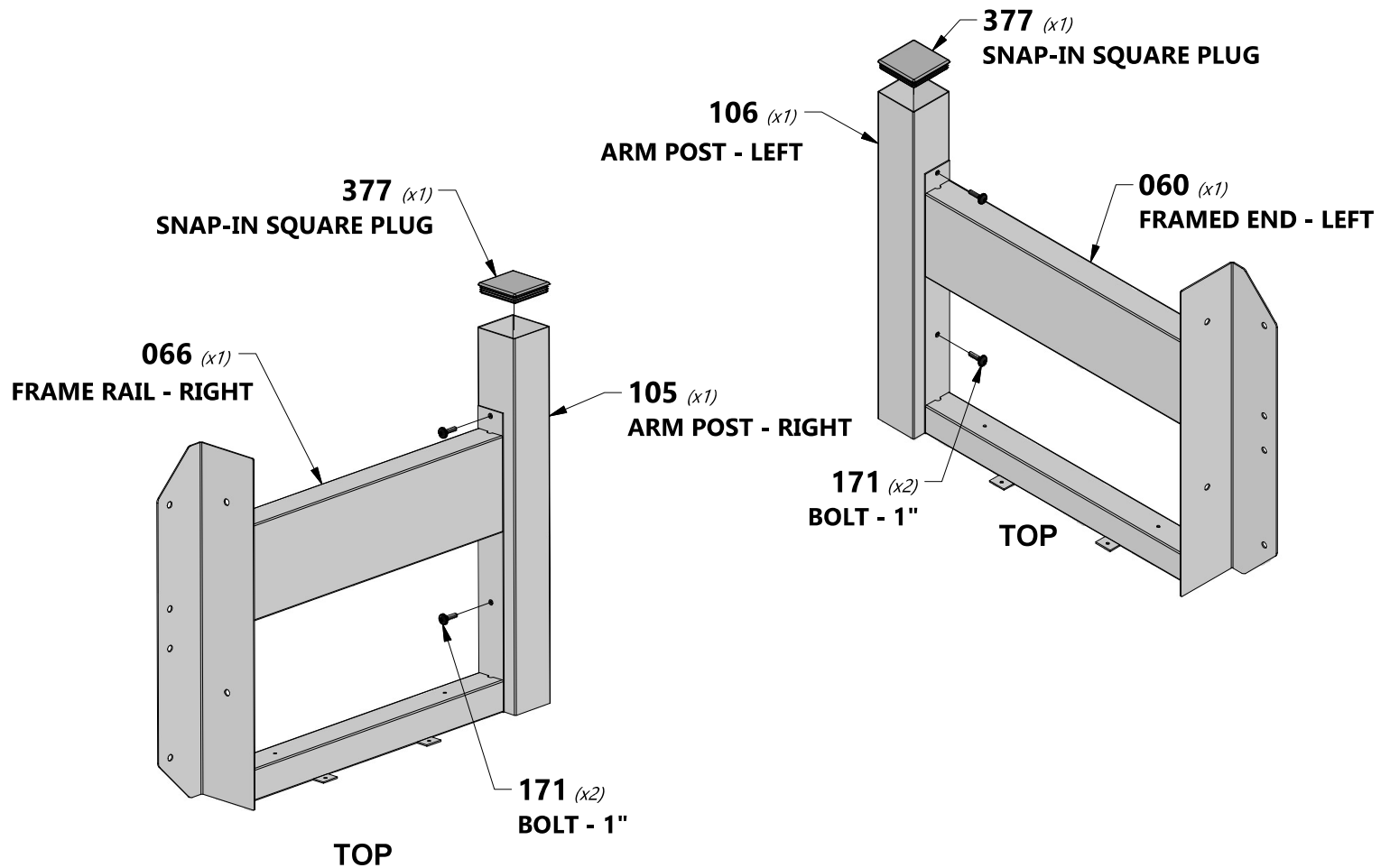



STEP 16

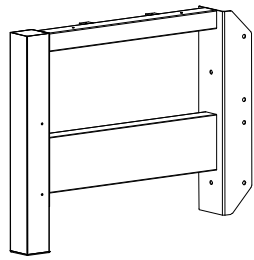

(1) METAL ARM - LEFT
SUBASSEMBLY

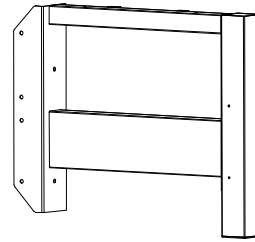

(1) METAL ARM - RIGHT
SUBASSEMBLY



H100471 | LAG SCREW WH BLK
(10) | 5/16x1 1/2

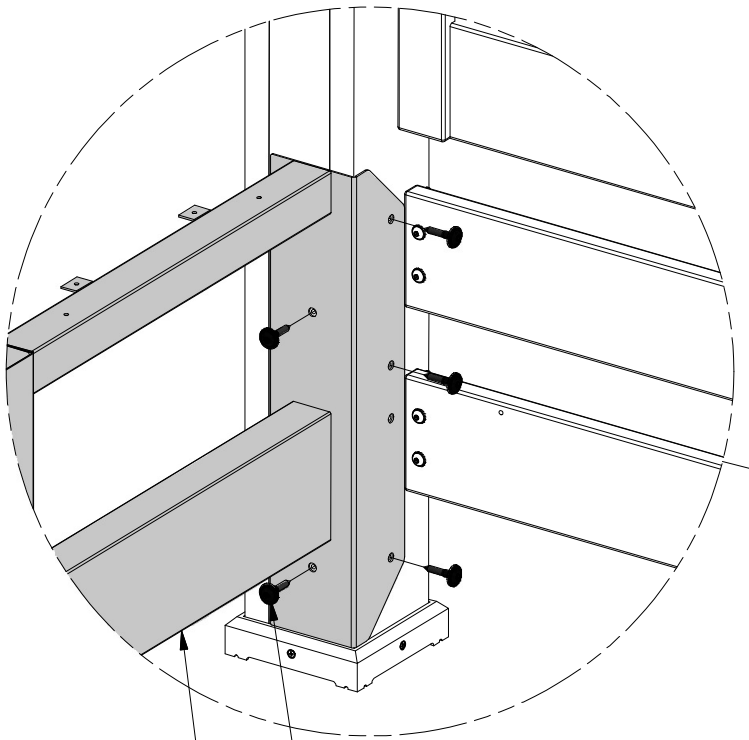

471 (x10)
LAG SCREW - 1 1/2"
(RIGHT & LEFT ARMS)

METAL ARM - LEFT
SUBASSEMBLY (x1)

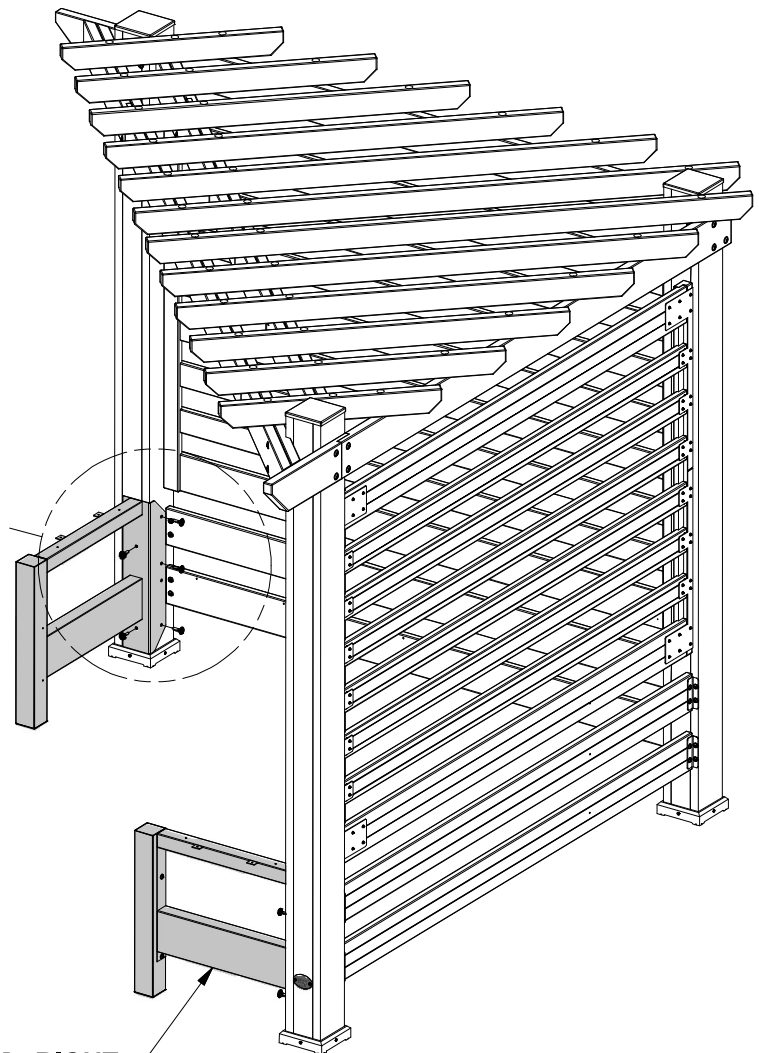

METAL ARM - RIGHT
SUBASSEMBLY (x1)



STEP 17

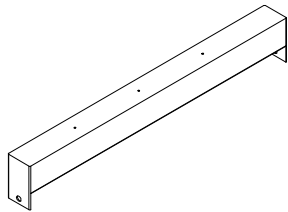

A4M01065 | RAIL
(2)

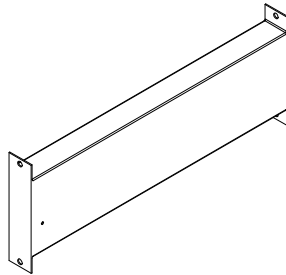

A4M01095 | RAIL
(2)

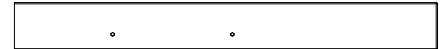

A4M01063 | POST
(1)



A4M01069 | POST
(1)



A4M01070 | POST
(1)



H100171 | BOLT WH BLK
(12) 1/4x1



A6P00377 | SNAP-IN SQUARE PLUG
(3)

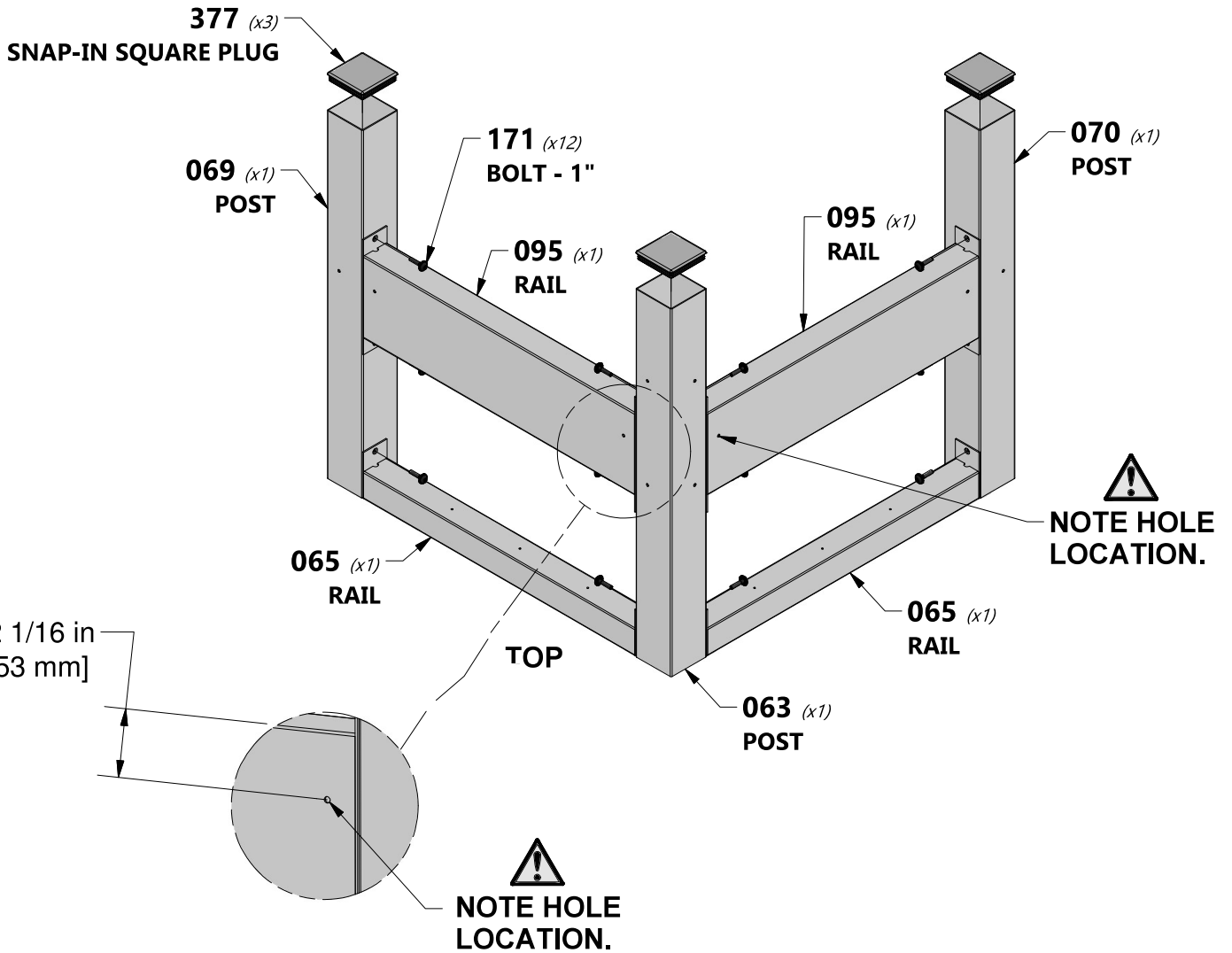



STEP 18

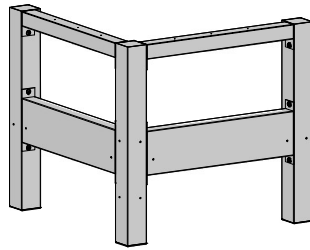

(1) METAL ARM TABLE BASE SUBASSEMBLY



H100391 | SCREW PFH BLK
(6) | 8x2

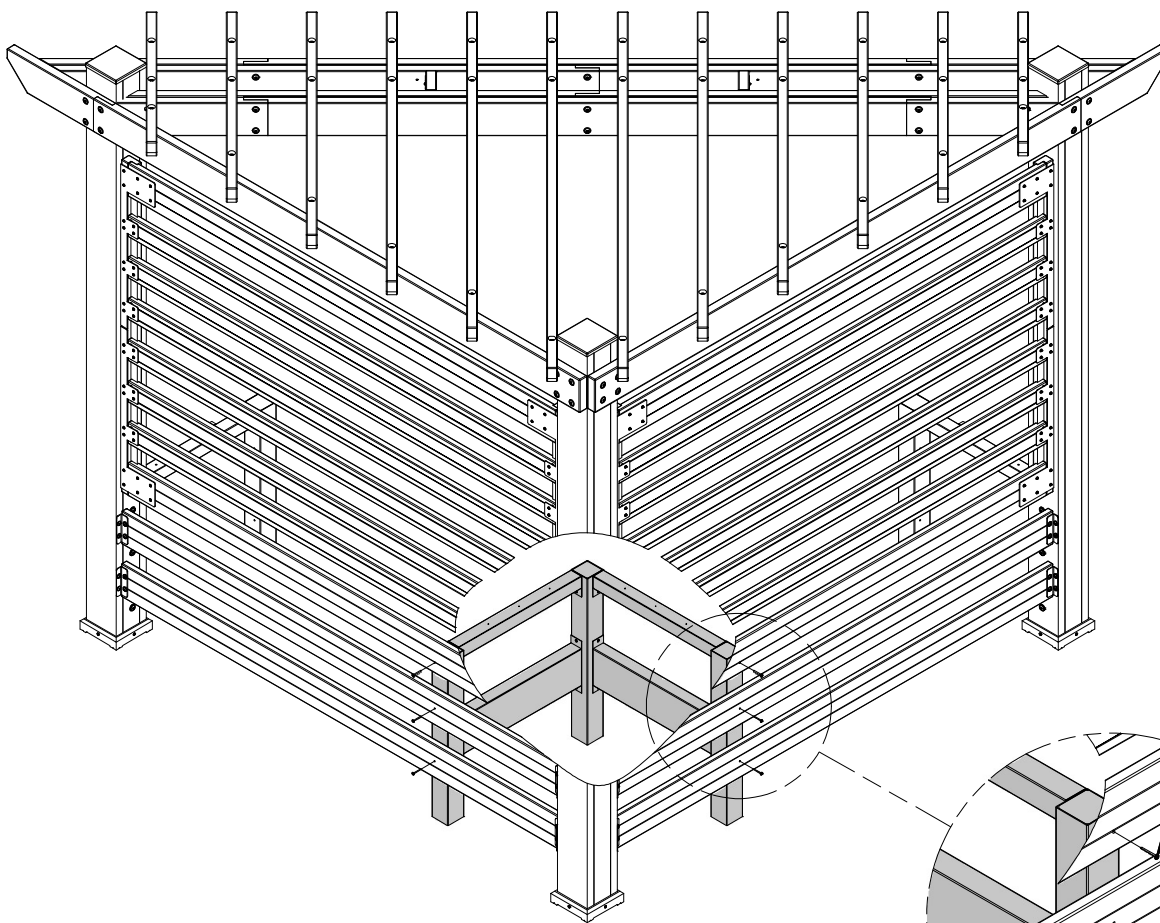

391 (x6)
SCREW - 2"

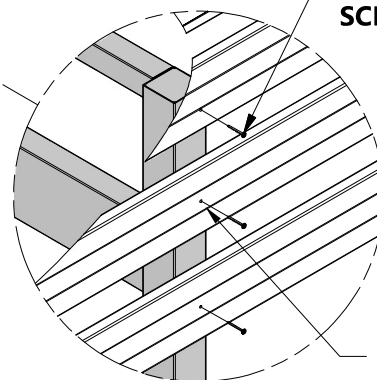

NOTE HOLE LOCATION.



STEP 19

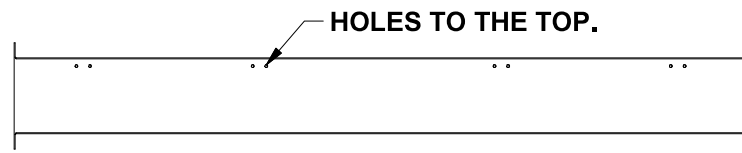

A4M01101 | RAIL
(2)



H100171 | BOLT WH BLK
(8) | 1/4x1

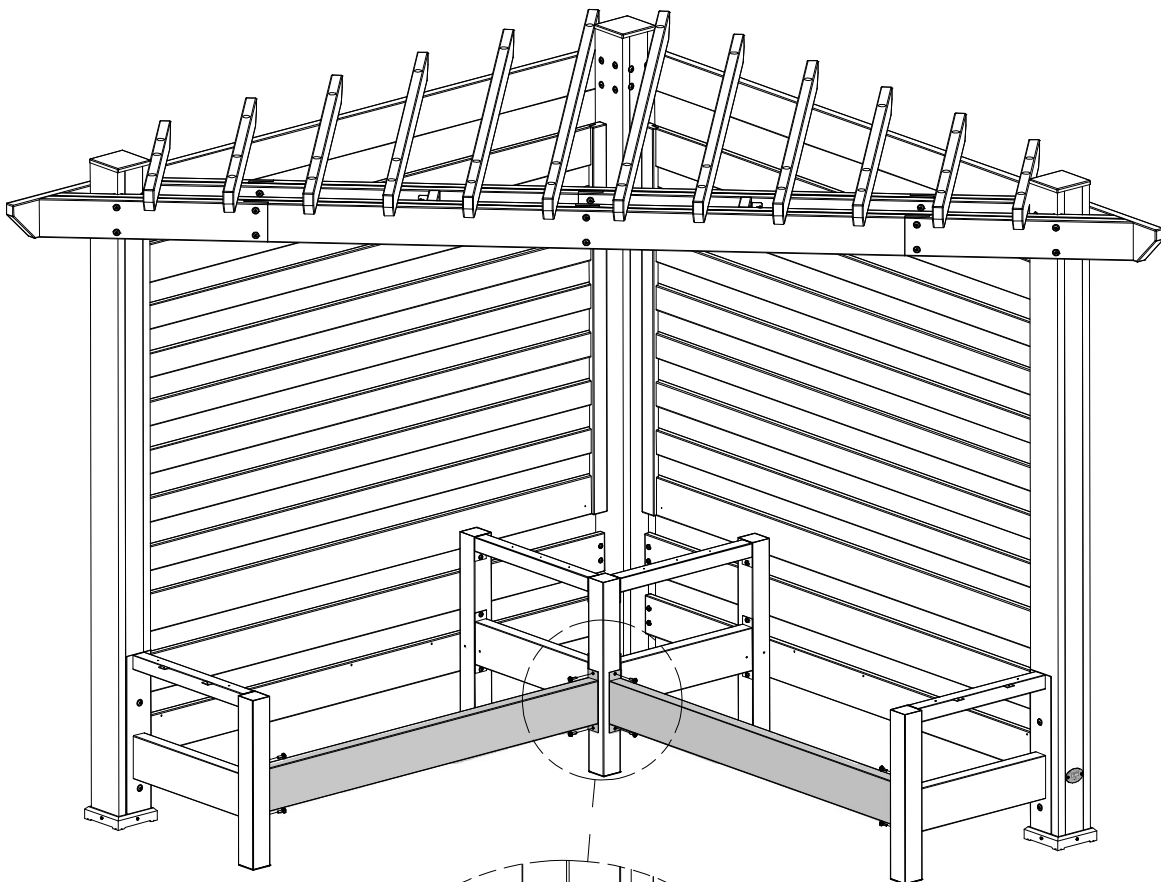

171 (x8)
BOLT - 1"

101 (x2)
RAIL





STEP 20

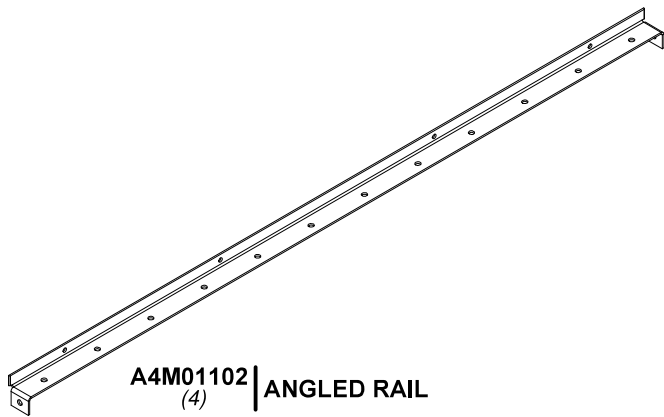

A4M01102 (4) ANGLED RAIL

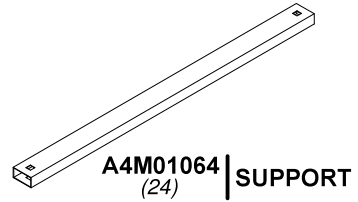

A4M01064 (24) SUPPORT



H100712 BOLT CARRIAGE BLK (48) 5/16x1 1/2



H100770 WASHER FLAT (48) 5/16 BLK



H100479 NUT LOCK BLK (48) 5/16



NOTE:

LOOSELY TIGHTEN SEAT SUPPORT FRAME FOR EASIER ATTACHMENT TO METAL FRAME AND CABANA RAILS!

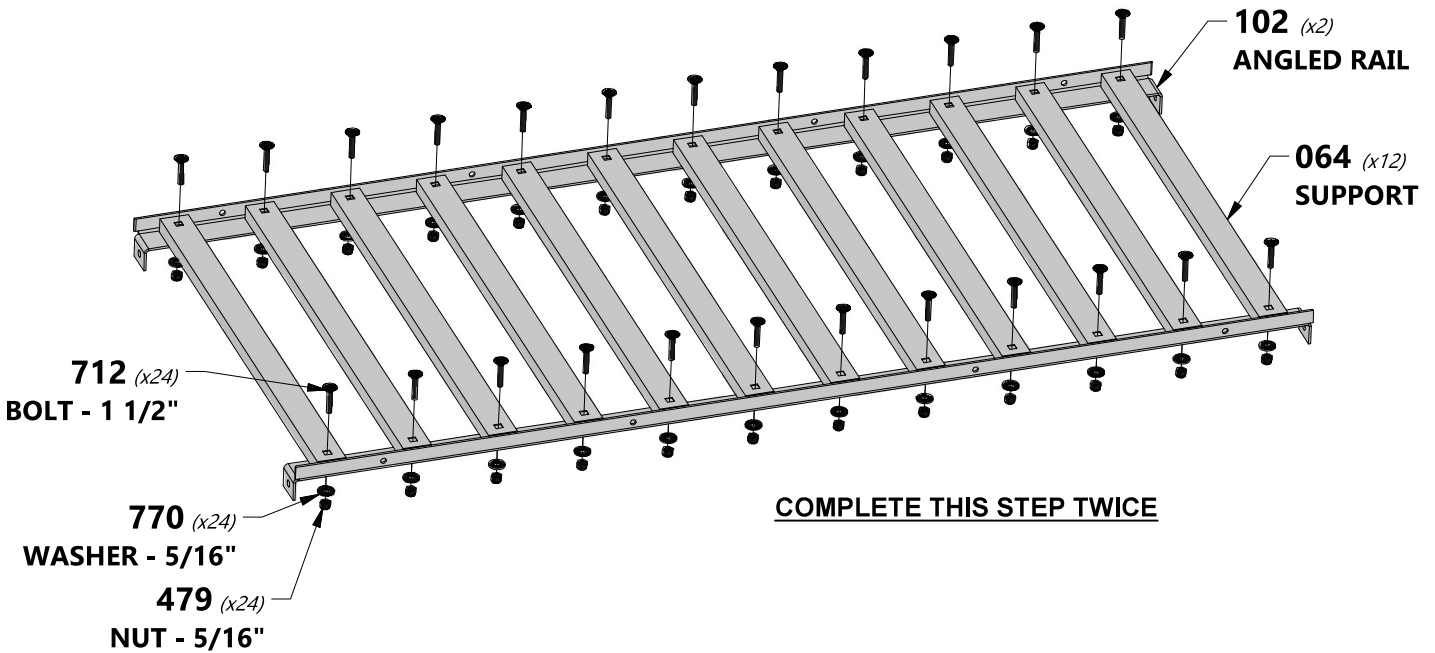



STEP 21

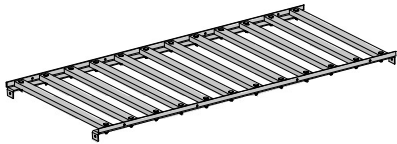

(2) SEAT SUPPORT SUBASSEMBLY



H100171 | BOLT WH BLK
(12) | 1/4x1



H100460 | LAG SCREW WH BLK
(10) | 1/4x1



NOTE:

1. LINE UP THE PILOT HOLES IN THE WOOD RAILS WITH THE HOLES IN THE SEAT SUPPORT RAILS FOR PROPER ASSEMBLY.

2. AFTER SEAT SUPPORT SUBASSEMBLIES ARE INSTALLED, FINISH TIGHTENING ALL THE BOLTS AND SCREWS FROM PREVIOUS STEP.

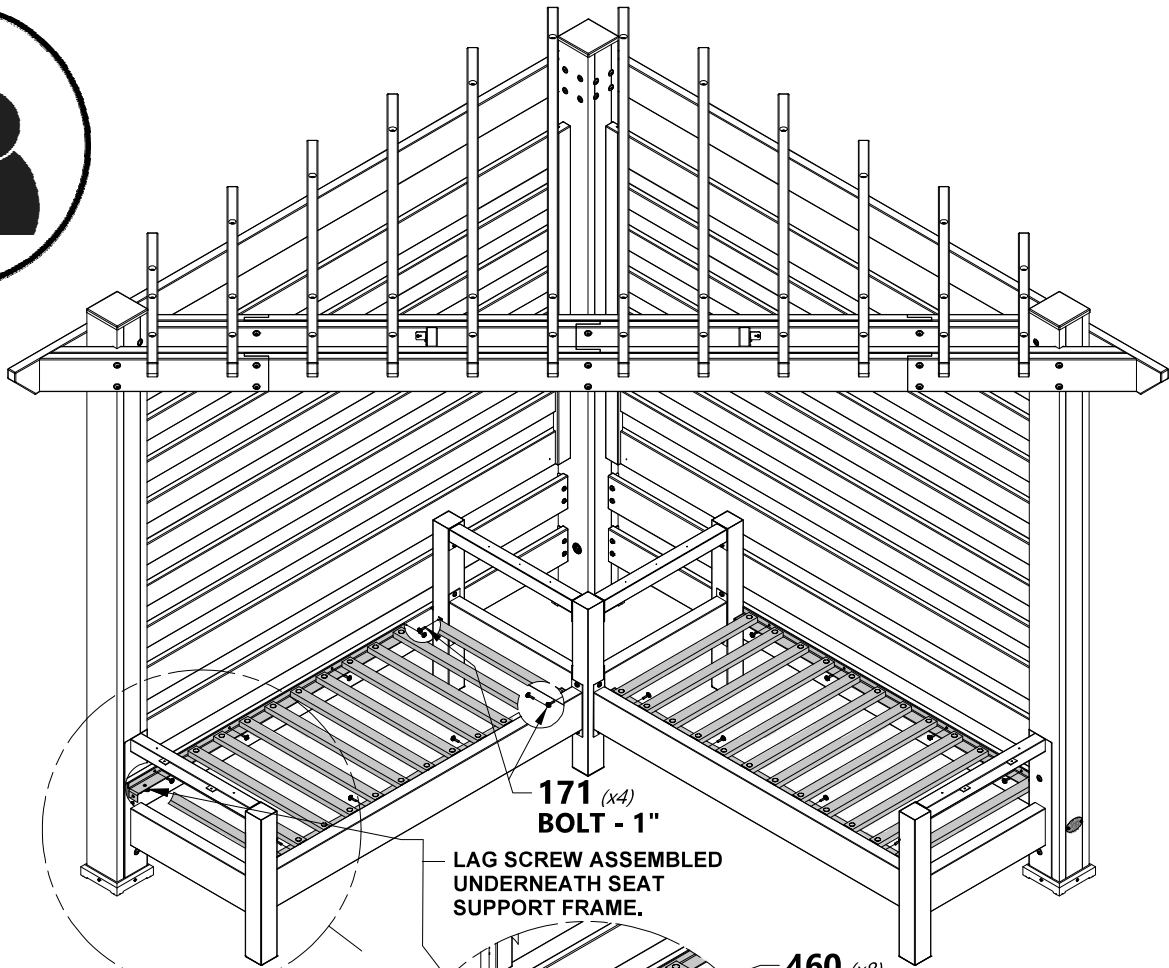

171 (x4)
BOLT - 1"

LAG SCREW ASSEMBLED UNDERNEATH SEAT SUPPORT FRAME.

460 (x8)
LAG SCREW - 1"
(BACK L-BRACKET)

171 (x8)
BOLT - 1"
(FRONT L BRACKET & (2) CORNERS)

REPEAT PROCESS FOR BOTH SEAT SUPPORT SUBASSEMBLIES.

460 (x2)
LAG SCREW - 1"
(POST CONNECTION)



STEP 22

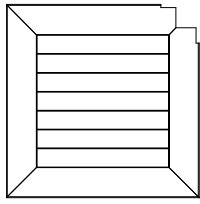

TT1 | TABLE TOP - W2A02925
(1) | 1 5/16"x30 1/8"x30 1/8" (34x765x765)

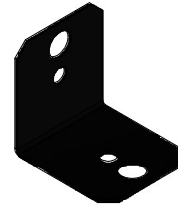

A4M00555 | 90° L-BRACKET - BLK
(2)



H100202 | SCREW PWH BLK
(4) | 8x5/8



H100824 | SCREW PWH BLK
(6) | 8x3



NOTE:
ASSEMBLE REAR CORNER L-BRACKETS FIRST.

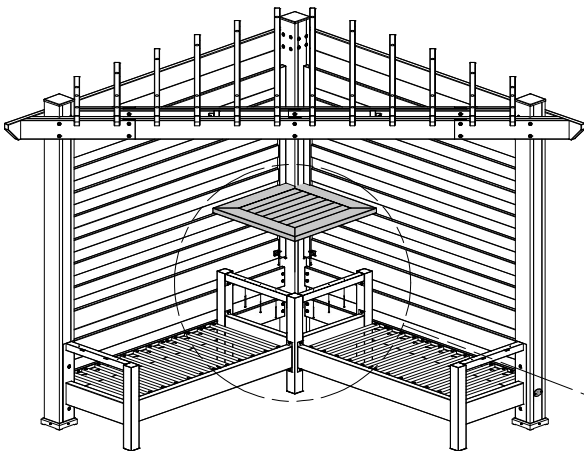

TT1 (x1)
TABLE TOP

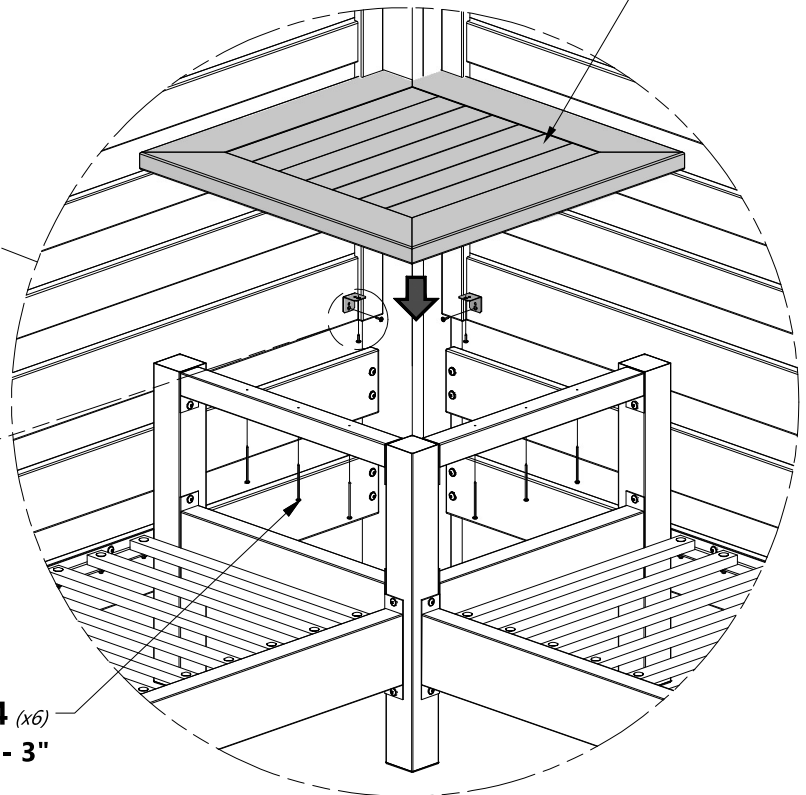

555 (x2)
90° L-BRACKET - BLK

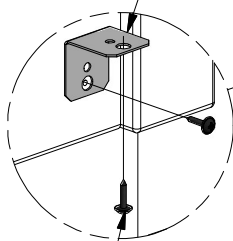

202 (x4)
SCREW - 5/8"

824 (x6)
SCREW - 3"



STEP 23



D7 | **ARM REST - W4L13068**
(2) | 1 3/8"x5"x26" (36x126x660)



H100824 | **SCREW PWH BLK**
(4) | 8x3



H100392 | **SCREW PWH BLK**
(4) | 8x3/4

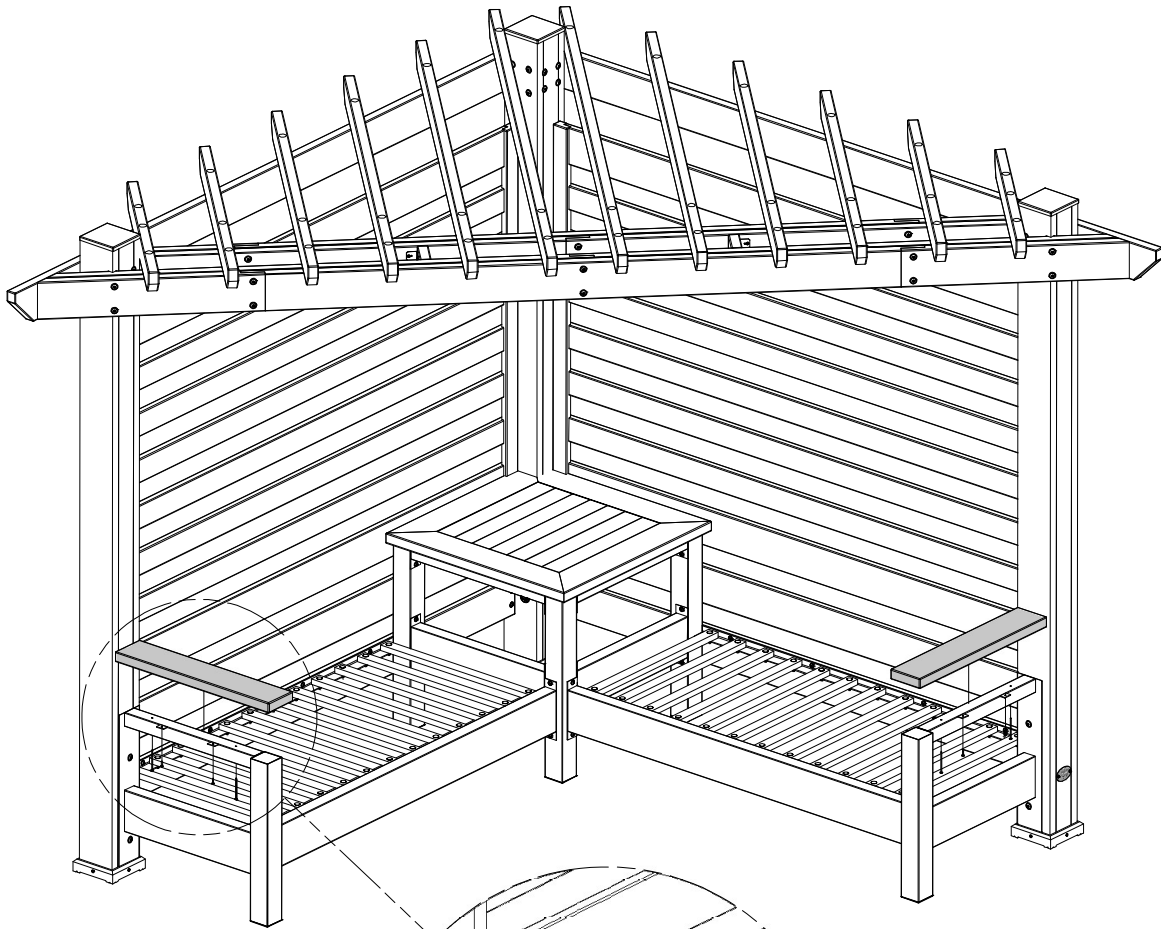

**REPEAT PROCESS FOR BOTH
ARM RESTS.**

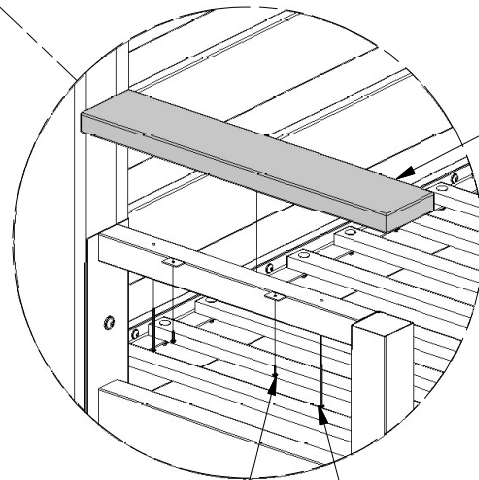

D7 (x2)
ARM REST

392 (x4)
SCREW - 3/4"

824 (x4)
SCREW - 3"



STEP 24

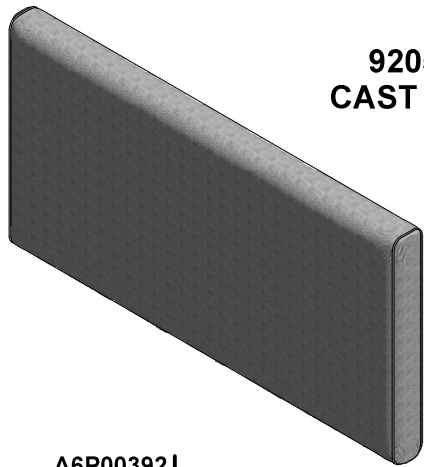

9205109
CAST SLATE

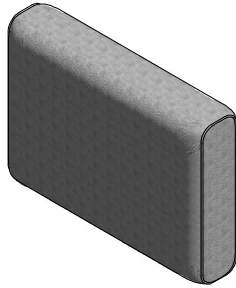

A6P00392 | SEAT CUSHION
(2)

A6P00393 | BACK CUSHION
(4)

OR

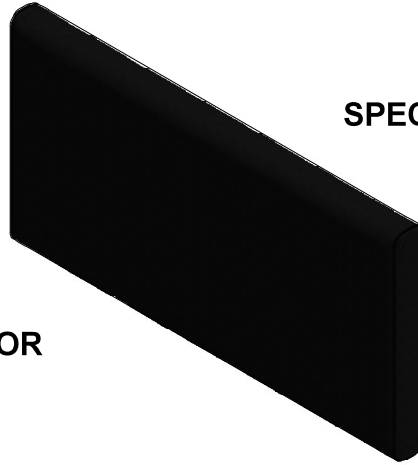

9205116
SPECTRUM INDIGO



A6P00394 | SEAT CUSHION
(2)

A6P00395 | BACK CUSHION
(4)

