

1. Carefully lift shingles above the vent hole.

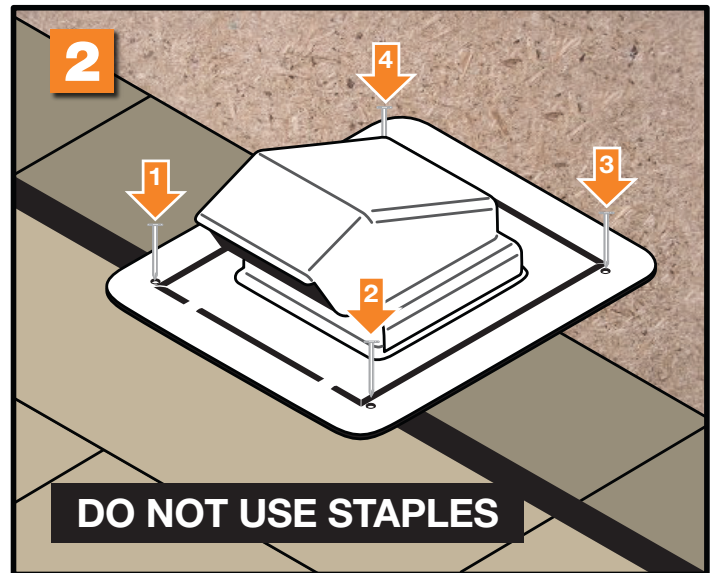

2. Secure vent with four galvanized roofing nails through provided holes in vent flange.

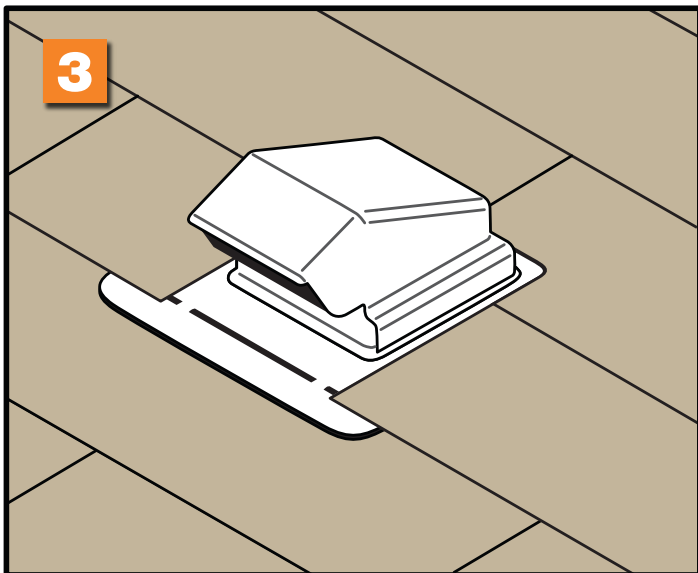

3. Cover as much of the vent flange as possible with shingles. When nailing the roofing material near the vent do not let fasteners penetrate the vent flange.

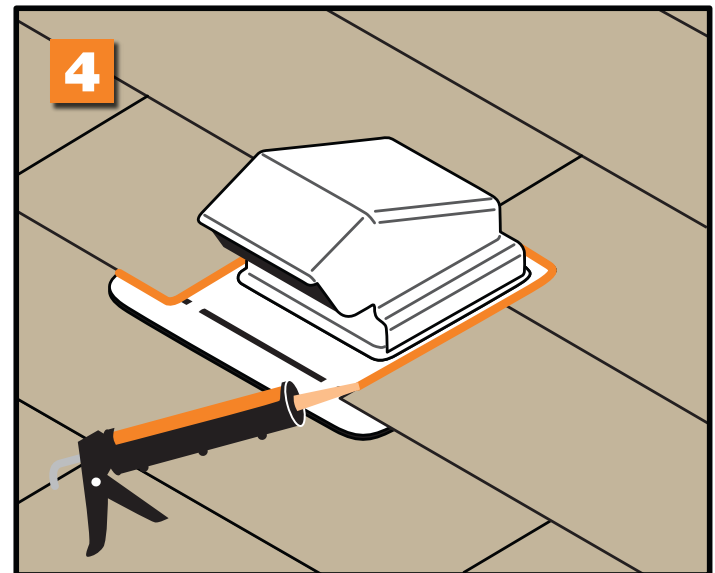

4. Overlapping shingles can be sealed to the vent base using an elastomeric sealant. Do not use asphalt based roof cements.

Note: Be sure to remove the 1/4 inch screen if it is to be used as a dryer vent.



CAUTION! Working above grade is inherently dangerous, be sure that proper fall protection measures are in place. When working with power tools, gloves and eye protection are absolutely required.

These installation guidelines are for use with typical or standard applications. It is always recommended to seek advice from a licensed professional, and to check with your local building inspector or building permit office for approvals and possible variations that may apply.