



# INSTRUCTION MANUAL



## Brass Torch

Model: UL2317

# READ ALL INSTRUCTIONS



### ⚠ DANGER

**Failure to comply with these instructions and warnings may result in damage to property, serious personal injury or death.**

Torches are to be used with propane only. Use only with Hand Held Propane Cylinders specifically designed for use with torches. (DOT-39 or TC-39M cylinders)

Read and comply with the instructions and warnings in this manual and familiarize yourself with the torch before igniting and using. Review instructions and warnings periodically to maintain awareness. Do not try to operate before reading instructions. When using torches, basic safety precautions should Always be followed.

### ⚠ WARNING

- Materials used in the construction of this device may contain brass (which may contain lead), a chemical known to the State of California to cause birth defects or other reproductive harm.
  - Combustion by-products produced when using this device contain chemicals known to the State of California to cause cancer, birth defects, or other reproductive harm.
- 
- Before using, check all parts for proper function and damage to component parts.
  - Keep torch out of reach of children. Do not permit anyone to use this torch who has not read this manual.
  - Only use the torch in an upright position. Never use this torch upside down. The propane cylinder contains gaseous and liquid propane. If the torch is moved rapidly, tilted too far to the side or upside down, the liquid can enter the valve and cause the flame to flare or extinguish.
  - Keep a fire extinguisher near where you are using the torch and where you store the torch.
  - Always point the torch flame away from your body, other persons and flammable objects. Check to make sure no unintended materials have been heated. Never attempt to use torch as a cigarette lighter.
  - Disconnect torch from cylinder when not in use.
  - Do not attempt to modify the torch construction and Never use unapproved accessories or fuels.
  - Unauthorized servicing is prohibited.
  - Be cautious when using the torch outdoors on sunny or windy days. Bright sun makes it difficult to observe the flame. Wind may misdirect the flame towards you or other unintended areas or objects. Wind may further cause sparks to come in contact with unintended combustible materials.
  - Do not drop or otherwise abuse the torch.
  - Do not use a torch that is leaking, damaged or malfunctioning.
  - Radiant energy can harm your eyes. Wear goggles having ANSI 287.12979 shade lens number appropriate to the torch operation as indicated; brazing and light cutting (3 or 4), medium cutting and light welding (4 or 5), heavy cutting and medium/heavy welding (5-8).
  - Do not use this torch to heat, mold or bend plastic sheets, molding or tubing.
  - Do not use this torch to remove paint.
  - Work only in well-ventilated areas. The fumes from fluxes, cadmium plating, brass, zinc and galvanized metal are toxic.
  - Hidden areas such as behind walls, ceilings, floors, soffit boards and other panels may contain flammable materials that could be ignited by the heat gun when working in these locations. The ignition of these materials may not be readily

### DO NOT DISCARD THESE WARNINGS AND INSTRUCTIONS

apparent and could result in property damage and injury to persons. When working in these locations, keep the torch moving in a back-and-forth motion. Lingering or pausing in one spot could ignite the panel or the material behind it.

- Avoid contact of flux with eyes or skin.
- Always wear protective gloves.
- Be aware that the tip of the torch can get extremely hot during use.
- Be careful around motor vehicles or any gasoline-fired products and beware of any hidden fuel lines and tanks.
- Always make certain the torch is placed on a level surface when connected to a fuel cylinder to reduce the risk of accidental tip over.
- Never use the torch on or near an aerosol can or any container that contains or previously contained chemicals, or flammable materials, liquids or gases. Heating these is extremely dangerous, especially after they have been emptied.
- Never leave the torch unattended when lit.
- This torch consumes oxygen and must only be used in well ventilated areas. Do not use in a confined work area or enclosed space.

## ▲ DANGER

This Torch uses Propane Fuel in a pressurized cylinder. Propane is EXTREMELY FLAMMABLE.

- Keep propane cylinders away from heat or flame.
- It is illegal and dangerous to refill the cylinder. When empty, obtain a new cylinder from your dealer.
- Federal law prohibits transportation if refilled: Penalty up to \$500,000 fine and five years imprisonment (49 U.S.C. 5124)
- Keep propane cylinders out of reach of children.
- Avoid prolonged exposure to sunlight.
- Do not store near source of heat or in a room used for habitation.
- Always detach torch from cylinder when not in use.
- Do not breathe gas, fumes, vapor or spray. If inhaled, remove affected person to fresh air.
- Avoid contact with eyes or skin. In case of contact with eyes, rinse immediately with plenty of water and seek medical advice. For skin contact, flush with large amounts of water.
- When cylinder is empty: discard in a safe place.
- Do not throw cylinder in fire.
- Do not puncture or incinerate cylinder.

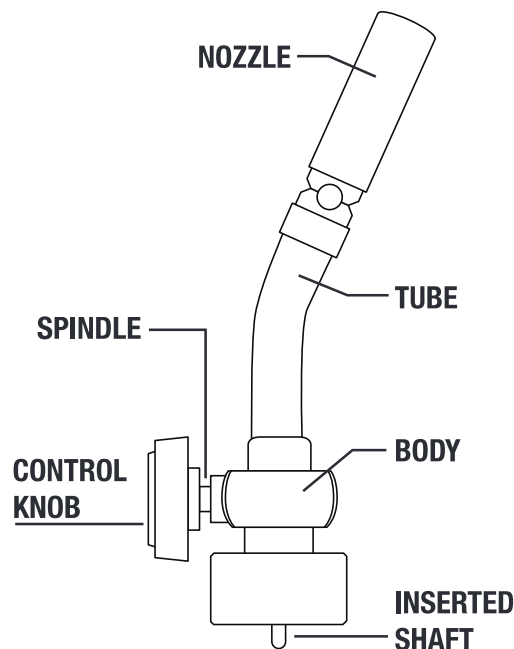

**DO NOT DISCARD THESE WARNINGS AND INSTRUCTIONS**

## COMPONENTS

## ASSEMBLY

### STEP 1

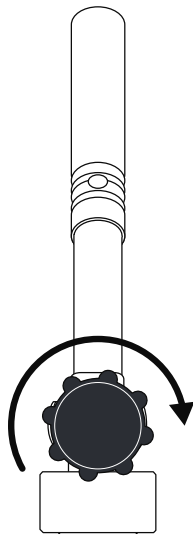

### STEP 2

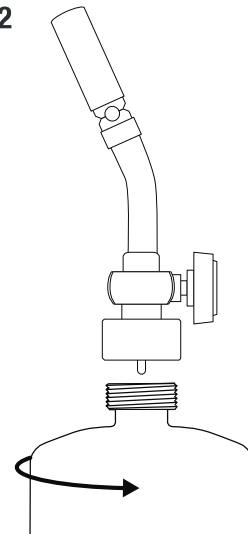

1. Make sure valve is OFF by turning knob in direction of arrow until hand tight only. Do not Force.
2. Turn fuel cylinder clockwise into valve body until hand tight. Do not Force.

## LIGHTING AND OPERATION

1. To light with a match, hold as shown and open valve slowly.
2. To light with spark lighter, open valve slowly before sparking. Hold spark lighter at a 45° angle to the torch opening.  
**NOTE:** It is very difficult to light with valve fully open.
3. For hottest, most efficient flame, adjust inner blue flame of pencil burner to 1-1/2 to 2 inch length.
4. If ignition does not occur immediately upon opening the torch valve, close the valve and wait 5 minutes before attempting to ignite again. Failure to follow this instruction could result in a build up of flammable gas which if ignited could result in a fireball that could cause injuries and property damage. Do not open the valve and allow gas to flow through the torch without attempting to ignite the torch.

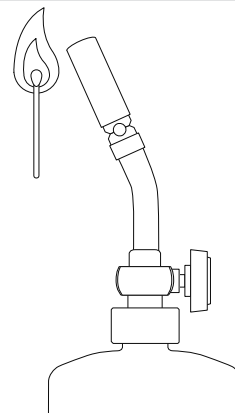

## ▲ ADDITIONAL WARNINGS

- Make sure torch is cool before tightening or removing burner head, or before installing or removing accessories.
- Check all joints and couplings periodically to insure against loose connections. With valve open, without lighting, test all connections with soapy water. If bubbles appear, gas is leaking and torch must be repaired. Never Use a flame to check for leaks. Make this test in a well-ventilated and spark-free area, and where there are no open flames.
- In cold weather the size of the flame will be smaller. To produce a larger flame, pre-warm the cylinder to room temperature prior to use.
- **ADDITIONAL NOTE:** As a safety feature, the burner may snap if the torch is dropped, in which case the burner must be replaced.

## STORAGE

### REMOVE CYLINDER FROM TORCH WHEN NOT IN USE

1. Turn valve off.
2. When torch is cool, disconnect cylinder and store torch and cylinder separately and out of reach of children. Observe cautions on cylinder label.

# SAVE THESE INSTRUCTIONS