

Installation
& Instructions

ALEKO

Multi-functional RV/PatioAwning

ARVAW010



W20170220EN

www.AlekoProducts.com

Package Components

ALEKO®

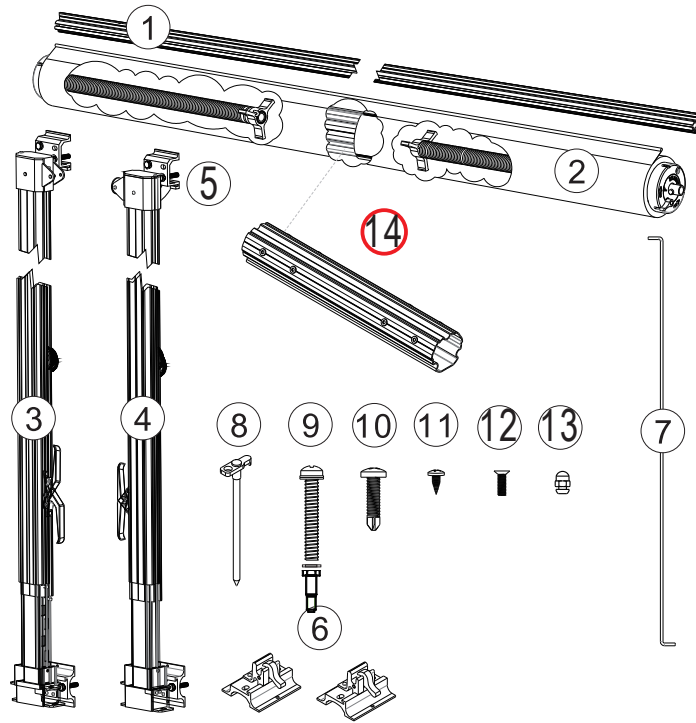

<input type="checkbox"/>	ITEM	DESCRIPTION
<input type="checkbox"/>	1	Fabric lock rail
<input type="checkbox"/>	2	Fabric tube
<input type="checkbox"/>	3	Left arm
<input type="checkbox"/>	4	Right arm
<input type="checkbox"/>	5	Upper bracket
<input type="checkbox"/>	6	Bottom bracket
<input type="checkbox"/>	7	Pull rod
<input type="checkbox"/>	8	Peg
<input type="checkbox"/>	9	M6x50 hex head screw
<input type="checkbox"/>	10	Φ4.1x35 Self-tapping screw
<input type="checkbox"/>	11	Φ4.1x13.5 Self-tapping screw
<input type="checkbox"/>	12	M6x16 screw
<input type="checkbox"/>	13	Set screw
<input type="checkbox"/>	14	Fabric tube connector

Preparation

1. Open the package and check all parts and accessories on the package components. Insure nothing is missing in the package box.
2. Prepare the installation tools, like electric hand drill, hand plier, measuring tape, screwdriver, an erasable color pen ect.
3. Please take a look bellow drawing, there are 4 points need to be fixed on your c aravan, those 4 points defer in distance (height and width of each type are different) Please find it in the bellow measurement sheet of the type you bought. Then calculate and measure right installation points, Mark it with erasable color pen.

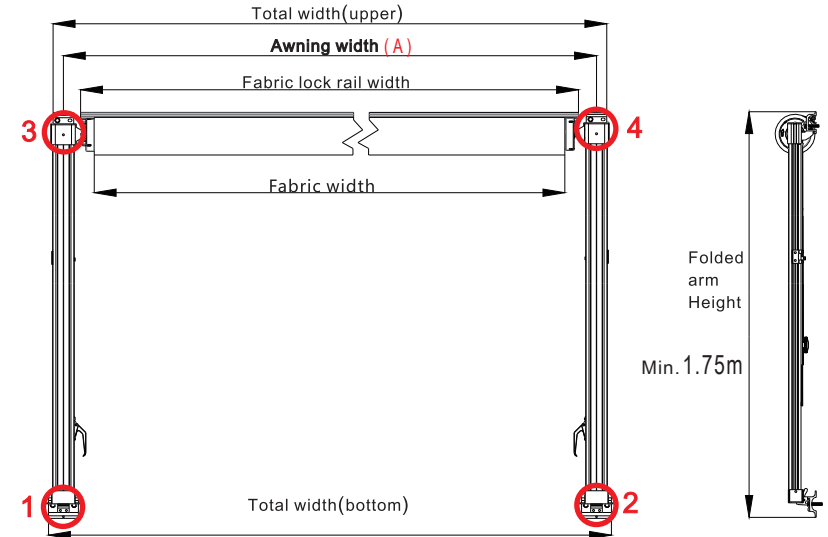

ATTENTION

Our awning min.folded arm height is 1.75m. if your caravan is high, please extend the arm to suit for your caravan. Then lock the position with our set screw.

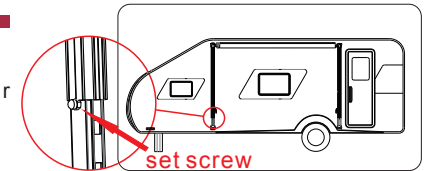

Metric measurement

Measurement position sheet								Unit: m
Awning Width (A)	2.5	3.0	3.5	4.0	4.5	5.0	5.5	6.0
Total Width (upper)	A+0.08							
Fabric lock rail width	A-0.13							
Fabric Width	A-0.254							
Total Width (bottom)	A+0.105							
Folded arm Height	1.75							
Extension (max)	2.5							

Imperial system measurement **ALEKO**[®]

Measurement position sheet													Unit : ft / in			
Awning width(A)	8'	9'	10'	11'	12'	13'	14'	15'	16'	17'	18'	19'	20'	21'		
Total Width (Upper)	A+3.15"															
Fabric lock rail width	A-5.12"															
Fabric Width	A-10"															
Total Width (Bottom)	A+4.13"															
Folded arm height	72.44"															
Extension (Max.)	8'															

REMAKE:
A.represent awning width.
 Please check above measurement sheet carefully, and calculate the correct installation position accordingly.

Installation

step 1

Find out the awning brackets(2pcs bottom brackets + 2pcs upper brackets which already fixed on the arm) and two arms. see package components pic. 5 and 6.

step 2

Drill the holes according to your marked positions.
 (You may check again the right distance of the upper and bottom brackets)

ATTENTION

Please insure all brackets positions are free stable and DO NOT overlap with other parts of the caravan side wall (Eg.Windows, doors or others).

Step 3

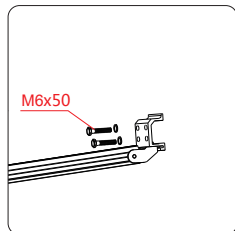

Fix the bottom brackets with M10 screws.

Step 4

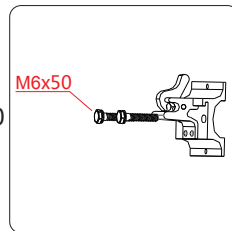

Fix the upper brackets with M10 screws.

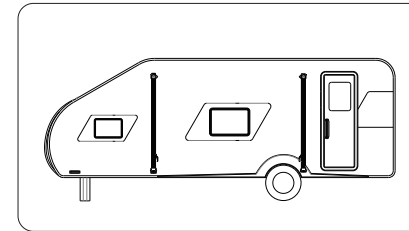

ATTENTION

Please insure the arms are vertical to the ground and parallel to each other !

Step 5

Fix fabric lock rail

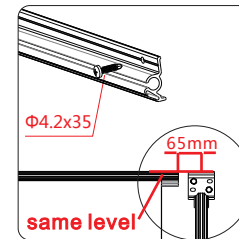

The fabric lock rail is between two upper brackets, but keep them in the same height position.

Step 6

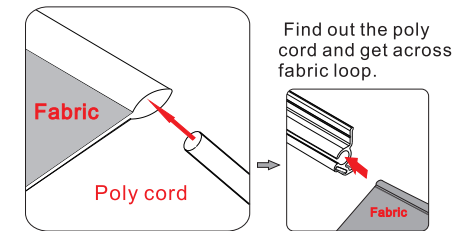

Find out the poly cord and get across fabric loop.

then put the fabric into the fabric lock rail.

Step 7

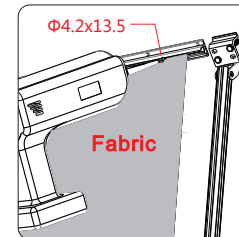

Find the self tapping screws then fix the fabric on each side of fabric lock rail, in case of fabric slide out when operating the awning.

After you done above steps, awning is looks like as below picture.

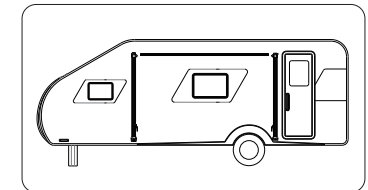

Fabric lock rail

Optional Acc. - Led Strip

Install the LED strip
 There is a groove for Led strip which is under the fabric groove on the fabric lock rail. See pic You can slid your LED strip into it if you have.
 (But the Led strip is not our standard accessories. if you need, please kindly contact with our salesman to order it)

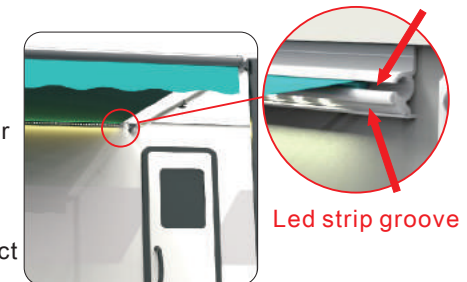

Led strip groove

ATTENTION

If you choose a modular type ,
please connect the fabric tube first.

Connect the fabric tube

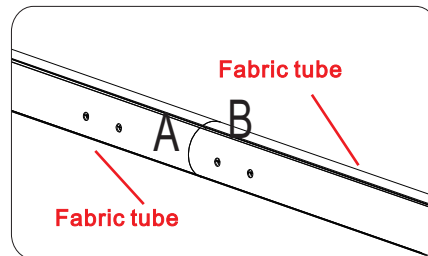
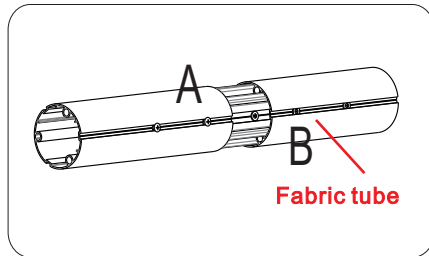
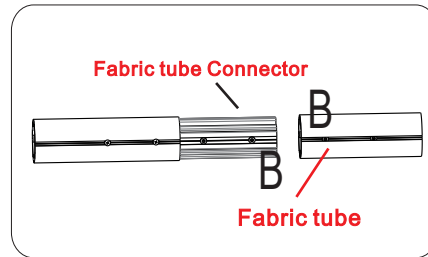
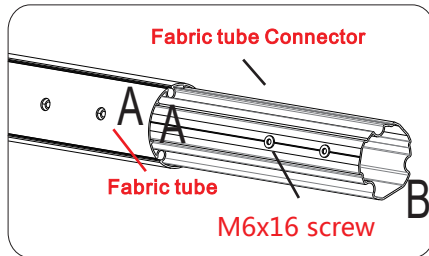

Step 8

Please kindly remove the right side end cap from fabric tube and then take out the springs.
Then put the fabric into fabric tube according to below steps.

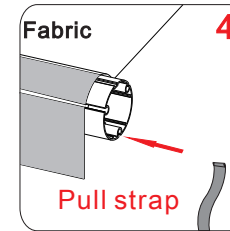
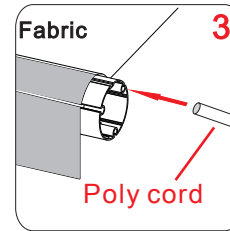
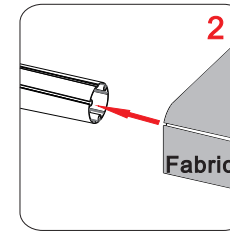
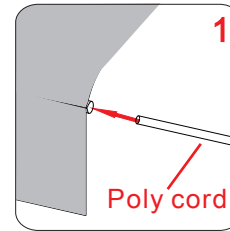

1) Find the poly cord and get across fabric loop.

2) Put the fabric into the fabric tube groove.

3) Put the fabric into second fabric tube groove, then get the poly cord across.

4) Put the pull strap on the last tube.

ATTENTION

When reset the side cover components, Make sure the triangle block at the right position Or, the spring is very easy to waggle, and can't work stable !

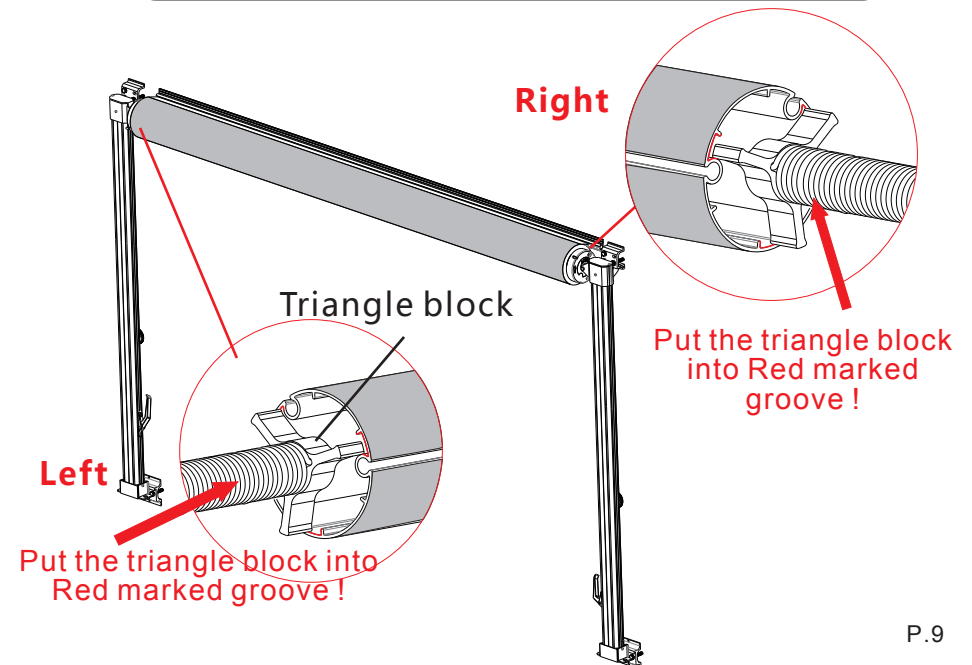

Step.9

Connect the right arm

1. Turn down the Safety-spring lock according to the PIC marked direction
(On and ONLY the RIGHT side of the fabric tube, there is a Safety-spring lock)
2. Make Pre-stress for right side spring by turn the sping ending stick with clamp/screw driver fully turn 15 turns according to pic marked diredtion
3. Connect the tube with arm, see pic

ALEKO®

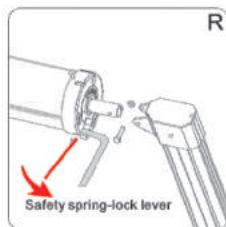

Connect the left arm

1. Make Pre-stress for Left side sping by turn the sping ending stick with screw driver/clamp fully turn 15 turns accoring to pic marked direction
2. After doing the pre-stressing, please DO NOT LOOSE the clamp/screw, until the left arm is connected safely

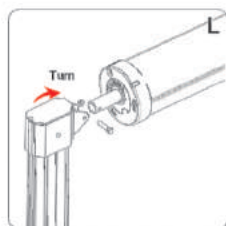

ATTENTION

By now, installation step is done, please double check the awning and keep awning twoside spring tension are the same, and in a state of equilibrium.

Step.10

Turn up the safety-spring lock according the pic marked direction

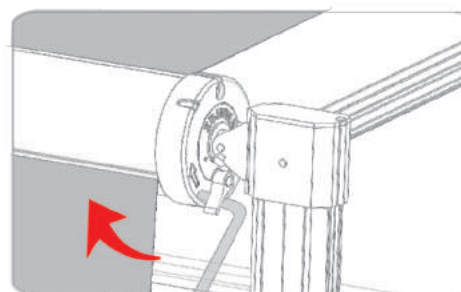

Step.11

Pull to close the awning.

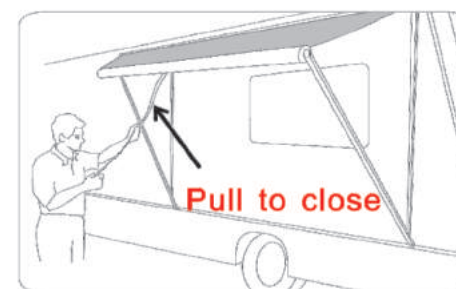

ATTENTION

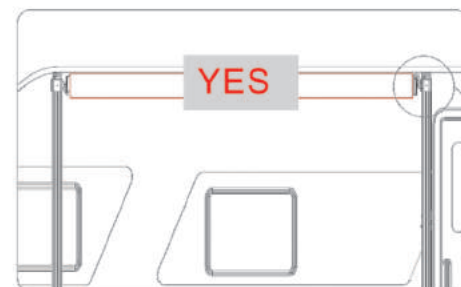
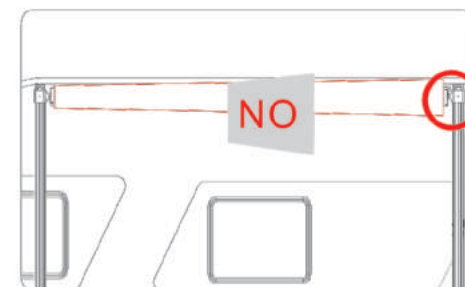
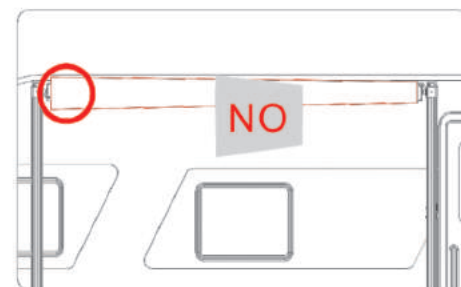

Side view

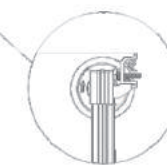

Open steps

ALEKO®

Step.1

Release the inner and outer arm-lock each side.

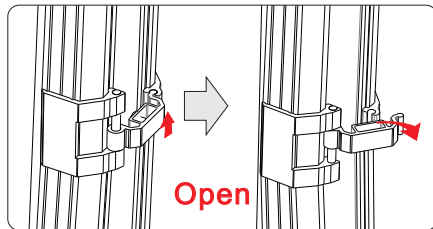

Step.2

Turn down the spring lock according the pic. marked direction.

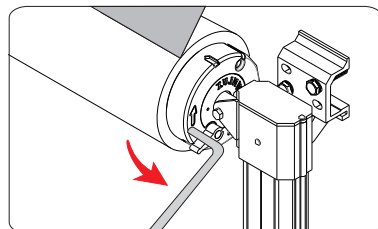

Step.3

Grab the pull strap with the pull rod. Now pull the construction open until the outside arms are parallel to the ground.

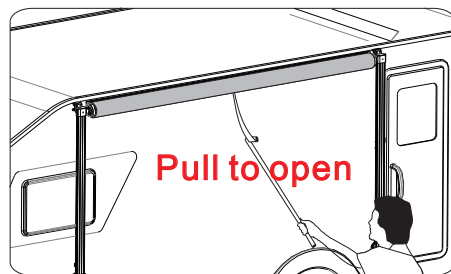

Step.4

Open the wheel-lock of the inside arms and move the arms to the end of the fabric-tube. Then tighten their wheel-locks each side.

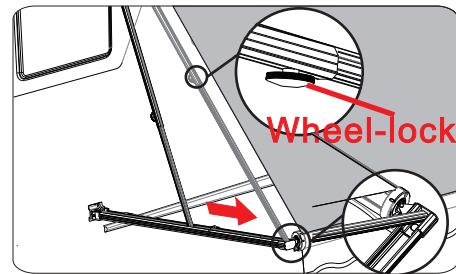

Step.5

Keep the pull strap nicely by pulling it on one end of the fabric-tube and wrap the strap around the arm.

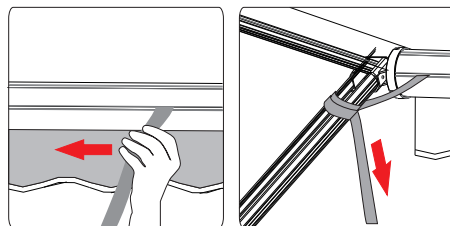

Step.6

Now you can lift up the arm by opening the handle-lock on the outer arms and stretch them as long as you like (ranging from 1.75 to 2.87m).

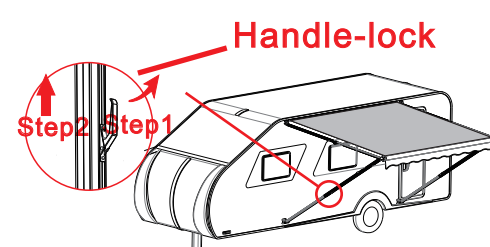

Step.7

Release the outer arms from their bottom brackets by pushing the little lever. Take care that the construction won't be twisted too much doing so. You may post the outer arms in a good 90 degree angle to the ground. Now adjust the necessary height and then fix the tubes with their locks.

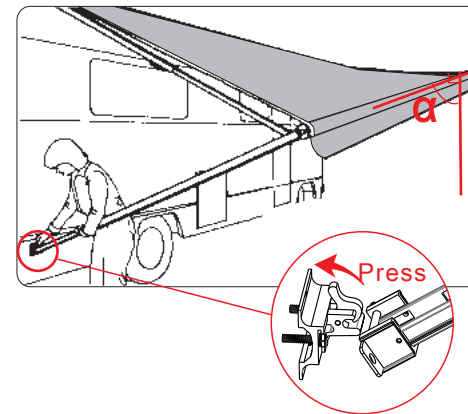

Step.8

Fix the bottom plates of the poles with the steel-peg. That way the outer arms become the poles of the awning.

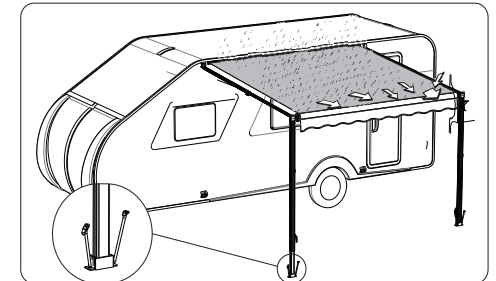

Outer arms / poles There should be a little inclination of the fabric against the ground in order to let rain-water run down from the fabric!

Close steps

Step.1

Pull out the pegs from the bottom-plate of the outer arms.

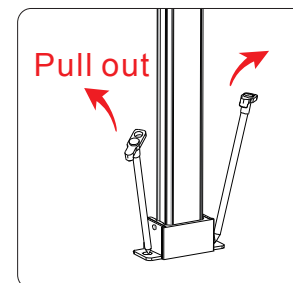

Step.2

Lift up the outer arms and pull them back into their bottom-bracket on the caravan sidewall by opening the bottom-bracket-locks.

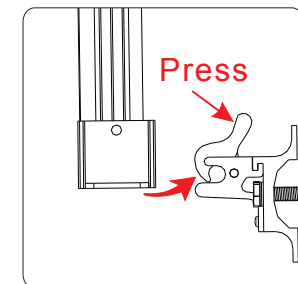

Close steps

Step.3

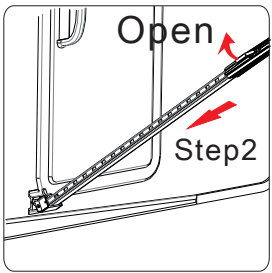

Now open the handle-lock and slide the two tubes of the outer arms into another.

Step.5

Press the buttons inside the outer arms and now slide the two tubes of the inner arm into each other.

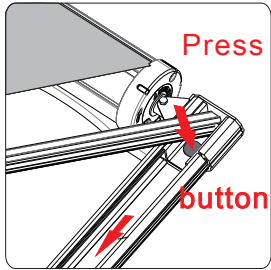

Step.7

Grab the pull strap and put it in the middle of the fabric-tube and then pull the awning slightly, then let the awning rolls itself up slowly.

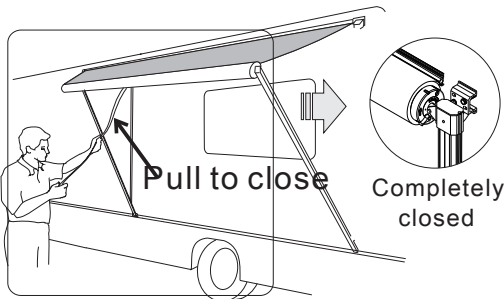

ALEKO®

Step.4

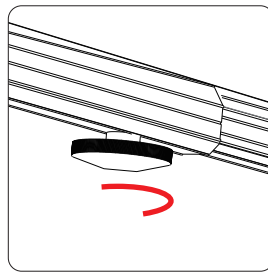

Turn the wheel-lock.

Step.6

Turn up the safety spring lock according to the pic marked direction.

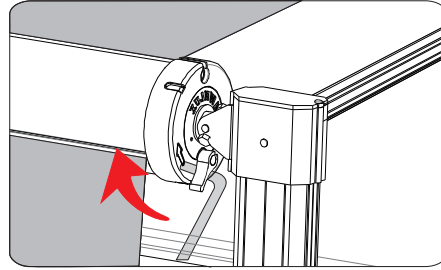

Step.8

Close the inner and outer arm-lock each side.

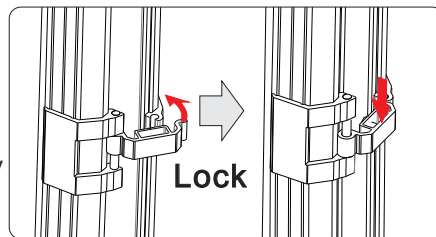

AWNING CARE AND MAINTENANCE CARE

Regularly check if the awning fasteners keep tight , if not, please tight all fasteners. And Periodically clean the awning fabric and arms.

HOW TO CLEAN FABRIC

Monthly flush off the awning fabric with clean water and thorough cleaning the fabric with soft brush and warm water every one or two years.

PLEASE NOTE

When you clean the fabric , only the natural soap and clean water. Never detergent, old based cleaners or any caustic, granulated or abrasive type cleaners. Air- dry, Roll up the awning until the fabric is dry thoroughly.

HOW TO CLEAN AWNING ARMS

Regularly wash out the arm channels with hose off water in case of dirt and debris cause the arm channels not to slide easily. It is better if you can lightly spray the inside of the channel with dry silicone lubricant.

To clean the arms periodically, it is the best way to keep the awning arms and braces operating smoothly.

After the arms have been cleaned and dried thoroughly, open the arm locks, then sprayed with dry lubricant to prevent binding and locking



ATTENTION

Please make sure that all parts of the awnings are safely locked when you are not using it!