

# LG WashTower™ Pre-Delivery Cheat Sheet

## STEP 1 | Watch the Measure First Video

The video explains how to **Walk the Path** to ensure the unit will fit through doorways and can be properly moved into the designated space. It also covers how to determine fuel type and required accessories.



## STEP 2 | Confirm the Customer's Fuel Type

### Gas Requirements



### Electric Requirements



**IMPORTANT!** For Electric Dryers, customers need to know whether they have a 3-prong or a 4-prong outlet to purchase the correct cord. Most electric power cords are 4-6 ft long. Be sure to purchase a cord long enough to reach from the top of the dryer to the outlet.

## STEP 3 | Confirm All Required Accessories Have Been Purchased

Click your Model type to view required accessories and the Customer Checklist.

### Gas Models

#### With Steam Dryer

- WKGX201HBA
- WKGX201HWA
- WSGX201HNA

#### Without Steam Dryer

- WKG101HVA
- WKG101HWA

### Electric Models

#### With Steam Dryer

- WKEX200HBA
- WKEX200HWA
- WSEX200HNA

#### Without Steam Dryer

- WKE100HVA
- WKE100HWA

# LG WashTower™ Customer Checklist

## Models with Steam Dryer

- WKEX200HBA
- WSEZ200HNA
- WKEX200HWA

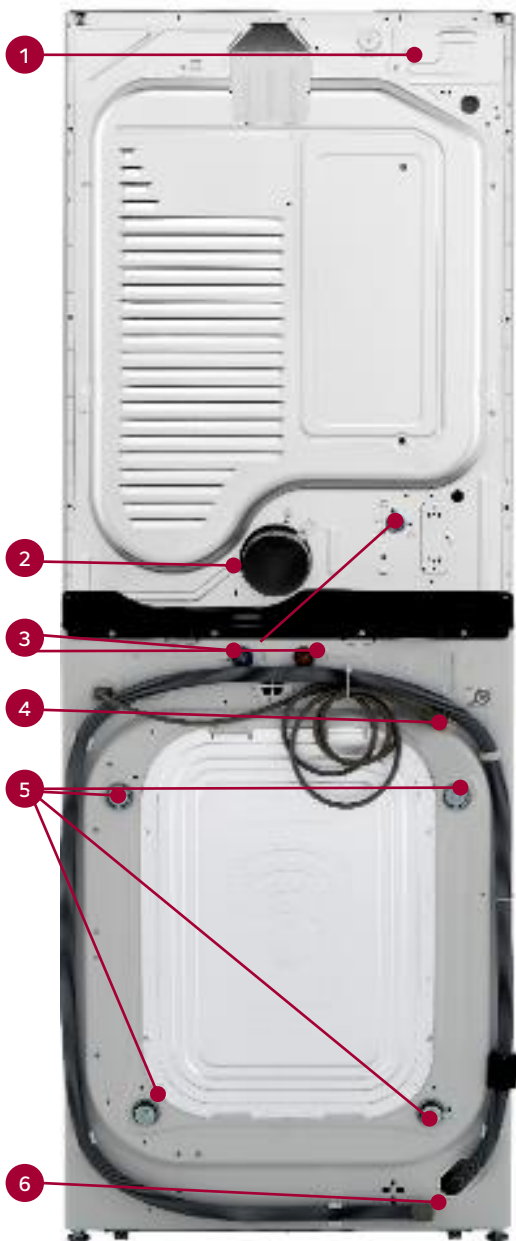

## 1 | Measure First & Confirm Fuel Type

- Watch Measure First Video
- Confirm 120V, 15-Amp Outlet (For Washer)
- Confirm 240V, 30-Amp Outlet (For Dryer)
- Locate the Water Line and Shut Off Valve



## 2 | Purchase Required Accessories

**IMPORTANT!** These accessories are sold separately and are required for proper installation.

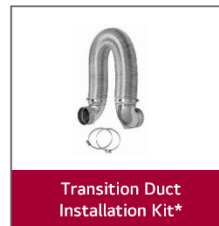

## 3 | Follow Delivery Day Install Steps

- 1 Install 1 Power Cord in Block Access Panel  
Check if 3 or 4 for 240V, 30A Outlet
- 2 Install Ducting to Dryer Exhaust Vent Outlet
- 3 Install 2 Hoses for Hot and Cold Water Inlets
- 4 Remove 4 Shipping Bolts Prior to Installation
- 5 Plug 1 power cord for both Washer & Dryer into 120V, 15-Amp Outlet\*
- 6 Install Drain Hose
- 7 Activate **ThinQ Care**  
Download the LG ThinQ® App to activate ThinQ Care.

\* Unit may not work properly on 120 V GFI outlet. Check owner manual for complete installation guidelines and instructions.