

USE AND CARE GUIDE

22 in. LED Indoor/Outdoor Ceiling Fan with Remote Control

120V 60Hz 0.61A Weight of the fan with light kit: approx. 20.86lbs



Questions, problems, missing parts? Before returning to the store,
call Home Decorators Collection Customer Service
8 a.m. - 7 p.m. , EST, Monday - Friday, 9 a.m.- 6 p.m. , EST, Saturday

1-800-986-3460

HOMEDEPOT.COM/HOMEDECORATORS

THANK YOU

We appreciate the trust and confidence you have placed in Home Decorators Collection through the purchase of this 22 in. LED Indoor/Outdoor Ceiling Fan with Remote Control . We strive to continually create quality products designed to enhance your home. Visit us online to see our full line of products available for your home improvement needs. Thank you for choosing Home Decorators Collection!

Table of Contents

Table of Contents	2	Package Contents	4
Safety Information	2	Tools Required	5
Warranty	3	Hardware Included	5
What is cover	3	Installation	6-14
What is not covered	3	Operation	15-16
Pre-Installation	3	Maintenance	17
		Trouble Shooting	18

Safety Information



WARNING:

Read all safety warnings and all instructions.

Failure to follow the warnings and instructions may result in electric shock, fire and/or serious injury.

READ AND SAVE THESE INSTRUCTIONS

- Use this unit only in the manner intended by the manufacturer. If you have questions, contact the manufacturer.
- Before beginning installation, read and understand all instructions and safety information. Thoroughly review all assembly information and drawings and be sure you understand the assembly requirements.
- Before installing, servicing, or cleaning unit, switch power off at service panel and lock the service disconnecting means to prevent power from being switched on accidentally. When the service disconnecting means cannot be locked, securely fasten a prominent warning device, such as a tag, to the service panel.
- Installation work and electrical wiring must be done by qualified person(s) in accordance with all applicable codes and standards, including fire-rated construction.
- Installation and wiring must be in accordance with the National Electrical Code, ANSI/NFPA 70 and all local codes. If you are unfamiliar with or unable to comply with these requirements, have ceiling fan installed by a licensed electrician.
- When cutting or drilling into wall or ceiling, do not damage electrical wiring and other hidden utilities.
- If this unit is to be installed over a tub or shower, it must be marked as appropriate for the application and be to a GFCI (Ground Fault Circuit Interrupter) — protected branch circuit.
- Do not bend the blade brackets when cleaning the fan. Do not insert foreign objects in between rotating fan blades.
- Mount ceiling fan directly to a structural framing member or to a metal outlet box marked “Acceptable for Fan Support of 35 lbs. or less. For outlet box mounting, use mounting screws provided with the outlet box.
- When using an existing outlet box, make sure it is securely attached to the building structure and can support the full weight of the fan. Most outlet boxes commonly used for the support of lighting fixtures are not acceptable for fan support and would therefore need to be replaced. Do not use a plastic outlet box. Failure to follow this instruction can result in serious injury or death.
- To reduce the risk of injury to persons, install ceiling fan so that the blade guard is at least 7 feet above the floor.
- Ensure power is off before beginning installation. After making the wire connections, wires should be spread apart with the grounded conductor and the equipment grounding conductor on one side of the outlet box and the ungrounded conductor on the other side of the outlet box. Splices should be turned upward and pushed carefully up into the outlet box.
- Always turn fan off and allow to come to a complete stop before reversing blade direction.
- When installation is complete, make sure all connections are secure to prevent ceiling fan from falling.
- All set screws must be checked, and retightened where necessary, before installation.
- After making the wire connections, the wires should be spread apart with the grounded conductor and the equipment-grounding conductor on one side of the outlet box and the ungrounded conductor on the other side of the outlet box.
- The splices after being made should be turned upward and pushed carefully up into the outlet box.
- Save these instructions. Refer to them frequently and use them to instruct others who may use this product. If you loan someone this product, loan them these instructions also.

Warranty

1-YEAR LIMITED WARRANTY

WHAT IS COVERED

The manufacturer warrants this product to be free from manufacturing defects in the material and workmanship under normal use for a period of one year after the date of purchase by the original purchaser.

WHAT IS NOT COVERED

This warranty does not cover transit damages. This warranty does not apply to damages from accident, misuse, alteration of any kind to the fan or where the connected voltage is more than above the nameplate voltage. This warranty does not apply to the finish on any portion of the product. Servicing performed by unauthorized persons shall render the warranty invalid.

This warranty is not responsible for damages of any kind, including accident and consequential damages. Some states do not allow the exclusion or limitation of the incidental or consequential damages, so the above exclusion or limitation may not apply to you. This warranty gives you specific legal rights, and you may also have other rights which vary from state to state.

Contact the Customer Service Team at 1-800-986-3460 or visit www.HOMEDEPOT.com/HOMEDECORATORS.

Pre-Installation



WARNING: Items in this section are not assembled to the product by the manufacturer and require installation. Use of a product that may have been improperly assembled could result in serious personal injury.



WARNING: To reduce the risk of fire, electric shock, or injury to persons, unplug or disconnect the appliance from the power supply before the fan installation, cleaning, or servicing.



WARNING: To reduce the risk of personal injury, do not bend the blade brackets when installing the brackets, balancing the blades, or cleaning the fan. Do not insert foreign objects in between rotating fan blades.



WARNING: To reduce the risk of fire or electric shock, do not use this fan with any solid-state speed control device.



WARNING: If any parts are damaged or missing, do not operate this product until the parts are replaced. Use of this product with damaged or missing parts could result in serious personal injury.



WARNING: Do not attempt to modify this product or create accessories not recommended for use with this product. Any such alteration or modification is misuse and could result in a hazardous condition leading to possible serious personal injury.

- Remove all parts from the package, and verify that everything listed in this **Package Contents** section are present.
- Inspect the product carefully to make sure no breakage or damage occurred during shipping.
- Do not discard the packing material until you have carefully inspected and satisfactorily operated the product.

Pre-Installation (continued)

PACKAGE CONTENTS

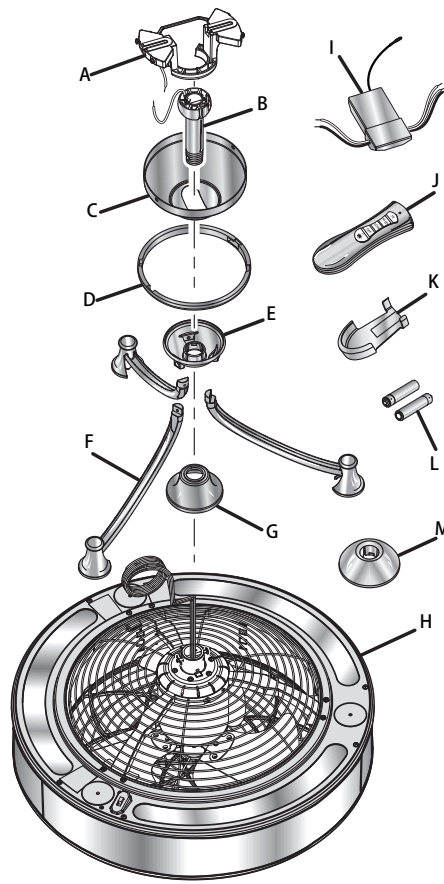

Part	Description	Quantity
A	Mounting bracket assembly*	1
B	Pivot ball/downrod assembly	1
C	Canopy*	1
D	Canopy screw cover ring*	1
E	Center arm support	1
F	Decorative legs	3
G	Motor housing cap	1
H	Fan assembly	1
I	Remote receiver	1
J	Remote control	1
K	Remote control wall mount	1
L	Remote control AAA batteries	2
M	Center arm support cover**	1

*For packing purposes, the mounting bracket assembly, canopy, and canopy screw cover ring are assembled together.

**This part is used only if ceiling fan using an extended-length downrod longer than one provided in this package.

Pre-Installation (continued)

TOOLS NEEDED

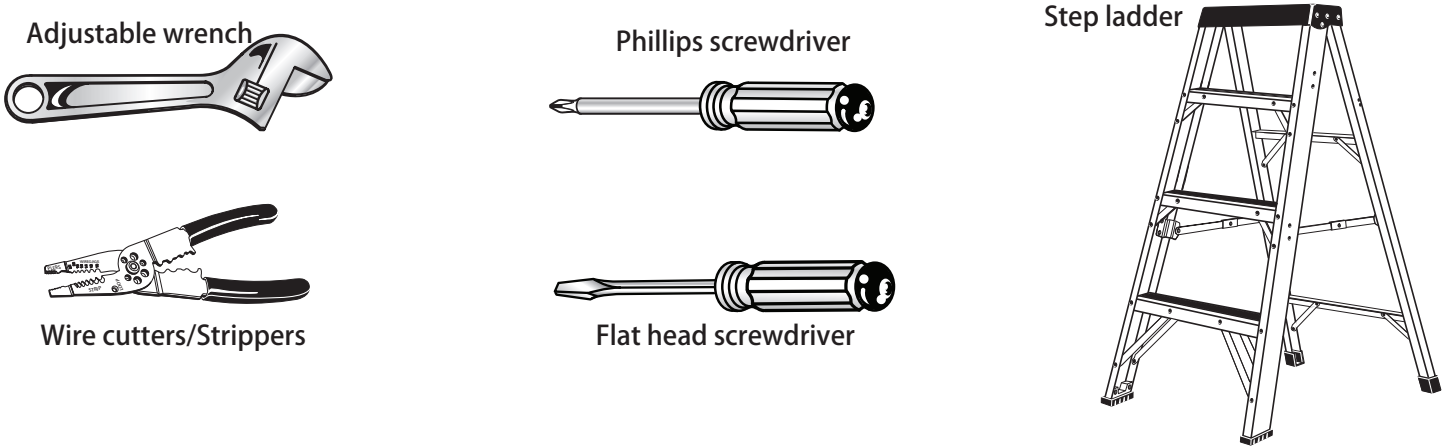

HARDWARE INCLUDED



Part	Description of Enclosed Installation Hardware	Quantity
A	Canada installation hardware bag	1
B	Phillips cap screws	4
C	Phillips cap screw covers	4

Installation



WARNING: To reduce the risk of fire, electric shock, or personal injury, turn off power to room and wall switch by removing fuses or turning off circuit breakers as needed before beginning installation.



WARNING: Mount fan only to a metal outlet box marked acceptable for fan support and use only the mounting screws provided with the outlet box. Plastic outlet boxes and outlet boxes commonly used for the support of lighting fixtures may not be acceptable for fan support and may need to be replaced. If you are unsure whether your outlet box is appropriate or uncertain about the proper method for mounting your ceiling fan, contact a qualified electrician.

- If your installation site does not have an existing UL-listed metal outlet box, one must be installed before proceeding. Make sure box is mounted directly to the building structure using ceiling joist screws provided with the box. Once installed, there must be at least 7 ft. clearance between the bottom of the ceiling fan and the floor. Ceilings taller than 8 ft. may benefit from an extended length downrod (not included) to achieve the best results.
- **NOTE:** Extended-length downrods longer than 48 in. will also require a downrod wire extension kit (not included, available from the retailer where you purchased your fan).
- Angled ceilings must not be steeper than 30° from the horizontal canopy.

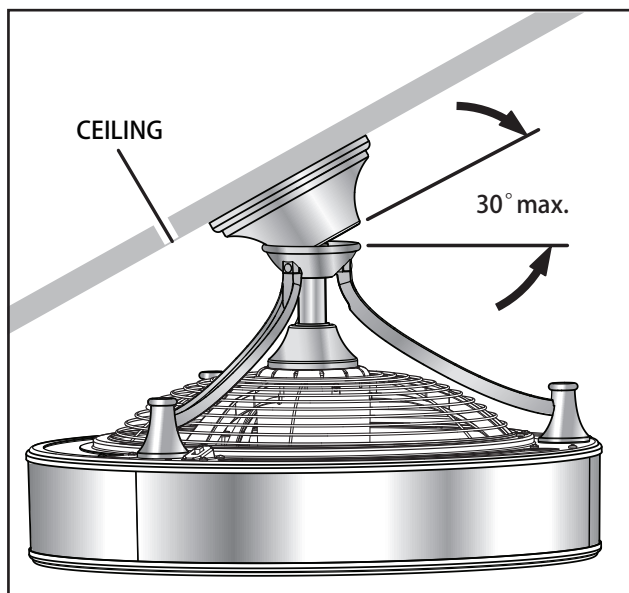

1 INSTALLING THE CEILING FAN MOUNTING BRACKET ASSEMBLY

- The mounting bracket assembly, canopy, and the canopy screw cover ring are assembled together for shipping purposes. If you haven't already done so, separate these pieces now.
 - Twist the canopy screw cover ring counterclockwise to release.
 - Loosen the two screws over the slots in the canopy.
 - Remove the two screws securing the canopy to the mounting bracket assembly, then twist the canopy counterclockwise to release from the other two screws.

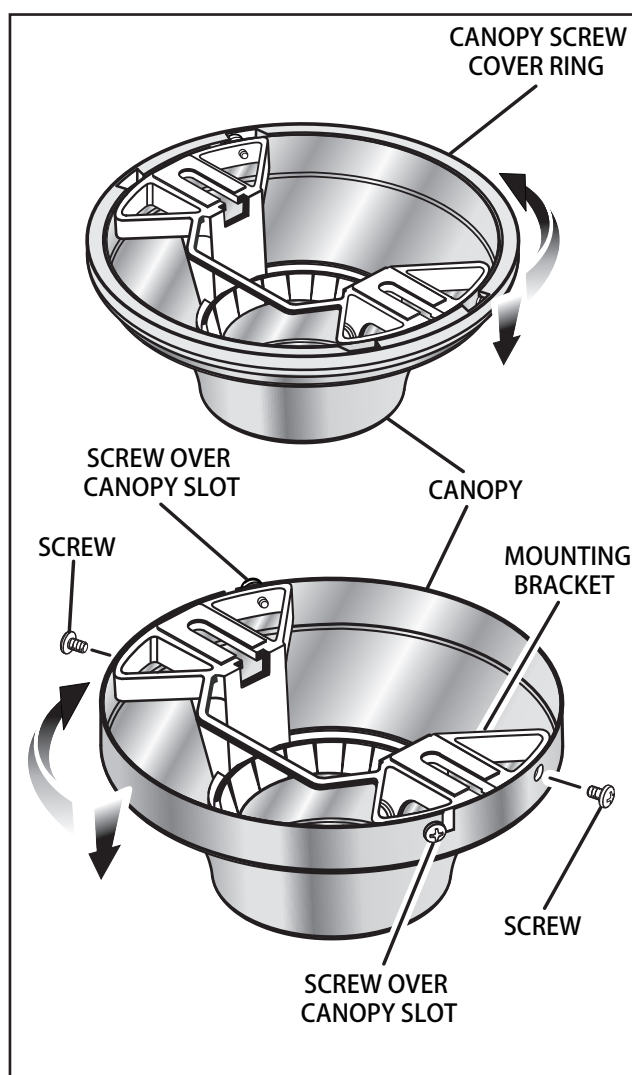

Installation (continued)

- Remove any existing ceiling fan or light where you intend to install this ceiling fan. Verify the existing outlet box is marked acceptable for fan support up to 35 lbs. and that it is securely fastened to the ceiling joists.

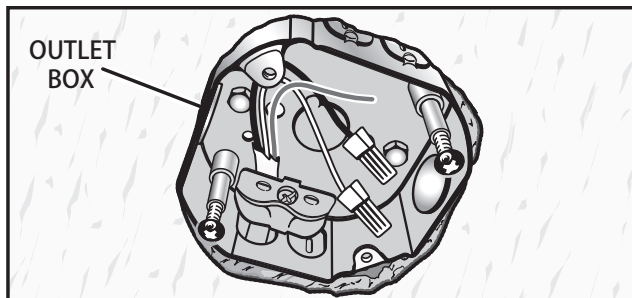

For Canada installations, refer to the Canada Installation Addendum located in the Canada Installation Hardware Bag and install the eye bolt or anchor assembly now.

- Using the screws provided with the outlet box, attach the ceiling mounting bracket assembly to the electrical box, passing the 120V electrical supply wires through the hole in the center of the mounting bracket assembly. **NOTE:** If you are installing the mounting bracket assembly for an angled orientation, make sure the open end of the bracket is installed facing the lower point of the ceiling.

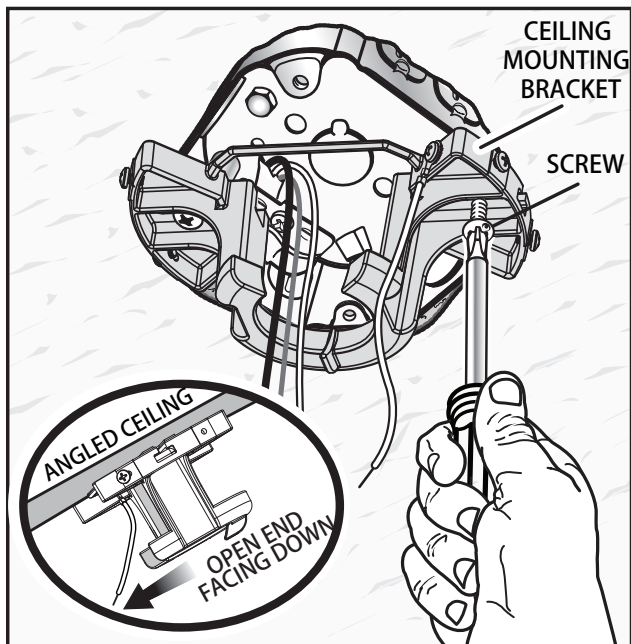

2 PREPARING YOUR CEILING FAN FOR MOUNTING

- Loosen the screw securing the pivot ball to the downrod. Slide the pivot ball down and off the downrod and set aside.

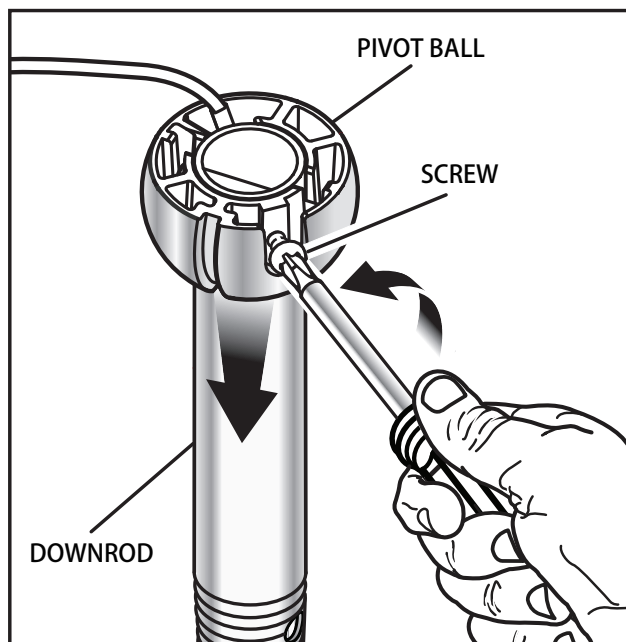

- Remove the retainer pin from the downrod.

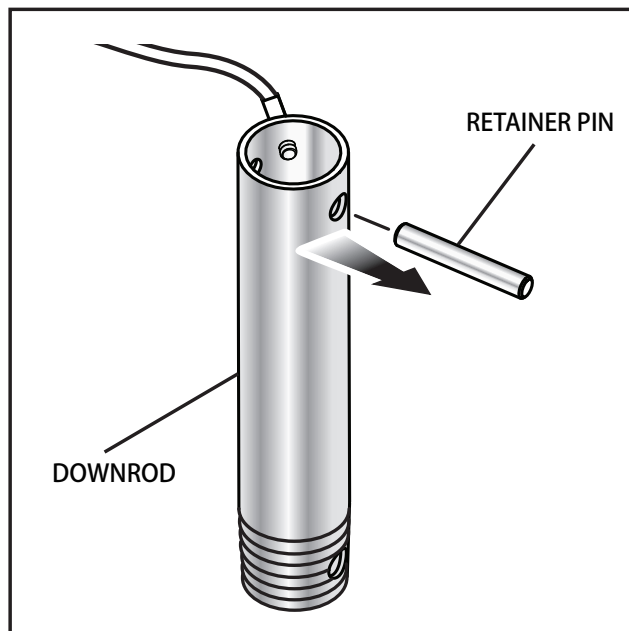

Installation (continued)

- Remove the screw and star washer securing the ground wire terminal to the downrod. Remove the wire and set aside.

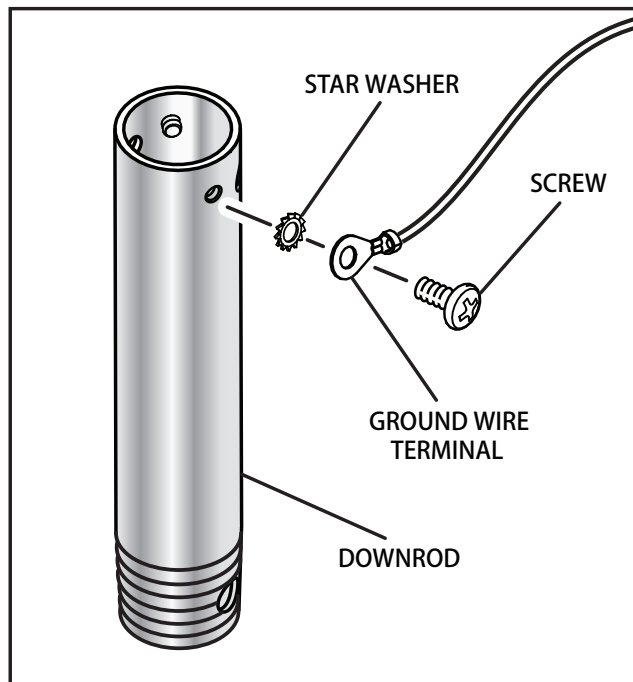

- Loosen (but do not remove) the lock screws securing the downrod to the mounting collar on the fan assembly, then remove the hitch pin and the clevis pin from the mounting collar. Carefully feed the fan's electrical wiring up through the threaded end of the downrod.

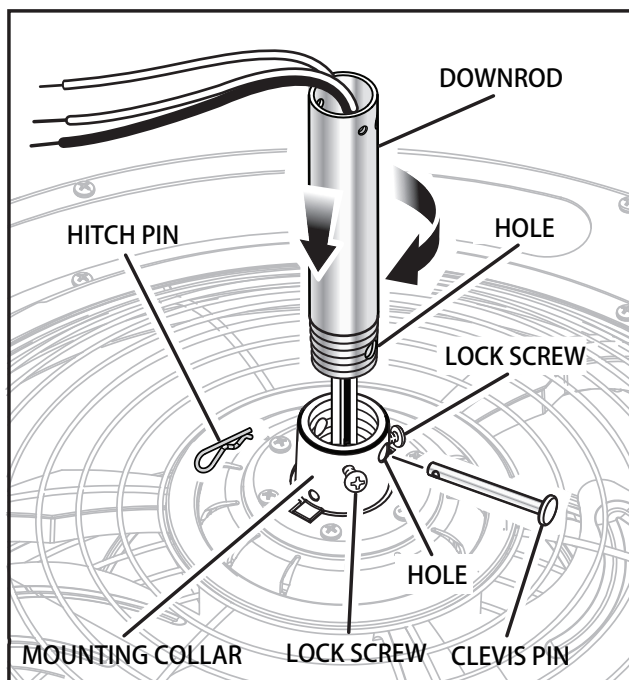

- Thread the downrod into the motor housing until it bottoms out, then back it out until the hole in the downrod aligns with the hole in the motor housing. Be careful not to twist the electrical wiring when tightening.

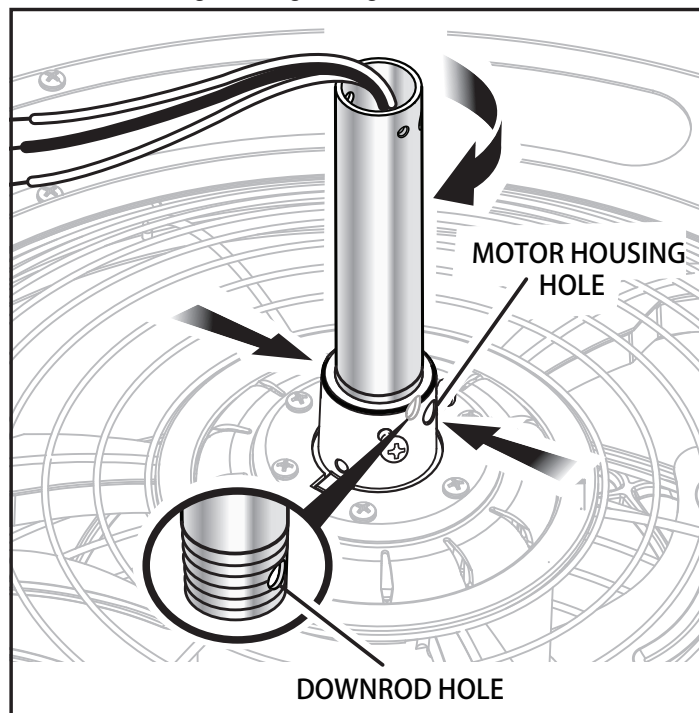

- Install the clevis pin through the holes in the motor housing and the downrod, then reinsert hitch pin. Retighten the lock screws to secure.

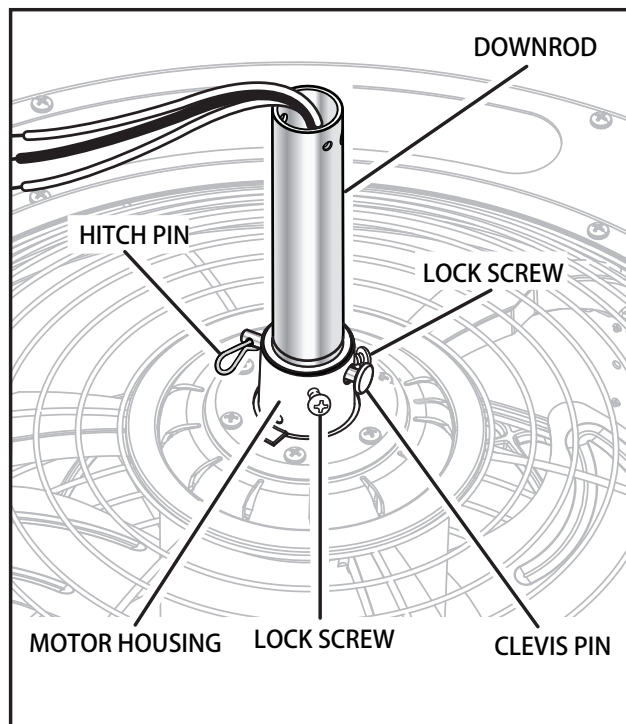

Installation (continued)

- Carefully feed the fan's electrical wiring through the motor housing cap, then install the cap as shown.

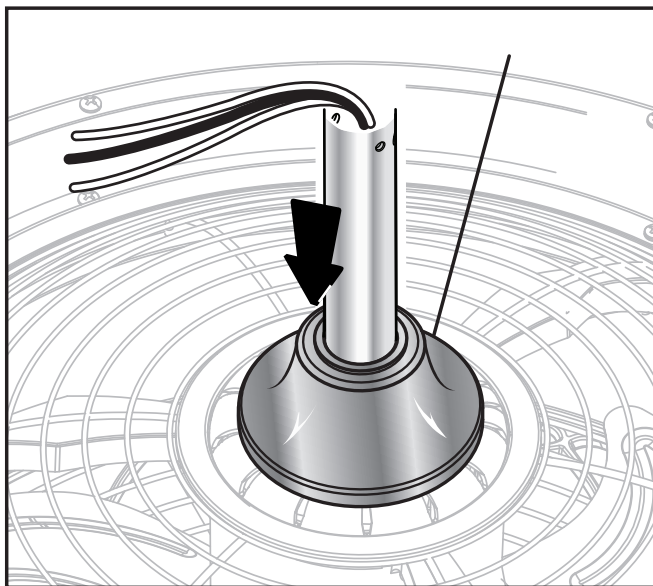

- Carefully feed the fan's electrical wiring through the center arm support, then install the support with the cupped side facing up.

NOTE: If you do not intend to use the decorative arms supplied with this ceiling fan, you can skip this step because the center arm support will not be needed. However, if you are installing using an extended-length downrod (not provided), you may still wish to use the center arm support and the cover discussed in the next step for a more finished appearance, even when not using the decorative arms.

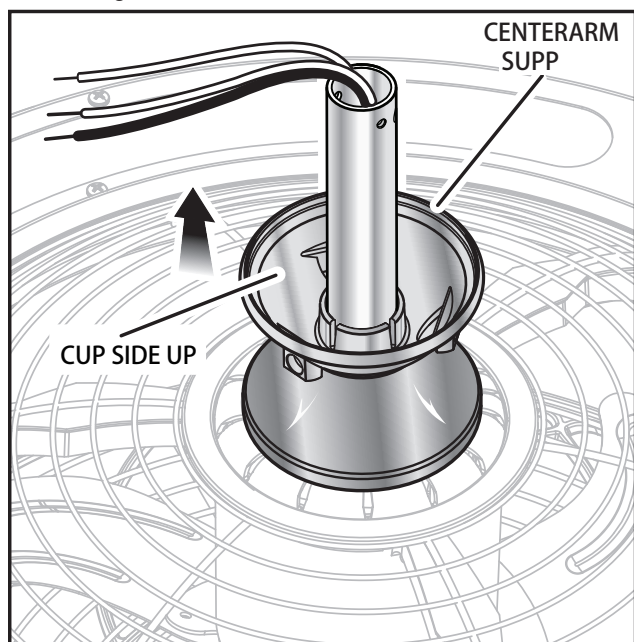

- This step is needed only if you are installing your ceiling fan using an extended-length downrod (not provided) and have installed the center arm support from the previous step. If you are using the downrod provided in this package, or if you are using an extended-length downrod but chose not to install the center arm support, skip this step and proceed directly to installing the canopy screw cover ring and canopy.
- Carefully feed the fan's electrical wiring through the center arm support cover, then install the support with the cupped side facing down.

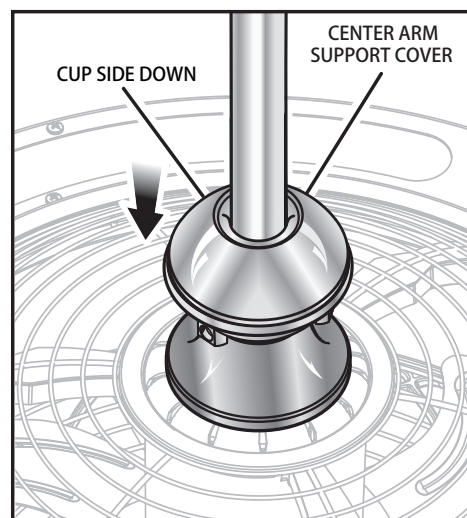

- Carefully feed the fan's electrical wiring through the canopy screw cover ring and canopy, then install the cover ring and canopy on the downrod as shown.

Note: Make sure the notched openings on the rim of the canopy screw cover ring are facing up.

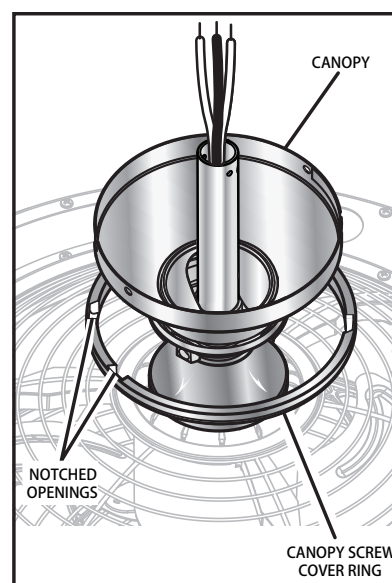

Installation (continued)

- Carefully feed the fan's electrical wiring through the pivot ball, then reinstall the pivot ball on the downrod with the flat side facing the ceiling.

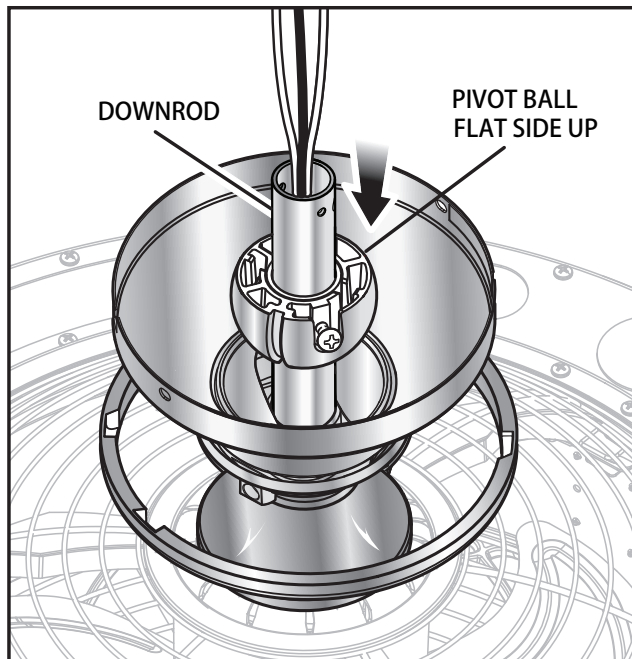

- Reinstall the ground wire with the wire facing up to ensure proper grounding, make sure the star washer is reinstalled in the location shown below.

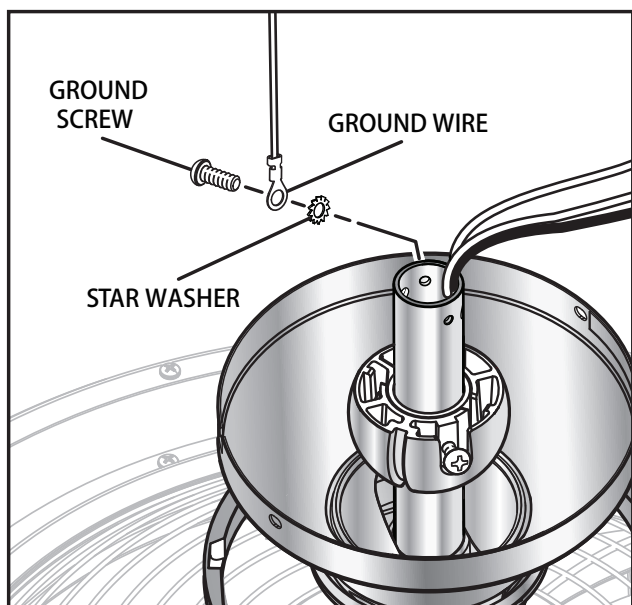

- Reinstall the retainer pin in the downrod.

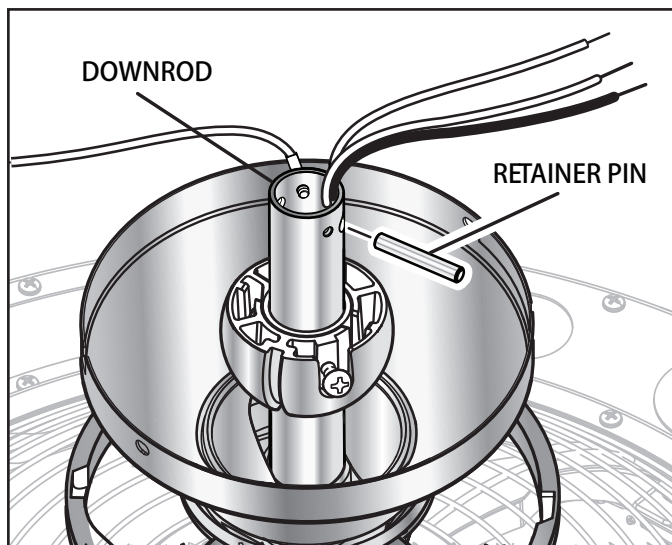

STOP For Canada installations, refer to the Canada Installation Addendum and install the support cable on the retainer pin now.

- Lift the pivot ball back to the top of the downrod until the retainer pin is captured. Tighten the screw to secure.

NOTE: When the pivot ball is oriented correctly, it will also cover the ground screw and will be flush with the top of the downrod.

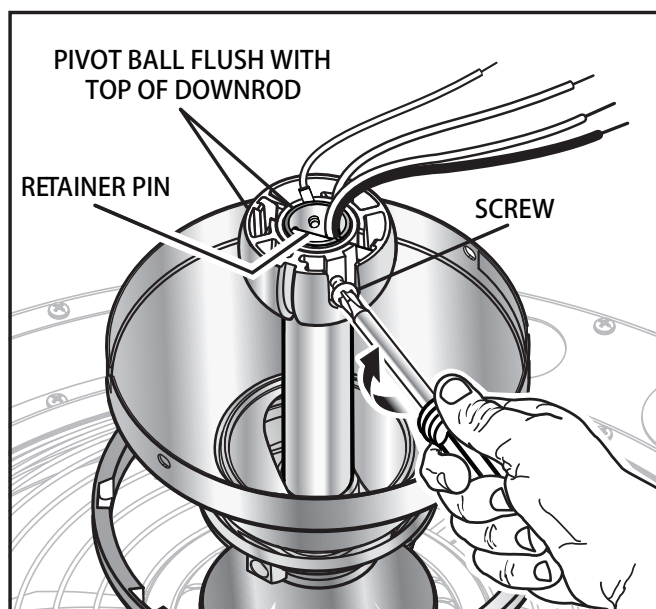

3 HANGING THE CEILING FAN



WARNING

Once you begin the process of hanging the ceiling fan, do not leave the fan unattended until the installation process is complete. A falling fan

- Carefully lift the assembled fan up to the mounting bracket assembly and seat the pivot ball in the mounting bracket socket. Rotate the fan as needed so the tab on the mounting bracket socket seats in the groove in the pivot ball.



WARNING

Failure to engage the fan's tab into the groove on the mounting bracket could allow the fan to wobble and/or fall. A falling fan could cause serious personal injury or death.

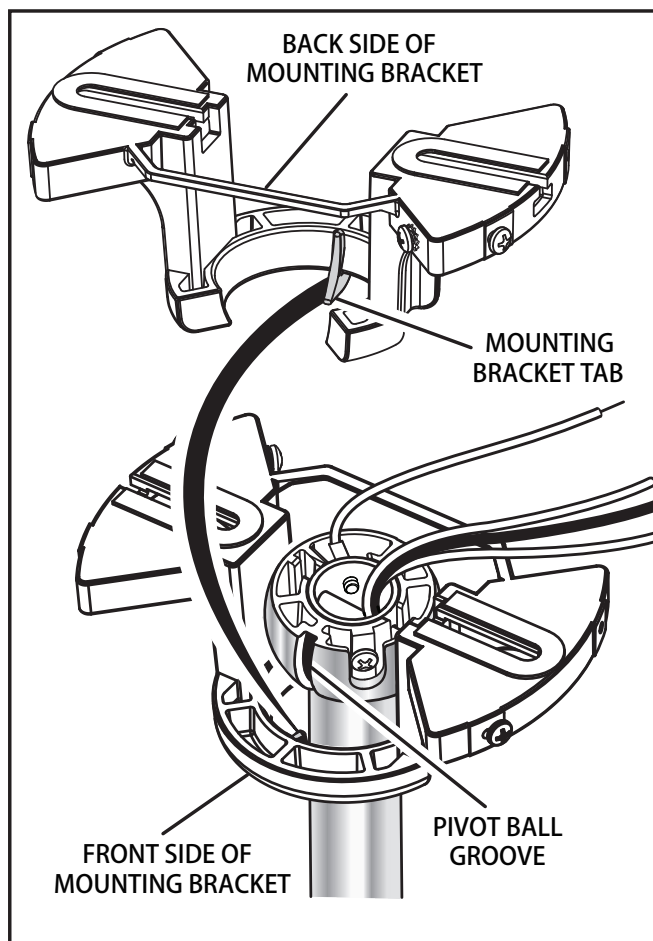

- Verify the DIP switches on the receiver and the remote control are both in the same configuration.

NOTE: The switches can be adjusted as needed to avoid possible interference with other remote units in your home, but always make sure that the same configuration is set on both the remote and the receiver.

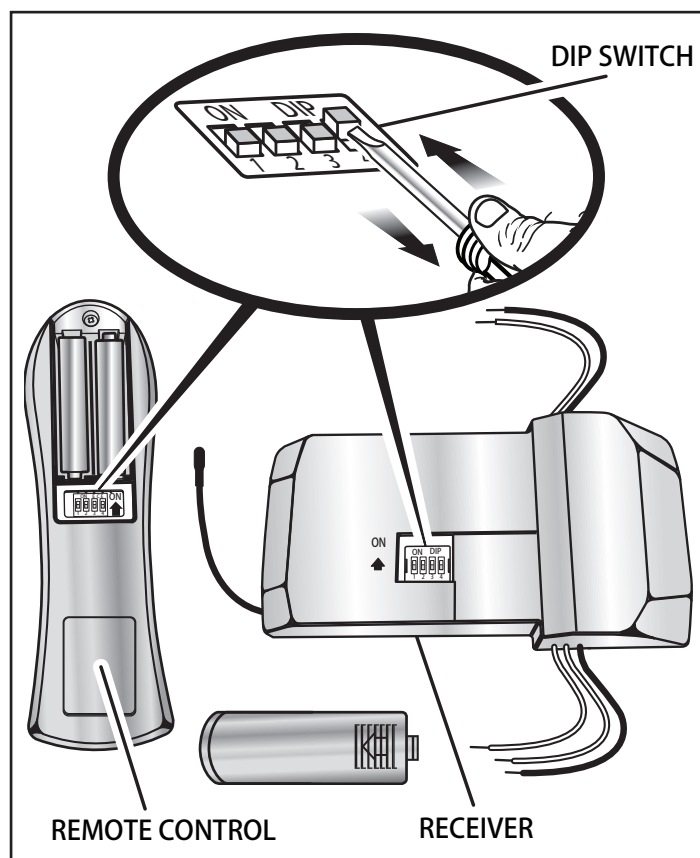

Installation (continued)

4 MAKING THE ELECTRICAL CONNECTIONS



WARNING

Verify the power has been disconnected to both the room and the wall switch before making the electrical connections. Failure to do so could cause fire, electric shock, serious personal injury, or death.

NOTICE:

When shipped, the electrical wires from the ceiling fan offer enough length to accommodate extended length downrods up to 48 in. (not included). For shorter downrods, including the one provided with this fan, this excess length is not needed and should be cut off before making the electrical connections in order to allow enough room for everything to fit inside the mounting bracket. Trim the electrical wires so that only 12 in. of electrical wires extend from the top of the downrod. Failure to trim the electrical wires as noted may make it impossible to fit the receiver into the mounting bracket as described in these instructions.

Connect the ceiling fan to the receiver:

- Connect the ceiling fan black wire to the black wire on the receiver marked TO MOTOR L.
- Connect the ceiling fan white wire to the white wire on the receiver marked TO MOTOR N.
- Connect the ceiling fan blue wire to the blue wire on the receiver marked FOR LIGHT.

Connect the receiver to the 120V electrical supply wires:

- If your outlet box has a ground wire (green or bare copper), connect it to the ground wire on the ceiling fan's pivot ball. If there is no ground wire in your outlet box, connect the ground wire on the pivot ball to the ground wire on the mounting bracket assembly.
- Connect the white (neutral) supply wire to the white wire on the receiver marked AC in N.
- Connect the black (hot) supply wire to the black wire on the receiver marked AC in L.
NOTE: If your electrical box has both red and black hot wires, only one of these will be needed. Choose the supply wire that matches the wall switch you want to use for your ceiling fan. Use a wire cap and electrical tape to seal off the other wire and tuck it back up into the box and out of the way.
- Install a plastic wire nut over each connection to secure. Reinforce with electrical tape as needed to make sure no bare wire is visible at the wire nuts (except for a bare ground wire, if present).

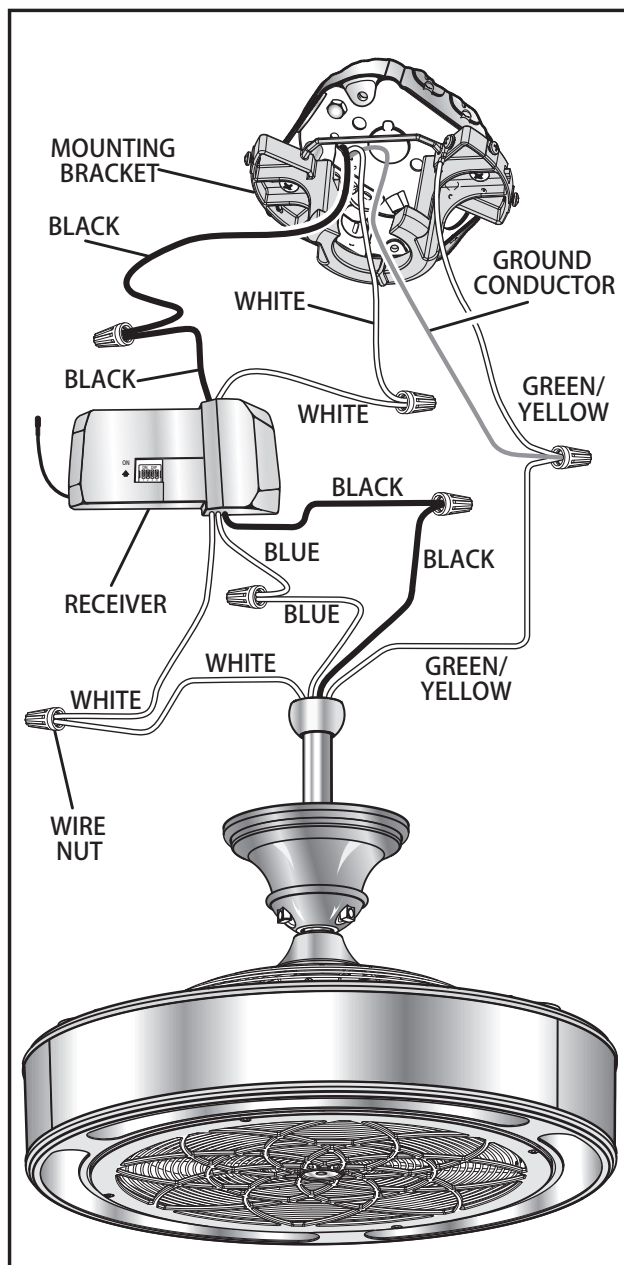

- Spread the wires apart so the green/yellow and white wires go to one side and the black and blue go to the other, then carefully tuck all the wire connections up into the outlet box.
NOTE: Orient the wires so the wire nuts are facing up and are not touching each other. This will help minimize potential noise once the installation is complete.



For Canada installations, refer to the Canada Installation Addendum and connect the support cable to the eye bolt or anchor assembly now.

Installation (continued)

- Place the receiver into the top of the mounting bracket with the flat side facing the ceiling. Tuck the receiver antenna and all wiring up into the mounting bracket, making sure the wires don't become pinched.

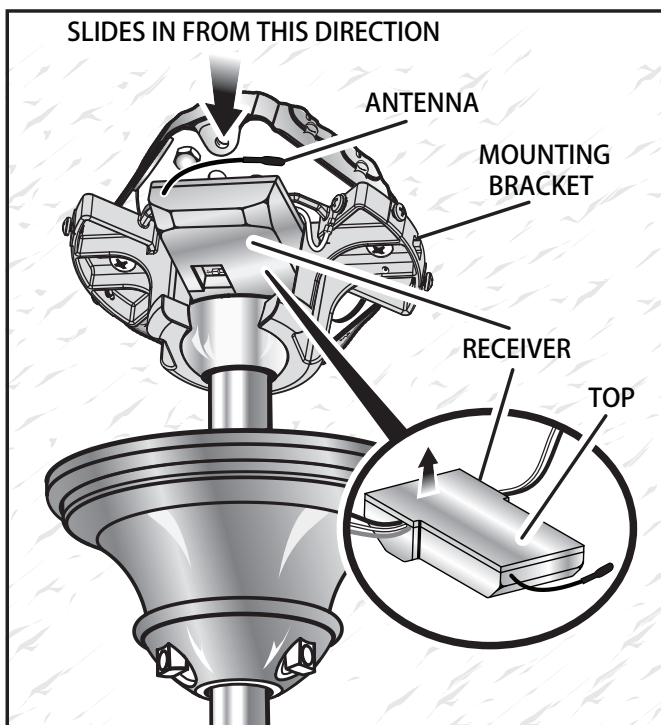

- Slide the canopy up into place and rotate clockwise to lock to mounting bracket assembly. Reinstall the two screws (M4 x 6 mm) removed previously and tighten securely.

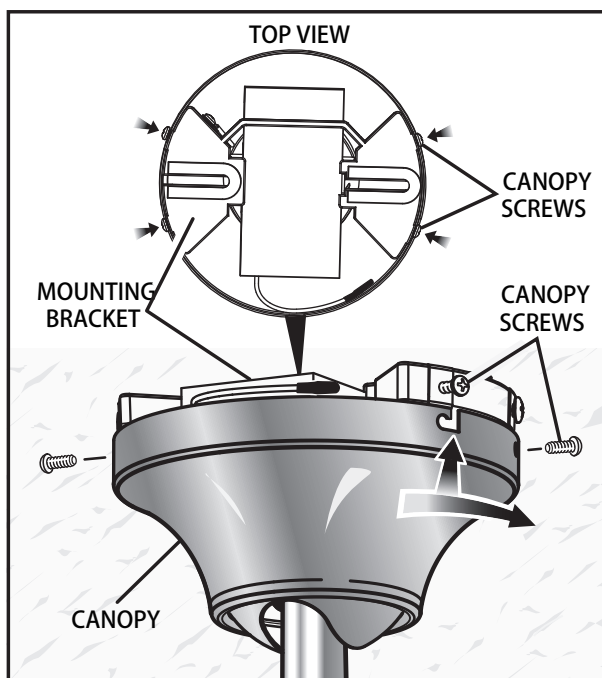

- Lift the screw cover ring up over the screws and twist counterclockwise to secure in place.

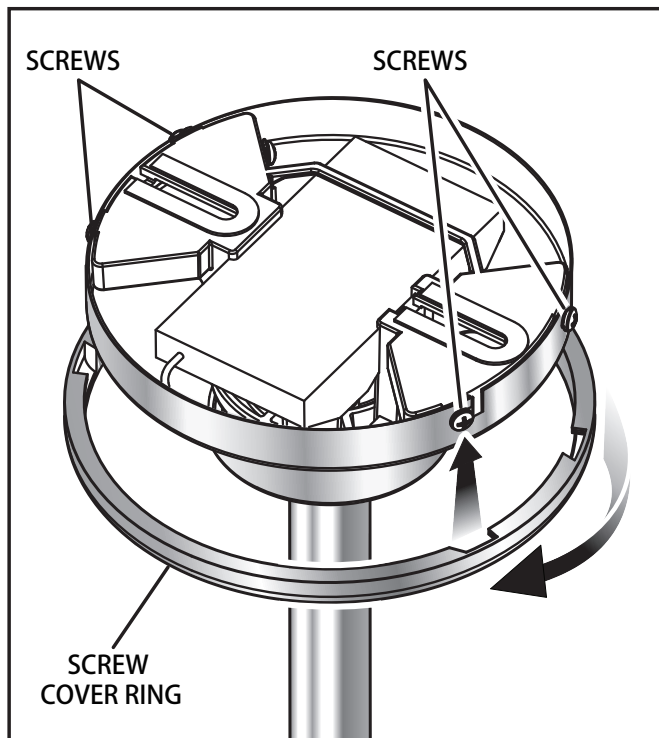

Installation (continued)

□ **NOTICE:**

The decorative arms in the next two steps are not required for fan operation. You may skip these two steps if you do not wish to install the decorative arms.

- Install the decorative arms using a Phillips head screwdriver. Attach one side of each arm to the center arm support using the Phillips cap screws and screw covers as shown.

NOTE: For easier assembly, insert each screw and partially tighten, then go back and fully tighten each screw.

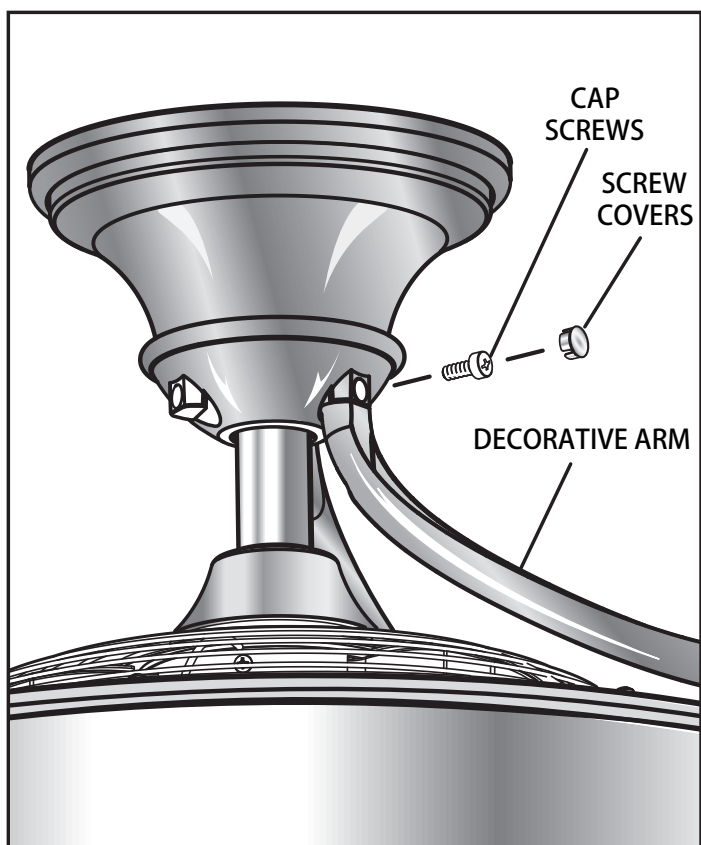

- Finish the assembly by screwing the finial screw on each arm into the threaded holes in the top lens cover.

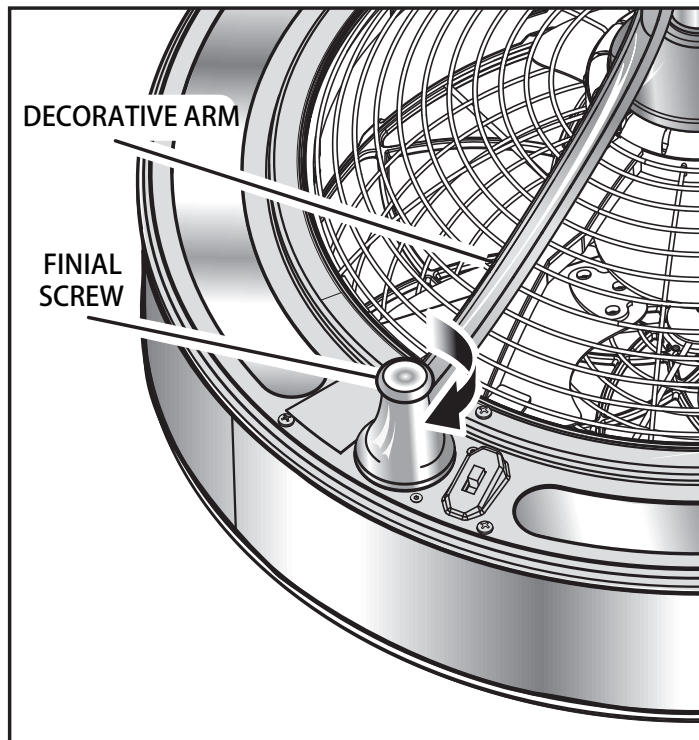

- Restore power to the room and wall switch. Turn on the wall switch, then refer to the remote control operating instructions in the next section to test the fan's operation.

Operation

1 USING THE REMOTE CONTROL

NOTE: If you have not already done so, restore power to the room and wall switch, then make sure the wall switch controlling the fan is turned on. The remote control will have no effect on the fan if the switch is turned off.

- Install the two AAA batteries provided into the remote control.

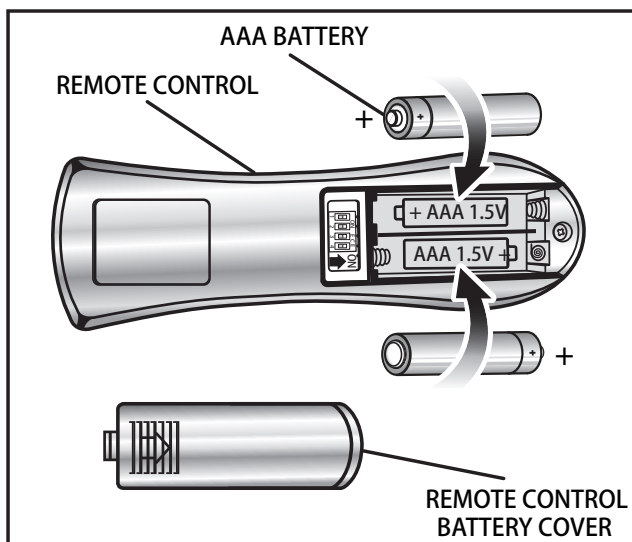

- To turn the light on and off, press and release the button . Press and hold the button to control the brightness of the light.
NOTE: The brightness of the fan light can only be controlled by the remote control. A wall-mounted dimmer switch will not change the light's brightness.
- To set the fan speed, press the desired speed button.
- To turn the fan OFF, press the OFF button.

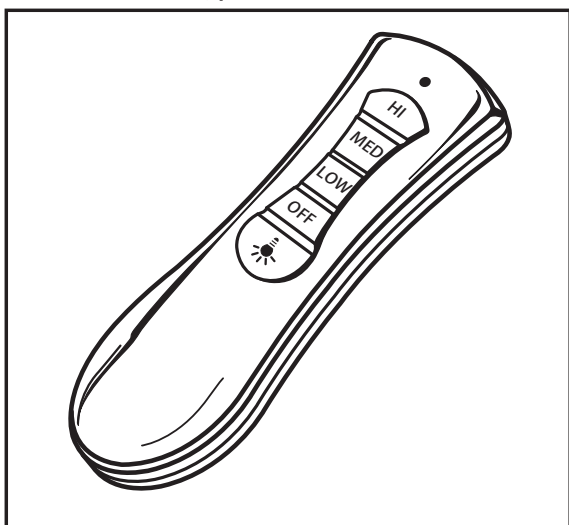

To mount the remote control holder:

- Remove the screw cover from the remote control holder.
- Install the remote control holder in the desired location using the two mounting screws provided.
- Replace the screw cover to cover the screw heads.

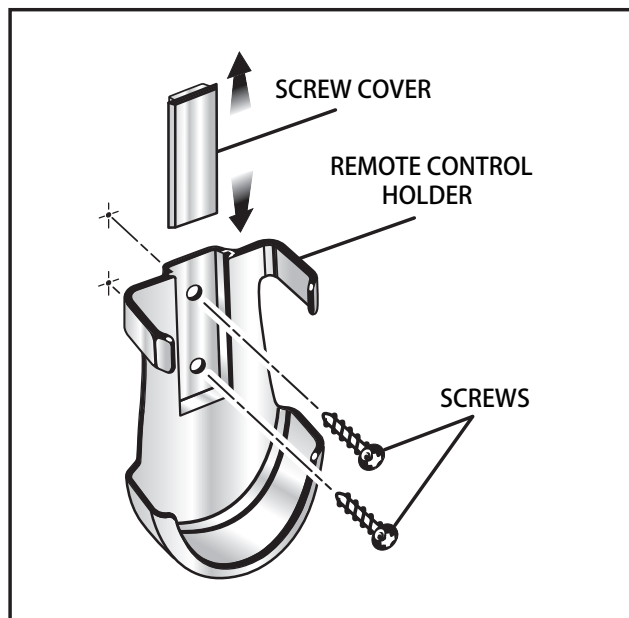

MODEL NO: UC7216T

FCC ID: CHQ7216T

This device complies with Part 15 of the FCC Rules. Operation is subject to the following two conditions:
(1) this device may not cause harmful interference, and
(2) this device must accept any interference received, including interference that may cause undesired operation.

Operation (continued)

2 SETTING THE AIRFLOW DIRECTION

- Choosing the correct airflow direction of the ceiling fan will enhance the fan's performance and make its use more enjoyable. To change the direction of airflow, use the direction switch on top of the ceiling fan's housing.

NOTICE:

Always allow the ceiling fan to come to a complete stop before changing the fan's direction.

- Choose the **DOWN** position to provide a downward air flow. In warmer weather, this direction will provide a constant breeze, creating a wind chill effect for the room's occupants.

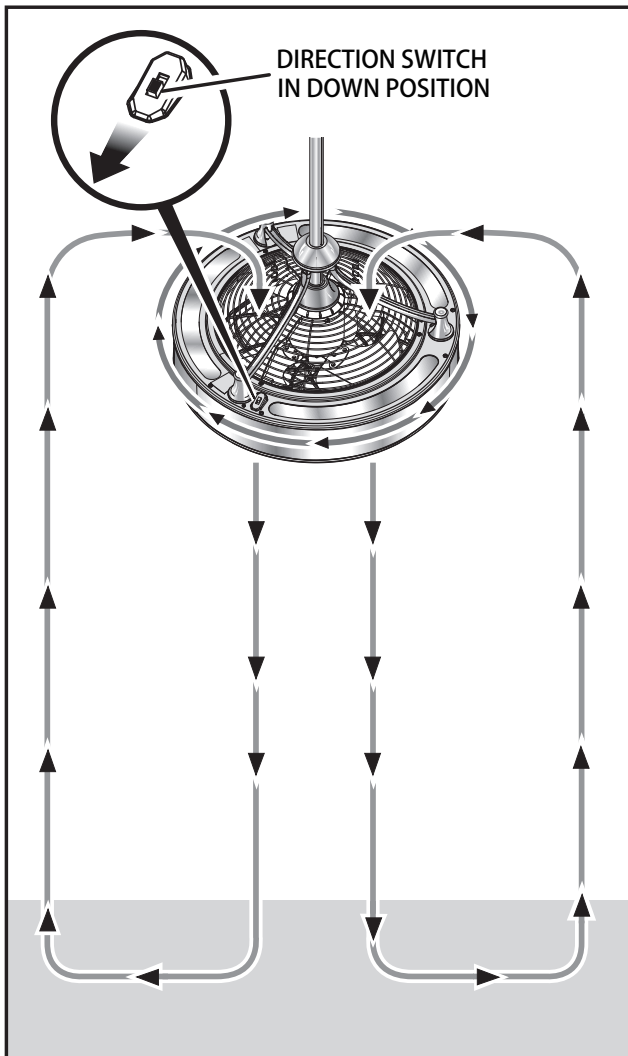

- In cooler weather, choose the **UP** position to provide an upward direction of air travel. This will help circulate warm air off the ceiling and back down into the room.

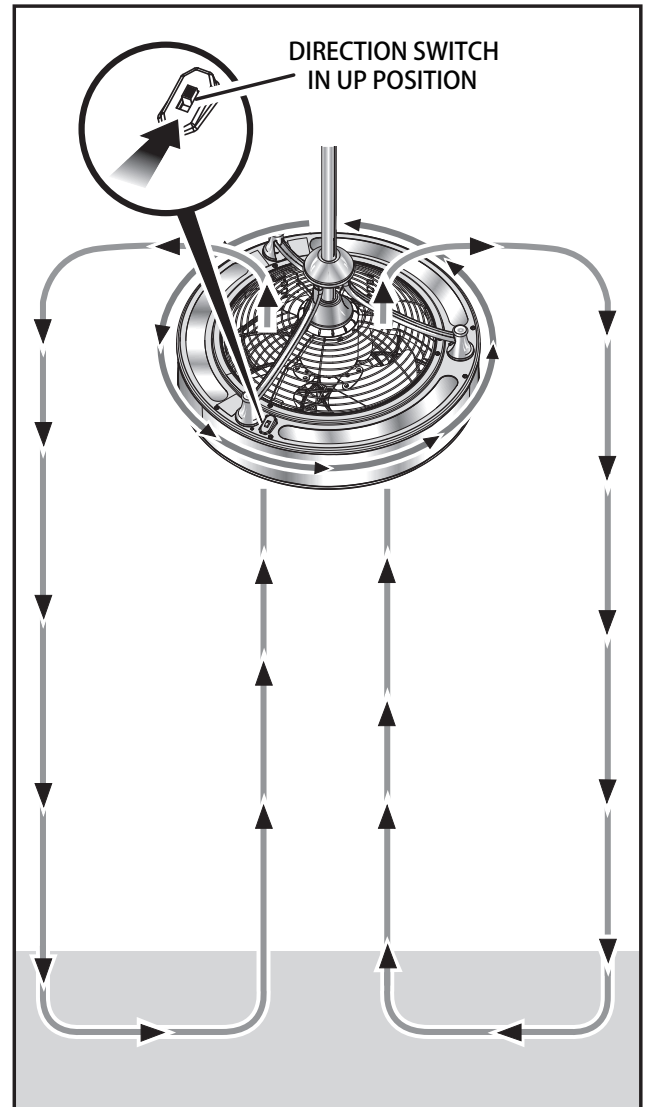

Maintenance

GENERAL CARE AND CLEANING

- Due to the natural movement of a ceiling fan, connections can become loose over time. Check all the ceiling fan's connections (not including the electrical connections) at least twice a year.
- The fan has permanently lubricated sealed bearings, therefore no further lubrication is required.
- Clean your fan periodically to help maintain its new appearance over time. Use only a soft brush or lint-free cloth to avoid scratching the finish. The plating is sealed with a lacquer to minimize discoloration or tarnishing. Do not use water when cleaning, as this could damage the motor or cause an electrical shock. When shipped, the blade and guard on the ceiling fan are preassembled. To disassemble for cleaning purposes:



WARNING

Turn off power to room and wall switch by removing fuses or turning off circuit breakers as needed before disassembling the ceiling fan. Failure to do so can cause serious personal injury.

- Remove the screws securing the decorative grill, then remove the decorative grill.
- Remove the guard screws, then remove the blade guard.
- Remove the set screws at the top of the blade head using a 3 mm hex wrench (not provided).
- Remove the blade from the motor shaft.
- To reassemble the fan:**
- Reinstall the blade on the motor shaft so the shaft opening on the blade straddles the recessed area on the blade shaft.
- Reinstall the set screws and tighten securely.
- Reinstall the blade guard and guard screws; tighten securely.
- Reinstall the decorative grill and screws; tighten securely.

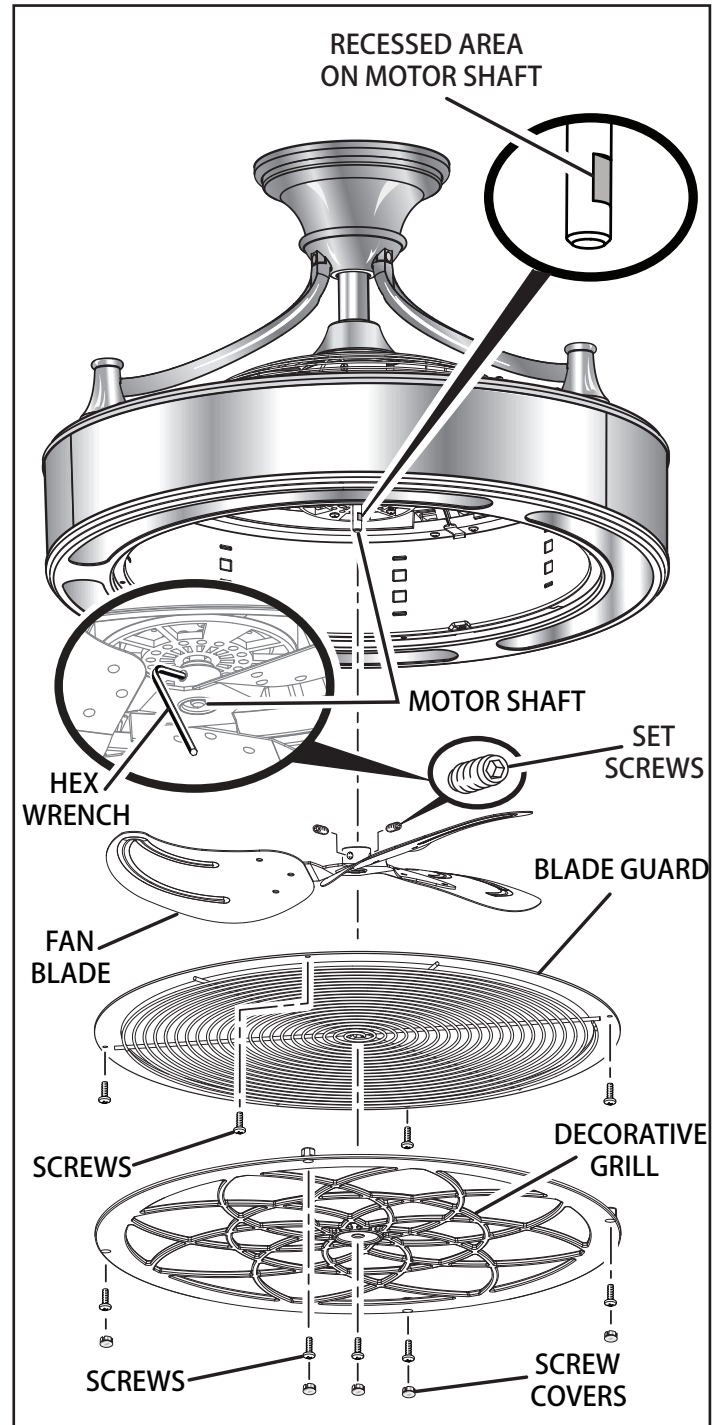

FCC Statement

This equipment has been tested and found to comply with the limits for a Class B digital device, pursuant to Part 15 of the FCC Rules. These limits are designed to provide reasonable protection against harmful interference in a residential installation. This equipment generated uses and can radiate radio frequency energy and, if not installed and used in accordance with the instructions, may cause harmful interference to radio communications. However, there is no guarantee that interference will not occur in a particular installation. If this equipment does cause harmful interference to radio or television reception, which can be determined by turning the equipment off and on, the user is encouraged to try to correct the interference by one or more of the following measures:

- Reorient or relocate the receiving antenna.
- Increase the separation between the equipment and receiver.
- Connect the equipment into an outlet on a circuit different from that to which the receiver is connected.
- Consult the dealer or an experienced radio/TV technician for help.

CAUTION:

Any changes or modifications not expressly approved by the grantee of this device could void the user's authority to operate the equipment.

This device complies with Part 15 of the FCC Rules. Operation is subject to the following two conditions:

- (1) This device may not cause harmful interference, and
- (2) this device must accept any interference received, including interference that may cause undesired operation.

The following responsible party designated in FCC §2.909 is responsible for this declaration:

Model Number: SFL-550L1, SFL-550L2, SFL-550L3, SFL-550L4

Company Name: CM Development Inc.

Company Address: P.O. Box 90962, CA 91715, USA



Telephone Number: 562-283-8103

Troubleshooting



WARNING

Turn off power to room and wall switch by removing fuses or turning off circuit breakers as needed before attempting any repairs to the ceiling fan or the electrical connections. Failure to do so can cause serious personal injury.

Problem	Solution
Fan will not start.	<ul style="list-style-type: none"> □ Wall switch is turned off. Turn wall switch on. □ Circuit breaker is tripped or fuse is blown. Reset circuit breaker or replace fuse. □ Ceiling fan wiring is incorrect. Check the ceiling fan's electrical connections. If you are unable to detect the problem, consult a qualified electrician.
Fan is noisy.	<ul style="list-style-type: none"> □ Some noise is natural during the break-in period of the fan. Allow a minimum 24 hours break-in period. Most noises associated with a new fan will be resolved during this time. □ Ceiling fan housing screws are loose. Make sure all housing screws are snugly tightened. □ Blade set screw is loose. Retighten the blade set screw.
Fan wobbles.	<ul style="list-style-type: none"> □ Pivot ball is not captured in slot on fan mounting bracket. Refer to the instructions under Hanging the Ceiling Fan on page 11 to be sure the ceiling fan is hung correctly. □ Outlet box is not securely fastened to the ceiling joists. Tighten the outlet box screws or use longer screws, if needed, to fasten securely.
Remote control is not working.	<ul style="list-style-type: none"> □ Wall switch is turned off. Turn wall switch on. □ Remote batteries are dead. Replace the batteries in the remote control. □ Wall switch has solid-state speed controls. Do not use a wall switch that has variable speed control (i.e. a dimmer switch). □ DIP switches on the wall remote and the receiver do not match. Reset DIP switches so that the configuration is the same on both the remote and the receiver.
Remote control and fan are working, but lights don't work.	<ul style="list-style-type: none"> □ Verify the indicator light on the remote control lights up when you press the  button. This light indicates a signal is being sent from the remote control to the ceiling fan. If the indicator light does not illuminate when the  button is pressed, the remote control may be damaged and need to be replaced. Contact a customer service representative. <p>If the light on the remote illuminates, but the lights on the fan still don't work, contact a service representative.</p>

