

210\*290mm

Item #1002 936 719

Model #NB01aA10FR1-279

Item #1002 936 732

Item #1002 936 982

Item #1002 936 983

Model #NB01aA10FR1-509

Model #NB01aA09FR2-279

Model #NB01aA09FR2-509

USE AND CARE GUIDE

LED Recessed Downlight

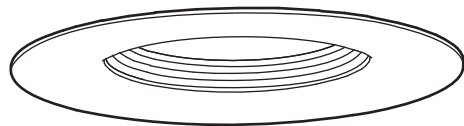

THANK YOU

We appreciate the trust and confidence you have placed in EcoSmart through the purchase of this downlight. We strive to continually create quality products designed to enhance your home. Visit us online to see our full line of products available for your home improvement needs. Thank you for choosing EcoSmart!

Warranty

The limited warranty set forth below is given by The Home Depot ("Seller") with respect to the lighting product packaged with this limited warranty (the "Product"). Your Product, when delivered to you in new condition in its original packaging, is warranted against defects in materials or workmanship as follows: for a period of five (5) years from the date of original purchase, defective parts or a defective Product returned to Seller, or its authorized service providers, as applicable, and proven to be defective upon inspection, will be repaired, or exchanged for a new Product, as determined by Seller, or the authorized service provider.

This limited warranty covers all defects encountered in normal use of the Product, and does not apply in the following cases: Loss of or damage to the Product due to abuse, mishandling, alteration, accident, electrical current fluctuations, failure to follow operating, maintenance or environmental instructions prescribed by Seller in writing or services performed by someone other than Seller or its authorized service provider.

WARRANTY IS VOID IF PRODUCT IS NOT USED FOR THE PURPOSE FOR WHICH THIS PRODUCT IS MANUFACTURED. Any complaints you may have regarding the product should be addressed to the Customer Service Team at 1-877-527-0313.

NO IMPLIED WARRANTY, INCLUDING ANY IMPLIED WARRANTY OF MERCHANTABILITY OR FITNESS FOR A PARTICULAR PURPOSE, APPLIES TO THE PRODUCT AFTER THE APPLICABLE PERIOD OF THE EXPRESS LIMITED WARRANTY STATED ABOVE, AND NO OTHER EXPRESS WARRANTY OR GUARANTEE GIVEN BY ANY PERSON OR ENTITY WITH RESPECT TO THE PRODUCT SHALL BIND THE SELLER. (SOME STATES AND PROVINCES DO NOT ALLOW LIMITATIONS ON HOW LONG AN IMPLIED WARRANTY LASTS, SO THE ABOVE LIMITATION MAY NOT APPLY TO YOU.)

NOT INTENDED FOR USE WITH EMERGENCY EXIT FIXTURES OR EMERGENCY EXIT LIGHTS. NOT FOR USE WHERE EXPOSED DIRECTLY TO THE WEATHER OR WATER. NOT FOR USE IN TOTALLY ENCLOSED RECESSED FIXTURES.

Call 1-877-527-0313 to address issues with bulbs under warranty.

Safety Information

READ AND FOLLOW ALL SAFETY INSTRUCTIONS

1. It may be necessary to remove a socket mounting plate for adequate clearance.
2. Each lampholder shall be installed only in its intended manner and orientation.
3. Not all existing recessed housings that meet these requirements will be compatible with the downlight. To ensure compatibility, a test installation should be conducted.
4. This light is suitable for damp locations.
5. Do not make or alter any open holes in an enclosure of wiring or electrical components during kit installation.
6. The minimum temperature rating for this light is -4°F or -20 °C.
7. This light is compatible with most dimmer switches when used with multiple EcoSmart Downlight fixtures.

SAVE THESE INSTRUCTIONS FOR FUTURE REFERENCE

- WARNING:** Risk of Electric Shock. Disconnect power at the fuse or circuit breaker before installing or servicing. LED Retrofit Kit installation requires knowledge of luminaires electrical systems. If not qualified, do not attempt this installation. Contact a qualified electrician.
- WARNING:** Risk of fire or electric shock. Install this kit only in luminaires that have the construction features and dimensions shown in the photographs and/or drawings and where the input rating of the retrofit kit does not exceed the input rating of the luminaire.
- WARNING:** To prevent wiring damage or abrasion, do not expose wiring to edges of sheet metal or other sharp objects.
- CAUTION:** Risk of electrical shock. Do not open. There are no user serviceable parts inside. Turn the power off before inspection, installation, or removal.
- CAUTION:** Use only on 120 VAC, 60 Hz circuits.

NOTE:

This device complies with Part 15 of the FCC Rules. Operation is subject to the following two conditions: (1) This device may not cause harmful interference, And (2) This device must accept any interference received, including the interference that may cause undesired operation.

This equipment has been tested and found to comply with the limits for a Class B digital device, pursuant to part 15 of the FCC Rules. These limits are designed to provide reasonable protection against harmful interference in a residential installation. This equipment generates, uses and can radiate radio frequency energy and, if not installed and used in accordance with the instructions, may cause harmful interference to radio communications. However, there is no guarantee that interference will not occur in a particular installation. If this equipment does cause harmful interference to radio or television reception, which can be determined by turning the equipment off and on, the user is encouraged to try to correct the interference by one or more of the following measures:

- Reorient or relocate the receiving antenna.
- Increase the separation between the equipment and receiver.
- Connect the equipment into an outlet on a circuit different from that to which the receiver is connected.
- Consult the dealer or an experienced radio/TV technician for help.

Pre-Installation

TOOLS REQUIRED



Phillips screwdriver

RECESSED HOUSING COMPATIBILITY

The EcoSmart LED downlight is designed to install in most standard 6 in. and some 5 in. recessed downlight housings. For a list of compatible housings, go to [www.HomeDepot.com/EcoSmart](http://www.HomeDepot.com/EcoSmart)

Compatibility of housings not on this list may be determined by measurement of the housing as detailed in this drawing:

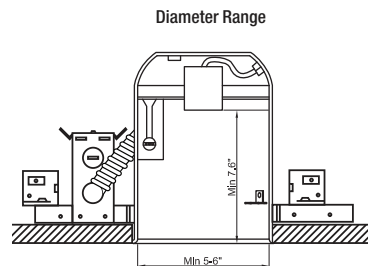

Installation

1 Preparing the LED downlight

- ☐ Remove the fixture from the packaging.
- ☐ The factory setting of the spring clips is for 6in.housing.

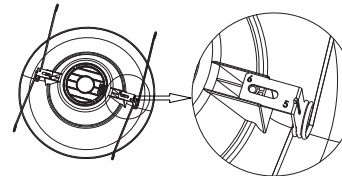

- ☐ If using a 5 in. housing, loosen the screws on the torsion spring brackets and slide the brackets outward. Re-tighten screws to secure spring bracket in place.

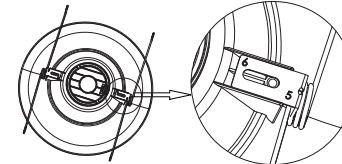

2 Preparing the installation location

- WARNING:** Turn the power OFF at the fixture source or fuse box before you proceed with this installation.
- ☐ Remove the existing trim and bulb, revealing the existing socket.
  - ☐ Locate the socket in your existing recessed housing and remove any screws that prevent the socket bracket from being removed.

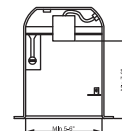

Specifications

Model	Input Volts (Vac)	Input Frequency (Hz)	Input Watts (W)
NB01aA10FR1-279	120	60	10
NB01aA10FR1-509	120	60	10
NB01aA09FR2-279	120	60	9
NB01aA09FR2-509	120	60	9

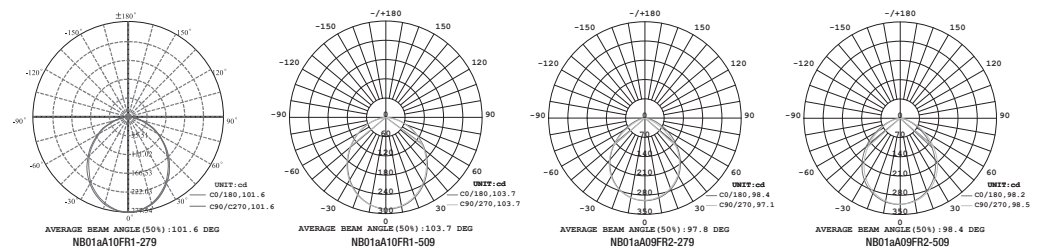

3 Preparing the socket

- ☐ Pull the socket assembly, including the bracket, as low as possible given the existing wire length available. This may require socket plate removal.
- ☐ Remove any excess brackets from the socket. Use care so as not to damage wiring during this process.

**WARNING:** To prevent wiring damage or abrasion, DO NOT expose wiring to edges of sheet metal or other sharp objects.

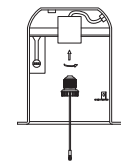

4 Installing the downlight

- ☐ Attach the downlight to the recessed housing socket. Plug the base cable connector into the lamp.

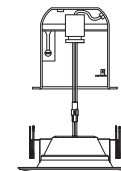

- ☐ Compress the spring clips and insert into the ears on the inside of the recessed housing. Carefully route the wires into the fixture.

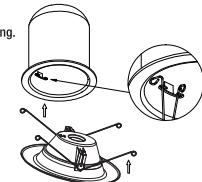

5 Finishing the installation

**WARNING:** Make sure power to the fixture or fuse box is disconnected before attempting to remove the downlight from the fixture.

- ☐ Push the retrofit into the recessed housing until the trim is flush with the ceiling surface.

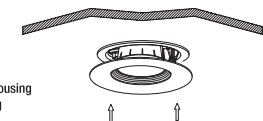

Questions, problems, missing parts? Before returning to the store, call EcoSmart Customer Service  
8 a.m.-7 p.m., EST, Monday-Friday  
9 a.m. - 6 p.m., EST, Saturday  
1-877-527-0313  
HOMEDEPOT.COM