

## Pre-Installation

### PLACEMENT

- ☐ Before use, remove all packing materials, including bottom cushions, foam pads and tapes inside of the refrigerator; tear off the protective film on the doors and the refrigerator body.
- ☐ Keep away from heat and avoid direct sunlight. Do not place the freezer in moist or watery places to prevent rust or reduction of insulating effect.
- ☐ Do not spray or wash the refrigerator; do not put the refrigerator in moist places easy to be splashed with water so as not to affect the electrical insulation properties of the refrigerator.
- ☐ The refrigerator is placed in a well-ventilated indoor place; the ground shall be flat, and sturdy (rotate left or right to adjust the wheel for levelling if unstable).
- ☐ The top space of the refrigerator shall be greater than 1.2 in, and The refrigerator should be placed against a wall with a free distance more than 0.4 in to facilitate heat dissipation.

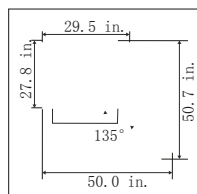
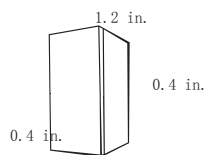

- ☐ Spare enough space for convenient opening of the doors and drawers or statement by the distributor.



**WARNING:** Information in the Instruction Manual is only for reference. The physical product may differ. Before installation and adjusting of accessories, it shall be ensured that the refrigerator is disconnected from power.

## Pre-Installation

### LEVELLING FEET

Schematic diagram of the levelling feet.

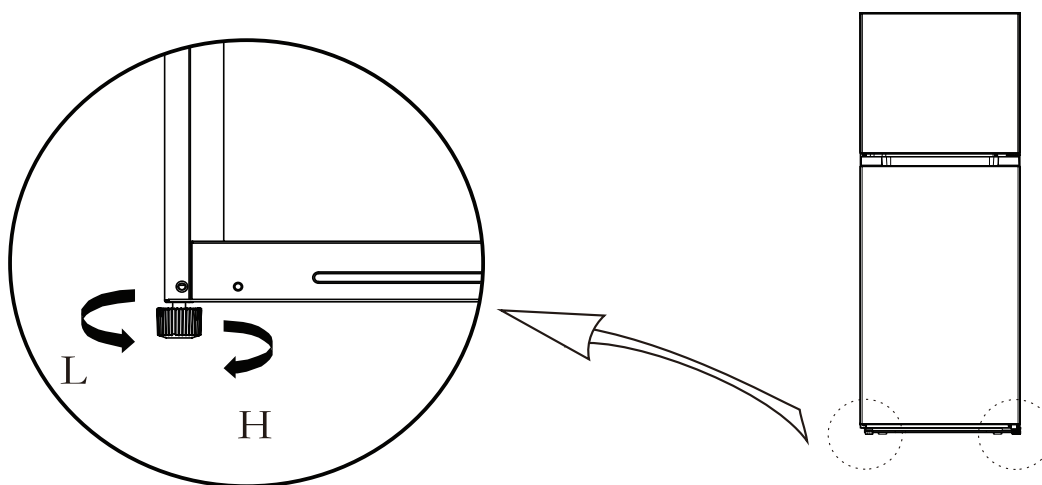

Adjusting procedures:

- Turn the feet clockwise to raise the refrigerator;
- Turn the feet counterclockwise to lower the refrigerator;
- Adjust the right and left feet based on the procedures above to a horizontal level.

### REVERSE THE DOOR SWING



**WARNING:** Follow all steps when reversing the door swing. Failure to follow these instructions, leaving off parts, or overtightening screws, can lead to the door falling off and result in injury and property damage.



**NOTE:**

When reversing the door swing.

- Read the instructions all the way through before starting.
- Handle parts carefully to avoid scratching paint.
- Set screws down by their related parts to avoid using them in the wrong places.
- Provide a non-scratching work surface for the doors.
- It is recommended that 2 people perform this task.

**IMPORTANT:** Once you begin, do not move the cabinet until door-swing reversal is completed.

These instructions are for changing the hinges from the right side to the left side—if you ever want to change the hinges back to the right side, follow these same instructions and reverse all references to left and right.

### Tools Required



$\frac{5}{16}$  in. Socket driver



Phillips screwdriver



Putty knife or thin-blade screwdriver

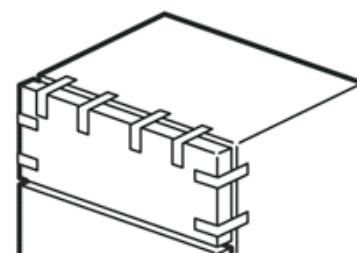

# Pre-Installation

1



**WARNING:** Unplug the refrigerator from its electrical outlet. Empty all door shelves.

- Remove the hole cover and the right top hinge cover, then unscrew screws and remove the right top hinge. Keep the screws to reuse.
- Lift the freezer door up and away from your refrigerator.

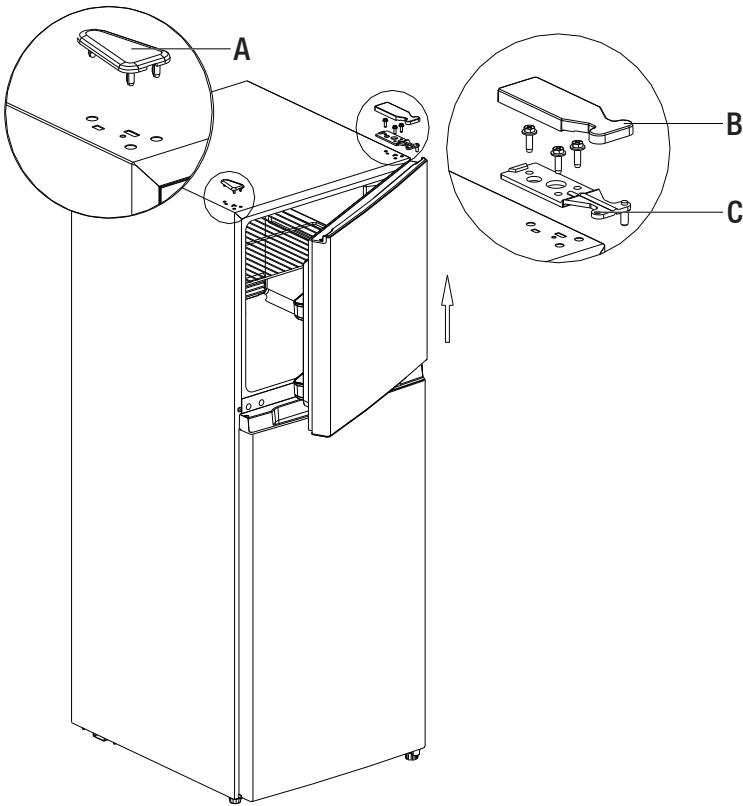

2

- Unscrew screws of middle hinge, remove the hinge, then lift the refrigerator door up and away from your refrigerator. Save the screws to reuse.

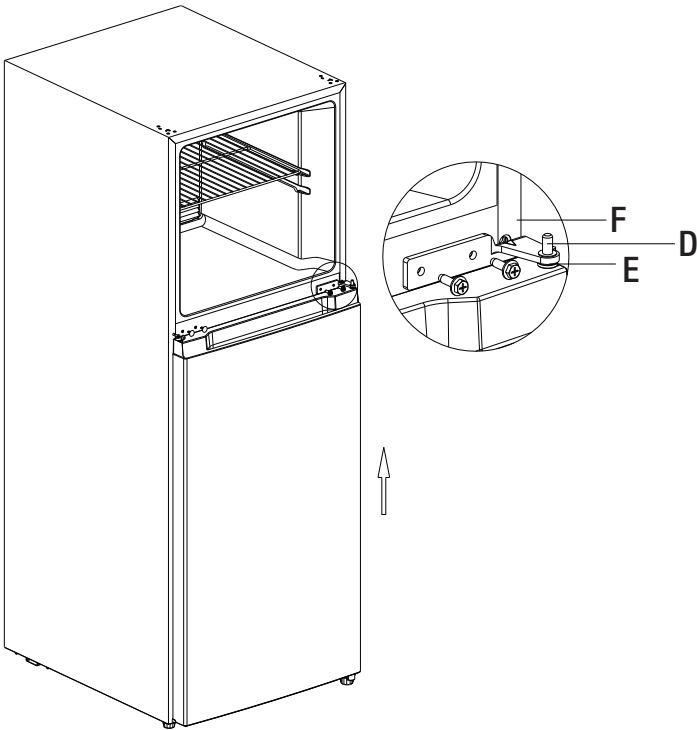

Part	Description	Quantity
A	Hole cap	1
B	Right top hinge cover	1
C	Top Right hinge	1
D	Right door self-locking block	1
E	Right door open stopper	1
F	Middle right hinge	1

# Pre-Installation

3

- Unscrew screws of the bottom hinge, then remove the bottom hinge from the bottom right side of the refrigerator.
- Unscrew the hinge shaft from the right side of the bottom hinge and move it to the left side, then secure the bottom hinge to the bottom left side of the refrigerator, using the screws you removed previously.

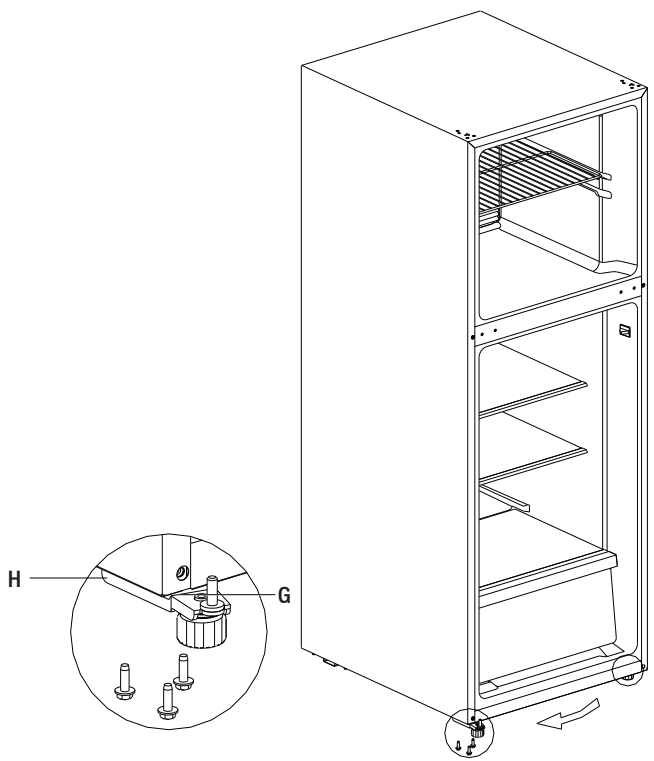

4

- Remove the sleeves from the top right of doors and hole cap from top left of doors, and assemble them on the opposite sides.
- Remove the refrigerator door open bottom stopper and install it other side of the door. Remove the freezer right door self-locking block and right door open stopper and save. Then to reuse take out the left freezer self-locking block and left door open stopper from the accessory bag in the refrigerator and installed on the left of freezer door.

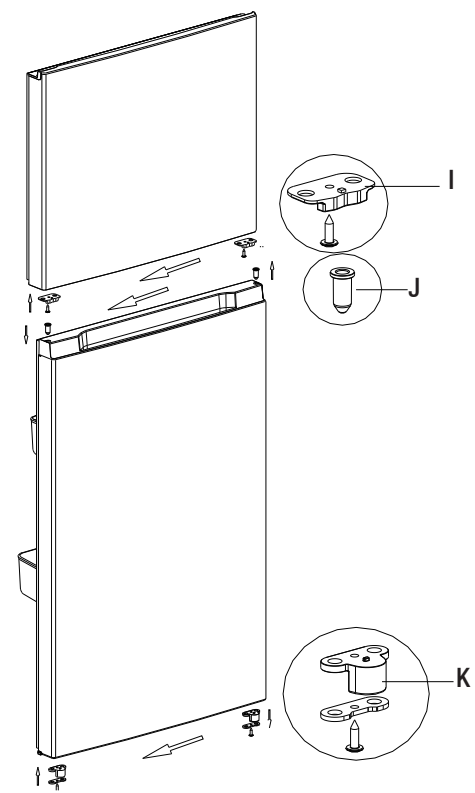

Part	Description	Quantity
G	Hinge shaft	1
H	Bottom hinge	1
I	Top sleeves	1
J	Hole cap	1
K	Bottom stopper	1

# Pre-Installation

5

- Install the refrigerator door vertically onto the bottom hinge. Take out the middle left hinge from the accessory bag then assemble the middle left hinge on the left side of the refrigerator.

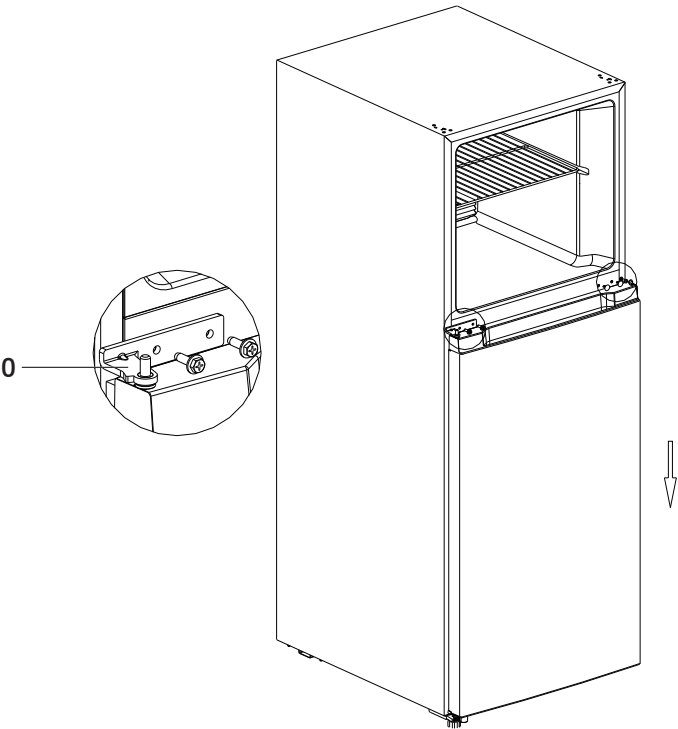

6

- Install the freezer door vertically into the center hinge. Take out the left top hinge and left top hinge cover from accessory bag, assembly left top hinge, left top hinge cover and hole cover.

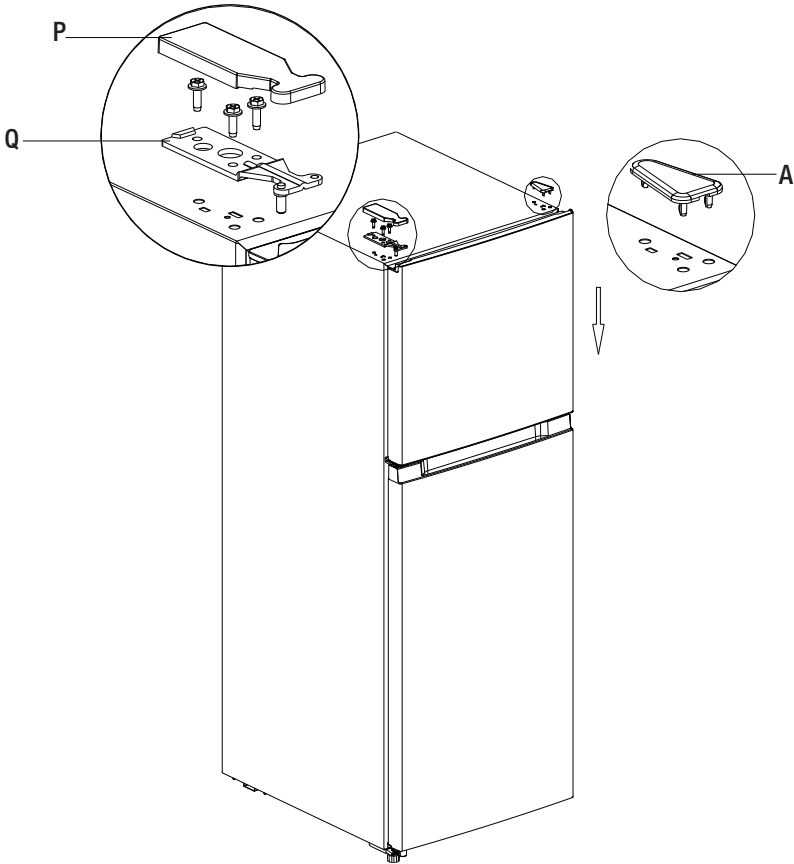

Part	Description	Quantity
0	Middle left hinge	1
P	Left top hinge cover	1
Q	Top left hinge	1
A	Hole cap	1

### STARTING

- Before initial start, keep the refrigerator still for half an hour before connecting it to power supply.
- Before putting any fresh or frozen foods, the refrigerator shall have run for 2-3 hours, or for above 4 hours in summer when the ambient temperature is high.
- This refrigerator is tested for garage use from 38°F to 110°F, but recommended to be used from 50°F to 110°F for better cooling performance in freezer room.
- For colder temperature, turn the fridge setting to COLDER. For warmer temperature, turn the fridge setting to MID.
- Do not use the refrigerator where the ambient temperature below 38°F, or it will stop cooling.

### ENERGY SAVING TIPS

- The appliance should be located in the coolest area of the room, away from heat producing appliances or heating ducts, and out of the direct sunlight.
- Let hot foods cool to room temperature before placing in the appliance. Overloading the appliance forces the compressor to run longer. Foods that freeze too slowly may lose quality, or spoil.
- Be sure to wrap foods properly, and wipe containers dry before placing them in the appliance. This cuts down on frost build-up inside the appliance.
- Appliance storage bin should not be lined with aluminum foil, wax paper, or paper toweling. Liners interfere with cold air circulation, making the appliance less efficient.
- Organize and label food to reduce door openings and extended searches. Remove as many items as needed at one time, and close the door as soon as possible.