

10P Utility Cart
OPERATION SECTION

Installing	pg 16
Removing	pg 17
Determining Weight	pg 18
Unloading	pg 19
Maintenance	pg 20
Specifications	pg 20
Service	pg 20



JOHN DEERE

Installing

Step 1. Installing the Cart



 **CAUTION: Avoid injury!**
Before installing the cart, make sure the foot pedal (L) is locked in place.

Step 2. Installing the Cart

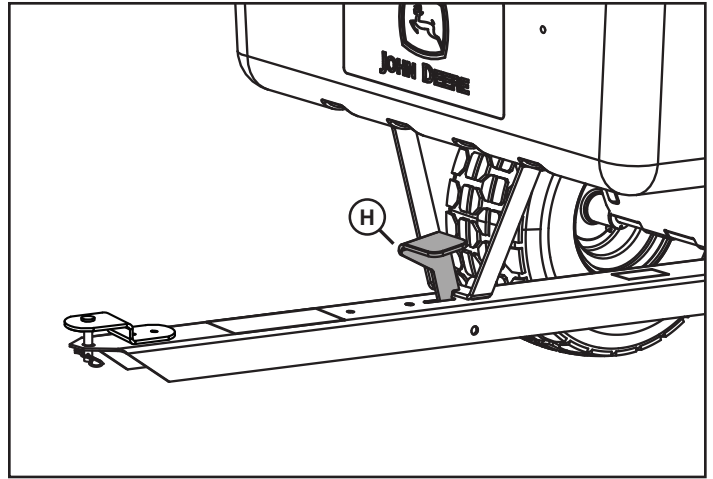

1. Lock cart foot pedal (H) in place & park machine safely. (See *Parking in the Safety section*).

Step 3. Installing the Cart

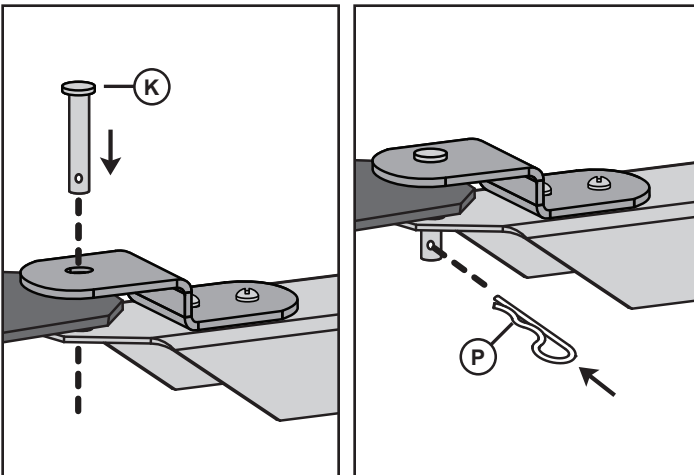

1. Align cart drawbar with machine drawbar.
2. Install clevis pin (K) through cart drawbar and machine drawbar, then secure the clevis pin (K) with a spring locking pin (P).

Removing

Step 1. Removing the Cart

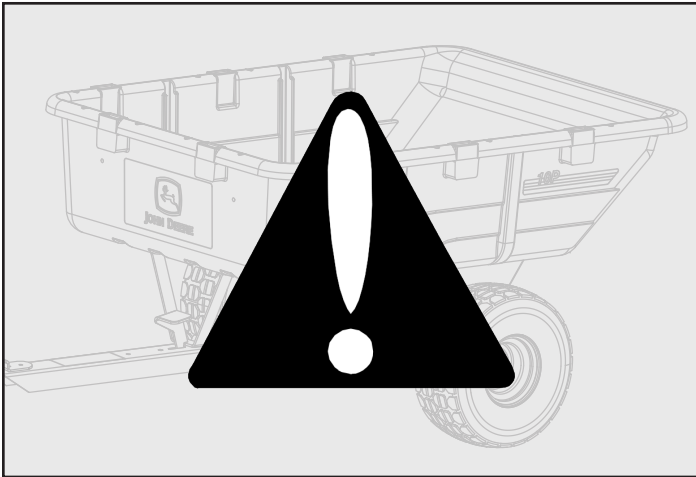

 **CAUTION: Avoid injury!** Before Removing cart, make sure transport latch is facing toward cart foot pedal and foot pedal is locked in place.

1. Park machine safely.
(See *Parking Safely in the Safety section.*)

Step 2. Removing the Cart

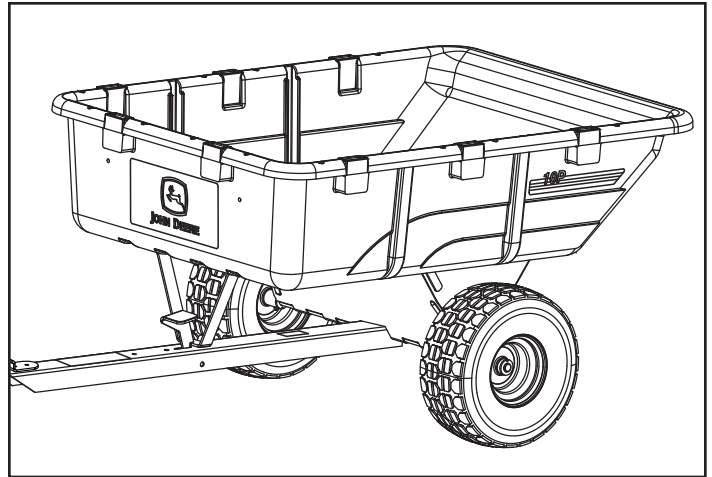

1. Unload cart.

 **CAUTION: Avoid injury!** Keep hands, feet and other body parts away from under the drawbar.

Step 3. Removing the Cart

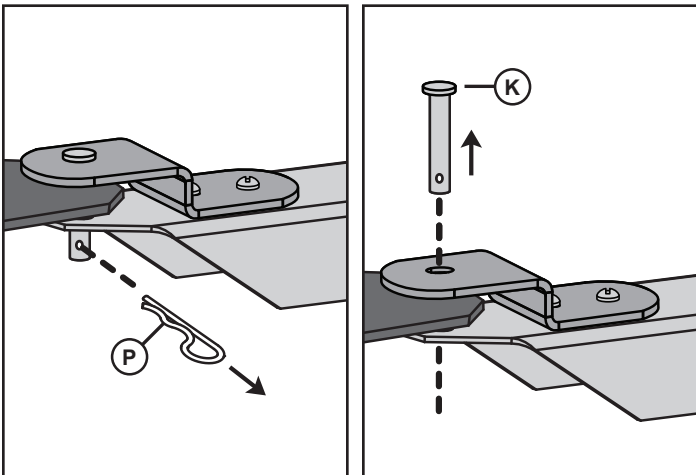

1. Remove spring locking pin (P) and clevis pin (K).

Step 4. Removing the Cart

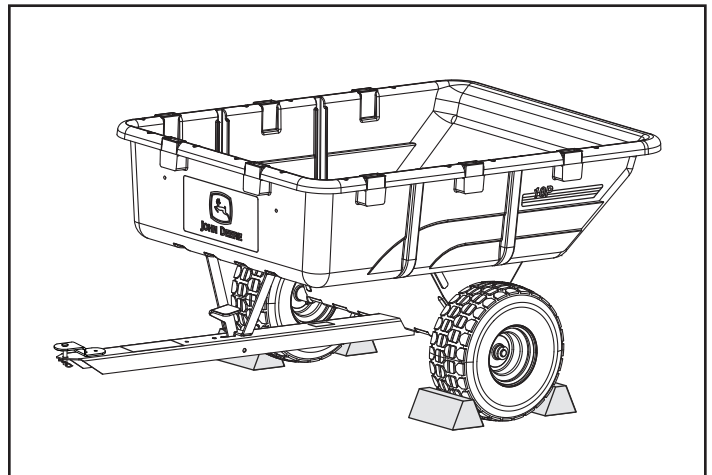

1. Push cart away from machine. Block cart wheels.
2. Install clevis pin (K) and spring locking pin (P) in cart drawbar for storage.

Operating

Determining Weight for Cart

CAUTION: Avoid injury!

Excessive towed load can cause loss of traction and loss of control on slopes. Stopping distance increases with speed and weight of towed load.



Total towed weight must not exceed combined weight of pulling machine, operator and front ballast, or the maximum capacity of the cart.

The following maximum loaded cart weight capacities are the average weight of each cart model loaded with dry sand leveled with the top of the cart.

Load Capacity:	295 kg (650 lb)
+ Empty cart weight:	33 kg (72 lb)
<hr/>	
Total Capacity:	328 kg (723 lb)

CAUTION: Avoid injury!

If additional weight is required when towing a cart, add weight at or forward of the rear wheels. Adding weight behind the rear wheels can affect machine steering.



Towing cart capacity will vary with weight of the towing machine and operator. Add the weight of your machine to operator weight to find the maximum capacity of the towing cart. With all cart usage, the cart load should be reduced when operating on slopes or slippery surfaces to maintain stability.

Example:

If towing machine weighs:	225 kg (500 lb)
+ Your weight:	90 kg (200 lb)
<hr/>	
Combined weight equals:	315 kg (700 lb)

To maintain stability using the cart in this example, you cannot safely carry more than 315 kg (700 lb) without first adding additional ballast to the towing machine.

Operating

Unloading the Cart

CAUTION: Avoid injury!



- Before dumping cart, park machine safely.
- Before backing up, make sure the area is clear of bystanders, especially children.
- Make sure cart is installed to the towing machine.
- Keep hands, feet and other body parts away from unloading areas and locking points to prevent injury from hauled materials or the cart itself.

Step 1. Unloading Cart

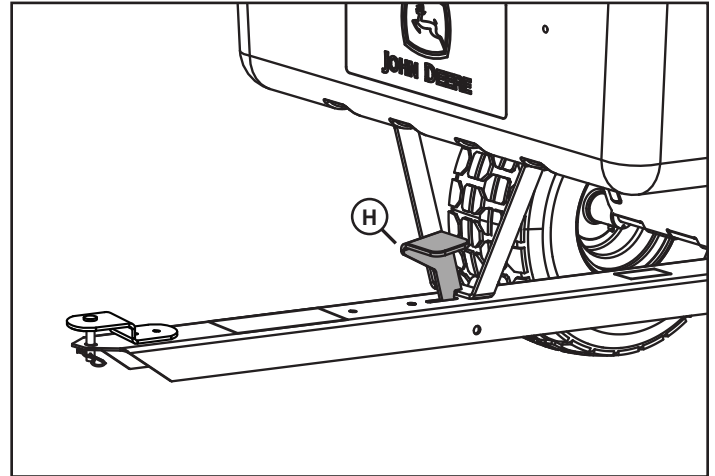

1. Park machine Safely.
(See *Parking in the Safety section*).

Step 2. Unloading Cart

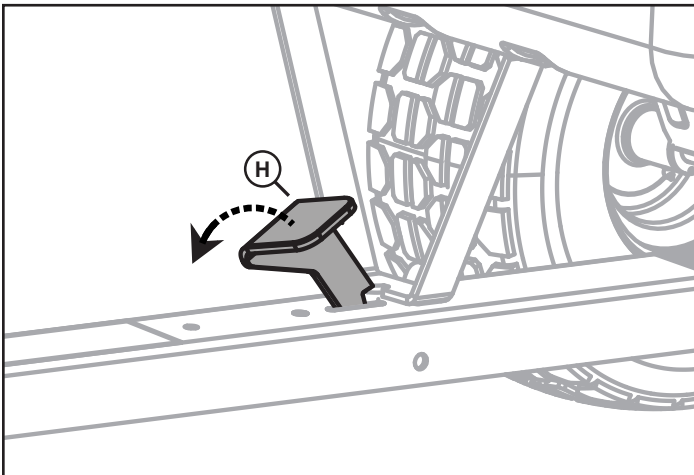

1. Press down on the foot pedal (H).

Step 3. Unloading Cart

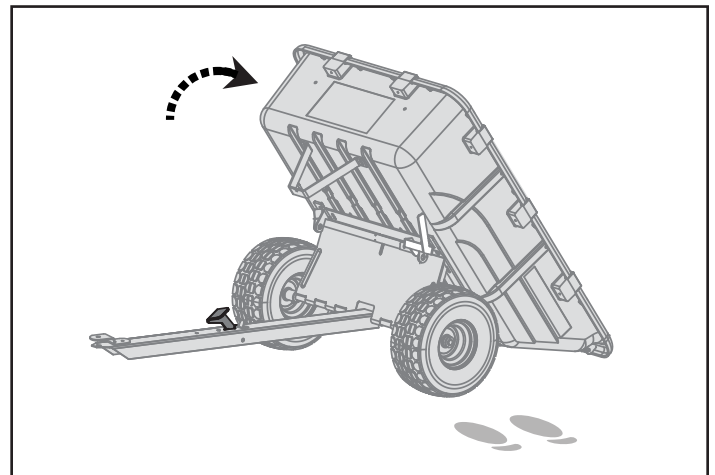

1. Pivot cart to the unloading position.
2. After unloading, slowly lower the cart back into the standard transport position until the foot pedal (H) locks securely in place.

Maintenance, Specifications and Service

General Maintenance

NOTE: Unload cart before performing any maintenance or service.

- Lubricate wheel bearings annually or more frequently with heavy use.
- Wash cart bed after each use to avoid damage to bed or hardware.
- Check tire pressure with an accurate gauge, add or remove air if necessary.

Specifications

Model 10P Cart

Maximum Towing Speed	13 kph (8 mph)
Box Capacity (Heaping)	28m ³ (10 cu ft)
Maximum Load	295kg (650 lb)
Maximum Tongue Weight	32kg (70 lb)
Empty Weight	33kg (72 lb)
Tire Size	15.00 x 6-6
Inflation Pressure	97kPa (14 psi)

Service

John Deere Quality Continues with Quality Service

John Deere provides a process to handle your questions or problems, should they arise, to ensure that product quality continues with the quality parts and service support.

Follow the steps below to get answers to any questions you may have about your product.

1. Refer to your attachment and machine operator manuals.
2. In North America or Canada, call John Deere Special Services at 1-866-218-8622 and provide product serial number (if available) and model number.

This product was manufactured by Brinly-Hardy Co. a John Deere Licensee, located at 3230 Industrial Pkwy; Jeffersonville, IN 47130. If you have any questions or concerns with the assembly, installation or operation of this attachment see your local John Deere Dealer or call Brinly-Hardy at 866-218-8622 for assistance.

