

⚠ WARNING:

T-ADAPTER MUST BE TURNED OFF AFTER EACH USED

Please turn off T-adapter after each use. This helps the longevity of your components and avoids accidental water damage. If you choose not to turn off the T-adapter, you may damage the internal components of the sprayer and hose or flood your floor!

Part List

- a) Sprayer
- b) Shower hose
- c) T-adapter
- d) Tank bracket
- e) Teflon tape
- f) Screws bag

Toilet Tank Mount steps:

1. Turn off water feed
2. Disconnect toilet hose from water tank
3. Connect T-adapter to water tank
4. Connect shower hose and toilet hose to T-adapter
5. Connect the other end of shower hose to sprayer
6. Turn on water feed
7. Place sprayer on the water tank

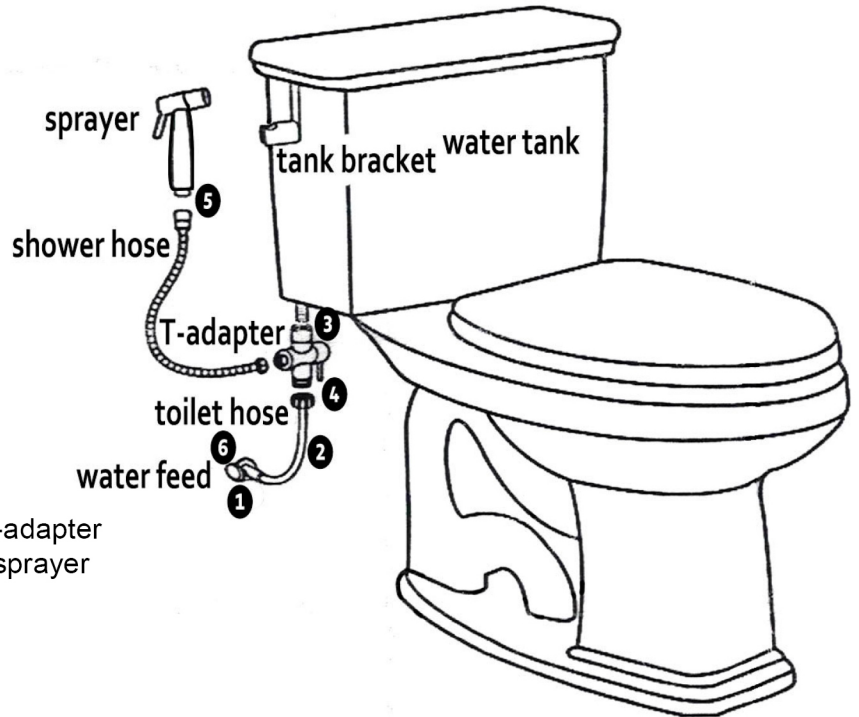

Wall Mount steps:

1. Disassemble the tank bracket as picture 1
2. Drill 2 holes on the wall and install tank bracket then put bidet sprayer on the bracket as picture 2 shows
3. Install other parts like the first six steps of toilet tank mount

Notes

1. Hand tighten connections
2. **DO NOT** over tighten connections
3. Make sure washers are placed in shower hose connectors and the T-adapter connector which connect to the water tank

We'd Love to Hear From You

Dear Customer,

Thank you for your purchase.

If have any concern or problem, feel free to let us know. Our E-mail: service@boylliving.com

We will reply in 24 hours.

If like it, pls share with friends or on Boyelliving. Lifetime highest standard customer service within 30 days refund or exchange if not 100% satisfied.

Best regards!

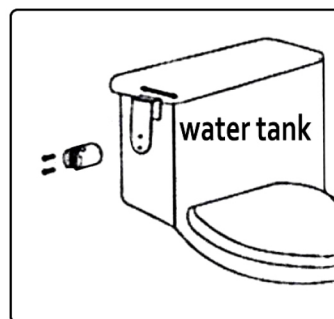

picture 1

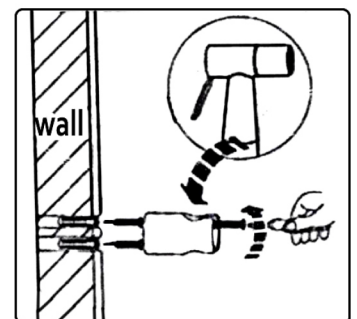

picture 2