

Solar-on-Demand Birdbath / Fountain



* Styles may vary but assembly will be consistent with this manual



Birdbath & Metal Stand
with Ceramic/Concrete Bowl



Birdbath & Metal Stand
with Glass Bowl



Birdbath

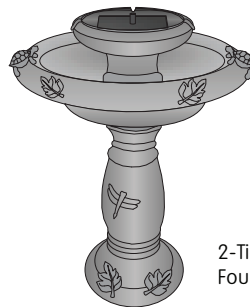

2-Tier
Fountain

Fountain Heads

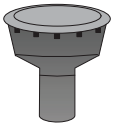

The 360° fountain head accessory can be used to enhance your fountain.
Note: It will only work effectively in bright sunlight or if battery is charged.



The short nozzle can be used to produce a finer higher stream of water.
Note: May need to be removed in bright sunlight to avoid splashing.

Warnings



Water must be regularly topped off. We recommend regularly changing the water to ensure it remains clean and free from debris.

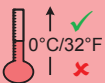

Important!

Frost causes damage, store whole product inside during cold weather.

For Birdbath with Glass Bowl Only:

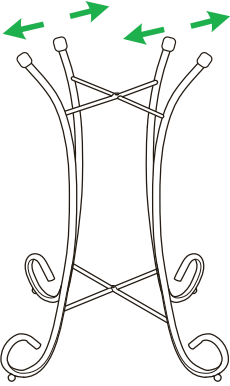

Open frame.

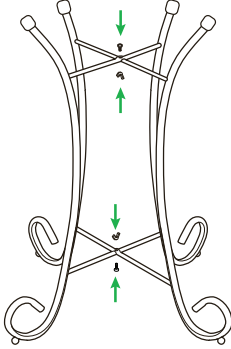

Tighten Wingnuts

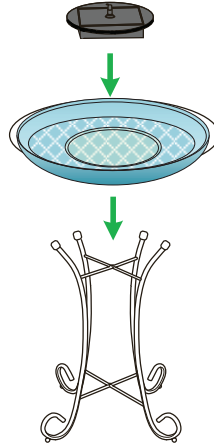

Place Bowl on rubber caps. Insert Solar panel/pump.

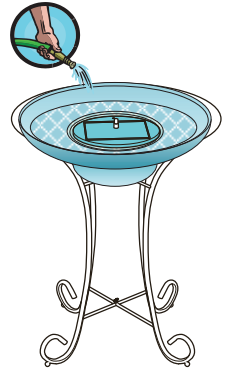

Fill bowl with water.

For Birdbath with Ceramic or Concrete Bowl Only:



Open frame.



Attach metal ring to frame.

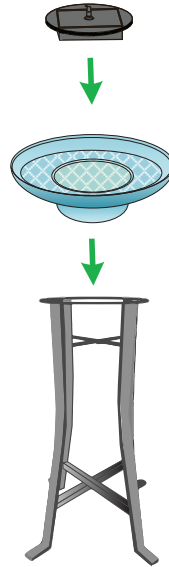

Place Bowl. Insert Solar panel/pump.

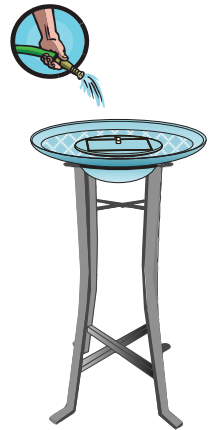

Fill bowl with water.

For Birdbath Only:

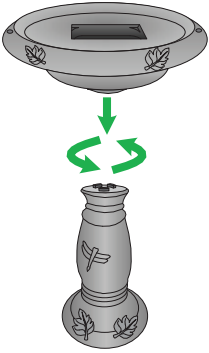

Attach bowl to pedestal. Align the marks and turn to lock in place.

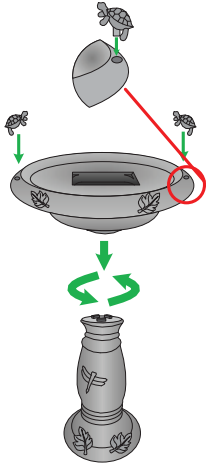

If your fountain includes Accents, locate the pin on the accent pieces and insert into the holes around the edge of the bowl.



Place the solar panel/pump assembly into the reservoir.

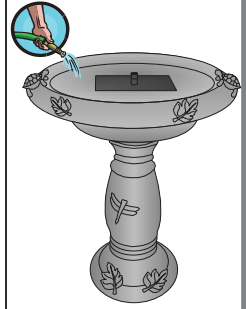

Fill bowl with water.

For 2-Tier Fountain Only:

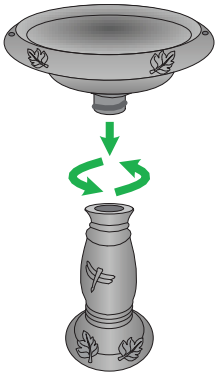

Attach bowl to pedestal. Align the marks and turn to lock in place.

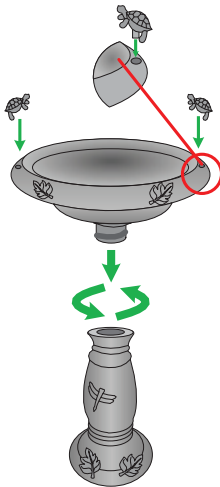

If your fountain includes Accents, locate the pin on the accent pieces and insert into the holes around the edge of the bowl.



See Page 7 on how to connect upper tier components. Place upper tier into the main bowl.

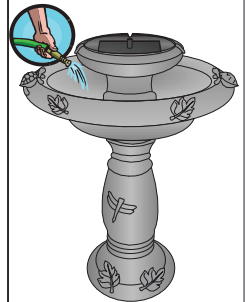

Fill bowl with water.

IMPORTANT!

Important!

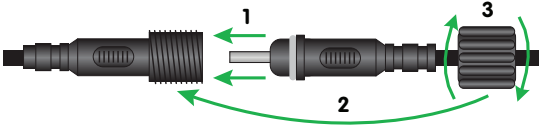

When reconnecting the plugs ensure that the connections are water tight. Push the plugs together until they touch the rubber o-ring, slide the threaded cap over the plug and turn the cap until tight.

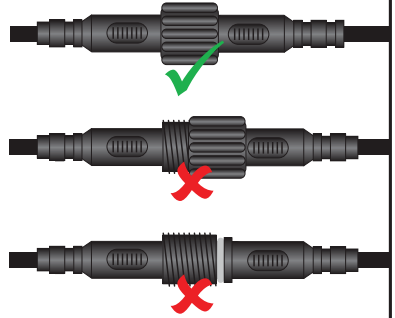

Position

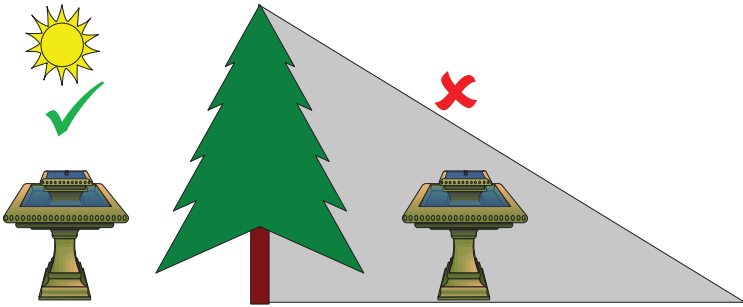

Position your fountain so that receives direct sunlight. The fountain will NOT work if the solar panel is in a shaded area.

Battery

Rechargeable battery packs become less efficient with repeated charge and discharge cycles. The capacity of the battery may also reduce over time and you may not achieve the 6 hour operation. If you find that the battery appears less efficient or does not run as long, we first suggest you try to boost charge it. To do this, leave off for 3 to 5 sunny days to allow the maximum charge to the battery. We suggest you do this occasionally anyway to help prolong the battery life. If after this boost charge, your battery still does not perform to expectations, you should seek a replacement from Customer Service.

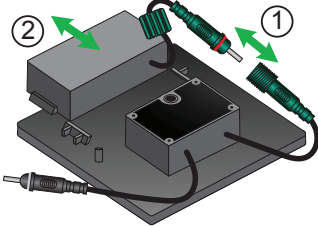

Battery Charging

Unplug green battery connector (1) and slide out the battery pack (2). Replace with new battery and reconnect. Dispose of battery according to local regulations

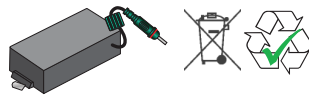

Operation and Performance

I = ON

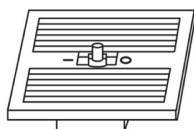
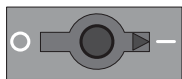



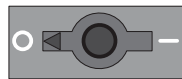

O = OFF / CHARGE

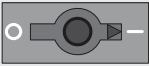
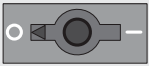

When the switch is set to the 'I' this is the "on" mode. If you want your fountain to work during the day use this setting. The sun will run the pump when the solar panel is in direct sun, and when a cloud passes then the battery will automatically activate to keep the pump running consistently throughout the day. When the sun goes down in the evening the battery will keep the pump running as long as it can until it is depleted. The run time will vary based on the weather that day.

When the switch is set to 'O' this is the "off" mode. The pump will not run at all. If you want to use your fountain in the evening or at night then you need to charge it in this setting during the day in this mode. When the panel is in direct sun it will charge the battery. Once the battery is charged you can then turn the fountain on and run it in any location regardless of the weather conditions, day or night! If you have a party coming up we suggest turning it off for a couple days to charge up.

WEATHER	SWITCH SET TO 'I' (ON) 	SWITCH SET TO 'O' (OFF / CHARGE) 
Sunny No Clouds 	Direct sun runs the pump and any extra energy will trickle charge the battery at the same time.	Battery should fully charge in 1 sunny day.
Light Overcast Partly Cloudy 	As clouds pass the battery will automatically activate when needed to keep the pump running consistently so the battery will get used throughout the day.	Battery may take 2-3 days to fully charge with light overcast.
Heavy Overcast Dark Clouds 	The battery will run the pump if the battery is charged. A fully charged battery will run the pump up to 6 hours. When the battery is depleted the pump will stop running.	Battery will not charge when very cloudy.
Dusk to Dawn Night 	At night the pump will only run if the battery is charged. When the battery is depleted the pump will stop running.	Battery will not charge in the evening when the sun is too low or at night.

When in direct sun or the battery is fully charged

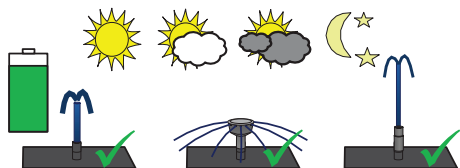

When not in the sun and the battery is low

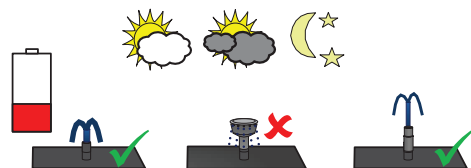

Maintenance, Care and Troubleshooting

Your solar fountain is designed for outdoor use and with proper care will last for many years. The best way to preserve and extend the life of it is to clean it regularly and store it indoors for winter. There is a 1-year manufacturer's warranty on products that are properly maintained. Below are maintenance tips.

Pump

The pump needs to be cleaned regularly. We suggest once a week if possible or once a month minimum. Pull off the plastic filter cover and remove the mesh filter. Turn the spout clockwise to remove it then pull out the impeller fan. Rinse all parts and wipe off the impeller magnet. Use a cotton swab to clean the impeller cavity. To keep the pump clean for longer periods by preventing algae from growing in the water, try Fountain Fresh (our all-natural non-toxic water clarifier which is safe for birds and pets).

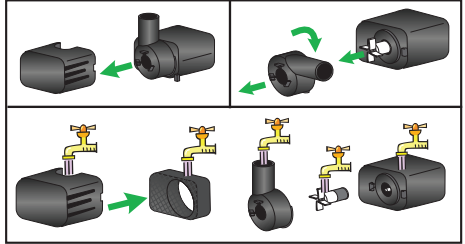

Solar Panel and Fountain Head

Clean the panel with vinegar, glass cleaner or mild soap and sponge or cloth. If hard water build-up makes it look foggy use a scrubbing pad with a hard water cleaner. To rinse debris out the fountain head sprayer unscrew the top cap.

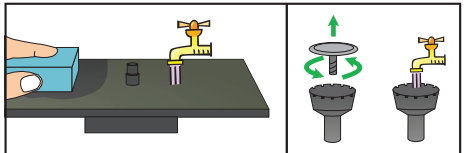

Battery

Rechargeable batteries lose performance over time after many charge-discharge cycles. If you have this issue you can boost charge it by turning it off for 2-3 sunny days then turn it back on. If this does not help you can replace the battery pack by sliding it out of the rails on the bottom of the solar panel (as shown below) and installing a new one. Dispose of it according to your local regulations. If your fountain is not working at all when in direct sun with switch facing 'I' (on) then the issue is the pump or panel not the battery. Please see the Troubleshooting section.

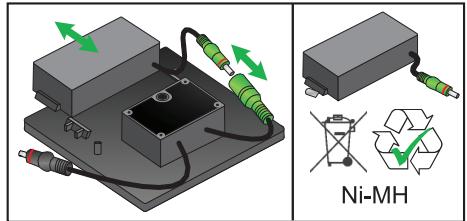

Troubleshooting

If fountain stops working:

- *Clean pump and panel as shown above.
- *Set switch to 'O' (off) to charge in direct sun for 2 days.
- *Set switch to 'I' (on) to run pump from sun/battery.
- *Ensure connectors are together and tightened.
- *Test battery and pump. Connect the battery (green plug with red ring) to the pump (black plug with sleeve). If pump works then you may need a new solar panel.

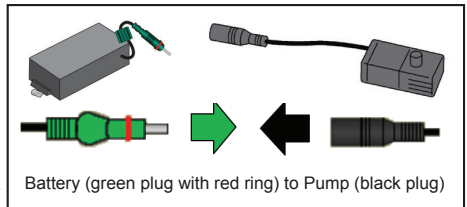

WARNING: Freezing Temperatures and Winter Storage

Do not leave the fountain outside in winter if you get freezing temperatures in your area. Freezing can cause damage to the product. Before the temp get down to 0°C/32°F store the entire fountain in a frost-proof environment such as a shed, garage or basement. Any issues caused by freezing temps, snow, or ice from leaving it outside in the winter are not covered under the manufacturer's warranty.

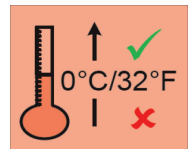

Troubleshooting for 2-Tier Fountains



CORRECT ASSEMBLY AND PERFORMANCE:

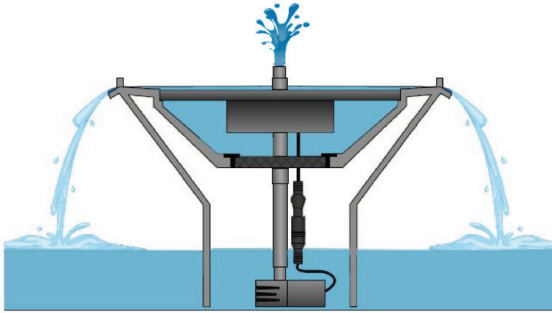

- Switch set to 'I' (on) to run pump when in direct sun or after charging the battery with switch set to 'O' (off) for 1-2 days in direct sun.
- Tube is inserted into bottom of panel so water will come out through the tube and the panel does not lift out or fall out.
- Foam disc seals the hole so the top tier fills up and overflows.
- Plugs have red orings covered to make a water tight connection.
- Pump has two 2" tubes and sits at the bottom of the tier so it's fully submerged.



ISSUE:

"It works but is weak"

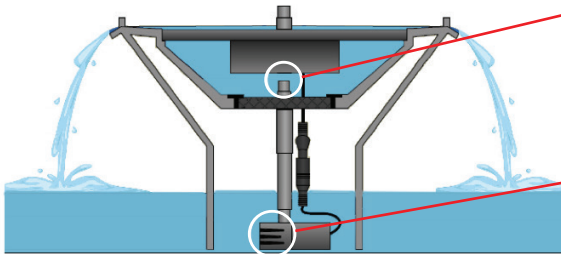

HOW TO FIX IT:

- The tube may not be connected to the bottom of the panel. If your panel lifts out easily or falls out when upside down that's the issue. Hold the panel in the top with one hand, hold the pump with the other hand and squeeze them together to insert the tube into the bottom of the panel.
- If it doesn't lift out then the filter might be clogged. Clean the pump and solar panel as shown in the maintenance section.
- If that does not help the battery might be low. Set the switch to 'O' to charge the battery for 1-2 sunny days.



ISSUE:

"It works but the top doesn't overflow"

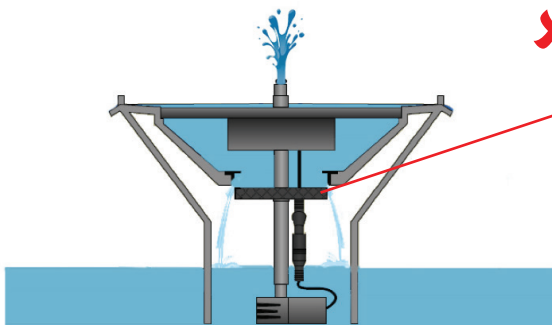

HOW TO FIX IT:

- The foam disc is not in the correct place so the water is running back down inside the tier to the pump. Ensure the foam disc is securely fitted into the hole with the wire tucked into the slit in the side of the disc. Push the disc up into the hole. It must be sealed to make the top fill up and overflow.

Troubleshooting for 2-Tier Fountains

✘ ISSUE:
"Loud noise and not pumping water up"

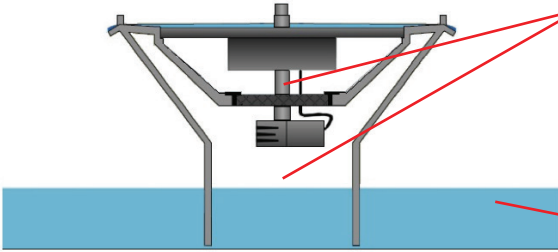

HOW TO FIX IT:

- The pump is not submerged and is running dry. Ensure you have 2 tubes that are two inches long each in between the pump and panel. If you only have 1 tube the pump will be up close to the foam disc and is too high inside the top tier so it's running dry. Install 2nd tube to lower the pump. If it's missing contact customer service for a tube.
- If you have 2 tubes then the water level might be low. Fill the main bowl to the rim.

✘ ISSUE:
"Pump is not running at all."

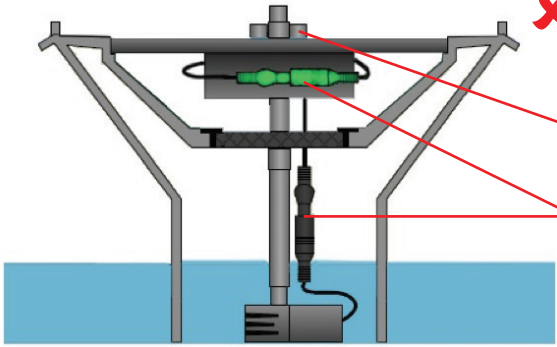

HOW TO FIX IT:

- Make sure the fountain is in direct sun or the battery has been charged already.
- To charge, switch to 'O' (off). While off you can take the top tier out of the bowl and place it anywhere in direct sun to charge.
- Ensure the red o-rings are fully covered.
- Clean pump and panel
- Switch to 'I' (on) to run from sun or battery.

ADDITIONAL TROUBLESHOOTING STEP:

If none of the previous troubleshooting steps work then test the battery and pump as shown below. Connect the battery (green plug with red ring) to the pump (black plug with sleeve). If that works then the pump and battery are ok and the solar panel might need to be replaced. Please contact the manufacturer for a replacement solar panel.

BATTERY
(green male
plug with
red ring)

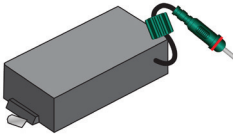

TEST

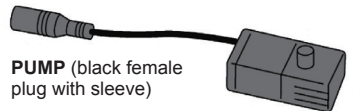

PUMP (black female
plug with sleeve)

smartLiving
home & garden

Smart Solar is a Smart Living Home & Garden brand

Telephone: + 1 813 343 5775 **Email:** customerservice@smartlivinghg.com

Web: www.smartlivinghg.com

US Patent 7484671 & EU Patent 1648620

1 Year Limited Manufacturer's Warranty

