



ELITE
WHOLE HOUSE FILTRATION

PRO+AQUA filtration systems are designed in California USA and are made from quality NSF Approved filters and components.

System Inspection Before Starting

Remove the system and all the components out of the box, take note of all parts. Inspect the system housings, fittings and connections carefully, make sure nothing was damaged during transit. If any part is cracked or damaged, please **do not proceed** with the installation and contact us or your distributor for an exchange or diagnosis.

Components List

- 2 Stainless Steel Mounting Screws or Lag Bolts & Washer.
 - 1 Bracket (Preinstalled).
 - 3 housing (1 clear, 2 black)
 - 3 Heads (Preinstalled on bracket)
 - 1 Housing Wrench.
-

Tools Recommended For Installation

- Variable Speed Drill
 - Adjustable Wrench
 - Drill Bit
 - Teflon Tape
 - Bolt Bit
 - Pen or Pencil
-

System Maintenance

All of our systems require little maintenance. The only regular maintenance required is filter replacement every 4 - 6 or 6 - 12 months (depending on usage and water quality in your area). It is important to change out your filters at the recommended intervals as indicated in this sheet to keep your system working properly. When replacing any of the filter elements, pay special attention to the housing it belongs to as installing the filters incorrectly will impact the performance of the system.

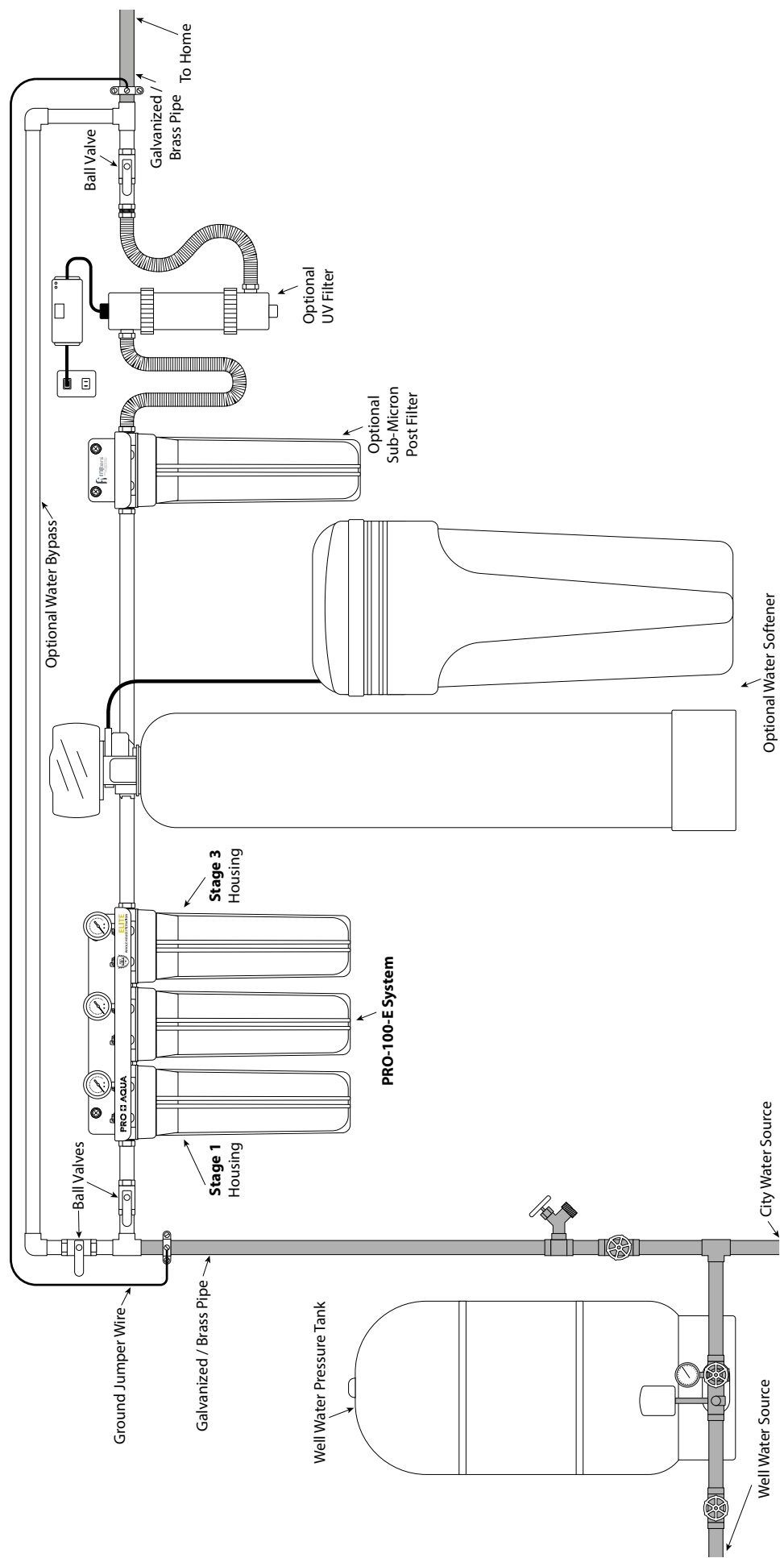

Installation Diagram

System installation

1 >

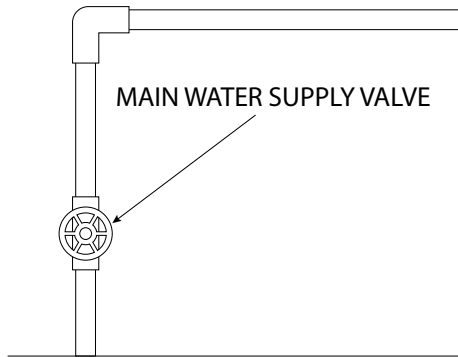

Shut off the main water line to your home.

2 >

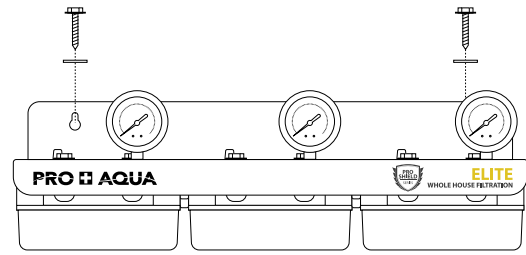

Install system to wall using the included SS bolts.

3 >

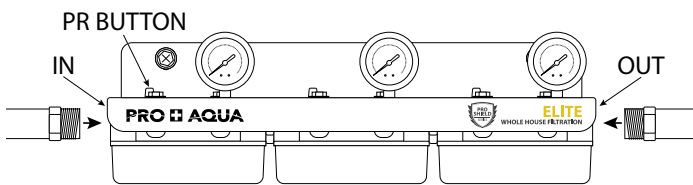

Attach your incoming supply line to the "IN" Port on the system then attach the line going into your home to the "OUT" port on the system. Plastic fittings recommended. DO NOT solder.

4 >

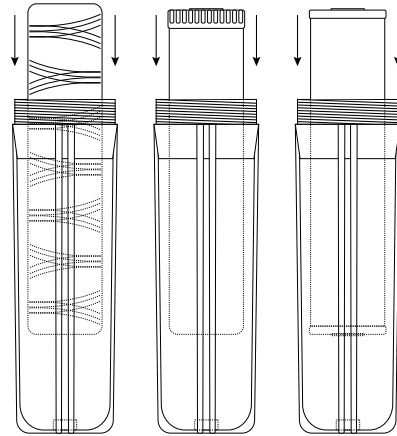

Unwrap cartridges and drop into the correct housings, centering on the stand pipe in the bottom of the housing. Stage 1 is closest to the "IN" port on the system.

5 >

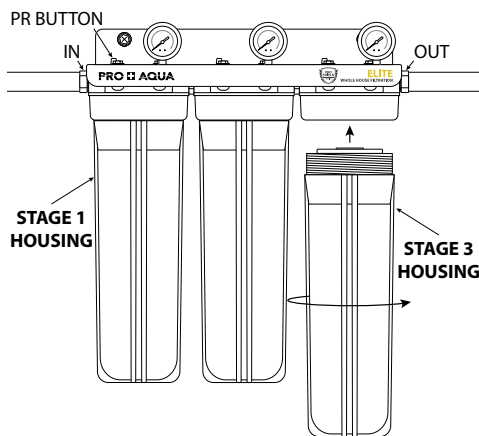

Install housing(s) onto the corresponding head and turn clockwise until snug. Hand Tighten. (DO NOT OVERTIGHTEN)

6 >

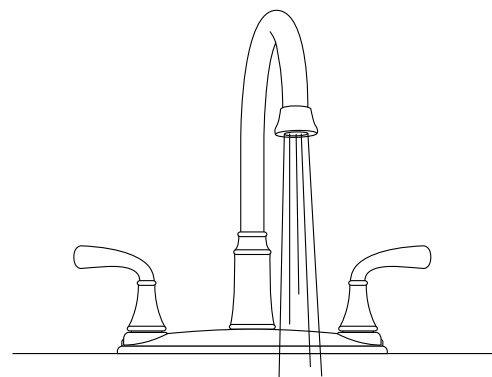

- 1) Locate nearest faucet and remove aerator.
- 2) Turn water supply on for 5 min. to flush filters.
- 3) Check system for leaks.
- 4) System is now ready.

Flow Reversal

Depending on the location of your feed water and the entry location of the pipe to your home, you may need to flip the direction flow of your system. This will reverse the flow of your system to be Left to Right.

1 >

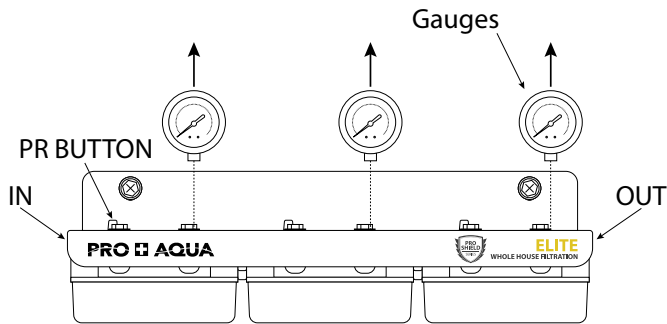

Carefully remove the Pressure Gauges from the system.

2 >

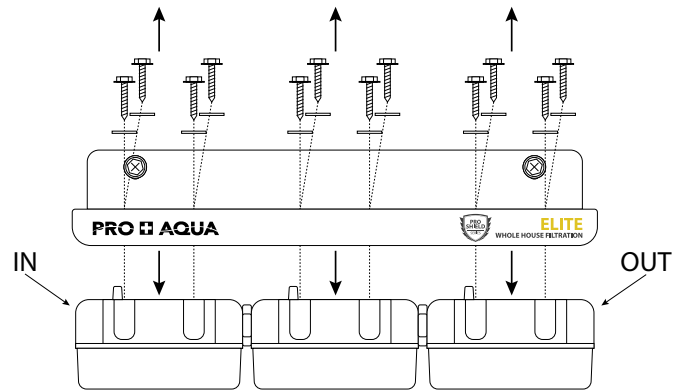

Remove the 12 bolts and washer to separate the Cap Module from the Bracket.

3 >

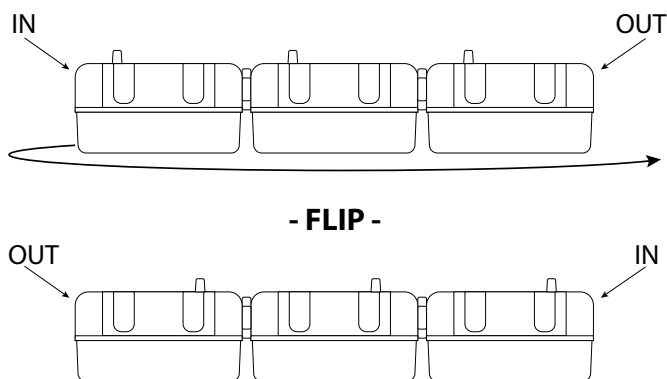

Flip the Cap Module so the IN port is on the opposite side.

4 >

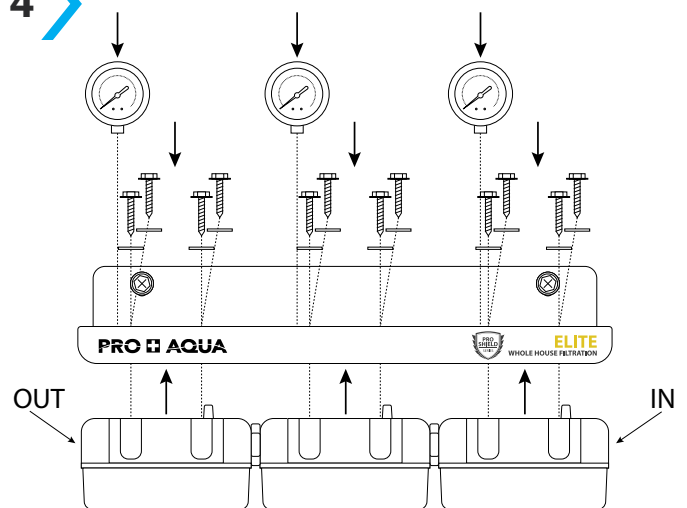

- 1) Reinstall the 12 bolts and washer to attach the Cap Module.
- 2) Apply new Teflon to the Pressure Gauges to prevent any leaks. Ensure to apply plenty of Teflon, it should feel snug while installing the Pressure Gauges.
- 3) The Flow Direction is now flipped.

Replacing Your Filters

Replacement Filter Set: **FC-PK-100E**

To insure your system keeps performing at its best, only use original OEM Certified filters, untested filters will reduce performance and void its warranty.

Before starting: Turn incoming water off then press and hold the PR button to relief the pressure in the system. Ensure to place a bucket or rag to catch any splashing water.

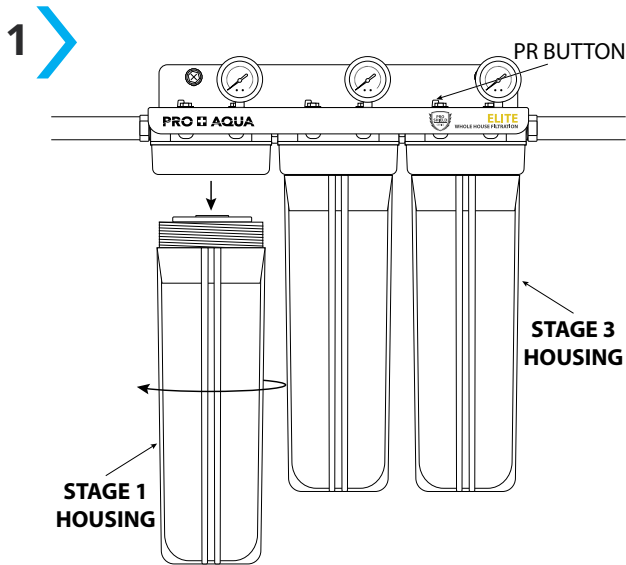

Remove housing using the housing wrench by turning the handle counterclockwise.

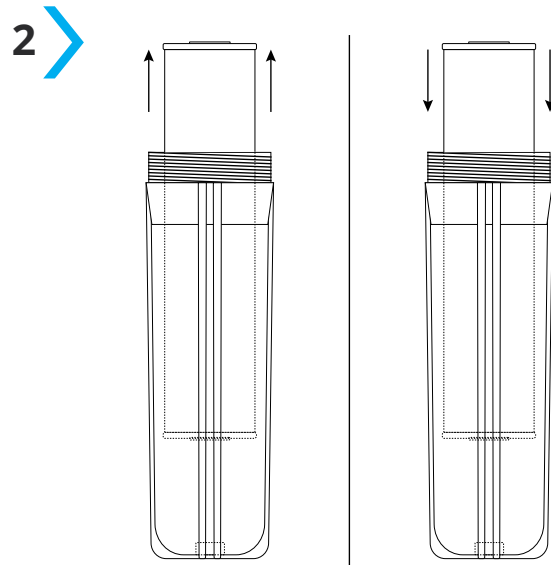

Remove the old filter and install the new filter. Ensure to center the filter cartridge properly in the housing.

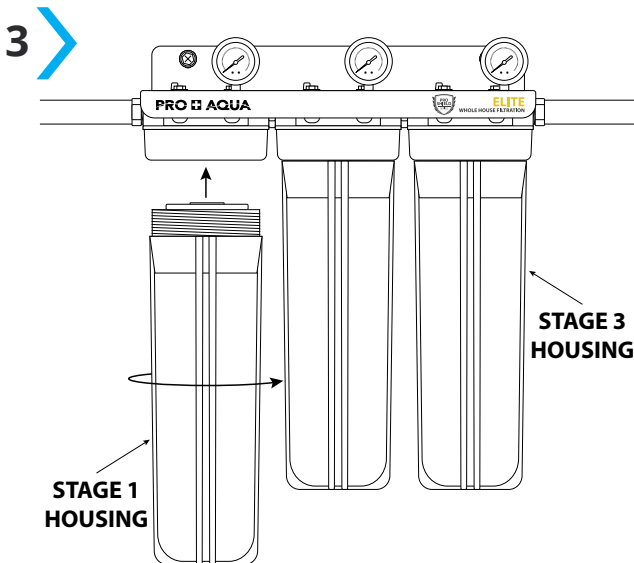

Inspect the O-Ring on the housing for any damage or cracks. Ensure the O-Ring is sitting properly in the groove. Lubricate the O-Ring and housing threads with silicone lubricant or a food-grade lubricant.

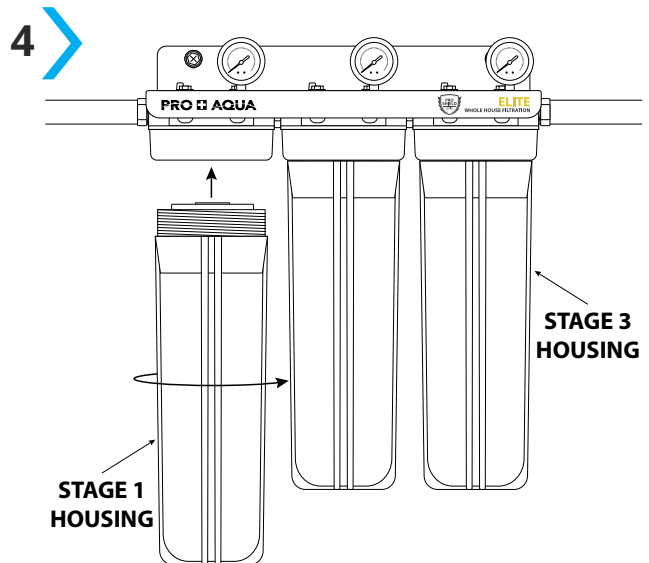

Reinstall the housing by pushing the housing up and at the same time turning the housing clockwise. Ensure to keep the housing and filter cartridge straight. Improper installation will cause the filter cartridge to not sit properly in the housing and will prevent the housing from closing all the way.
* Hand tighten. Do not overtighten housing.



Optional Add Ons:

Ball Valves, Bypass, Ground Jumper Wire, Water Softener, Post Filter, and UV Filter are not included.



Warning:

The plastic components of the system will interrupt the continuity of the grounded (conductive) plumbing system. A grounded "jumper wire" bridging the equipment to the plumbing system must be installed prior to systems use. Consulting a Licensed Plumber is highly recommended (see Installation Diagram).

Do not use with water that is microbiologically unsafe or of unknown quality without adequate disinfection before or after the system. It is highly recommended to test your well at least once a year to properly manage your water quality and

Caution:

Filtration System must be protected against freezing and extreme heat, which can cause the housing(s) to crack and the components to fail and may cause water leakage. Filtration system should not be installed in direct sunlight since UV rays make housings and other components brittle.

It is important that the O-ring be properly seated or a water leak could occur as the O-ring provides the water-tight seal between the cap and the housing.

To prevent possible water damage, housings should be replaced every 4 years (5 years for clear housings).

Operational Parameters

Installation needs to comply with state and local plumbing regulations. These systems are intended to be used with cold water only.

	Maximum	Minimum
Operational Temperature	100°F (37.8°C)	40°F (4.4°C)
Operating Pressure	80 psi (5.98 kg/cm ²)	20psi (1.406 kg/cm ²)
pH Parameters	10	5

NOTES:

