

# CABINET HARDWARE PULL MEASUREMENT GUIDE

- Choose the right cabinet pull size for your usage
- Center to Center = distance between center of left and right screw holes
- Actual product width may be longer than center to center measurement

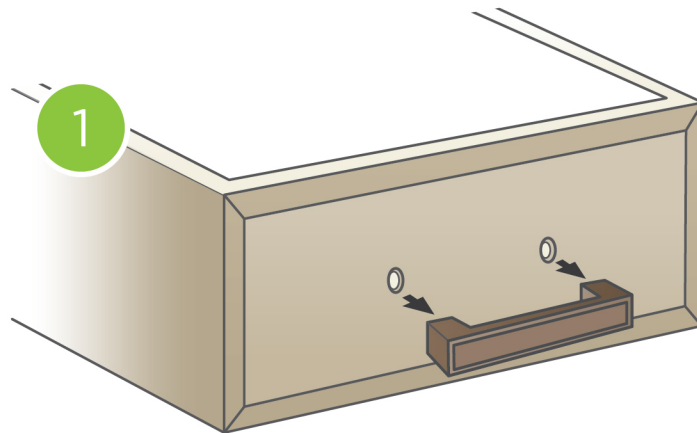

(AT HOME)  
REMOVE OLD HARDWARE

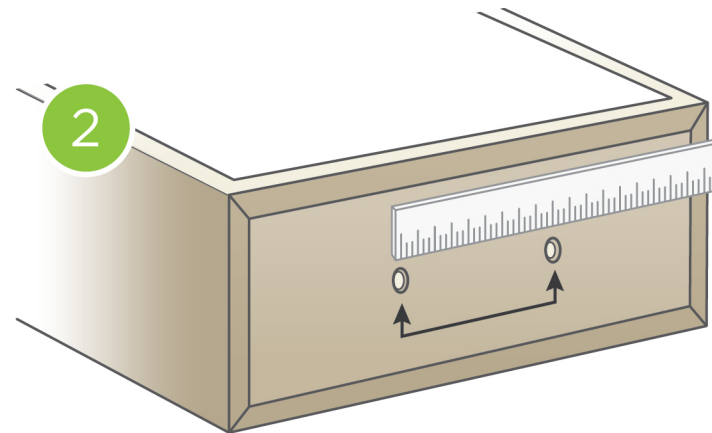

(AT HOME)  
MEASURE SCREW HOLES CENTER TO CENTER

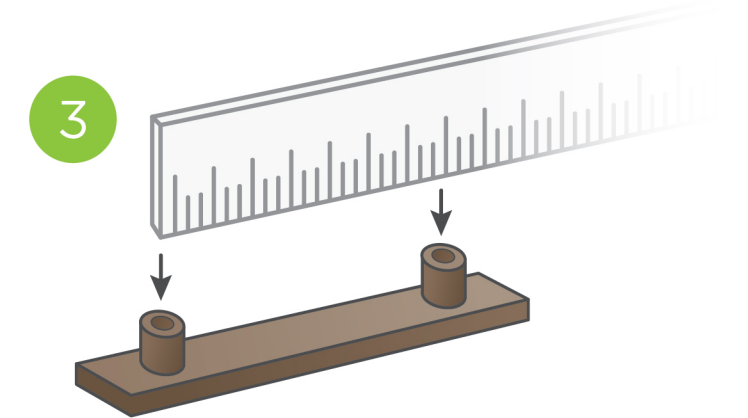

REVIEW CENTER TO CENTER DIMENSIONS  
OR, MEASURE POSTS - CENTER TO CENTER