

# HOW TO INSTALL

CLOSETS  
By LIBERTY.

## WHAT YOU WILL NEED:

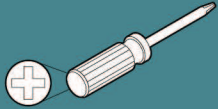

Screwdriver



Pencil



Tape Measure

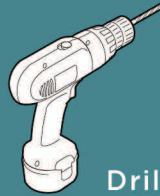

Drill

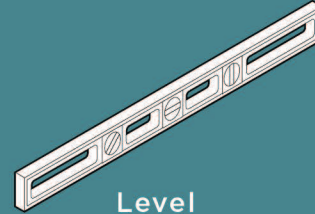

Level



Eye Protection

## 1. BUILD THE TOWERS

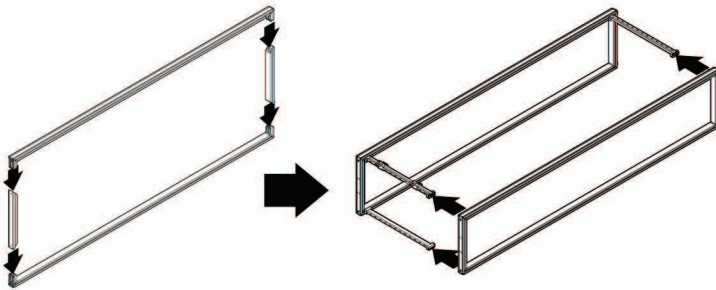

## 2. STABILIZE THE CLOSET SYSTEM

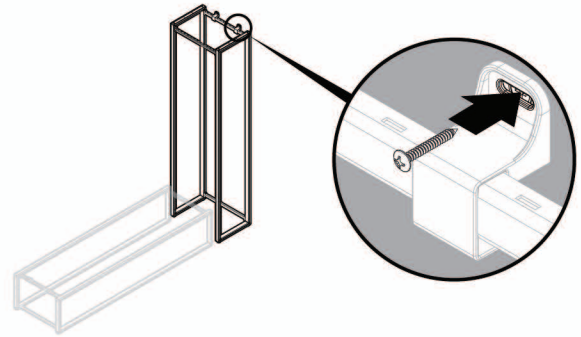

## 3. ADD SHELVES AND HANGER RODS

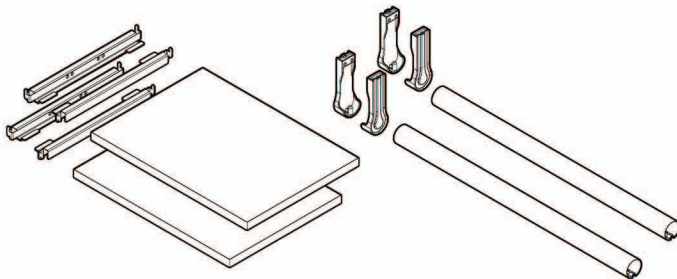

## 4. ASSEMBLE DRAWERS

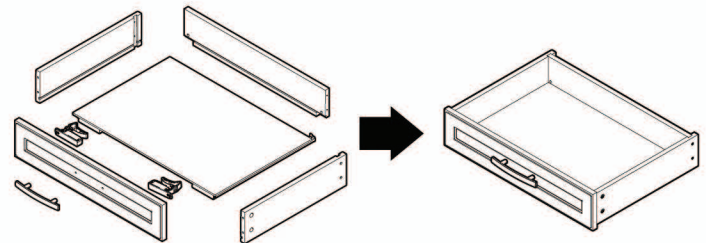

## 5. CUSTOMIZE AND REARRANGE SHELVES AND DRAWERS TO FIT YOUR SPACE AS NEEDED

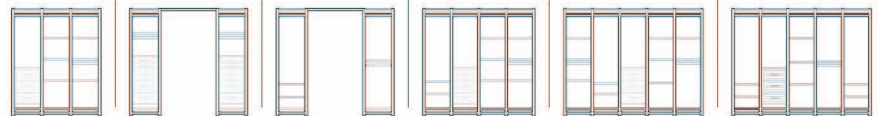

FOR FULL DETAILS, PLEASE SEE COMPLETE INSTRUCTIONS INCLUDED WITH ITEM