

KNOW YOUR UNIT

APPLICATIONS

- Cleaning yards, garages, driveways, porches, patios, around walls, fences and more

ASSEMBLY TOOLS REQUIRED

- Flat-head screwdriver

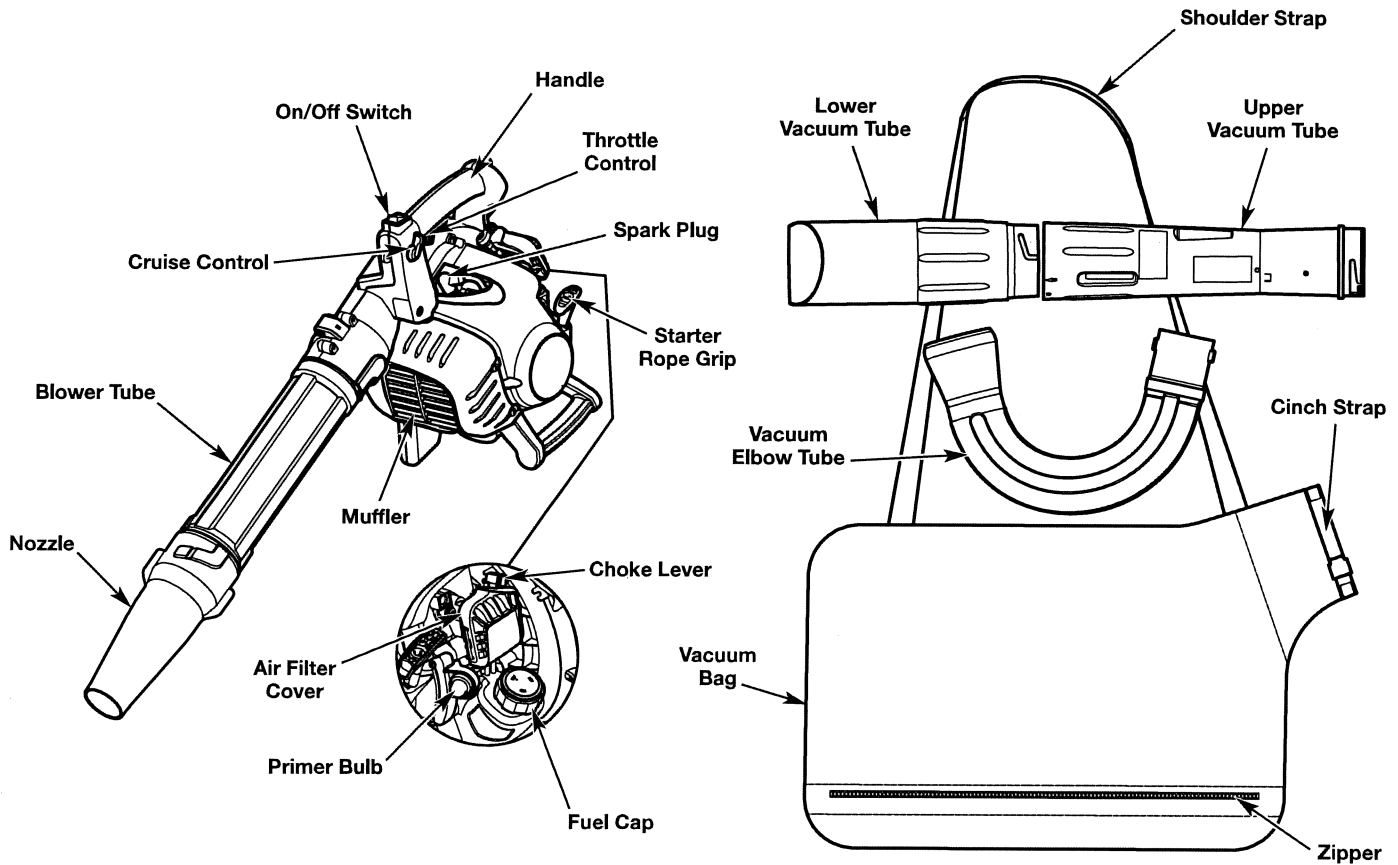

SPECIFICATIONS*

| | |
|--------------------------------------------------------------------------|--------------------------------------------|
| Engine Type | Air-Cooled, 2-Cycle |
| Displacement..... | 27 cc (1.64 cu. in.) |
| Spark Plug Gap..... | 0.025 in. (0.635 mm) |
| Spark Plug..... | Champion® RDJ7J or equivalent plug |
| Lubrication | Fuel/Oil Mixture |
| Fuel/Oil Ratio | 40:1 |
| Fuel Tank Capacity..... | 14 oz. (414 ml) |
| Approximate Unit Weight (No fuel) | 10 - 12 lbs. (4.5 - 5.4 kg) |
| Air Volume** (measured at: outlet / blower tube / nozzle)..... | 450 / 425 / 310 cfm (12 / 12 / 8 m³/min) |
| Air Speed (Peak)** (measured at: outlet / blower tube / nozzle)..... | 120 / 125 / 205 mph (193 / 201 / 330 km/h) |
| Air Speed (Average)** (measured at: outlet / blower tube / nozzle) | 100 / 105 / 175 mph (161 / 169 / 282 km/h) |
| Mulching Ratio..... | up to 16:1 |
| Vacuum Bag Capacity | 1.5 Bushel (54.6 L) |

* All specifications are based on the latest product information available at the time of printing. We reserve the right to make changes at any time without notice.

** Measured per ANSI B175.2.