



Buy it for looks. Buy it for life.®

Illustrated Parts

■ Order by Part Number

*There is more than 1 version of this model.
Page down to identify the version you have.*

• 2nd generation valve manufactured on and after July 27th, 2009. Can be identified by mounting plate and smaller drive feature (1-1/8") on adapter nut.

• 147210 volume control cartridge will not work with 1st generation valves.

ExactTemp® 3/4" Volume Control Flow Valve MODEL S3600
--

2nd Generation Valve Parts

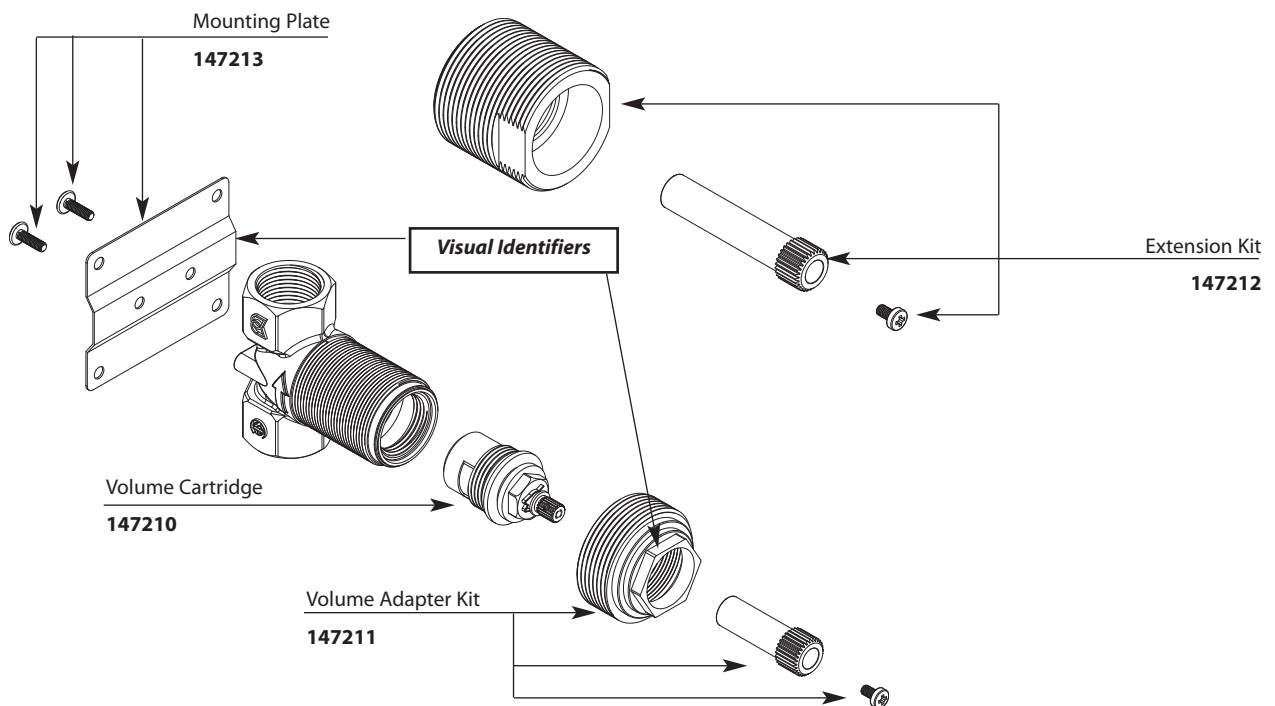



Buy it for looks. Buy it for life.®

Illustrated Parts

■ Order by Part Number

- 1st generation valves manufactured prior to July 27th, 2009. Valves can be identified by a lack of a mounting bracket and drive feature on adapter nut (requires open ended wrench).
- 130157 volume control cartridge will not work with 2nd generation valves.

ExactTemp®
3/4" Volume Control Flow Valve

MODEL
S3600

1st Generation Valve Parts

