

STEP 3:

Use clamps (not included) to stabilize panels.
Lock all bolts (G) by using bolt caps (H) .

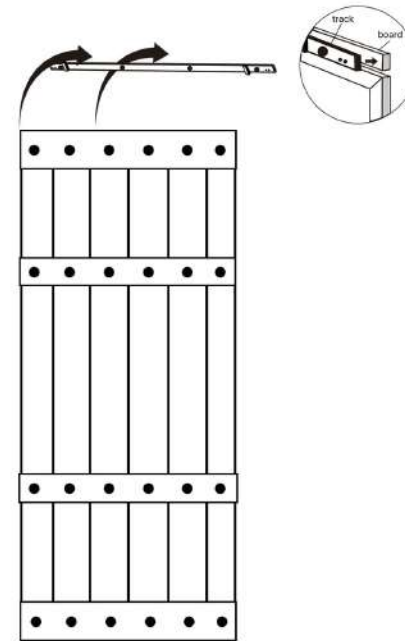
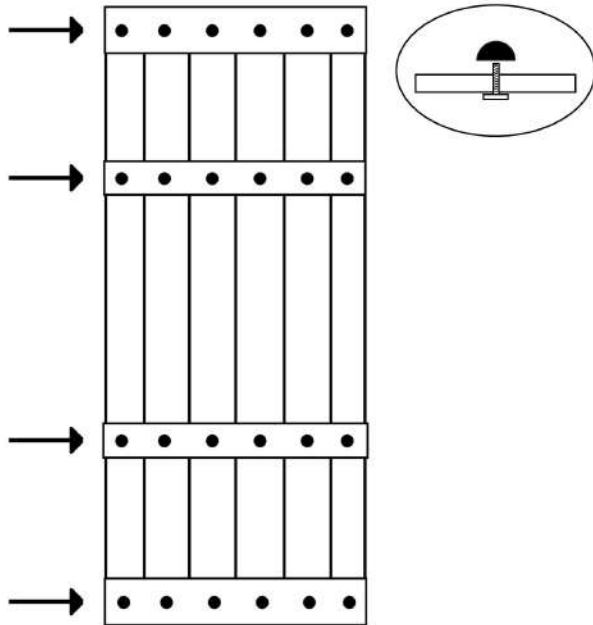

For installation of the sliding hardware kit, please refer to the sliding hardware kit installation instruction included in the package.

—Return & Refund Policy

If, for any reason, you are not satisfied with a purchase, we invite you to review our policy on returns and refunds. The following terms are applicable for any product(s) that you purchased with us. You are entitled to return your order within 30 days from the date on which you received the product or on which a third party you have appointed, who is not the carrier, takes possession of the product delivered. The delivery date will be subjected to the information provided by the shipping carrier. In order for the product(s) to be eligible for a return, please ensure the products are in original packaging and were not used or damaged.

If you ordered the product through a marketplace, their return and refund policy takes precedence. Coast Sequoia, Inc reserves the right to refuse returns of any merchandise that does not meet the return conditions in our sole discretion.



COAST SEQUOIA INC

Coast Sequoia

Castle - Series

Sliding Barn Door

Installation Instruction

Website: www.coastsequoia.com

Email: info@coastsequoia.com

PARTS INCLUDED

Description	Part	Side View	Qty
Left Side Panel	(A)		1
Middle Panel	(B)		4
Right Side Panel	(C)		1
Top Panel	(D)		1
Center Panel	(E)		2
Bottom Panel	(F)		1
Bolt	(G)		24
Bolt Cap	(H)		24

PRE-INSTALLATION

Product Cautions:

1. Avoid Direct Sunlight
2. Avoid Moisture
3. Avoid Rain



Tools Required

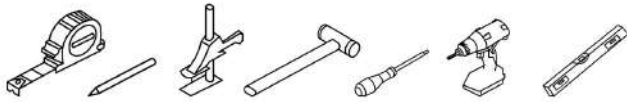

Assembly with a partner is recommended.
Wear working gloves.

INSTALLATION

STEP 1:

Combine lower Panel A, B, and C.
Make sure all panels with 45 degree incline side corners are facing upward.

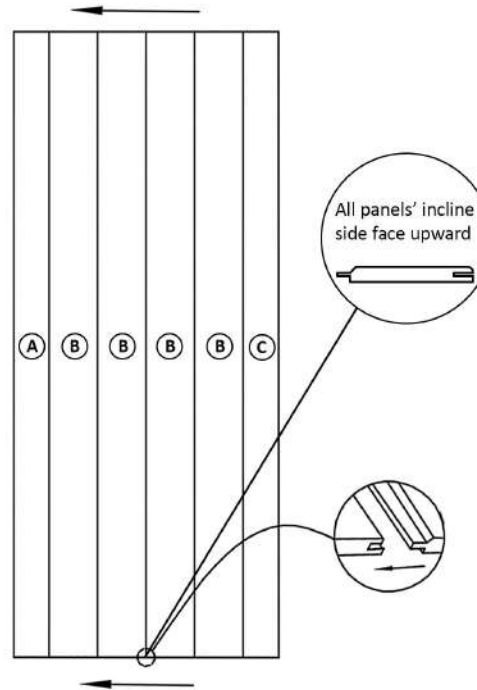

STEP 2:

Align upper Panel D, E, F with pre-drilled holes.
Top and bottom panels are 1" thick and 8" wide.
Center panels are 1" thick and 6" wide.

