

210X290mm 对折

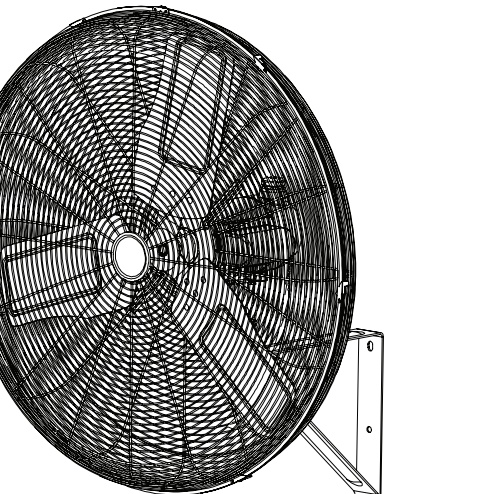

24 " OSCILLATING HIGH VELOCITY WALL FAN

INDOOR / OUTDOOR USE



ITEM NO : FAN-OW24S

READ & SAVE THESE INSTRUCTIONS

Questions, problems, missing parts? Before returning the product,

please e-mail our customer service by

hicfm@outlook.com

READ AND SAVE THESE INSTRUCTIONS

To prevent serious injury or property damage, read and understand owner's manual before operating.
This product can be used indoor or outdoor with a proper GFCI plug.

SAFETY INFORMATION

WARNING

1. Unplug the fan before moving it or performing maintenance.
Don't operate the fan when your hands are wet.
2. Do not disassemble, repair or rebuild the fan.
3. Unplug the fan when it is not in use.
4. Do not unplug the fan by holding the cable cord. Unplug by holding the plug.
5. DO NOT use the fan when there is damage to the cable cord or plug. If the supply cord is damaged, it has to be replaced by the manufacturer, its service agent or similarly qualified persons.
6. To Reduce The Risk Of Fire, Electric Shock Or Injury To Persons, Do Not Use Replacement Parts That Have Not Been Recommended By The Manufacturer (e.g. Parts Made At Home Using A 3D Printer).
7. Do not use the fan close to fires.
8. Do not insert your hand or other objects into the guard or near movable parts.
9. To reduce the risk of fire or electric shock, do not use this fan with any solid-state speed control device.
10. Do Not Use An Extension Cord With This Fan.

CAUTION

1. Unplug the fan from the socket and clean it with a soft cloth.
2. DO NOT immerse the fan.
3. Fit the guard onto fan before starting up the fan.
4. This fan is not intended for use by people (including children) with reduced physical, sensory or mental capabilities or lack of experience and knowledge unless they have been given supervisor or instruction concerning use of the fan by a person responsible for their safety. Supervise children to ensure they do not play with the fan.

TECHNICAL SPECIFICATIONS

ITEM NO.	MODEL NO.	SIZE	VOLTE/Hz	CURRENT(A)	RPM	CFM
FAN-OW24S	SFW-750/60VWA	24"	120V/60Hz	2A	1100	8900

OPERATING INSTRUCTIONS

1. Test GFCI(Ground Fault Circuit Interrupter) plug BEFORE EACH USE.

- Plug GFCI into power outlet. Press RESET button(b). Indicator(a) should turn red.
 - Press TEST button(c). Indicator (a) should turn off.
 - GFCI plug is tripped.
 - DO NOT USE FAN IF ABOVE TEST FAILS.
- Call customer service for assistance.

2. ADJUSTING AIR SPEED

The fan has three speeds (LOW, MEDIUM and HIGH). Pull the chain (e) of the unit to adjust air flow to desired speed.

3. USING THE OSCILLATING FEATURE

Pressing down on the oscillation knob (d) will allow the fan head to start oscillating. Pulling up on the oscillation knob (d) will lock the fan head at the desired position.

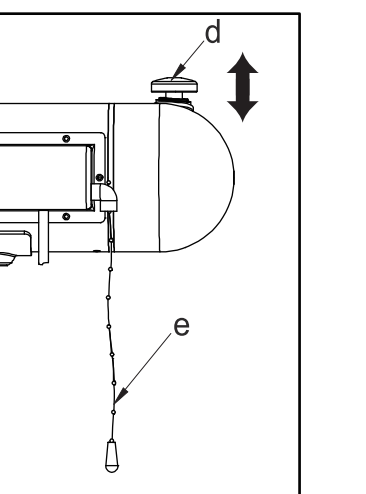

ASSEMBLY

1. Mark the mounting hole locations by using the holes in the bracket as a guide, then drill the holes.
A. For concrete wall installation, after drilling, you would insert the wall anchors and tap them flush with the wall, position the bracket and then screw the two bolts into the anchors, securely attaching the bracket to the wall.
- B. For wall stud installation, after drilling the smaller diameter pilot hole, position the bracket and screw the two bolts into the wall until they are secured.

CAUTION

The fan is only suitable for concrete wall or direct to stud installation. Do not use for dry wall mounting. Use the mounting accessories shipped with products for wall mounting.

WARNING

This fan is to be mounted with wall bracket. It MUST be mounted and secured on a solid wall that is structurally sound to support the fan and mounting bracket. The wall bracket along with the fan MUST NOT be mounted on any surface that is subject to vibration, wobbling, movement or the like. The fan MUST be mounted and properly secured to a stationary structure.

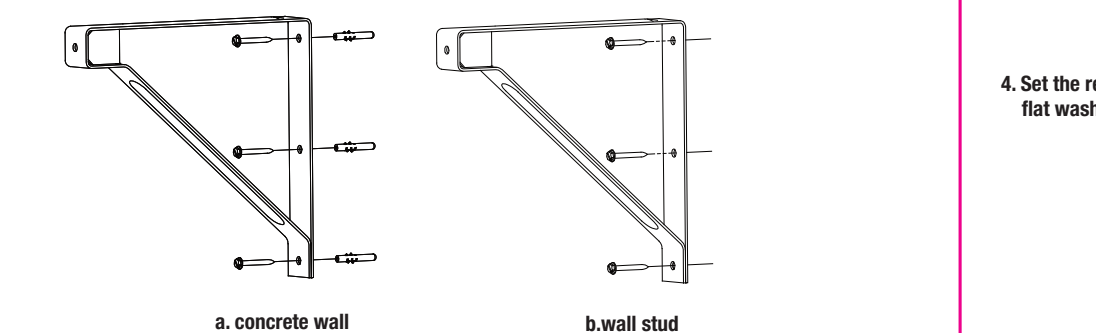

2. Assemble the motor Z brackets by fastening screws and nuts.

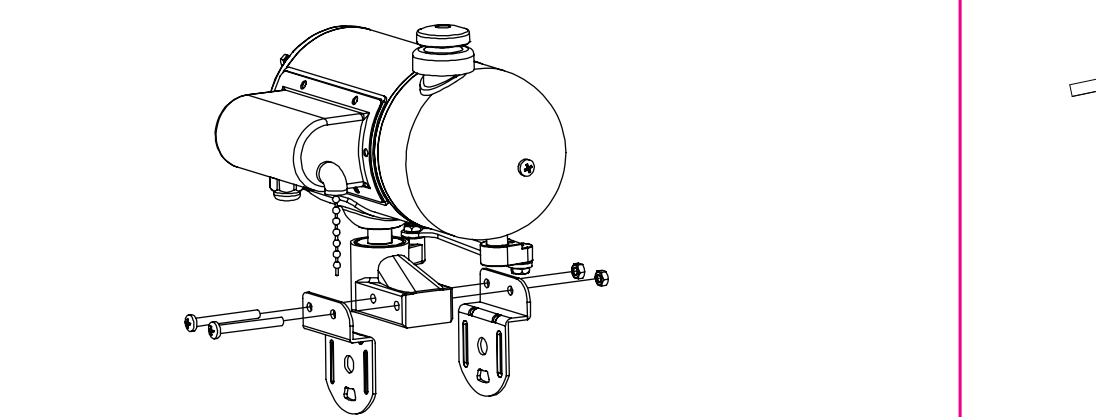

3. Remove four sets of hexagonal nuts, spring washers, and flat washers from the motor, save them for step 4.

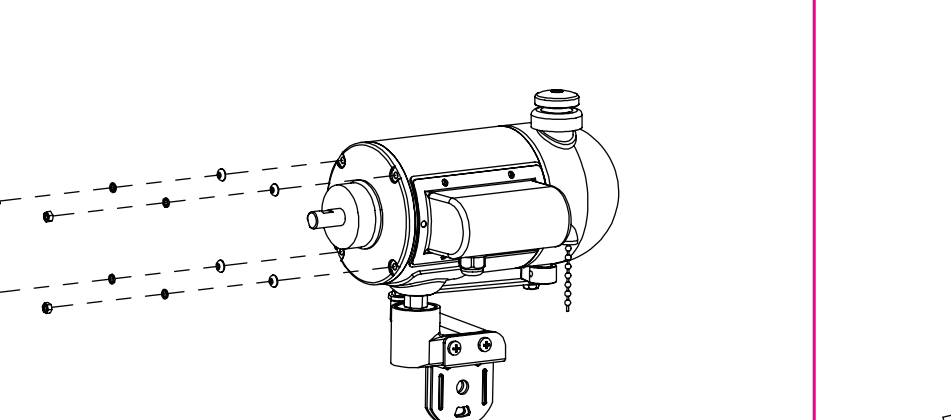

4. Set the rear guard in the proper position and affix it to the motor using the hexagonal nuts, spring washers, and flat washers.

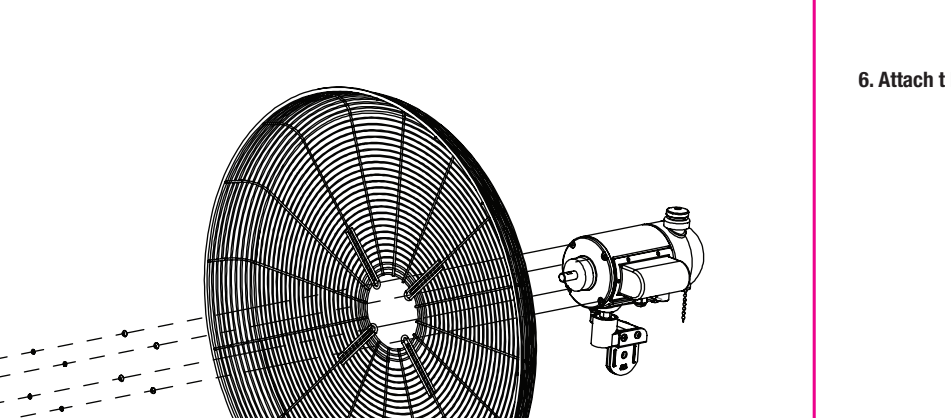

5. Assemble the fan blade onto the motor shaft by tightening the two screws. Make sure the screws are tightly secured.

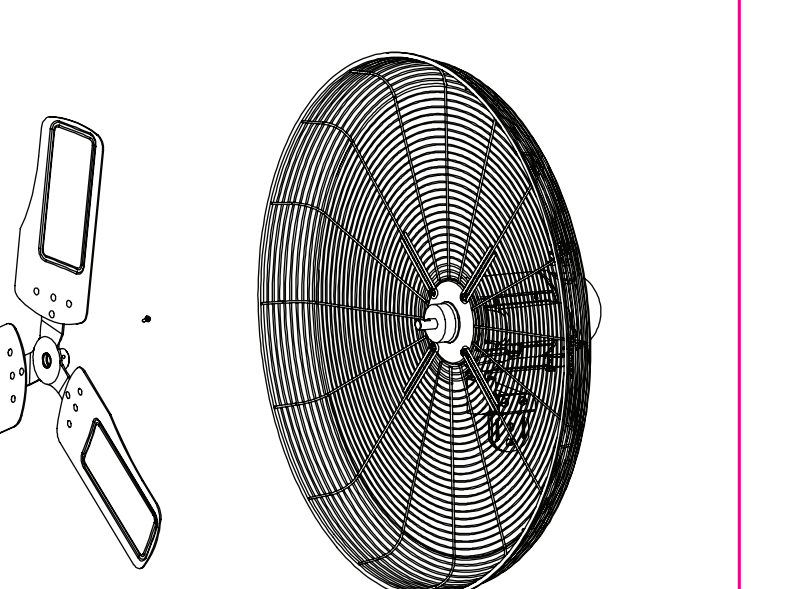

6. Attach the front guard to the rear guard and secure them together by using the clips on the front guard.

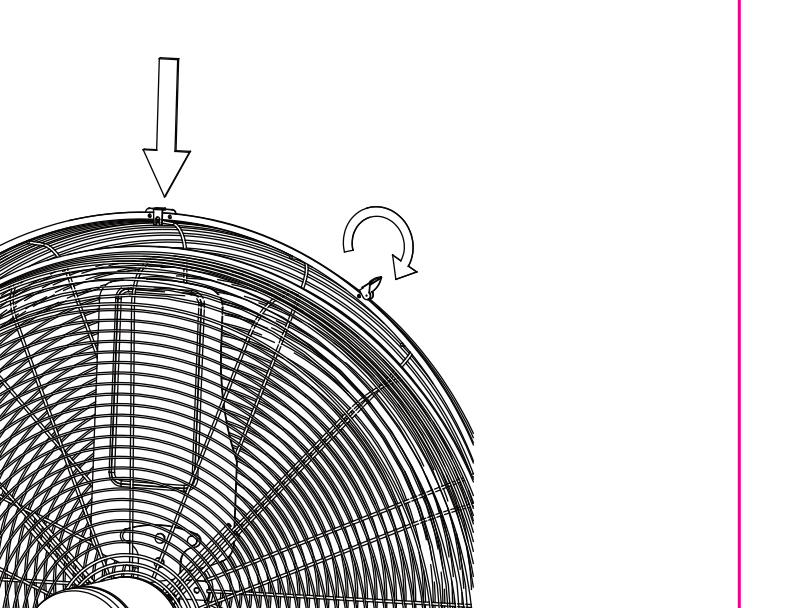

7. Secure the assembly on the front guard and rear guard by tightening the screw, washer and nut at the bottom of the fan guards.

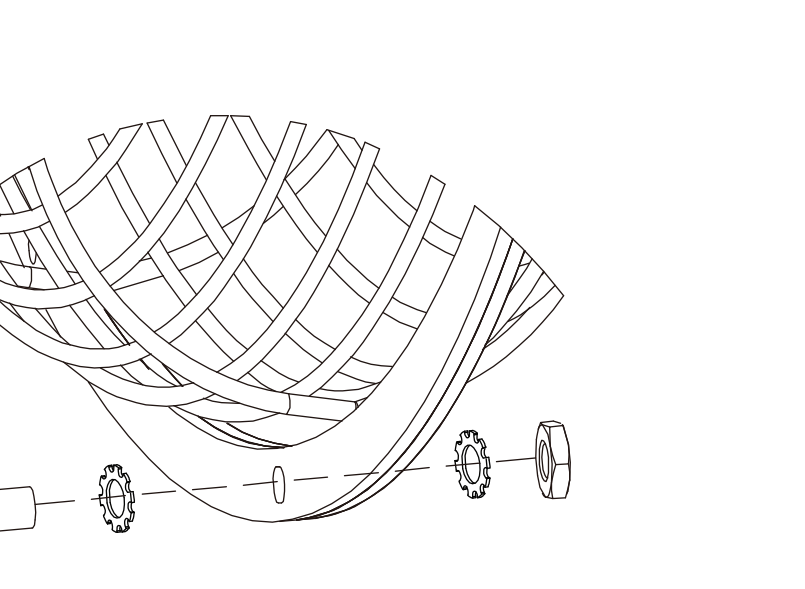

8. Insert the swivel bracket into motor Z brackets and fasten it with bolt (a), flat washer (b), spring washer (c) and nut (d). Fasten the bolt (f) with the knob (e) for adjusting the tilt angle of the fan or fix the tilt angle of the fan.

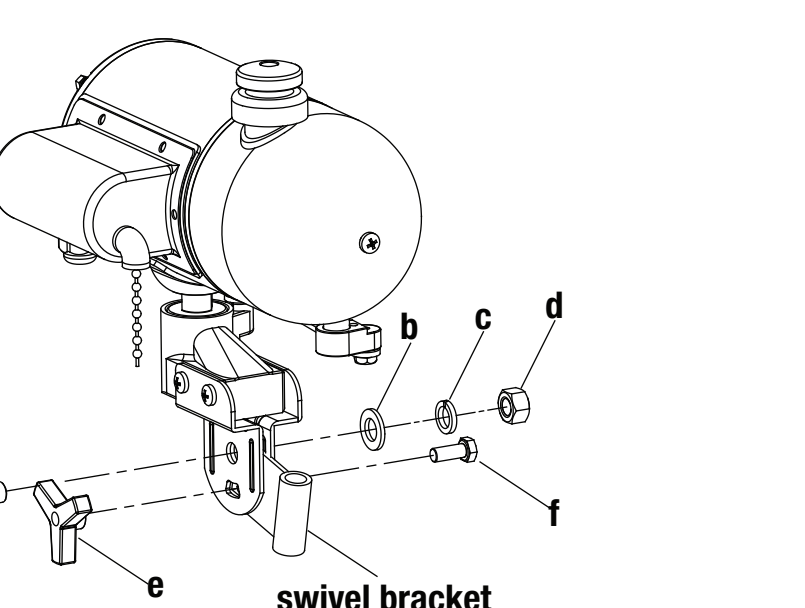

9. Assemble the swivel bracket with wall bracket and fasten with hexagon screw, flat washer, spring washer and nut.

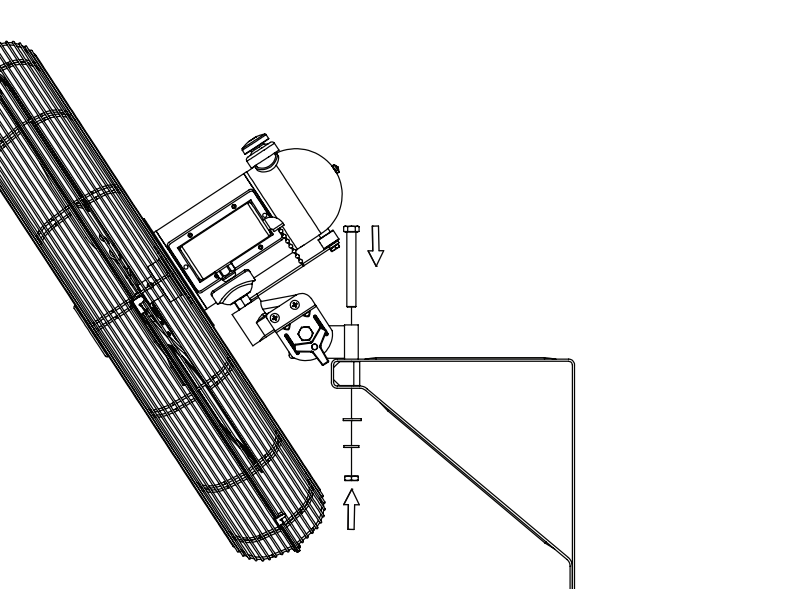

10. Loosen the knob (g) and adjust until the fan head is at the desired angle. Tighten the knob (g) back.

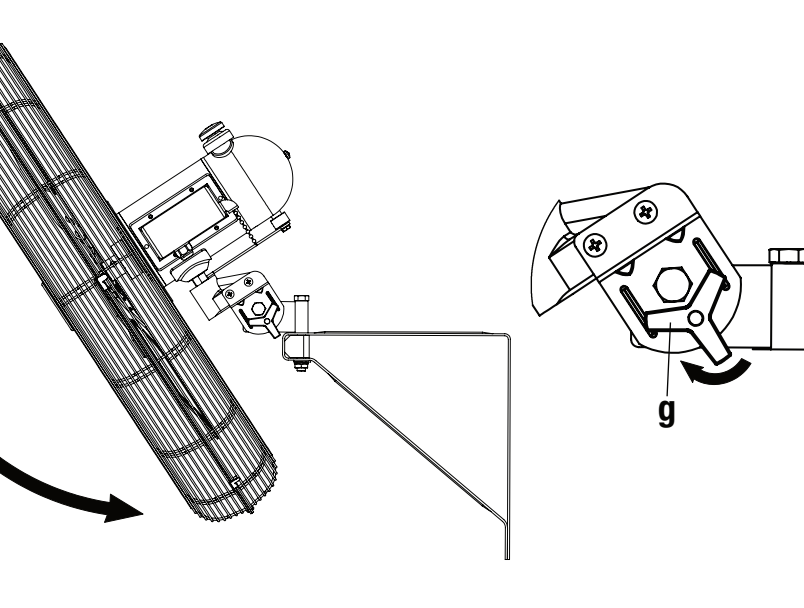

CARE AND MAINTENANCE

Unplug the appliance before cleaning. Don't use any water for cleaning metal surfaces. Slightly moisten a cloth and then wipe off the surfaces of the fan. In order to remove dust from the grill, use a vacuum cleaner or remove the front grill by removing the securing screws on the edge of the grill. After doing this, fasten the screws on the edge of the grill.

1-YEAR LIMITED WARRANTY

The manufacturer warrants this product to be free from manufacturing defects in the material and workmanship under normal use for a period of one year after the date of purchase by the original purchaser.
This warranty does not cover transit damages. This warranty does not apply to damages from accident, misuse, alteration of any kind to the fan or where the connected voltage is more than above the nameplate voltage. This warranty does not apply to the finish on any portion of the product. Servicing performed by unauthorized persons shall render the warranty invalid. The warranty is not responsible for damages of any kind, including accident and consequential damages. Some states do not allow the exclusion or limitation of the incidental or consequential damages, so the above exclusion or limitation may not apply to you. This warranty gives you specific legal rights, and you may also have other rights which vary from state to state.

REPLACEMENT PARTS LIST

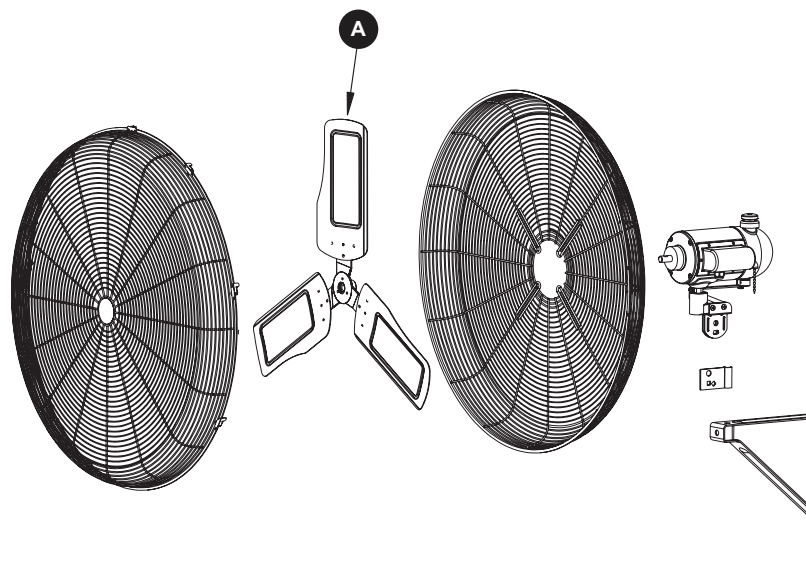

SIZE	PART	DESCRIPTION	PART #
24"	A	Blade	FAN-OW24S-01

Warning:

Use of secondary safety support cable does not guarantee protection against injury of persons. Mounting of both the circulator and cable could fail if subject to abuse, neglect or if improperly installed. To avoid personal injury, circulators must be supported anytime angle is adjusted.

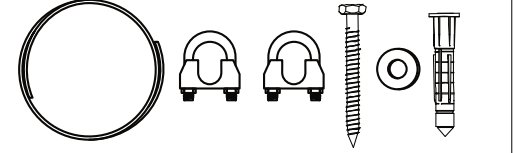

PARTS	SPECIFICATION	QTY
1	Φ3*3050	1
2	M5*13	2
3	ST8*50	1
4	Φ8*Φ24*±2	1
5	Φ10*60	1

For concrete wall installation

1. Drill a hole in concrete wall, insert the wall anchor and tap it flush with the wall.

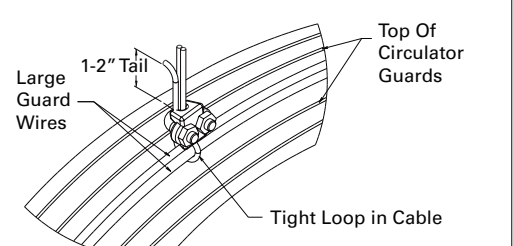

2. Fasten a bolt and a washer through the terminal of secondary safety support cable into the anchor for security.

