

Before you begin

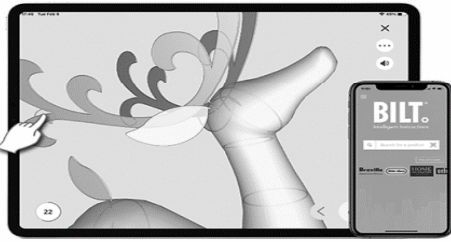

SCAN FOR BILT 3D INSTRUCTIONS



3D-GUIDED INTERACTIVE ASSEMBLY INSTRUCTIONS CAN BE FOUND IN BILT®
 DOWNLOAD THE FREE APP



SKU # 1005 416 765
 OMS THD SKU # 1005 269 897
 Model # TY619-2014

ASSEMBLY INSTRUCTIONS

8.5 ft Yuletide Lane GIANT-SIZED LED
 Santa's Sleigh with Reindeer

USE AND CARE GUIDE

PLANNING ASSEMBLY

Carefully remove all the parts from the box and place them on the ground. Many parts are connected by the lighting string that runs throughout the item. Take special care not to pull, cut or damage the lighting string. Read the entire manual prior to assembly and identify all the parts included in the package against the parts list. It is recommended to assemble parts of the product while laying flat on the ground versus standing the item up to assemble the parts. If any parts are missing or damaged do not attempt assembly but contact our customer service center or return to the place of purchase with purchase receipt. 1-877-527-0313

*Assembly of this product may require more than one person.

Pre-Operation

CAUTION: Grasp the plug to insert or remove from the power source. Do not unplug by pulling on cord.

CAUTION: The lighting string on this product is rated at 19.2 Watts (0.16 Amps). Do not overload. Do not connect to another lighting string, decorative outfit or other electrical products. Before you use or re-use this product inspect it carefully. Discard or return to place of purchase with purchase receipt if the product has cuts, damage, frayed wire insulation on cords, cracks in the socket enclosures, loose connections, exposed copper wire or other obvious damage.

Care and Cleaning

- Carefully remove the product from wherever it is placed. This helps to avoid any undue strain or stress on the product connections and wires. If the product is placed somewhere other than the ground it should be well secured and flat.
- Carefully disassemble the unit taking caution not to cut any electrical wires.
- Wipe the unit with a damp cloth and allow the unit to dry before storing.
- Store the product neatly in a cool, dry location protected from sunlight.

Troubleshooting

- Ensure that the floor or surface that the item sits on is flat and level
- Be sure to plug the item correctly to a wall outlet or a UL Listed Power Cord
- Ensure all parts are assembled properly per the Instruction Manual
- If the item does not light check for loose or broken bulbs and connections
- Do not plug into other electrical items
- If the item has multiple Light String Cords be sure to plug in all cords
- Check for Broken or Burned Out Fuse In Plug

Guarantee

What is Covered

The product is intended for residential seasonal use for 90 days per year. This product is covered by a 90 days limited guarantee due to defects in material and workmanship. Return the product with purchase receipts to the location of purchase for refund within 90 days of purchase.

What is Not Covered

This warranty does not cover commercial use, normal wear and tear, products not used in accordance with directions provided on or with the product, burn out of bulbs or LEDs, batteries, products that have been subjected to unauthorized repair and/or modification and damage caused by shipping and improper handling, alterations, misuse, in store display models or accidents. Questions, problems, missing parts? Before returning to the store, call Home Accents Holiday Customer Service 8 a.m.-6 p.m., EST, Monday-Friday 1-877-527-0313

Diagram of Parts

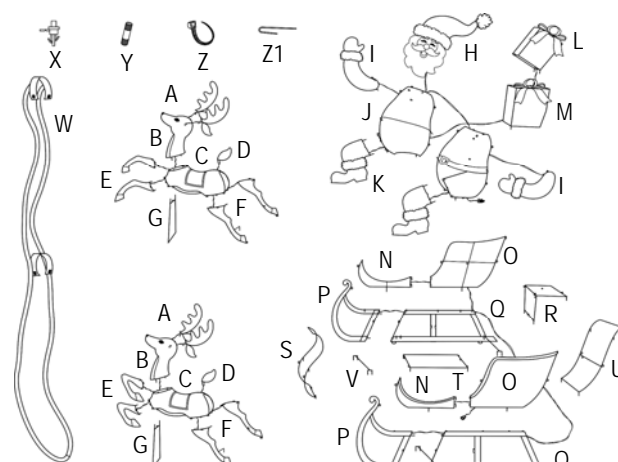

Thank you!

We appreciate the trust and confidence you have placed in Home Accents through the purchase of this 8.5 ft Yuletide Lane GIANT-SIZED LED Santa's Sleigh with Reindeer. We strive to continually create quality products designed to enhance your home. Visit us online to see our full line of products available for your home improvement needs. Thank you for choosing Home Accents!

1-877-527-0313

HOMEACCENTSHOLIDAY.COM

| Parts List | | |
|------------|-----------------------|------|
| Locater | Name | Qty. |
| A | Antler & Ear | 4 |
| B | Head/Neck | 2 |
| C | Body | 2 |
| D | Tail | 2 |
| E | Front Leg | 4 |
| F | Hind Leg | 4 |
| G | Support Frame | 2 |
| H | Santa Head/Hat | 1 |
| I | Santa Arm | 2 |
| J | Santa Body Halves | 2 |
| K | Santa Leg/Boot | 2 |
| L | Upper Gift Box | 1 |
| M | Lower Gift Box | 1 |
| N | Front Side Panel | 2 |
| O | Back Side Panel | 2 |
| P | Front Runner | 2 |
| Q | Back Runner | 2 |
| R | Seat | 1 |
| S | Front Panel | 1 |
| T | Floor Panel | 1 |
| U | Back Panel | 1 |
| V | Cross Support Bracket | 1 |
| W | Collared Reins | 1 |

| Hardware List | | |
|---------------|--------------|------|
| Locater | Name | Qty. |
| X | Spare Bulb | 8 |
| Y | Spare Fuse | 8 |
| Z | Plastic Tie | 45 |
| Z1 | Ground Stake | 12 |

ASSEMBLY

1 Assembling the Legs to the First Deer's Body

(Note: Please reference page 1 photo of assembled product to see the Deer in position as First Deer and Second Deer). Insert the connecting rods on the Front and Hind Legs (E,F) into the connecting holes on the underside of the First Deer's Body (C) and fasten at the connecting loops with Plastic Ties (Z).

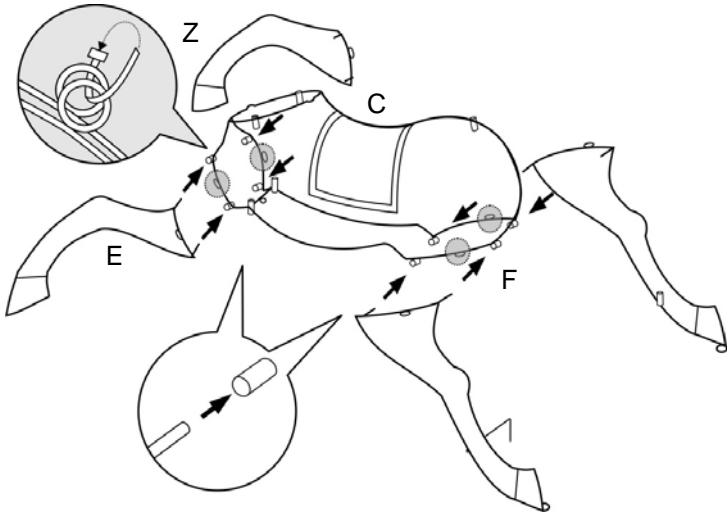

2 Assembling the Support Frame to the First Deer's Body

Insert the connecting rods on the Support Frame (G) into the connecting holes on the underside of the First Deer's Body (C) and fasten at the connecting loops with Plastic Ties (Z). The Legs come with metal bars attached to stabilize the Deer. Insert the hooked end of the metal bars into the connecting hole on the opposite Leg.

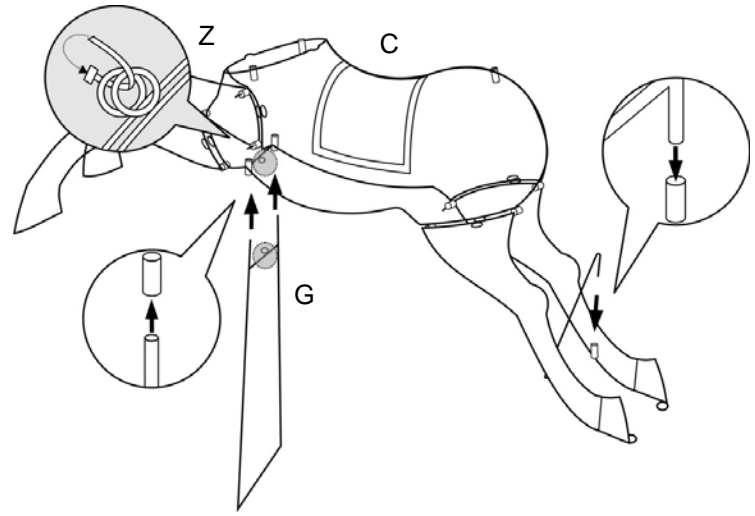

3 Assembling the Head/Neck, Antler, Ear and Tail to the First Deer's Body

Insert the connecting rods on the bottom of the Head/Neck of Deer (B) into the connecting holes on the front top of the First Deer's Body (C) and fasten at the connecting loops with Plastic Ties (Z). Insert the connecting rods on each Antler & Ear of Deer (A) into the connecting holes on top of the Head. Insert the connecting rod on the Tail (D) into the connecting holes at the rear of the First Deer's Body (C).

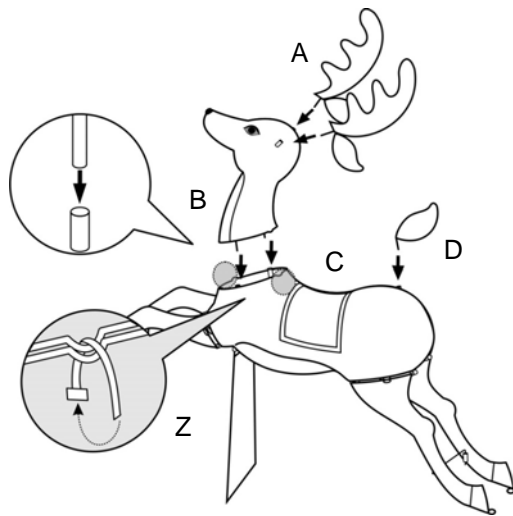

4 Assembling the Legs to the Second Deer's Body

(Note: Please reference page 1 photo of assembled product to see the Deer in position as First Deer and Second Deer). Insert the connecting rods on the Front and Hind Leg (E,F) into the connecting holes on the underside of the Second Deer's Body (C) and fasten at the connecting loops with Plastic Ties (Z).

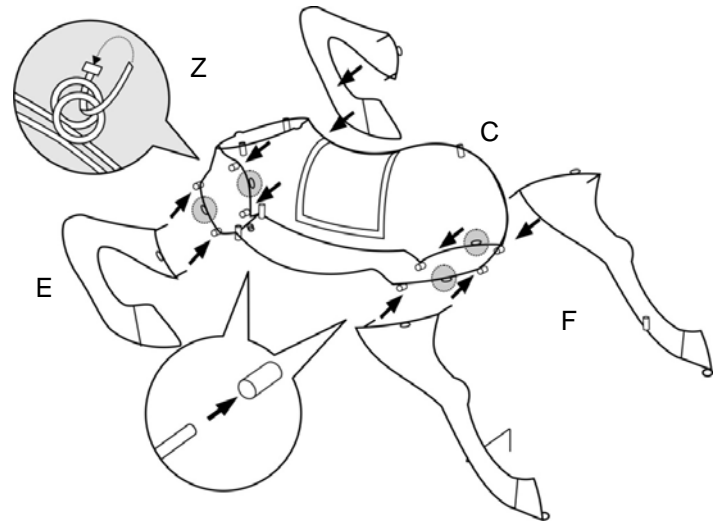

5 Assembling the Support Frame to the Second Deer's Body

Insert the connecting rods on the Support Frame (G) into the connecting holes on the underside of the Second Deer's Body (C) and fasten at the connecting loops with Plastic Ties (Z). The Legs come with metal bars attached to stabilize the Deer. Insert the hooked end of the metal bars into the connecting hole on the opposite Leg.

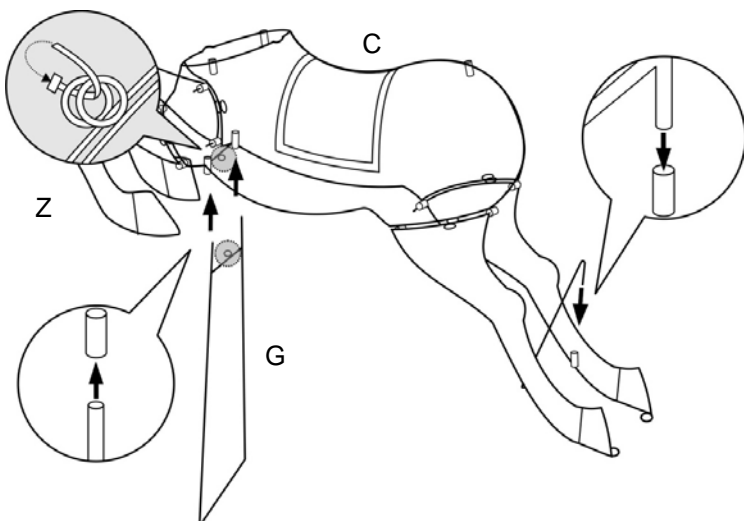

6 Assembling the Head/Neck, Antlers, Ears and Tail to the Second Deer's Body

Insert the connecting rods on the bottom of the Head/Neck of Deer (B) into the connecting holes on the front top of the Second Deer's Body (C) and fasten at the connecting loops with Plastic Ties (Z). Insert the connecting rods on each Antler & Ear of Deer (A) into the connecting holes on top of the Head. Insert the connecting rod on the Tail (D) into the connecting holes at the rear of the Second Deer's Body (C).

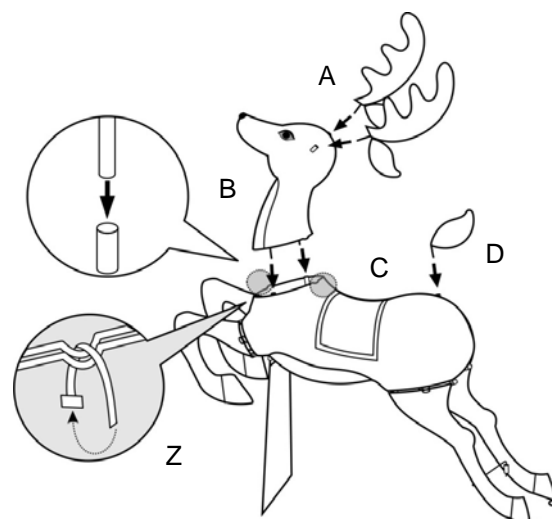

ASSEMBLY

7 Sleigh: Assembling the Runners

Insert the two connecting rods on the back edge of each Front Runner (P) into the connecting holes on the front edge of each Back Runner (Q) then fasten at the connecting loops with Plastic Ties (Z).

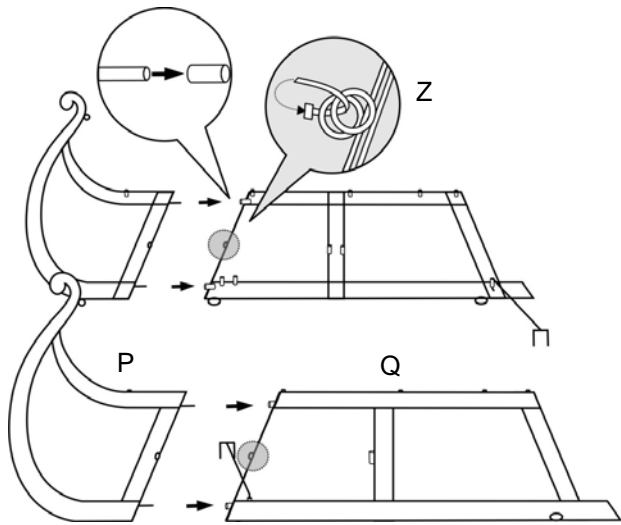

8 Sleigh: Assembling the Cross Support Bracket and attaching the Stabilizing Bars

The Runners come with built in stabilizing bars to stabilize the Sleigh. Attach the metal bars to the connecting hole on the inside of the opposite Runner (Q). Insert the connecting rods on the Cross Support Bracket (V) into the matching connecting holes on the middle of the Back Runners (Q).

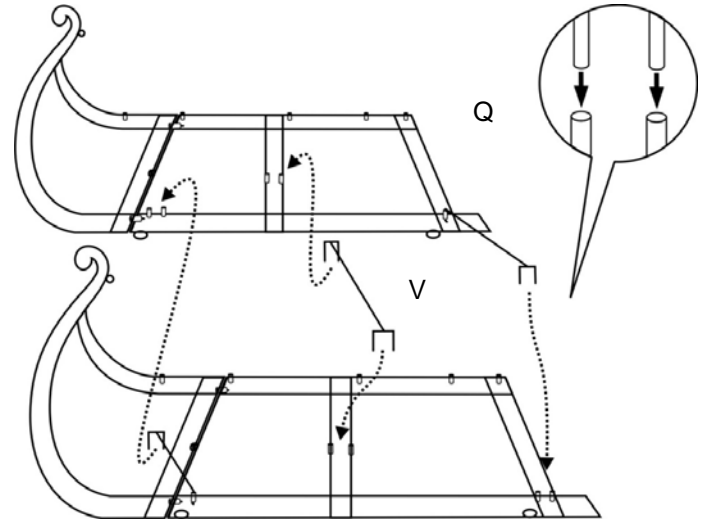

9 Sleigh: Assembling the Floor Panel to the Runners

Insert the connecting rods on the bottom side of the Floor Panel (T) into the matching connecting holes on the top of the Front & Back Runners (P,Q) then fasten at the connecting loops or over the metal frames with Plastic Ties.

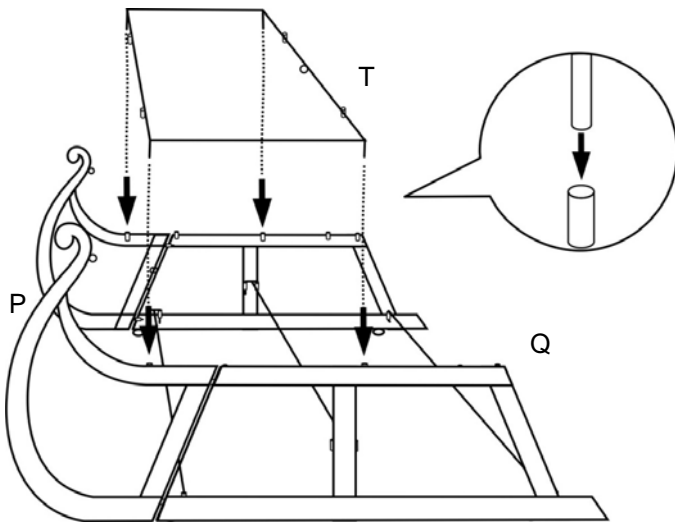

10 Sleigh: Assembling the Front & Back Side Panels

Insert the two connecting rods on the back edge of each Front Side Panel (N) into the connecting holes on the front edge of the Back Side Panel (O) then fasten together over the metal frames with Plastic Ties.

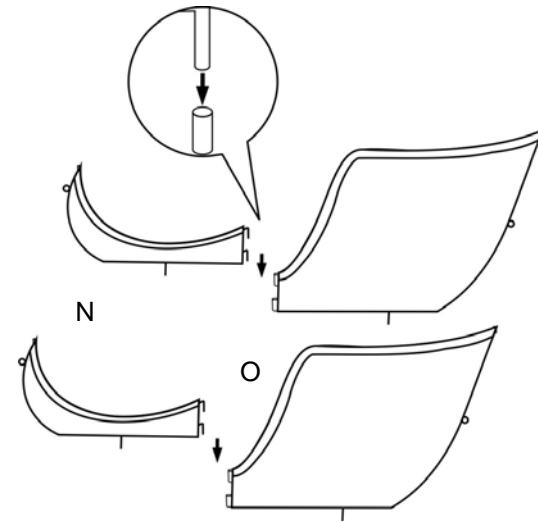

11 Sleigh: Assembling the Side Panels to the Runners

Insert the connecting rods of the bottom of the Side Panels (N,O) into the matching connecting holes on the top of the Front and Back Runners (P,Q) then fasten together with Plastic ties over the metal frames.

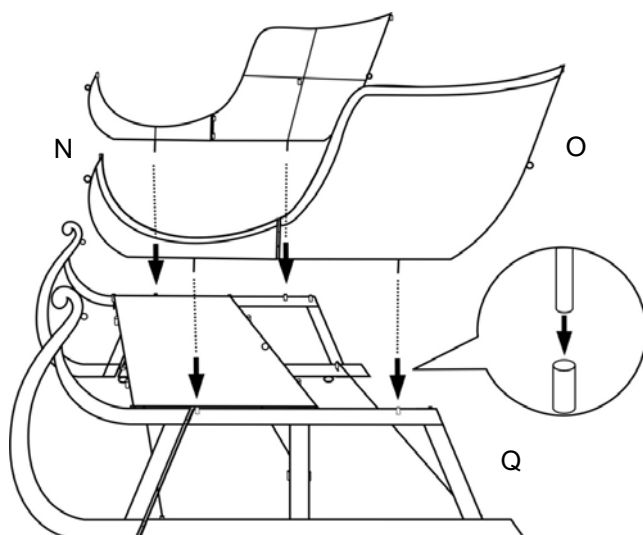

12 Sleigh: Assembling the Front Panel and Back Panel

Insert the connecting rods on the bottom edge of the Front Panel (S) into the matching connecting holes on the top of the Floor Panel (T) and the Front Side Panel (N) and fasten at the connecting loops with Plastic Ties (Z). Insert the connecting rods on the Back Panel (U) into the matching connecting holes on the top of the Back Side Panels (O) and the top of the Back Runner (Q) and fasten at the connecting loops with Plastic Ties (Z).

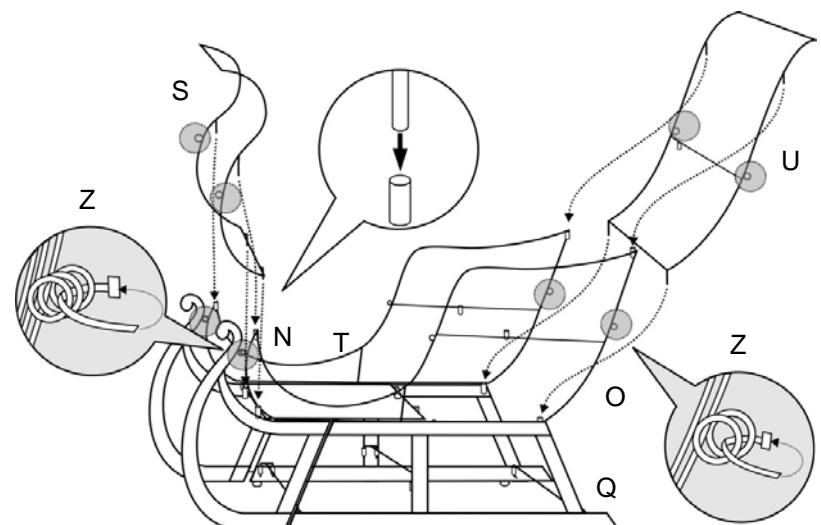

ASSEMBLY

13 Sleigh: Assembling the Seat to the Floor Panel and Back Panel

Insert the connecting rods on the bottom of the Seat (R) into the matching connecting holes on the Back Side Panel (O) and Floor Panel (T) (per diagram below) then fasten at the connecting loops with Plastic Ties (Z).

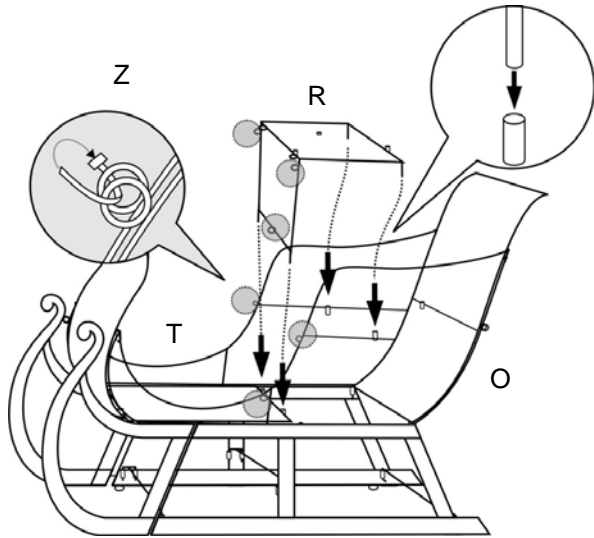

14 Assembling the Body, Arms and Legs of Santa

Align the Halves Body of Santa (J) then Insert the connecting rods on one side into the connecting holes on the other side then fasten together at the connecting loops with Plastic Ties (Z). Insert the connecting rods on each Arm and Leg/Boot of Santa (I,K) into the matching connecting holes on Santa's Body (J) and fasten at the connecting loops with Plastic Ties (Z).

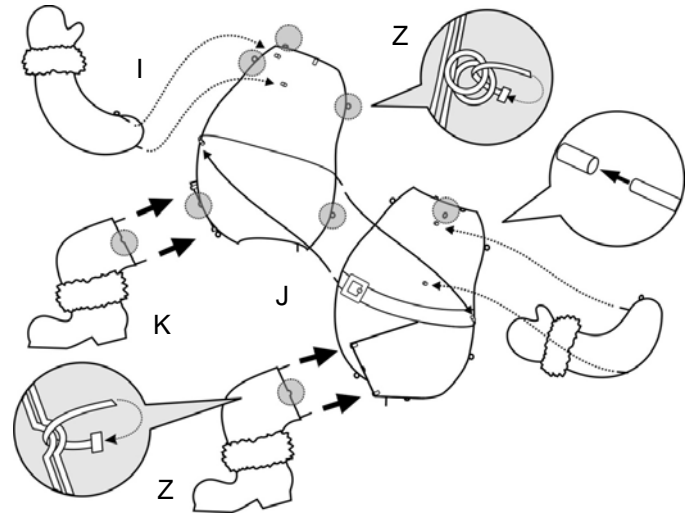

15 Assembling the Head/Hat and Gift Boxes

Insert the two connecting rods at the bottom of the Head/Hat of Santa (H) into the connecting holes on the top of the Body of Santa (J) and fasten at the connecting loops with Plastic Ties (Z). Insert the two connecting rods at the bottom of the Upper Gift Box (L) into the connecting holes on top of the Lower Gift Box (M).

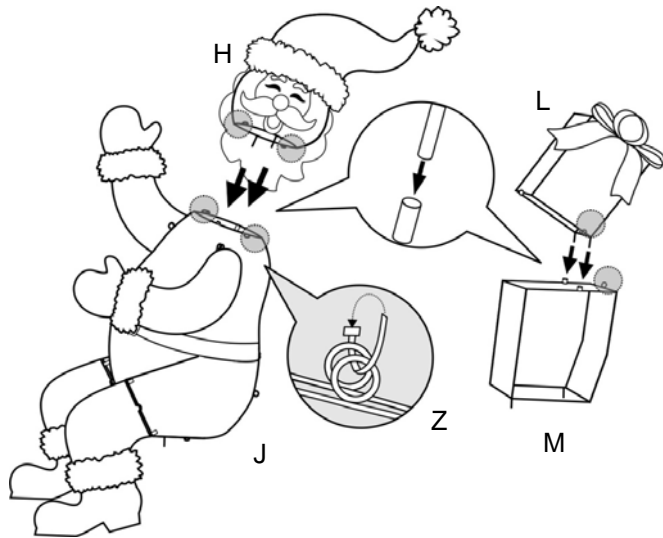

16 Assembling the Santa and Gift Boxes to the Sleigh

Insert the connecting rods at the bottom of the Santa Body (J) and Lower Gift Box (M) into the matching connecting holes on the Seat (R) and Back Panel (U) and align the back of Santa Body (J) to the front bottom of Upper Gift Box then fasten all parts at the connecting loops with Plastic Ties (Z). Note: Connect the electrical end-connector from the Santa to the plug from the Sleigh.

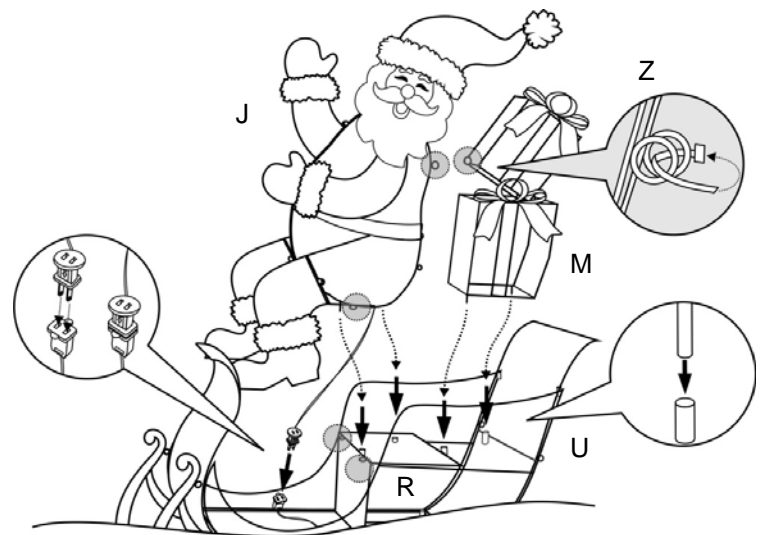

17 Assembling the Collar/Reins to the Deer and Sleigh

The Reins come with built in Collars. Wrap the Collared Reins (W) around the First Deer's neck then wrap around the Second Deer's neck then feed the reins back to the Sleigh and place in the left hand of the Santa. The Collars can be secured with the velcro closure.

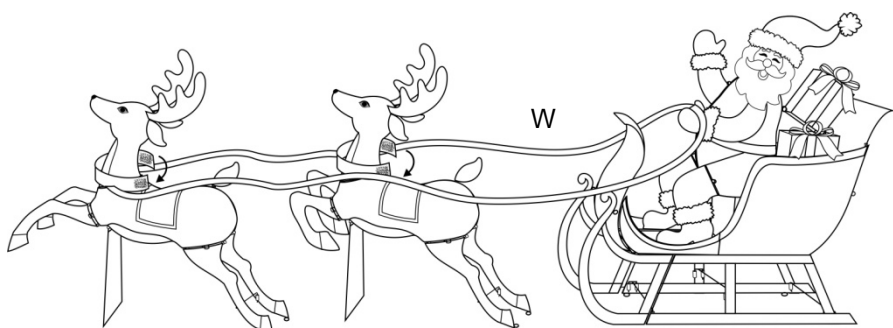

18 Assembling the Ground Stakes

Insert Ground Stakes (Z1) over the metal frame of the Support Stands and each back hoof of both Deer and at the four corners of the Runners on the Sleigh then into the ground firmly.

