

# Operating Your Dryer

## Cycle Selection Table

SENSOR DRY CYCLES			Drying Level	Temp.
Cotton	Quilts, small comforters and blankets	For thick and quilted fabrics	Very	High
	Terry towels, tea towels, towels, bed linen	For thick and quilted fabrics which do not need to be ironed	More	
	Bath towels, tea towels, underwear, cotton socks	For fabrics which do not need to be ironed	Normal	
	Sheets, pillowcase, towels	For fabrics which do not need to be ironed	Less	
	Bed linen, table linen, towels, T-shirts, polo shirts, and work clothes	For fabrics which do need to be ironed	Damp	
Mixed Fabrics	Bed linen, table linen, tracksuits, parka, blankets	For thick and quilted fabrics which do not need to be ironed	More	Medium High
	Shirts, blouses	For fabrics which do not need to be ironed	Normal	
	Trousers, dresses, skirts, blouses	For fabrics which do need to be ironed	Damp	
Easy Care	Shirts, T-shirts, trousers, under-wear and socks	For polyamide, acrylic, and polyester that do not need to be ironed	Normal	
	Shirts, T-shirts, under-wear, anoraks and socks	For polyamide, acrylic, polyester that do need to be ironed	Damp	
Bulky Items	Bed clothes, sheets	For bulky items	-	High
Jeans	Jeans and colour fading garments.	For jeans which do not need to be ironed	-	Medium High
Soft Care	T-shirts, pillowcase, and towels	For cotton fabrics which do not need to be ironed	-	Medium High
Quick Dry	A kind of linen and towel except for the special fabrics	For the small loads of qualified fabrics with short drying times	-	High
Sports Wear	Athletic uniform, training wear	For polyester material	-	Low
Delicates	Silk, Women's thin clothes, lingerie	For fabrics which are heat-sensitive like synthetic fabrics	-	Medium
Wool	Wool	For wool fabrics	-	Ultra Low
MANUAL DRY CYCLES				
Gentle Air	Silk, wool, delicate lingerie	Refreshes clothes without tumble drying (It can use the dryer rack.)	-	Ultra Low
Cool Air	All fabrics that need to be fluffed without heat		-	-
Warm Air	Bath towels, bath robes, dishclothes, quilted fabrics made of acrylic	Small clothes and pre-dried laundry normal fabrics using hot temperature	-	Adjustable

## CAUTION

If the load is less than 2.2lbs (1kg), please use Warm Air cycle in MANUAL DRY cycles  
 Use the Wool cycle for wool items and the Delicates cycle for heat-sensitive fabrics including silk, underwear and lingerie.  
 Be sure to follow the recommended load sizes when washing fabrics that need special care (see page 25) or clothes will not dry properly.

# Operating Your Dryer

## BEFORE YOU USE YOUR DRYER

1. When unpacking your dryer, make sure there is no visible damage to the machine.
2. Follow the installation instructions and use a level to ensure proper installation.
3. Check the water reservoir, condenser, door, gasket and drum for signs of damage.
4. Run the dryer for a few minutes to make sure it is heating properly.

### 1. Turn power on.

First, press the **Power** button. The indicator light above the button will become illuminated, indicating that the machine is ready set to run.

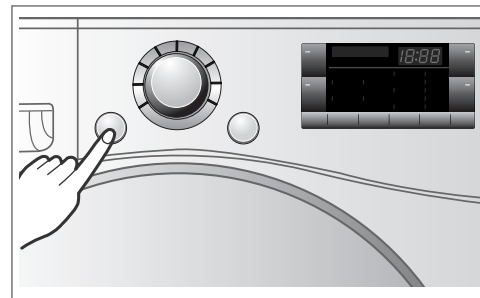

Turn the dryer on.

### 2. Open the door.

### 3. Check the lint filter, water container, and condenser.

The lint filter near the door, should be emptied before drying operation.

Open and check if lint filter is cleaned.

If not, clean it referring to page 22.

For better drying results, make sure the water container and condenser are also empty and clean.

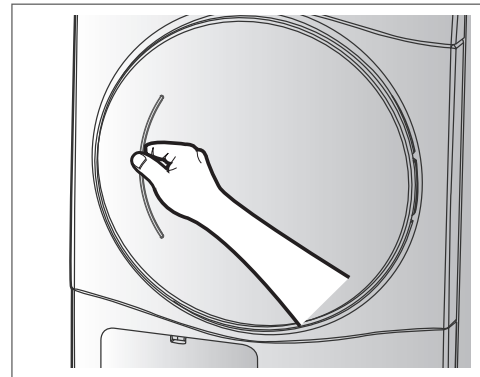

Open the door.

### 4. Place laundry into the drum after sorting.

The clothes should be sorted by fabric type and dryness level and all the strings and belts of clothes should be secured before being put into the drum.

Push the laundry all the way back to keep it away from the door seal.

If not, the door seal and clothes may be damaged.

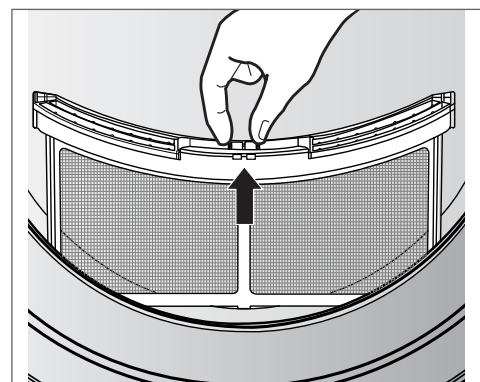

Check the lint filter.

# Operating Your Dryer

## 5. Close the Door.

Before you close the door, make sure fabrics are properly loaded and not caught in the door opening.

## 6. Select the Drying Cycle you want.

You can choose a cycle by turning the Cycle Selector Knob until the required program reaches to its indicator. If you press **Start/Pause** button without choosing any cycle, the dryer will proceed with the Cotton program. [Please refer to following Cycle Selection Table (page 15) for the detailed information]

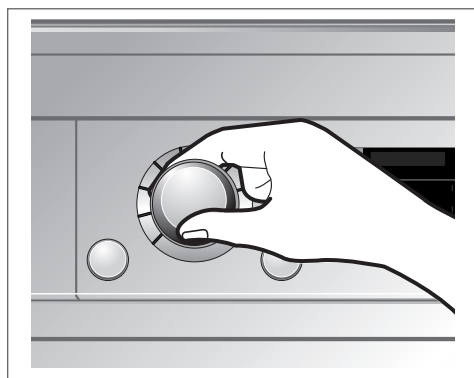

Select the desired cycle.

## 7. Press the Start/Pause button.

You can hear the drum turning.

## 8. After operation is completed, open the door and remove the laundry.

Be careful! Drum inside could be still hot. (Operation time varies depending on your cycle selection or options.)

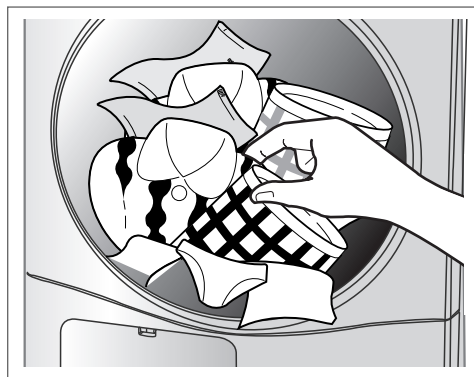

Take out the laundry.

## 9. Clean the lint filters and empty water container.

The lint filter should be cleaned after each load.

## 10. Turn off the Dryer.

Press the **Power** button.

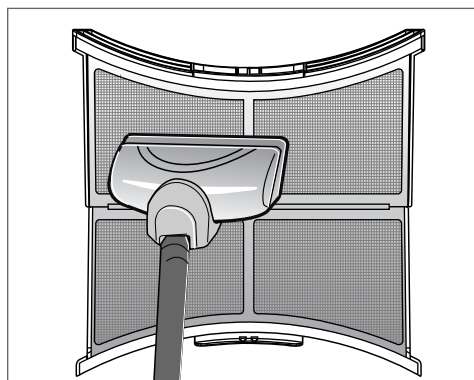

Clean the door lint filter.

## ⚠ CAUTION

- Be careful the filter is not torn or damaged when using a vacuum cleaner. If there is a little residue buildup on filter, you can scrub lint screen with a brush to remove.
- If you want to open the door while dryer is operating, please press the **Start/Pause** button first, wait until drum completely stops and then open the door.

# Additional Functions

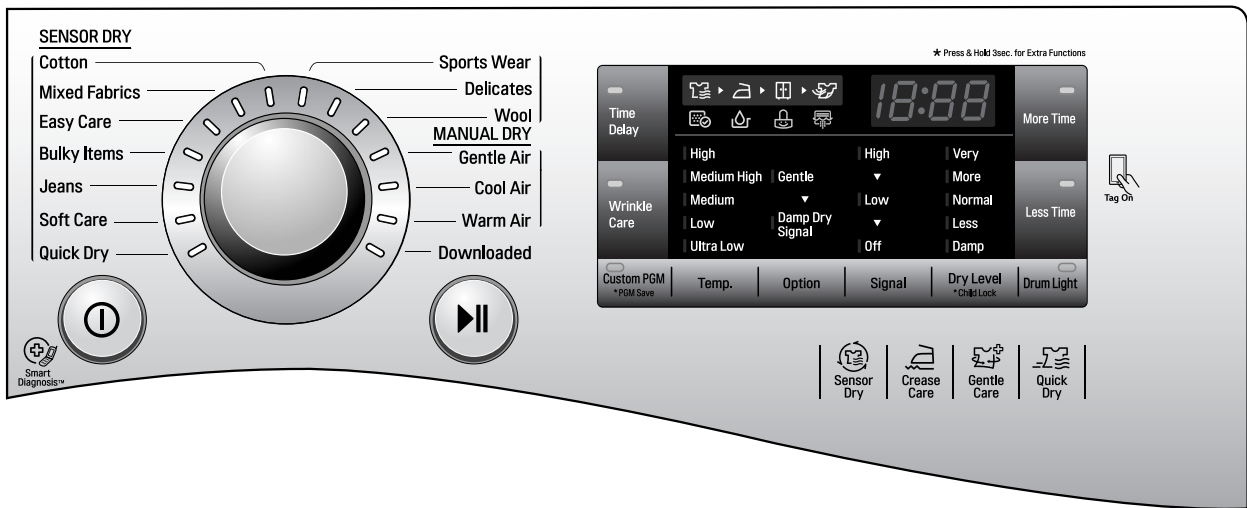

## Time Delay

The Time Delay feature allows you to have the dryer run at a time that is more convenient, for example when electricity rates are cheaper. The cycle can be delayed from 3 hours up to a maximum of 19 hours.

1. Load the dryer and close the door.
2. Press the **Power** button.
3. Select the desired cycle and options.
4. Press the **Time Delay** button until the desired delay time is displayed.
5. Press the **Start/Pause** button.

## Wrinkle Care (10:00)

Selecting this option will tumble the load periodically for a few seconds without heat. This will continue for up to 2 hours after the selected cycle, or until the door is opened. This prevents wrinkling of unremoved dry items until they can be removed.

### Note

If the door is opened during the drying portion of a cycle before Wrinkle Care has started, the cycle will not be cancelled and Wrinkle Care will begin as soon as the normal drying portion of the cycle is completed.

## Custom PGM

If you have a special combination of settings that you use frequently, you can save these settings as a Custom PGM.

### \* To Save a Custom PGM

1. Turn on the dryer.
2. Select a cycle.
3. Use the cycle modifier buttons to adjust the settings for that cycle.
4. Set any other desired cycle options.
5. Press and hold the **Custom PGM** button for 3 seconds. You will hear two beeps to confirm the settings have been stored.

### To Recall a Custom PGM

1. Press and release the **Custom PGM** button. The stored settings will be displayed.
2. Press and release the Cycle Selector Knob to start the cycle. The dryer will start automatically.

### Note

You can only save one Custom PGM program at a time. If you press and hold the Custom PGM button for 3 seconds, you will overwrite any previously stored Custom PGM settings. Once Custom PGM has been recalled, any of the memorized modifiers or options can be adjusted. However, if the Cycle Selector Knob is rotated, Custom PGM will be cancelled.

# Additional Functions

## More Time / Less Time

The **More Time** and **Less Time** buttons can be used to increase or decrease the dry time when MANUAL DRY cycles are selected. These buttons are disabled once the cycle is started.

### Note

These buttons are available only with MANUAL DRY, before you push Start/Pause button.

## Drum Light

Press the **Drum Light** button to turn on the drum light during dryer operation. This will allow you to more easily observe the load. The drum light will come on any time the door is opened.

## Temp.

Adjusts the temperature setting from Ultra Low to High. This allows precise care of your fabrics and garments.

- Press the **Temp.** button repeatedly to scroll through available settings.

## Options

### Gentle

- This function keeps the garments more moist than the standard Iron dry level.
- Cotton, Mixed Fabrics and Easy Care cycles.

### Damp Dry Signal

- This option causes the control to beep once the clothes have reached a "Damp Dry Signal" level. This can be used to alert you to remove articles that you don't want to over dry or that you want to have damp for easier ironing.
- Cotton, Mixed Fabrics and Easy Care cycles.

## Signal

Press the **Signal** button to adjust the volume of the signals from high to off.

## Child Lock( )

Use this option to prevent cycle settings from being changed while the dryer is operating. Press and hold the **Dry Level** button for 3 seconds to activate or deactivate the Child Lock function.

The lock icon will be shown in the display, and all controls are disabled.

# Additional Functions

- The Tag On function allows you to conveniently use the LG SmartDiagnosis™ and Cycle Download features to communicate with your appliance right from your own smart phone.
- To use the Tag On function:
  1. Download the LG Smart Laundry & DW App to your smart phone.
  2. Turn on the NFC (Near Field Communication) function in your smart phone.
- The Tag On function can only be used with most smart phones equipped with the NFC function and based on the Android operating system (OS).

## Turning on the NFC function of the smart phone



1. Enter the "Settings" menu of the smart phone and select "Share & Connect" under "WIRELESS & NETWORKS".

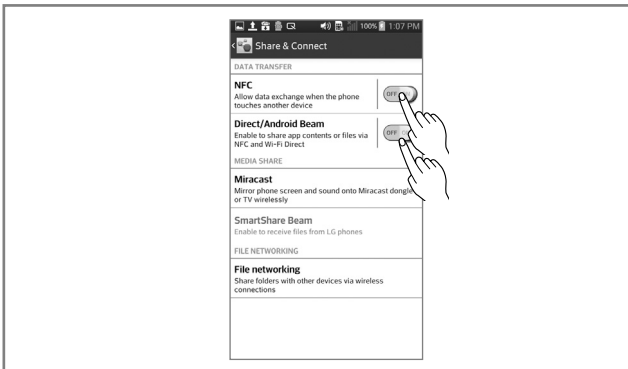

2. Set "NFC" and "Direct Android Beam" to ON and select "NFC".

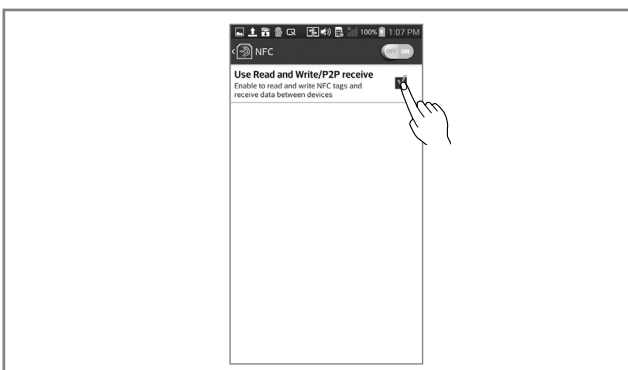

3. Check "Use Read and Write/P2P receive".

### Note

- Depending on the smart phone manufacturer and Android OS version, the NFC activation process may differ.
- Refer to the manual of your smart phone for details.

# Additional Functions

## The Tag On guide

### Tag On position

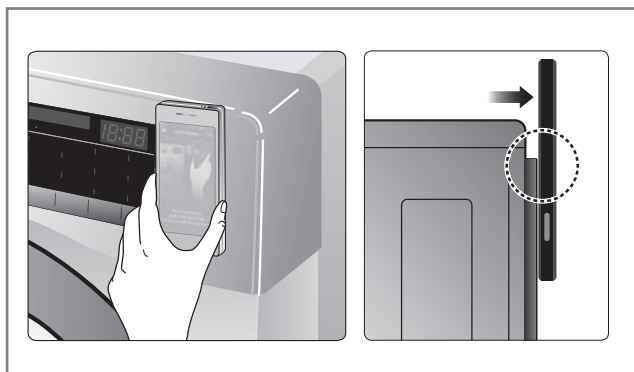
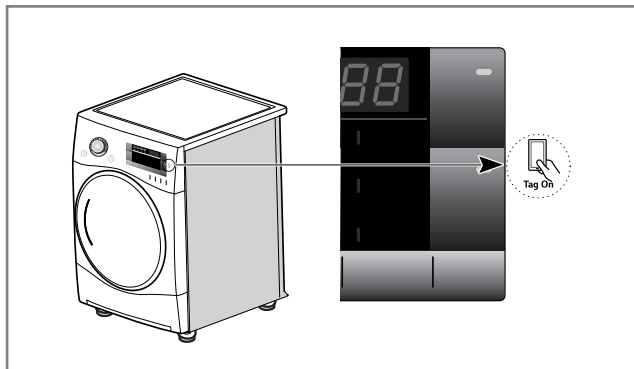

-  **Tag On:**  
Look for the Tag On icon next to the LED screen on the control panel.  
This is where you position your smart phone when using the Tag On function with the LG SmartDiagnosis™ and Cycle Download features of the LG Smart Laundry & DW App.
- When you use the Tag On function, position your smart phone so that the NFC antenna on the back of your smart phone matches the position of the Tag On icon on the appliance.  
If you do not know the position of your NFC antenna, move your smart phone very slightly in a circular motion until the application verifies the connection.

• Because of the characteristics of NFC, if the transmission distance is too far, or if there is a metal sticker or a thick case on the phone, transmission will not be good. In some cases, NFC-equipped phones may be unable to transmit successfully.

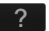
• Press  in the LG Smart Laundry & DW app for a more detailed guide on how to use the Tag On function.



# Caring For Your Dryer

## Clean lint filter

To maintain proper air flow and keep your dryer operating at peak efficiency, it is important to empty the lint filter between every load. If the Clean Filter () light comes on during a cycle and the beeper sounds, pause the dryer and empty the filter immediately.

1. Open the door.
2. Pull the filter out.

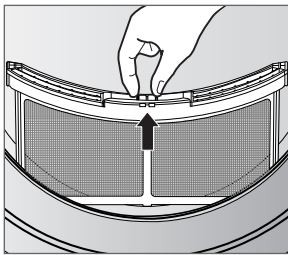

3. Open the filter and use your fingers to roll the lint off the screen surfaces. If the lint is difficult to remove or the filter material is showing signs of clogging, follow the cleaning instructions below.

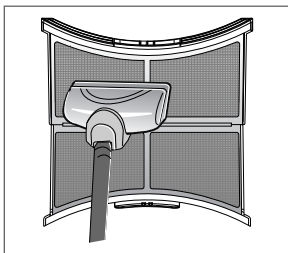

4. Snap the filter closed and replace it in the dryer.
  - Push the filter all the way down to avoid interference with the door

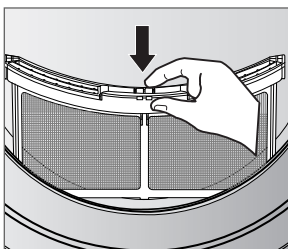

5. Close the door.

**Wash the lint screen in warm, soapy, water. Dry thoroughly and replace.**

## Clean lint filter during a cycle

If the Clean Filter () light flashes and the alarm sounds during operation, clean the filter promptly.

1. Press the **Power** button to stop the dryer. Then press it again to turn the dryer on.
2. Turn the Cycle Selector Knob to select the Cool Air cycle.
3. Press the **Start/Pause** button to start the dryer.
4. Let the Cool Air cycle run for 5 minutes to cool the dryer, then open the door and clean the lint filter.

### Note

**If the dryer is stopped in the middle of a cycle, the lint filter may be very hot. Failure to follow these cool down instructions could result in injury.**

## Empty water container

If your dryer is not connected to a household drain, then the water reservoir will capture the water from the drying process. This should be emptied every load. Failure to do so may result in poor drying performance.

If the container becomes full during a cycle, the Empty Water () light and alarm will be activated. In this case, the water reservoir should be emptied immediately, but in no case should it continue to be used for more than 1 hour.

1. Using the handle on the front of the drawer, pull out the reservoir.

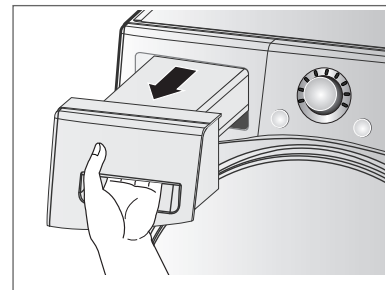

2. Using the handle on the front of the drawer, pull out the reservoir.

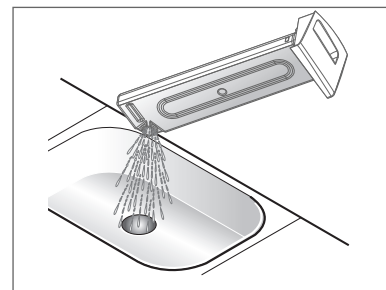

3. Drain the water into a sink.

4. Press the **Start/Pause** button to resume the cycle.



# Caring For Your Dryer

## Condenser

The condenser is a very important part of your dryer. This is where the moisture is removed from the air so there is no need for an outside exhaust. If the condenser is not properly maintained, it will greatly increase energy consumption and drying time. The condenser should be cleaned 3 or 4 times a year, or any time the Clean Condenser (  ) light blinks.

1. Push the tab and open the condenser cover.

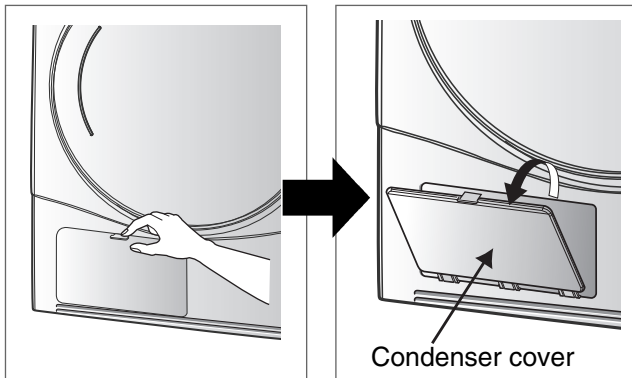

2. Unlock the inner plate by rotating the locking levers on either side of the plate. Then slide the plate out of the opening.

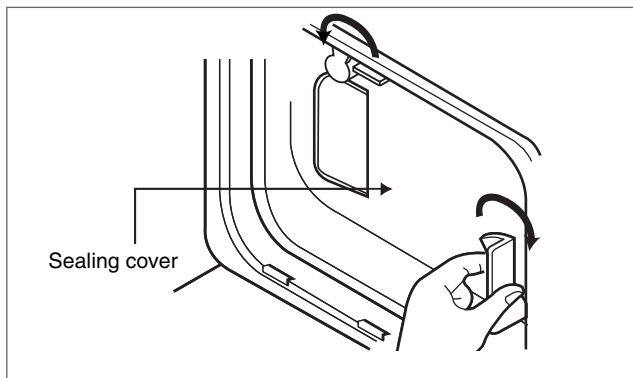

3. Carefully slide the condenser straight out of the housing using the finger ring at the center. Use care when handling the condenser to prevent damage that could reduce its efficiency.

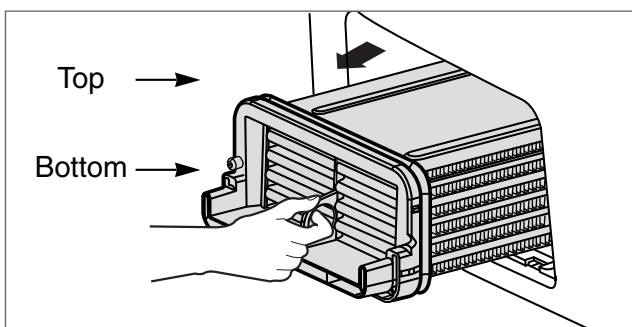

4. Thoroughly clean the condenser by running tap water through it from both the ends and the sides.

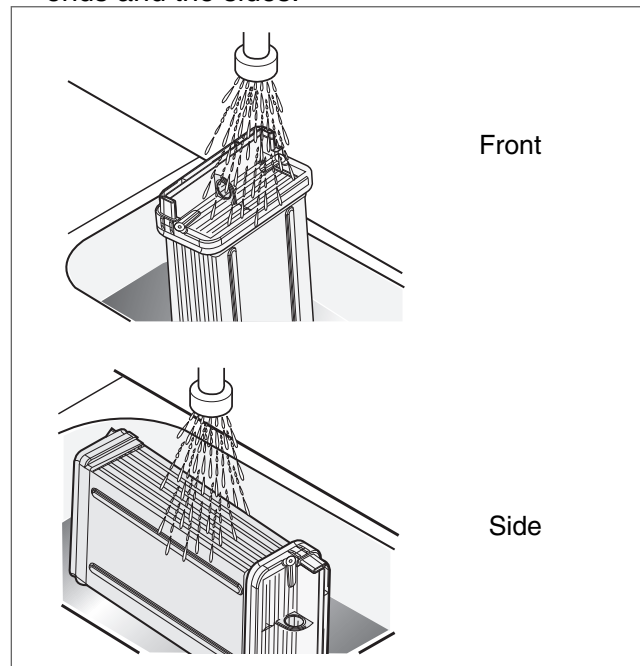

5. Slide the clean condenser into the housing. Make sure it is oriented as shown in the drawing in step 3.
6. Insert the inner plate into the opening in front of the condenser, then rotate the locking tabs to lock it in place. Then close the front cover.

## **CAUTION**

- NEVER operate the dryer without the condenser in place.
- Do not operate the dryer with a dirty or clogged condenser. Doing so will increase energy consumption and drying times.
- Handle the condenser with care. Do not use sharp or hard objects to clean the condenser as this could damage the condenser.
- Do not operate the dryer with a damaged condenser. Doing so could result in leaking which may result in property damage.

# Caring For Your Dryer

## ● Ventilation Grille and Cool Air Inlet Grille

Use a vacuum cleaner to clean the front ventilation grill and the cool air inlet in the back. Failure to remove any lint or dirt buildup will reduce air flow and increase energy consumption and drying times.

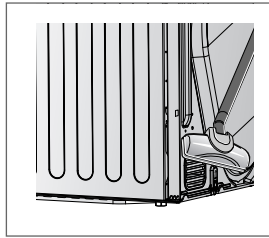
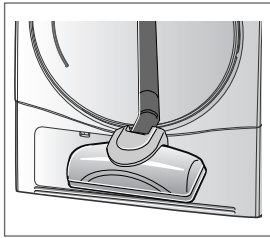

### Note

The warm air is exhausted through the ventilation grill.

## ● Condensed Water Drain

Condensed water is pumped to the reservoir which must be emptied every load. If a household drain is available, this water can be pumped down the drain so the reservoir is not used.

1. Slide the drain connection out the opening located on the back of the dryer on the right side as you face the rear of the dryer.

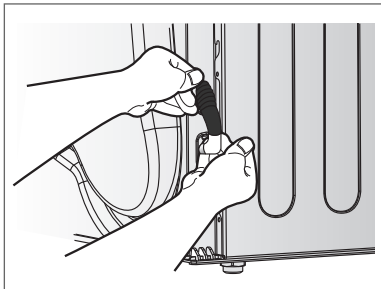

2. Disconnect the hose that goes up to the reservoir.

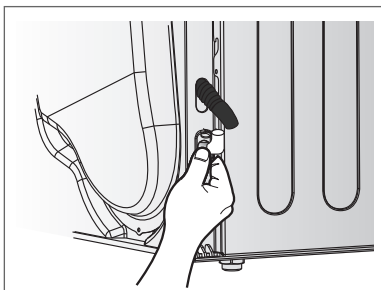

3. Connect the external drain hose included with the dryer. Route this hose to a permanent drain and secure the hose so it can not come loose.

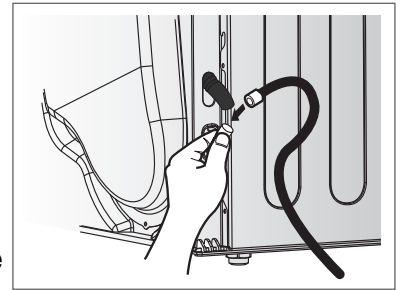

## ● Moisture Sensor

This sensor is used by the control to sense the moisture remaining in the clothes. If the sensor becomes dirty or coated the control will not be able to sense the moisture and the dryer will shut off before the clothes are dry.

Clean the sensor bars as shown below to maintain optimum performance of the SENSOR DRY cycles.

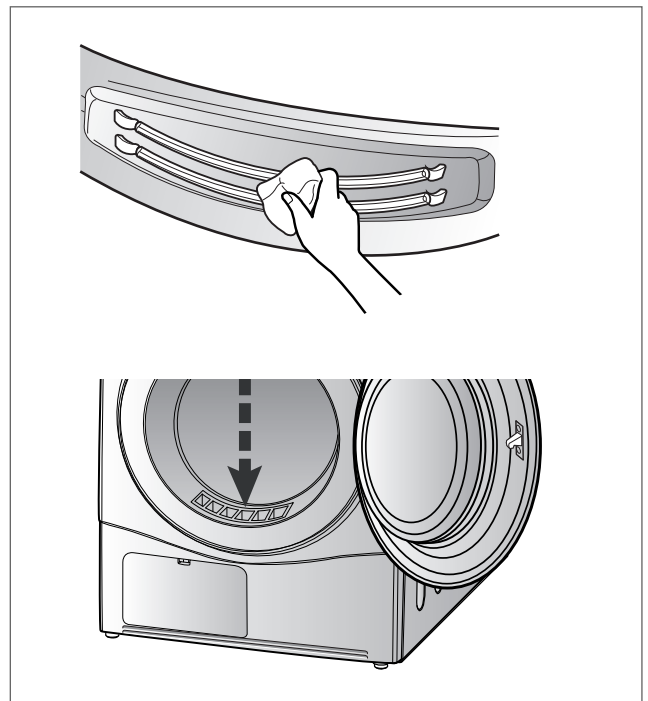

# Additional Tips For Smart Use

## Drying Guide

### Woolen Article

Dry woolens in wool cycle. Be sure to follow fabric care label symbols. Wool is not completely dried from the program so don't repeat drying. Pull woolens to their original shape and dry them flat.

### Woven and loopknit materials

Some woven and loopknit materials may shrink, depending on quality.

### Permanent Press and Synthetics

Do not overload your dryer.

Take out permanent press items as soon as the dryer stops to reduce wrinkles.

### Baby clothes and night gowns

Always check the manufacturer's instructions.

### Rubber and Plastics

Do not dry any items made from or containing rubber or plastics such as:

- a) Aprons, bibs and chair covers
- b) Curtains and table clothes
- c) Bathmats

### Fiber glass

Do not dry fiberglass articles in your dryer.















Glass particles left in the dryer could be picked up by your clothes the next time you use the dryer and irritate your skin.

### Fabric Care Labels

Sort and dry laundry according to care labels, size, and fabric type.

Do not overload the dryer. This will save energy and time and give the best drying performance.

*Below are fabric care labels.*

Symbols	Instructions
	Dry
	Tumble dry
	Permanent Press / Wrinkle resistant
	Gentle / Delicates
	Do not tumble dry
	Do not dry
	High heating
	Medium heating
	Low heating
	No heat / air
	Line Dry / hang to dry
	Drip dry
	Dry flat
	In the shade

# Additional Tips For Smart Use

## ● Spare Parts

Spare parts are covered under the terms of warranty. Components covered by warranty are provided free of charge. If coverage is expired, spare parts must be purchased from an authorized service center.

## ● Disposal of the dryer

To prevent possible injury to children, if you dispose of this dryer you must do so safely. Remove and dispose of the door, lid, and other protruding parts which could cause harm. Cut off the power cord to prevent future use. Follow local ordinances to dispose of the dryer safely.

## ● Service contact

If there is something wrong with your dryer, refer to the troubleshooting table.

If the trouble persists or you still have questions, please contact an authorized service center or call 1-800-243-0000.

You will need to provide the service center with the following information:

1. Your name, address, and ZIP code.
2. Your phone number.
3. Description of the problem.
4. The model number and serial number of your dryer.
5. The date of purchase.

## ● Accessory parts

Your dryer comes with accessories such as

### 1. Condensing drain hose

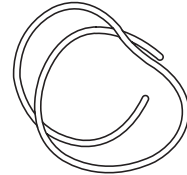

### 2. Hose holder

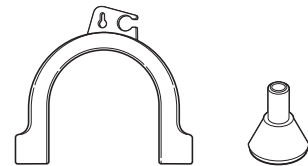

### 3. Stacking kit (2EA)

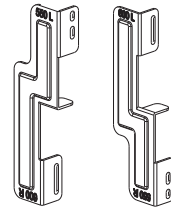

## ● Dryer Rack

Dryer Rack (Purchased Separately)

