

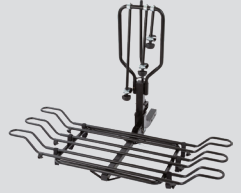

## Deluxe Hitch 3-Bike Rack Instructions for Part # BC-3581



### General Guidelines

- It is the user's responsibility to read and follow all instructions.
- Keep these instructions with the product at all times and review before each use.
- It is the responsibility of this product's owner to furnish the instructions to any person that borrows or purchases the product.
- Inspect the product before use to ensure it is assembled properly and all parts are in safe working order and free of defects.
- Never modify this product in any way.
- All circumstances cannot be addressed in these instructions. Please use common sense and practice general safety measures when using this product.
- Parts and/or instructions are subject to change without notice.

### Safety

- Not recommended for 1-1/4" trailer hitches
- Do not install on trailers or campers.
- The weight capacity of this carrier is 100 lbs.
- Make sure bike tires are away from the exhaust to avoid damage.
- During travel, periodically check all hardware and straps to ensure they are secured properly.
- Use caution when backing up, taking into consideration the extra length added to the vehicle.
- Drive carefully and use caution over speed bumps. Do not drive off-road with this carrier.
- Remove the carrier before entering an automatic car wash.

# Parts

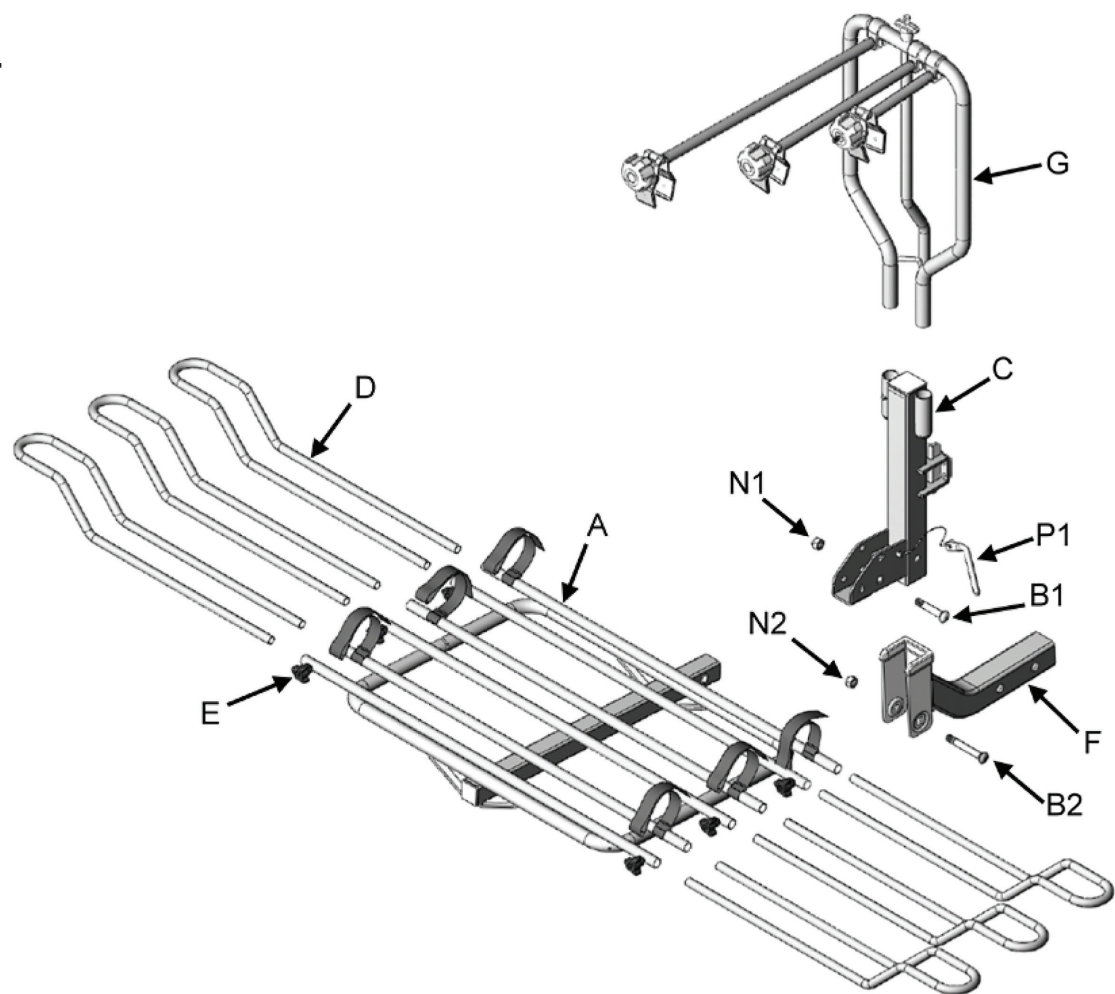

Part	Description	Quantity
A	Carrier Base	1
C	Main Tube	1
D	Wheel Holder	6
E	Adjustment Knobs	6
F	Hitch Mount	1
G	Clamp Assembly	1
H	Latch Release Hook (see pg. 3)	1

Part	Description	Quantity
I	Latch (see pg. 3)	1
J	Cable Screw (see pg. 3)	1
P1	Pin Lock	1
B1	Carriage Bolt M12x65	1
B2	Carriage Bolt M12x76	1
N1	Nut	1
N2	Nut	1

## Clamp Arm Parts

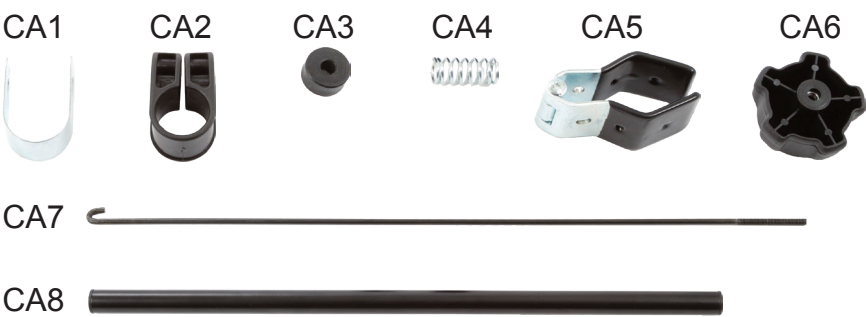

Part	Description	Quantity (per arm)
CA1	Metal Plate	1
CA2	Bracket	1
CA3	Rubber Stopper	1
CA4	Spring	1
CA5	Clamp	1
CA6	Turn Knob	1
CA7	Connector Rod	1
CA8	Main Tube	1

# Assembly

**Step 1.** Place the carrier base (A) into the main tube (C) and attach using the M12x65 carriage bolt (B1) and nut (N1). Tighten securely.

**Step 2.** Insert the pin lock (P1) into the hole on the main tube (C). Turn the pin to lock in position. ***For safety, the pin lock must be securely in place any time the carrier is in use.***

**Step 3.** Insert the six wheel holders (D) into the tubes on the carrier base (A). Tighten each piece using the adjustment knobs (E).

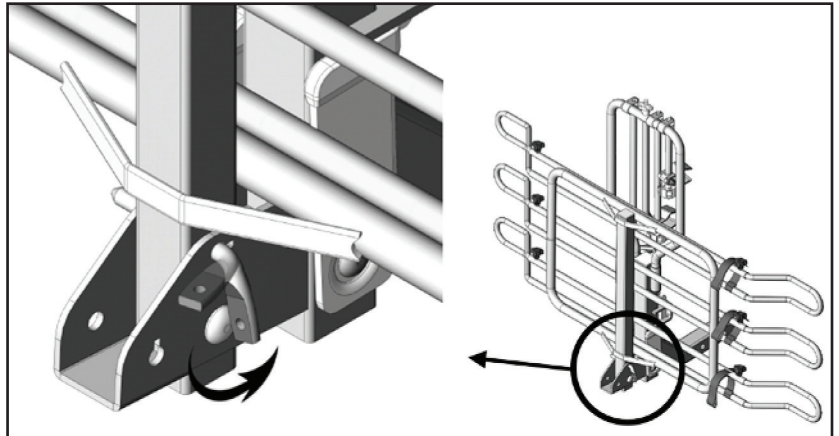

**Step 4.** Insert the assembled sections (A and C) into the hitch mount (F). Attach using the M12x76 carriage bolt (B2) and nut (N2).

**Step 5.** Slide the clamp assembly (G) into the main tube (C) by pressing the spring pin until it releases through the hole.

**Step 6.** Attach the hook (H) to the latch (I). Adjust the cable length as needed and tighten using the screw (J).

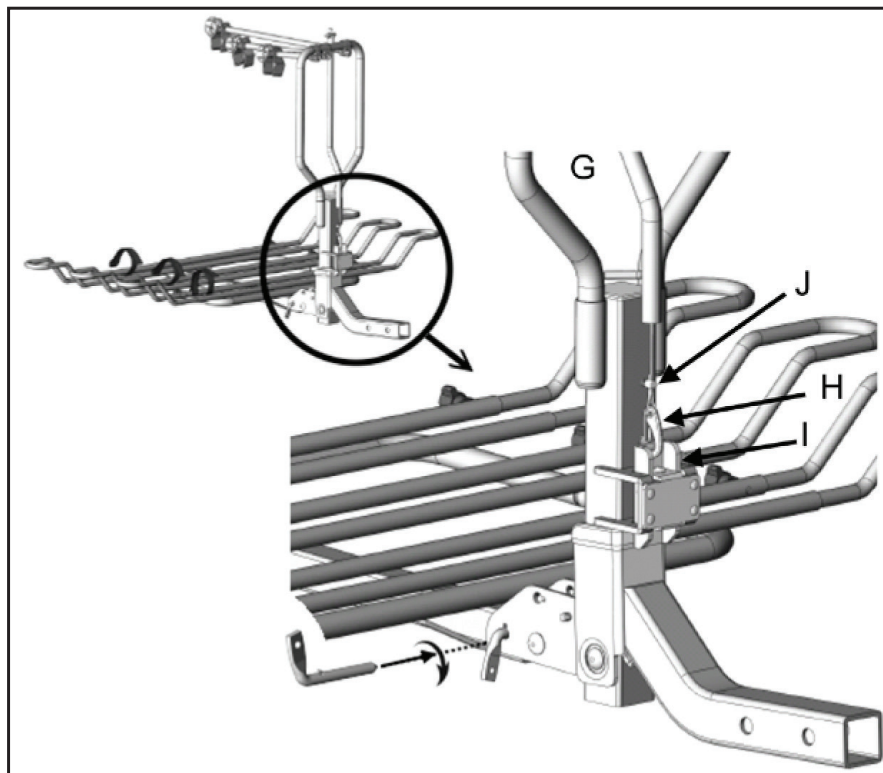

## Clamp Arm Assembly and Attachment

Clamp arms may need to be attached to the clamp assembly base (G).

**Step 1.** Disassemble each arm by unscrewing the turn knob (CA6) at the end of the arm. Carefully remove the parts by sliding them off the connector rod (CA7).

**Step 2.** Place the bracket (CA2) onto the clamp assembly base (G).

**Step 3.** Fit the metal plate (CA1) onto the bracket (CA2).

**Step 4.** Slide the connector rod (CA7) through the bracket (CA2) and metal plate (CA1) assembly.

**Step 5.** Fit the main tube (CA8) onto the connector rod (CA7).

**Step 6.** Slide the clamp (CA5) and spring (CA4) onto the connector rod (CA7). Slide one end of the clamp on first, then the spring, then the other end of the clamp so that the spring fits into the middle part of the clamp.

**Step 7.** Slide the rubber stopper (CA3) onto the connector rod (CA7).

**Step 8.** Screw the turn knob (CA6) onto the end of the connector rod (CA7).





# Use/Installation

This carrier is designed to fit into a standard 2"x2" hitch receiver.

**Step 1.** Slide the carrier into the hitch receiver.

**Step 2.** The hitch has two holes, A and B. Align the hitch receiver hole with the hitch pin hole that best suits your vehicle.

**Step 3.** Slide in a hitch pin (sold separately) and secure with its spring clip.

**Warning: Do not install on trailers or campers.**

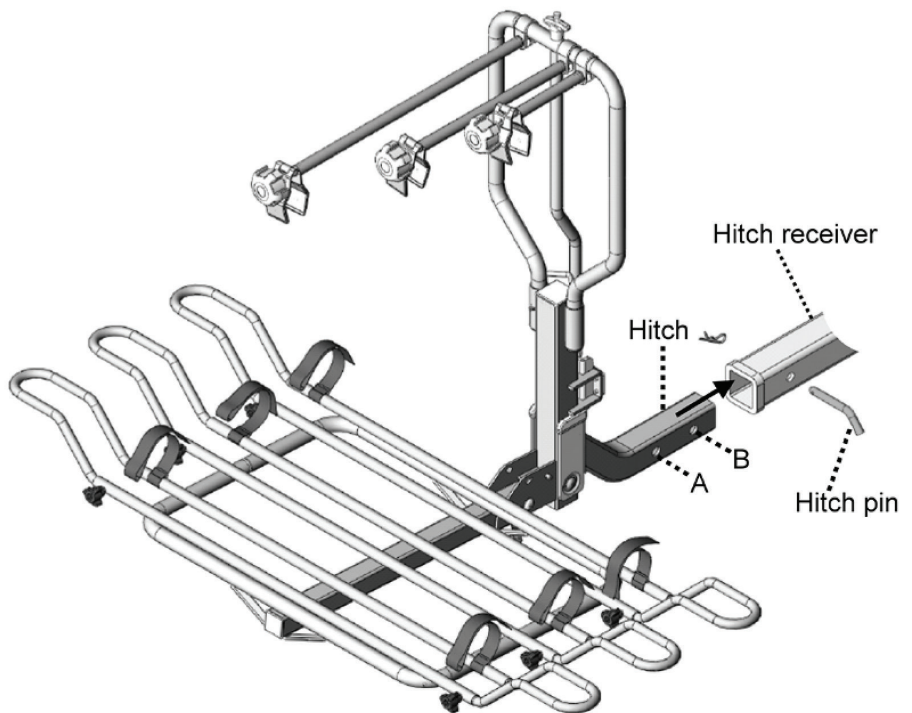

**Clamp Arms:** Adjust each clamp to fit your bike frame and tighten the knob securely.



**Tilt Down:** To tilt down the carrier, pull the top knob to release the stopper mechanism.



**Wheel Straps:** Fasten the bike wheels to the tray using the straps provided. Thread each strap around the bike tire and carrier, then through the strap buckle. Pull the strap so it is tight, then attach to the Velcro tab.



# Product Warranty and Liability

**GENERAL PRODUCT WARRANTY:** Products purchased from the Authorized Dealer (original place of purchase) or Merchant ("Dealer") will be free of defects in material and workmanship at the time of receipt, and will meet the specifications stated at the place of purchase transaction or online at the Dealer's website, under normal use and service when correctly installed, operated and maintained. This product warranty is effective for the period of time stated below, unless otherwise stated in the product instructions or depicted in the product advertisement. **All Authorized Dealer warranties are NON-TRANSFERABLE** and cover only the original end purchaser. This limited warranty does not cover products purchased through non-authorized dealers. Non-authorized dealer receipts are not accepted for warranty verification.

**\*\*\*Warranty claims must be made directly to the original place of purchase.\*\*\***

**WARRANTY PERIOD:** This warranty remains in force for one year from the date of the product's accepted delivery. The Authorized Dealer offers a one year manufacturer's warranty for most products unless otherwise specified on the product advertisement.

**WARRANTY SERVICE:** The Authorized Dealer will replace any defective or malfunctioning part at no charge, including payment of the shipping costs of parts or replacement product to and from the manufacturer. The purchaser is responsible for labor charges. If the product does not meet specifications as depicted in the advertisement, the Authorized Dealer will refund the full purchase price of the product.

Questions regarding the warranty on a specific product and warranty claims should be directed to the Authorized Dealer with whom the purchase transaction was made.

**WARRANTY LIMITATIONS:** The above warranty does not apply to products that are repaired, modified or altered by any party other than the Authorized Dealer; are subjected to unusual physical stress or conditions (such as overloaded ramps or corrosion), natural disaster, governmental actions, wars, strikes, labor disputes, riots, theft, vandalism, terrorism or any reason beyond reasonable control; are damaged due to improper installation, misuse, abuse, accident or negligence in use, storage, transportation or handling, or tampering; or to products that are considered consumable items or items requiring repair or replacement due to normal wear and tear.

Product should be inspected prior to signing for delivery. Product damage incurred during shipping, unless noted on the Bill of Lading at the time of delivery, renders this warranty void.

**LIMITED LIABILITY:** In no event shall THE AUTHORIZED DEALER be liable to the purchaser or any third party for any indirect, incidental, consequential, special, exemplary or punitive damages arising out of the use of the product, including, without limitation, property damage, loss of value of the product or any third party products that are used in or with the product, or loss of use of the product or any third party products that are used in or with the product.

