



Solar Step Lights

21060

Location of the Solar Panel

For best result, position the solar panel where it can get direct sunlight, and is free from cover and shade. (As shown in figure 1). The Solar Step Light should be left to charge for 2 sunny days before initial use

1

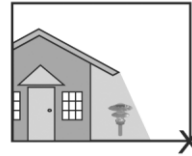
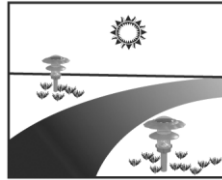

Operation

- 1) For normal operation, turn the switch to the "AUTO" position, this will automatically turn the unit ON at dusk (Shown in Figure 2)
- 2) The performance of the Solar Step Lights will vary during the time of year. The light will deliver more intensity when it has had a full day of sun rather than a day in cloudy or overcast weather.

Installation

- 1) Carefully remove all the fittings from the box
- 2) Find a suitable location for the Solar Step Lights, on a wall, step, or stairs..
- 3) Measure the width of two holes on the back of the Solar Step Light to align holes for 2 the screws on the surface.
- 4) If mounting on masonry, brick, or cement, use a drill for the holes insert wall plugs and fixing screws. Insert the wall plugs supplied so they are flush with the surface. Insert the screws and leave at least ¼", or 5 mm of the screws outside of the surface for holding the Solar Step Light.
- 5) Mount the Solar Step Light on the screws by placing the unit over the holes.

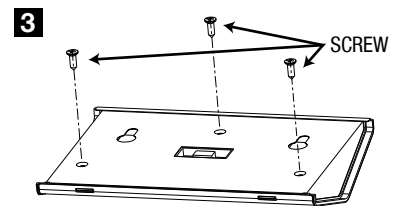
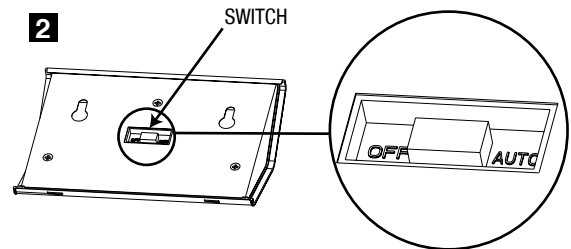

Replacing the Battery

- 1) Release the screws on the back of the unit and slide out the back cover part.(as shown in figure 3 and figure 4)
- 2) Remove the old battery. Make sure the new battery is high quality Ni-Mh AAA rechargeable battery.
- 3) Install the new battery in to the battery compartment, ensuring the correct polarity is observed.

Reassemble the unit by replacing the back cover. For best results Ni-Mh battery should be replaced every 12 months.

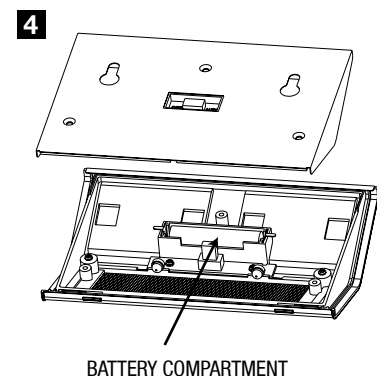

Trouble Shooting

If your Solar Step Light does not come on at dusk despite observance of all the instructions, please try the following steps:

- 1) Make sure the Solar Step Light is not being affected by any other light source, if this is the case move your Solar Step Light to a location where there is less light interference.
- 2) Make sure the Solar Step Light's solar panel is not located in the shade during the day.
- 3) Make sure the switch is in the AUTO position.
- 4) Check that battery is installed correctly.

Maintenance

Clean the solar module with a damp towel to insure optimum performance of the Solar Step Light. Do not use any type of solvent for cleaning and be careful not to put too much pressure on the module while cleaning.

Limited Warranty Proof of Purchase is Required (Receipt) Nature Power warrants our products to the original purchaser that this product is free from defects in materials and workmanship for the period of one year from date of purchase.

Please contact Nature Power Products to acquire more information or technical support:

1-800-588-0590

info@naturepowerproducts.com

www.naturepowerproducts.com