



Instruction Manual

Item# FT973622



Having Trouble?

Chat with us on your phone

Simply point your phone camera towards the QR code or see our website



xbrand.us

or email at

customerservice@ecintel.com

Monday - Friday 7:00AM - 3:30PM PST

Two Tier Waterfall Fountain



Have Questions or Issues? Need help with assembly?

Contact us and we will resolve immediately.

Simply point your phone camera towards the QR code or see our website

Support Hours M-F 7:00AM - 3:30PM (U.S Pacific Time)



Chat with us:
xbrand.us



Email:
customerservice@ecintel.com



Call:
951-319-4433

Purchased your product online?

We would really appreciate it if you can share your experience with others by reviewing our product on the website from which you purchased.



Limited 1-Year Manufacturer Warranty on xbrand.us

Manufacturer warranty covers:

- Parts that are deemed defective within 30 days will be shipped free of charge.
- Any warranty claim after 30 days, will require shipping to be paid by the customer.

Any visible damage due to the neglect, misuse, or abuse will void the limited warranty of the product.

For further information, please contact us:

Chat with us: xbrand.us



Simply point your phone camera towards the QR code or see our website

Email: customerservice@ecintel.com

Purchased your product online?

We would really appreciate it if you can share your experience with others by reviewing our product on the website from which you purchased.



Please use your smart phone camera to scan the QR code.
Simply point your camera and let the camera scan the
code below, and click on the link that opens up.

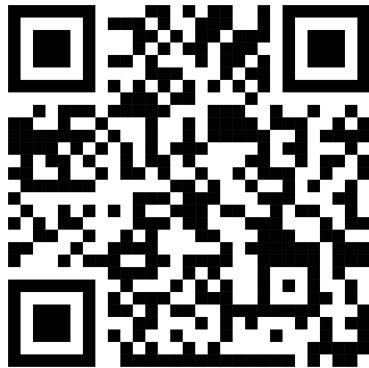

<https://xbrand.us/product/brown-painted-freestanding-waterfall-fountain-ft973622/>

Contents 2

What is included 3

Assembly instructions 4

YouTube video instruction 5

Warranty 6

What is included



A. Fountain Top



B. Small tier front and back



C. Top pedestal and pump access door



D. Splash guard



E. Large tier top view, side view, and bottom view



F. Pedestal base



G. Auto shut off pump with AC adapter



H. LED lights

Assembly instructions

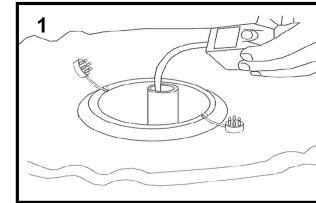

1 Insert water pump cable through the opening

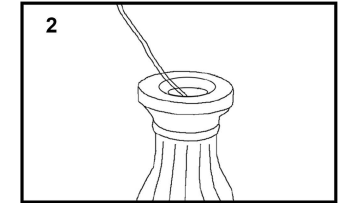

2 Insert pump cable through the pedestal base

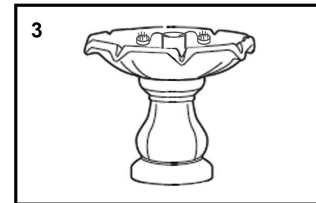

3 Connect part B to part C and connect two LED lights to small tier, and insert cables through the opening

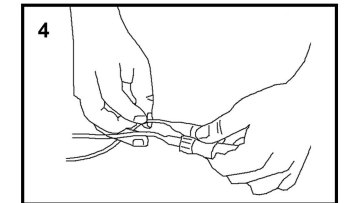

4 Connect 4 LED light connections to pump connections

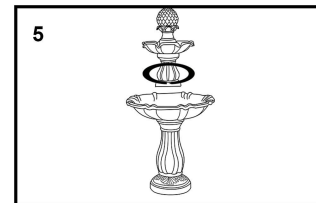

5 Connect Hose to pump and lay pump flat in the section cup

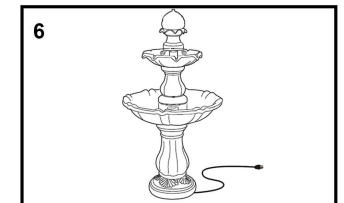

6 Make sure all parts are secured and locked



https://www.youtube.com/watch?v=3_EyI6X-Qoc

Auto Shut Off Pump