

**INSTALLATION INSTRUCTIONS**

**WARNINGS AND CAUTIONS:**

- To be installed and/or used in accordance with appropriate electrical codes and regulations.
- If you are unsure about any part of these instructions, consult a qualified electrician.
- To avoid overheating and possible damage to this device and other equipment, do not install to control a receptacle, fluorescent lighting, a motor- or a transformer-operated appliance other than appropriate ceiling fans.
- To reduce the risk of fire or electrical shock, this control is to be used with ceiling fans that are rated 120VAC, total load 1.5 amperes maximum.

**WARNINGS AND CAUTIONS:**

- For use on ceiling paddle fans with split-capacitor or shaded pole motors only. Please refer to manufacture's instructions or rating label on the motor to confirm type. Use with any other types of motors or equipment may cause overheating and/or damage to the motors or equipment.
- Disconnect power at circuit breaker or fuse when servicing fixture.
- Use this device only with copper or copper clad wire. With aluminum wire use only devices marked CO/ALR or CU/AL.

**Tools needed to install your Fan Speed Control:**

- |                              |                 |
|------------------------------|-----------------|
| Slotted/Phillips Screwdriver | Electrical Tape |
| Pliers                       | Pencil          |
| Cutters                      | Ruler           |

**Color Change Option:**

If a color change kit is provided with your device, proceed with the following step if you need to change the color. Otherwise, proceed with the "Installing Fan Speed Control by itself or with other devices" section.

**CHANGING THE COLOR OF YOUR FAN SPEED CONTROL**

Your Fan Speed Control includes two color options. The Control ships with the White frame attached. To change color of frame, proceed as follows:

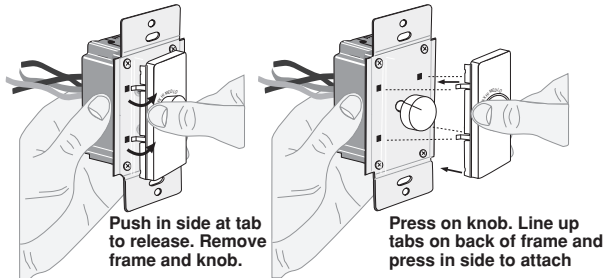

**Installing Fan Speed Control by itself or with other devices**

If installing Control in a single device application, proceed with the **MULTI-FAN CONTROL** section. If installing Control in a multi-device application, proceed as follows:

**MULTI-DEVICE APPLICATION**

**NOTE:** There is NO derating necessary for multi-gang installations of this Fan Speed Control.

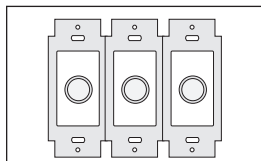

**MULTI-FAN CONTROL**

Any number of fans of the same type may be controlled by a single fan speed control provided that the total amperage of the fans do not exceed the amperage of the fan speed control.

**INSTALLING YOUR FAN SPEED CONTROL**

**NOTE:** Use check boxes  when Steps are completed.

**Step 1 WARNING:** To avoid fire, shock, or death; **TURN OFF POWER** at circuit breaker or fuse and test that power is off before wiring!

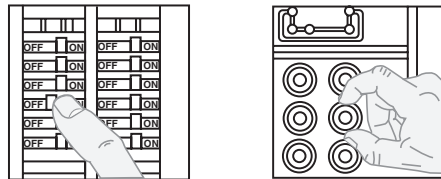

**Step 2 Removing existing switch:** Remove existing wallplate and switch mounting screws. Carefully pull switch from wall box. **DO NOT** remove wires attached to the switch at this time.



**Step 3 Identifying your wiring application (most common):**



**NOTE:** If the wiring in the wall box does not resemble this single pole configuration, consult a qualified electrician.

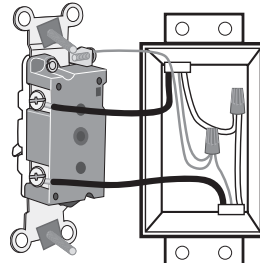

**Single-Pole:**

Look at the back of your switch. There should be 2 wires connected to two screw terminals (not including a green or bare copper wire used for grounding), you have a Single-Pole switch.

**Step 4 Disconnecting switch wires and preparing wires:**

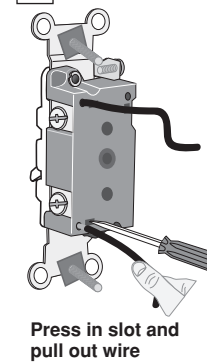

- Disconnect wires from screw terminals or Quickwire™ slots (shown).
- Pull off pre-cut insulation from Control leads.
- Make sure that the ends of the wires from the wall box are **straight (cut if necessary)**.
- Remove 5/8" (1.6 cm) of insulation from each wire in the wall box (shown).

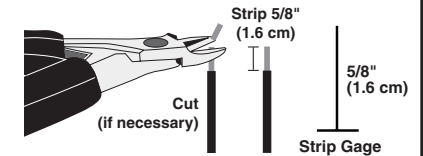

**Step 5 Single-Pole Wiring Application:**

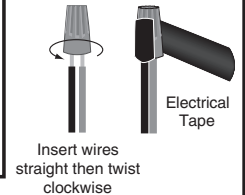
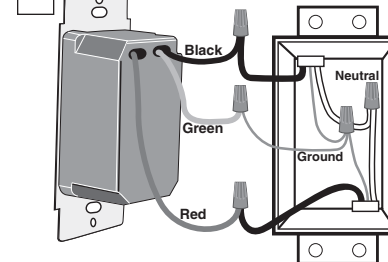

**Step 5** Single-Pole Wiring Application:  
con't

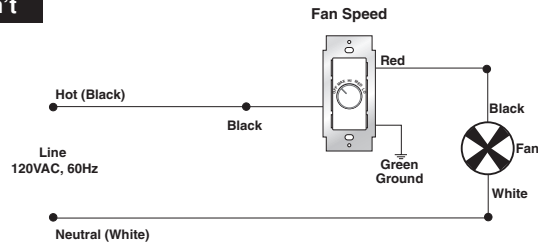

Connect wires per **WIRING DIAGRAM** as follows:  
Screw wire nuts on clockwise making sure no bare conductors show below the wire connectors. Secure each connector with electrical tape.

- Green control Ground lead to Green or bare copper wire in wall box.
- Black control lead to Line (Hot) wall box wire removed from old switch.
- Red control lead to remaining wall box wire.
- **Proceed to Step 6.**

**Step 6** Testing your Fan Speed Control prior to mounting in wall box:

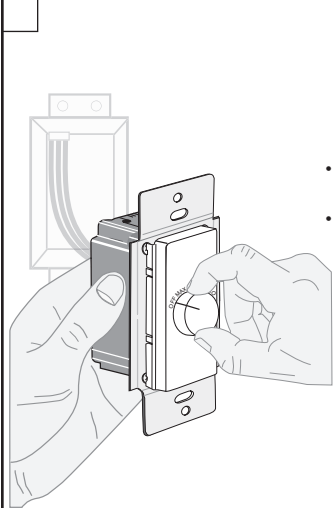

- Restore power at circuit breaker or fuse.
  - Carefully holding control as shown, rotate knob to the MAX position. Fan should turn ON to highest level. Rotate knob to the remaining levels: HI, MED, and LO. Fan speed should change accordingly.
- If fan does not turn ON, refer to the TROUBLESHOOTING section.**

**Step 7** Fan Speed Control Mounting:

**TURN OFF POWER AT CIRCUIT BREAKER OR FUSE.**

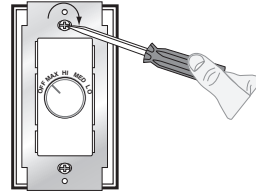

Installation may now be completed by carefully positioning all wires to provide room in wall box for control. Mount control into box with mounting screws supplied. Attach wallplate.

**Step 8** Restore Power: Restore power at circuit breaker or fuse. **Installation is complete.**

**Step 9** OPERATION

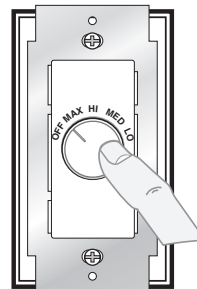

**ON**  
Rotate bottom control knob to one of the four levels: MAX, HI, MED, and LO  
– Fan will increase or decrease in speed respectively for desired level.

**OFF**  
Rotate bottom control knob fully counter-clockwise to the OFF position – Fan will turn OFF.

**TROUBLESHOOTING**

- Fan does not turn ON or does not run Multi-speed
  - Circuit breaker or fuse has tripped.
  - Fan Neutral connection is not wired.
  - Fan has burned out.

**For non-standard wiring applications, refer to Wire Nut and Conductor Size Chart**

WIRE NUT / # OF CONDUCTOR COMBINATION CHART	
1- #12 w/ 1 to 3 #14, #16 or #18	
2- #12 w/ 1 or 2 #16 or #18	
1- #14 w/ 1 to 4 #16 or #18	
2- #14 w/ 1 to 3 #16 or #18	

**PRODUCT INFORMATION**

- For technical assistance, contact us at **1-800-824-3005**.
- Visit our website at [www.leviton.com](http://www.leviton.com).

2008 © Leviton Mfg. Co., Inc.

DI-000-RTF01-02C

**LIMITED 5 YEAR WARRANTY AND EXCLUSIONS**

Leviton warrants to the original consumer purchaser and not for the benefit of anyone else that this product at the time of its sale by Leviton is free of defects in materials and workmanship under normal and proper use for five years from the purchase date. Leviton's only obligation is to correct such defects by repair or replacement, at its option, if within such five year period the product is returned prepaid, with proof of purchase date, and a description of the problem to **Leviton Manufacturing Co., Inc., Att: Quality Assurance Department, 59-25 Little Neck Parkway, Little Neck, New York 11362-2591**. This warranty excludes and there is disclaimed liability for labor for removal of this product or reinstallation. This warranty is void if this product is installed improperly or in an improper environment, overloaded, misused, opened, abused, or altered in any manner, or is not used under normal operating conditions or not in accordance with any labels or instructions. There are no other or implied warranties of any kind, including merchantability and fitness for a particular purpose, but if any implied warranty is required by the applicable jurisdiction, the duration of any such implied warranty, including merchantability and fitness for a particular purpose, is limited to five years. Leviton is not liable for incidental, indirect, special, or consequential damages, including without limitation, damage to, or loss of use of, any equipment, lost sales or profits or delay or failure to perform this warranty obligation. The remedies provided herein are the exclusive remedies under this warranty, whether based on contract, tort or otherwise.