

CAUTION

To reduce the risk of injury to persons, malfunction, or damage to the product or property when using the appliance, follow basic safety precautions, including the following:

INSTALLATION

- **Use this appliance only for its intended purpose.**
This product is not designed for preserving precision instruments, tableware or art works.
- **Use the appliance only in a well-ventilated area.**
Keep the area well ventilated, especially if also using a combustion appliance. Inadequate ventilation reduces the oxygen level in the air.
- **Never unplug the appliance by pulling on the power cord. Always grip the plug firmly and pull straight out from the outlet.**
- **Do not use the product in places where chemicals are used.**
Chemicals and solvents dissolved in the air in places such as hospitals, factories, laboratories and hair salons could cause product deformation and leaking, resulting in property damage.
- **Turn off the dehumidifier and pull out the power plug before cleaning.**
Wait for the fan to stop moving.
- **Do not operate the dehumidifier without a filter.**
Using the product without a filter could result in a reduced product lifespan, electric shock or injury.

OPERATION

- Do not use the product for preserving animals/plants, precision instruments, art works etc.
- Do not place vases or water jars on the dehumidifier.
- Turn off the dehumidifier and empty the water bucket before moving the dehumidifier.
- Pull out the power plug if you will not be using the product for an extended period.
- **Do not use the product in a very small space such as a closet.**
Poor ventilation could result in overheating or fire.
- **Do not use wax, thinner or a strong detergent when cleaning. Wipe the product using a soft cloth.**
Using inappropriate cleaning products could cause the product to become discolored or develop surface flaws.
- Do not use the product in direct sunlight or rain.
- Do not touch the product with wet hands.
- Position the product on a firm, stable surface.
- Remove cable ties and extend power cord before use.
- Do not spray foreign substances or water on the product.

PRODUCT OVERVIEW

Front

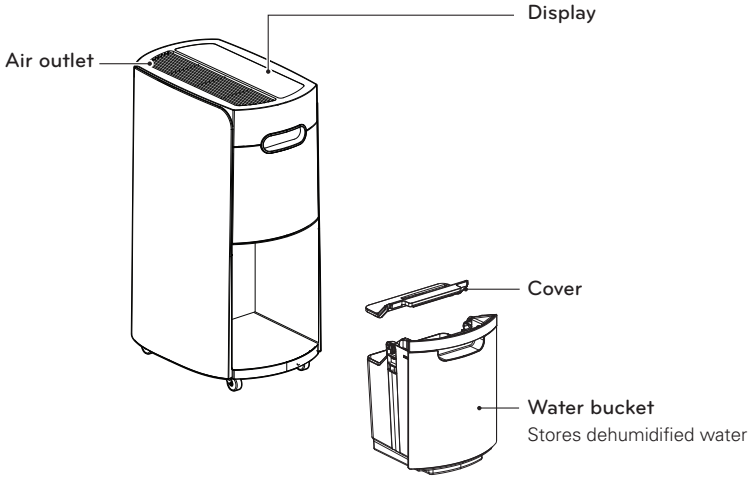

Back

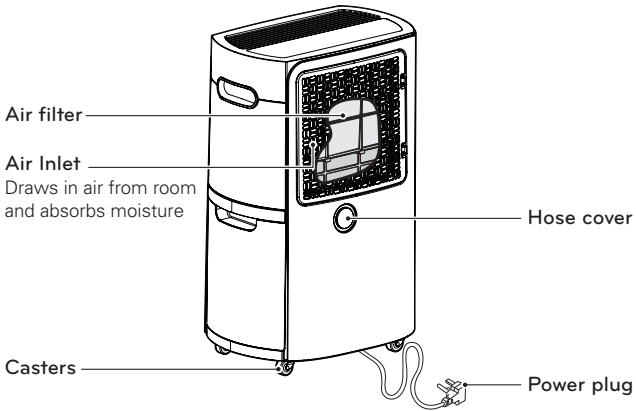

Power cord and plug may differ depending on the country where the product is purchased.

BEFORE USE

Indoor temperature and relative humidity affect dehumidification.

- Dehumidification is decreased if the temperature or relative humidity is low.
- The product does not operate unless the desired humidity level is lower than the current humidity level.

This product operates at temperatures from 41 ° F - 90 ° F (5 ° C - 32 ° C).

- At temperatures of 32 ° F (0 ° C) or less, water freezes inside the product.
- At temperatures over 90 ° F (32 ° C), the internal temperature of the product trips a protective device which deactivates the product to avoid product damage.

When the dehumidifier is operating, the indoor temperature will rise.

- The dehumidifier does not have a cooling/heating function.
- Heat is generated during operation, so the room temperature may be increased by about 37 ° F (3 ° C) depending on the usage conditions (indoor temperature, size of the room).

The compressor has a 3-minute delay before restarting.

- If the product is stopped and immediately restarted, to protect the compressor there is a 3-minute delay until the compressor restarts.

The product cannot be operated continuously for more than 23 hours.

After 23 hours of continuous operation, the compressor automatically shuts off for one hour to prevent product damage. The compressor will restart after one hour. This Safety Standby function is normal.

Install the product at least 11¹³/₁₆" (30 cm) from walls or other obstacles.

The product needs clearance for air intake and exhaust purposes.

There may be water in the drain water bucket before first use.

Water may remain in the drain water bucket from the product's outgoing inspection to check operation. This is normal.



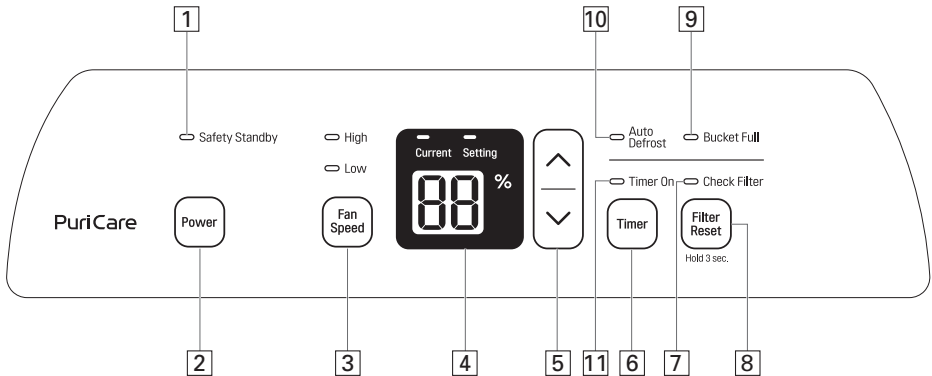

OPERATION

Control Panel and Display



1	Safety Standby light (red)	After 23 hours of continuous operation, the red lamp lights up for 1 hour.
2	Power button	Starts and stops the product.
3	Fan Speed control button	Adjusts the fan speed and air volume.
4	Humidity display	Displays the current humidity (25-90%) and the humidity setting (30-80%).
5	Humidity control button	Adjusts the humidity setting. Desired humidity levels can be set in 5-percent increments from 30-80%.
6	Timer button	Sets a time for the product to automatically turn off. Press the button repeatedly to increase the time until shutoff in 1-hour increments up to 12 hours.
7	Check Filter light	Lights up after 350 hours of operation. Check and clean the filter.
8	Filter Reset button	After cleaning the filter, press for three seconds to reset operating time.
9	Bucket Full light	Lights up when drain water bucket is full.
10	Auto Defrost light	Lights up when the product is defrosting.
11	Timer On light	Lights up when the Timer function is set.

Dehumidifying



- 1 Press  to turn on the power.
 - It takes 30 minutes of continuous operation to reach the desired humidity level the first time the product is used.
 - The display shows the current humidity level.
- 2 Press  /  to change humidity.
 - The desired humidity level can be set in 5-percent increments from 30-80%.
 - The display shows the desired humidity level while it is being set, then reverts to the current humidity level after 5 seconds.
 - The current humidity level is displayed in 5-percent increments from 25-90%. If the humidity level is outside the range, the display continues to show either 25% or 90%.
- 3 Press  to change the fan speed.

The fan speed has two levels: low or high.
- 4 Press  to turn off the product.

! NOTE

- If the product is restarted immediately after being shut down, to protect the compressor there is a 3-minute delay until the compressor begins operating.
- It is normal for the compressor to cause the product to vibrate while starting or stopping.

Setting the Timer

- 1 Press  to turn on the power.
- 2 Press  to set the automatic shut off time.
 - Press the button repeatedly to increase the time until shut off in 1-hour increments up to 12 hours.
- 3 Press  to cancel the Timer function.
 - Press the Timer button repeatedly until the Timer light turns off.

! NOTE

Empty the drain water bucket before setting the Timer function.

If the water bucket becomes full during the Timer function, the Bucket Full light goes on and dehumidification stops.

Safety Standby Light

- After 23 hours of continuous operation, the red Safety Standby light turns on for one hour and the fan and compressor shut off to prevent product malfunction.
- After an hour with the fan and compressor shut off, the Safety Standby light turns off and the fan and compressor automatically restart.

Bucket Full Light

- Empty the water bucket within three minutes of the Bucket Full light turning on.
- After the light turns on, the fan operates for an additional three minutes to remove remaining condensed water and then the product shuts off.
- See Emptying the Water Bucket for further instructions.

Checking the Filter

Check and clean the filter when the Check Filter light turns on.

- 1 After 350 hours of operation, the Check Filter light turns on. Check the filter and clean it if necessary or wait 24 hours for the light to go off automatically.
- 2 After cleaning the filter, press and hold  for three seconds to reset the operating time.

Auto Defrosting

The Auto Defrost function automatically removes any frost in the heat exchanger caused by low indoor temperatures.

- The Auto Defrost light turns on while the product automatically defrosts the heat exchanger.
- The compressor stops during the automatic defrost function.

 Auto Defrost

Continuous Drainage Setup

Items Needed:
3/4" (outer diameter) threaded garden hose nearby sink or drain.

- 1 Unplug the product. Turn the hose cover at the back of the product counterclockwise to open it.
- 2 Remove the water bucket.

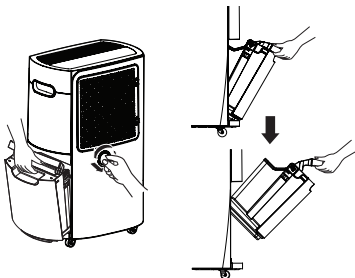

- 3 Insert the garden hose in the drain hole at the rear of the case.

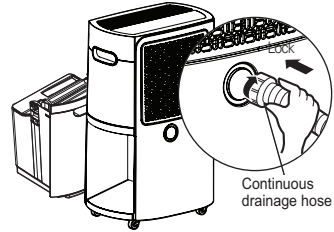

- 4 Turn the end of the garden hose clockwise to attach it to the male connection behind the water bucket. Firmly attach the hose to avoid leaks. Hand tighten; then make an additional 1/8 turn with pliers.

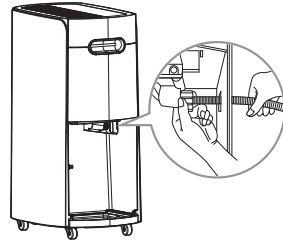

CAUTION

Take care not to injure hands while connecting drainage hose.

- 5 Reinstall the water bucket.

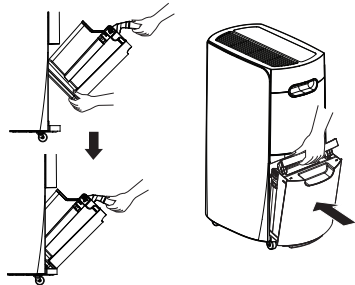

NOTE

- The product does not work without the water bucket installed.
- A hose for continuous drainage can be purchased through the LG customer information center.

Emptying the Water Bucket

- 1 Gently pull the top handle of the water bucket to remove the bucket from the product.

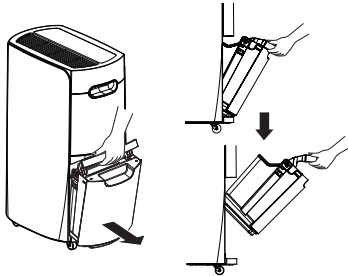

- 2 Lift off the cover of the water bucket.

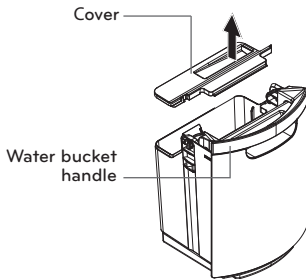

- 3 Pour out the water inside the water bucket.

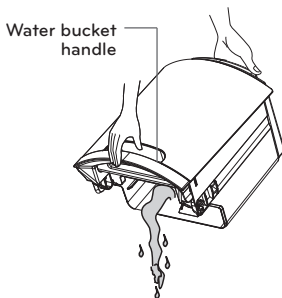

- 4 Put the cover back on the water bucket.

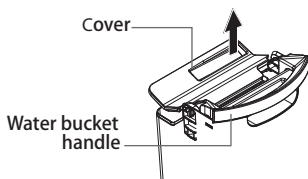

- 5 Angle the bottom of the water bucket into place first, then push the top into place.

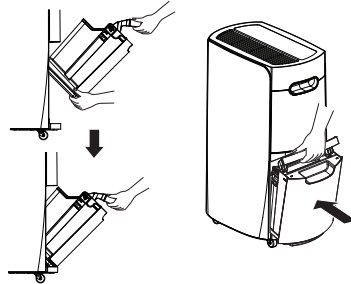

! NOTE

- If the water bucket is removed immediately after turning off the dehumidifier, the water remaining in the heat exchanger may drip inside the water bucket storage area. Remove the water with a soft cloth.
- While cleaning, do not touch the water detection device on the inside top of the water bucket storage area.
- Clean the water bucket once a week during use.
- If the ambient temperature is low, there is less moisture in the air for the product to remove.
- Unplug the product before removing the water bucket. If the bucket is removed while the product is operating, the compressor stops. The fan operates for another three minutes to clear the remaining water inside the heat exchanger and then also stops.

! CAUTION

Watch pinch points to avoid injuring fingers when installing the water bucket.

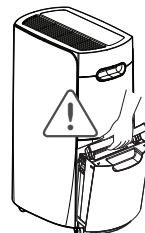

MAINTENANCE

Cleaning the Exterior

Wipe the exterior of the dehumidifier with a soft, damp cloth.

- Do not spray water directly on the product. Doing so may cause damage to the insulation or stains on the surface of the product.

Use a vacuum cleaner or soft brush to remove dust from the filter case.

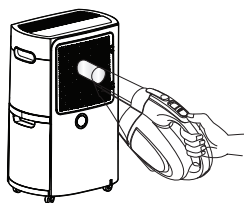

! CAUTION

Do not use materials such as thinners, benzene, acid, or sponges to clean the product. They may damage the surface of the product.

Cleaning the Water Bucket

1 Lift off the cover of the bucket.

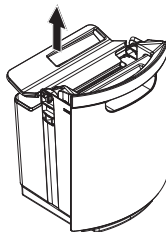

2 Empty the water bucket and use a soft cloth to remove any remaining moisture inside it.

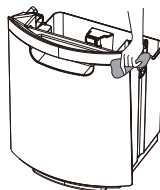

! CAUTION

Operating the product with the cover of the water bucket missing or assembled improperly may result in leaking.

Cleaning the Air Filter

CAUTION

- Unplug the unit before cleaning it.
- Allow the filter to dry completely, out of direct sunlight, before reinserting it in the product. Operating the product with a damp filter may cause product failure.

- 1 Release the two hooks at the right of the filter case and swing it open to remove it.

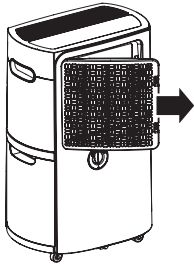
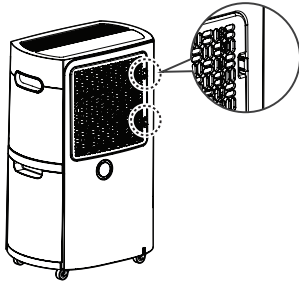

- 2 Pull the center tab on the air filter to remove it from the filter case.

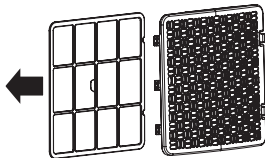

- 3 Clean the air filter with a vacuum cleaner or soft brush.

- If the filter is very dirty, wash it in water and a neutral detergent.
- Clean the air filter once a month.

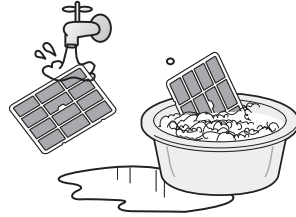

- 4 Bend the sides of the air filter inward slightly to reinsert it. Make sure the filter is seated under the tabs inside the filter case.

- 5 Align the hinges on the filter case with the hinge openings on the product and then swing the case to the right to reattach the two hooks.

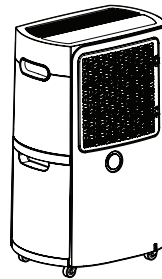

NOTE

Service calls to clean the air filter are not covered under the product warranty.

Storing the Product

1 Unplug the product.

2 Empty the water bucket completely.

- Remove the lid from the water bucket and use a soft cloth to wipe up any remaining water in the bucket.

3 Clean the filter.

- Let the filter thoroughly dry for several hours in a shaded, well-ventilated area before reinstalling it.
- Placing the filter in direct sunlight or near a fire may cause product deformation.

4 While the filter is drying, place the dehumidifier out of direct sunlight in a well-ventilated area and allow it to thoroughly dry for several hours. Reinstall the filter and cover the dehumidifier before storing it in an upright position.

(A dust cover for storing the dehumidifier is not included.)

