

Item # 1002 800 012
Model # 9235969

EVERBILT

Use and Care Guide
Single-Touch Latch
with Strike

TOOLS REQUIRED

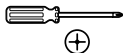

Phillips screwdriver

PACKAGE CONTENTS



A - Catch x 1



B - Plate x 1



C - Catch Screw x 4



D - Plate Screw x 1

Installation

1 DETERMINING THE INSTALLATION LOCATION

- You can attach the catch (A) on the top, bottom, or side of the cabinet.

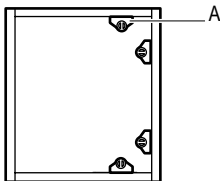

2 INSTALLING THE CATCH

- Use the catch screws (C) to attach the catch (A) to your chosen installation location.

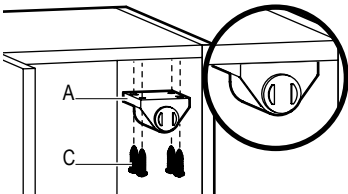

3 INSTALLING THE PLATE

- Attach the plate (B) to the cabinet door using the plate screw (D). Ensure that the plate (B) is aligned with the catch (A) when you close the cabinet door.

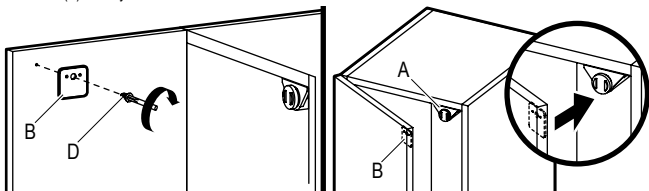

Warranty

Subject to the terms of this warranty, the Manufacturer warrants to the original consumer purchaser that the product will be free from defects in material and workmanship. If the product does not comply with this warranty, the Manufacturer will repair or replace the product or, at the Manufacturer's option, refund the purchase price. Repair, replacement, or refund of the original purchase price is your sole remedy under this or any other warranty on the product, whether expressed or implied. For additional details and questions, please contact Everbilt Customer Service at 1-800-305-1726.