

No. 2003BP

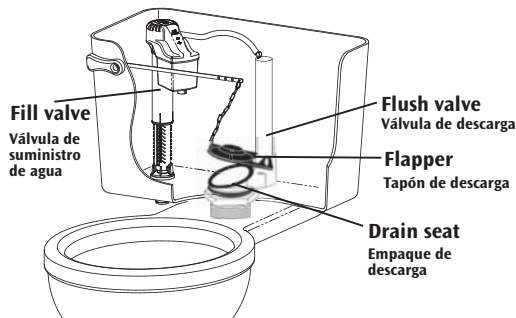

Instructions:

Instrucciones:

①



OFF
APAGADO

②

Drain seat
Empaque de descarga

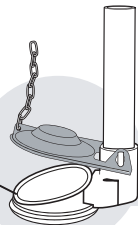

Drain water from tank. Remove old flapper. Clean drain seat with steel wool or sandpaper. Wipe and dry surface.

Drene el agua del tanque. Retire el tapón de descarga viejo. Limpie el empaque de descarga con lana de acero o papel de lija. Limpie y seque la superficie.

③

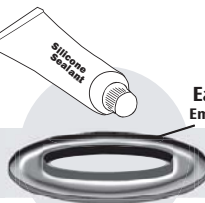

EasyFix seat
Empaque EasyFix

Squeeze silicone evenly around bottom of EasyFix seat. Use approximately 3/4 of tube.

Aplique silicón presionando uniformemente alrededor de la parte inferior del empaque EasyFix. Use aproximadamente 3/4 del tubo.

④

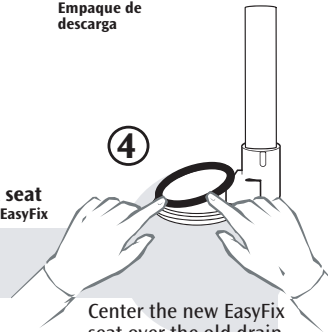

Center the new EasyFix seat over the old drain seat. Press firmly into place. Avoid getting sealant on top of EasyFix seat.

Centre el nuevo empaque EasyFix sobre el empaque viejo. Presione firmemente en posición. Evite derramar sellador encima del empaque EasyFix.

⑤



Wait 15 minutes.
Espere 15 minutos.

⑥

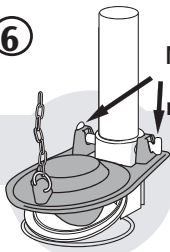

Mounting arms
Los brazos de montaje

⑦

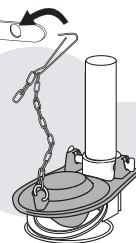

⑧



ON
Encendido

UPC:

049057101780