

NEED HELP?

call us:

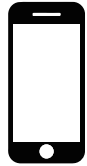

435-752-6611

email us:



cs@heatstorm.com

HEAT STORM® User Manual

and safety instructions

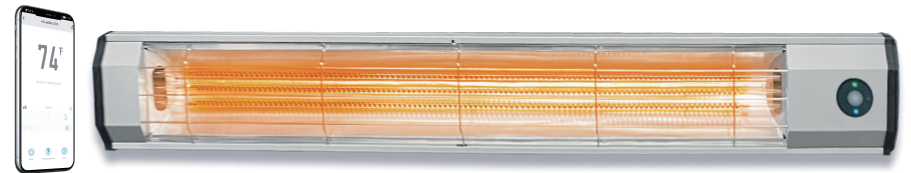

HEAVY DUTY

Infrared Heater

6000 WATT | 240 V | HS-6000-OTR | INDOOR-OUTDOOR

Visit us at:







heatstorm.com

for more product information

SAVE THIS INSTRUCTION MANUAL

Read all instructions before installing or using this heater.

TABLE OF CONTENTS:

	Introduction.....	1
	Safety Awareness.....	2
	Installation & Instructions.....	3
	Operations & Controls.....	6
	Troubleshooting Guide.....	7
	1 Year Limited Warranty.....	8
	Return Policy.....	9



Introduction

Thank you and congratulations on the purchase of your Heat Storm Smart Heater!

PLEASE READ THIS MANUAL BEFORE OPERATING THIS APPLIANCE.



WARNING:



IF THE DIRECTIONS IN THIS MANUAL ARE NOT FOLLOWED, AN ELECTRIC SHOCK OR FIRE MAY RESULT CAUSING PROPERTY DAMAGE, PERSONAL INJURY OR LOSS OF LIFE.



DO NOT STORE OR USE GASOLINE OR OTHER FLAMMABLE VAPORS AND LIQUIDS IN THE VICINITY OF THIS OR ANY OTHER HEATING APPLIANCE.



ANY REQUIRED SERVICE OTHER THAN FILTER MAINTENANCE SHOULD ONLY BE PERFORMED BY AN AUTHORIZED SERVICE REPRESENTATIVE.



ANY OTHER REPAIRS ATTEMPTED BY ANYONE OTHER THAN AN AUTHORIZED SERVICE REPRESENTATIVE WILL VOID THE WARRANTY.



IMPORTANT INSTRUCTIONS

This heater is hot when in use. To avoid burns, do not let bare skin touch hot surfaces. Keep combustible materials, such as furniture, pillows, bedding, papers, clothes, etc. and curtains at least 3 feet (0.9m) from the front of the heater and keep them away from the sides and rear (sides and rear restrictions apply to location dedicated heaters only).

Extreme caution is necessary when any heater is used by or near children or invalids and whenever the heater is left operating and unattended.

Do not operate any heater if it malfunctions. Disconnect power at service panel and have heater inspected by a reputable electrician before reusing.

To disconnect heater, turn controls to off, and turn off power to heater circuit at main disconnect panel.

Do not insert or allow foreign objects to enter any ventilation or exhaust opening as this may cause an electric shock or fire, or damage the heater.

To prevent a possible fire, do not block heating element.

A heater has hot and arcing or sparking parts inside. Do not use it in areas where gasoline, paint, or flammable vapors or liquids are used or stored.

Use this heater only as described in this manual. Any other use not recommended by the manufacturer may cause fire, electric shock, or injury to persons.

This heater includes a visual indicator to warn that parts of the heater are getting excessively hot. If the indicator illuminates, immediately turn the heater off and inspect for any objects on or adjacent to the heater that may have blocked the airflow or otherwise caused high temperatures to have occurred. **DO NOT OPERATE THE HEATER WHILE THE INDICATOR IS ILLUMINATED.**



WALL INSTALLATION

THE HEATER MUST BE PROPERLY INSTALLED BEFORE IT IS USED.

CAUTION: YOUR HEATER MUST BE INSTALLED ON A WALL. DO NOT PROP THE HEATER UP AGAINST OBJECTS OR USE THE HEATER WITH THE GRILL PLACED VERTICALLY.

1. Remove foam shipping cushions. Otherwise, it will cause a safety hazard.

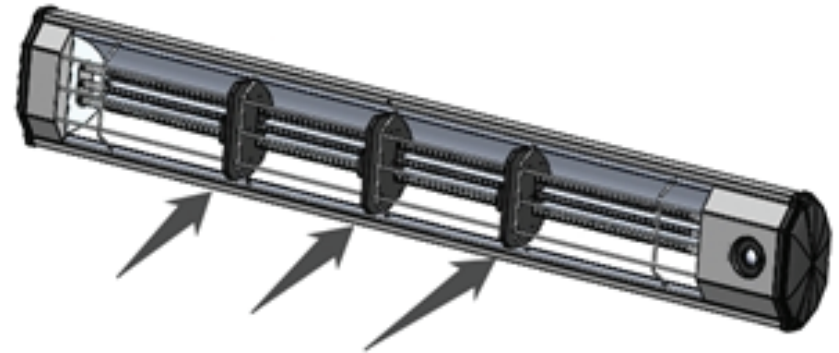

2. Wiring Diagram:

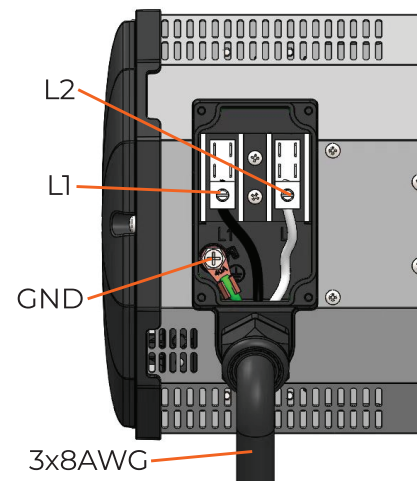

**WARNING:
HIGH VOLTAGE**

****Professional
Electrician
Recommended**

3. Use Template to mark holes and Drill suitable holes into wood studs or masonry.

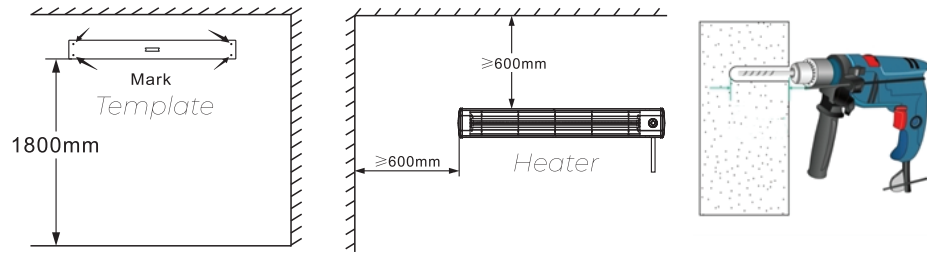

Ensure there is enough distance between heater and combustibles.

4. Connect Brackets to heater, then heater to wall. Use Screws (and anchors if necessary) to securely mount heater to wall.



6. Download Smart Life App and connect app to heater.

Control This Heater With Your Phone!

- Customize Settings
- Remotely Monitor Temperature
- Manual Power Control
- Set Schedules

wifi enabled WORKS WITH amazon alexa WORKS WITH Google Assistant







CONNECTING TO WIFI

Prepare your phone and download the App, following these steps:



1. Connect to your phone to a 2.4 GHz wifi network.

2. Download the Smart Life App and create a free account.

3. While the heater is plugged in and turned on, press and hold the wifi/sun symbol on control screen for 5 seconds. You should hear a beep and see a wifi symbol start blinking in a blue color

4. Enable Wi-Fi and Bluetooth in your phone.

*For some dual band routers, you may need to manually create a network dedicated to 2.4 GHz.

Bluetooth connect

After above steps, the heater will automatically find the wifi and pop up a window, follow steps below to connect

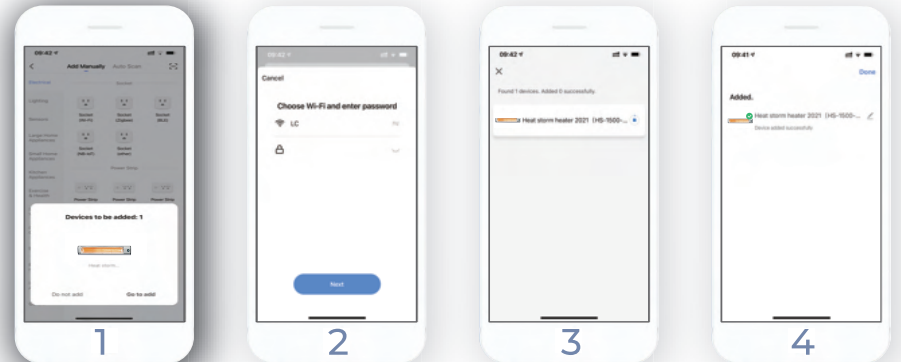

1. If the APP finds a new heater for connecting, it automatically pops up a window, tap "Go to add"

2. Enter in your wifi network name and password. Each of these fields are case sensitive so be sure to double check each one. Then tap "Next"

3. Your phone will start connecting your heater to your wifi network. Hang tight, it may take a few minute.

4. Your screen should look like this: If it shows any error notifications, check out our wifi trouble shooting guide online.

Manual Connect

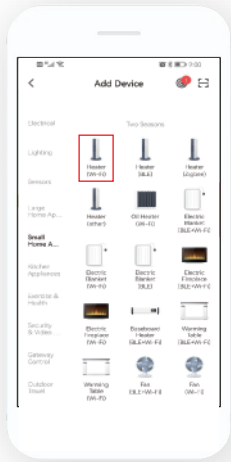

Tap "Add Device" then tap "Small Home Appliance" then tap "Heater"

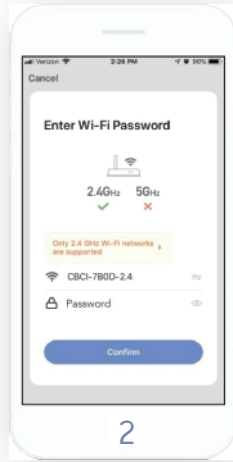

Enter in your wifi network name and password. Each of these fields are case sensitive so be sure to double check each one. Then tap "Confirm"

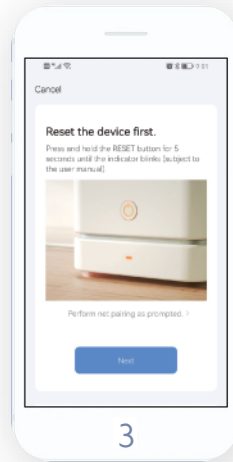

Now you can tap "Confirm Indicator Rapidly Blink" icon in the smart life app on your phone or tablet.

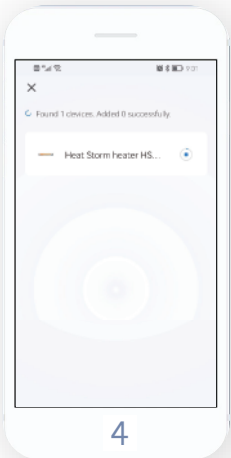

Your phone will start connecting your heater to your wifi network. Hang tight, it may take a few minutes.

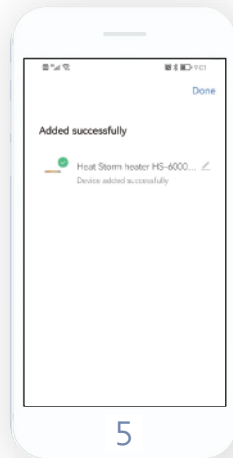

Your screen should look like this: If it shows any error notifications, check out our wifi trouble shooting guide online.



Operations & Controls



Power

Icon	What you do	What heater will do	Function Status
	Single touch	Turn On/Off the heater	Standby
		Single touch to cycle setting power from 1-2-3-Standby	on Status
		Turn to Standby	Overheat protection
	3 second touch	Turn on/Off the ECO Setting	on Status
	5 Sccond long touch	Hold for 5 seconds to enable wifi discovery mode	Standby



Power

Cycle

Eco

Icon	What you do	What heater will do	Function Status
	Single touch	Turn On/Off the heater	Standby/on state
	Single touch	Single touch to cycle setting power	on state
	Single touch	Turn on/Off the ECO Setting	on state
	Touch the figure 1, 2 and 3 in sequence and repeat 2 times within 5 seconds.	To enable wifi discovery mode	Standby /on state within 2 Minutes



1 Year Limited Warranty

MODELS: All models

The manufacturer warrants this product to be free from manufacturing and material defects for a period of one year from date of purchase, subject to the following conditions and limitations.

Install and operate this Electric Heater in accordance with the installation and operating instructions furnished with the product at all times. Any unauthorized repair, alteration, willful abuse, accident, or misuse of the product shall nullify this warranty.

This warranty is non-transferable and is made to the original owner, provided that the purchase was made through an authorized supplier of the product.

The warranty is limited to the repair or replacement of part(s) found to be defective in material or workmanship, provided that such part(s) have been subjected to normal conditions of use and service after said defect is confirmed by the manufacturer's inspection.

The manufacturer may, at its discretion, fully discharge all obligations with respect to this warranty by refunding the wholesale price of the defective part(s).

Any installation, labor, construction, transportation, or other related costs/expenses arising from defective part(s), repair, replacement, or otherwise of same, will not be covered by this warranty, nor shall the manufacturer assume responsibility for same.

The owner/user assumes all other risks, if any, including the risk of any direct, indirect or consequential loss or damage arising out of the use, or inability to use the product, except as provided by law.

This warranty gives you specific legal rights, and you may also have other rights which vary from state to state. This warranty is void if:

- a) The heater is subjected to prolonged periods of dampness or condensation.
- b) Any unauthorized alteration, willful abuse, accident, or misuse of the product.
- c) You do not have the original receipt of purchase.



Return Policy

If you purchased the heater directly from EnergyWise Solutions, we will refund the total sales amount when merchandise is received: 1) in new condition, 2) packed in its original manufacturer's box and all original packaging material included, 3) original manuals and any accessories that came with the item also included.

Manufacturer Return Policy: If you have purchased a product that needs an Exchange, Refund or Warranty claim the buyer will be responsible for all freight/shipping charges after 30 days of the purchase date.