

Item # 100-4215-364
Model # 82232



USE AND CARE GUIDE

HOPPER GUN

Questions, problems, missing parts?
Before returning to the store, call
Husky Customer Service
8 a.m. - 7 p.m., EST, Monday-Friday
9 a.m. - 6 p.m., EST, Saturday

1-888-HD-HUSKY

HUSKYTOOLS.COM

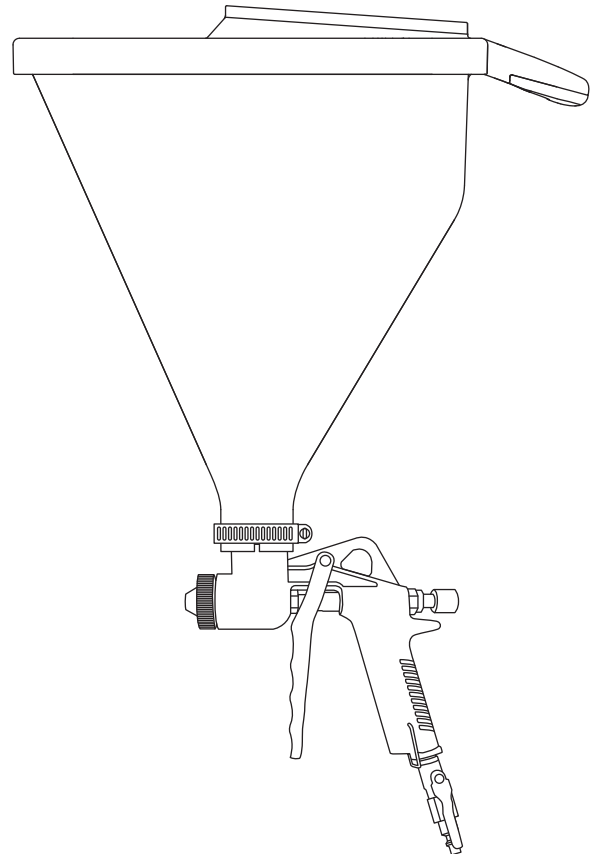

THANK YOU

We appreciate the trust and confidence you have placed in Husky through the purchase of this hopper gun. We strive to continually create quality products designed to enhance your home. Visit us online to see our full line of products available for your home improvement needs. Thank you for choosing Husky!

Table of Contents

Table of Contents.....	2	Tools required.....	3
Safety Information.....	2	Operation.....	4
Warranty.....	2	Pre-Assembly.....	4
What is Covered.....	2	Assembly.....	5
What is Not Covered.....	2	Operation.....	6
Pre-Operation.....	2	Maintenance and Cleaning.....	7
Planning Operation.....	3	Troubleshooting.....	7

Safety Information

SAVE THIS MANUAL

Keep this manual for the safety warnings and precautions, assembly, operating, inspection, maintenance and cleaning procedures. Write the product's serial number in the back of the manual near the assembly diagram (or month and year of purchase if product has no number). Keep this manual and the receipt in a safe and dry place for future reference.

Warranty

LIMITED WARRANTY

WHAT IS COVERED

Husky tools warrant that its products are free from defects in materials and workmanship under normal conditions of use and service.

WHAT IS NOT COVERED

The exclusive remedy for a breach of the foregoing warranty is for the replacement or repair (at the option of Husky Tools) of any defective product. No goods shall be returned to Husky tools for repair or replacement pursuant to this warrant without prior written approval. Husky Tools shall not be responsible for damage to the goods that might occur in transit to or from Husky tools, whether or not the return is authorized. In the event that Husky Tools is unwilling or unable to repair or replace any defective product, the original purchaser shall be entitled to a return of the purchase price paid for such product, as its sole and exclusive remedy.

WARRANTIES SET FORTH HEREIN ARE IN LIEU OF ANY AND ALL OTHER WARRANTIES, EXPRESS OR IMPLIED, INCLUDING THE WARRANTIES OF MERCHANTABILITY AND FITNESS. IN NO EVENT SHALL HUSKY TOOLS BE LIABLE FOR LOSS OF PROFIT OR INCIDENTAL, CONSEQUENTIAL, OR SPECIAL DAMAGES OF ANY KIND IN CONNECTION WITH THE MANUFACTURE, SALE, DELIVERY, OR USE OF ANY PRODUCT.

Contact the Customer Service Team at 1-888-43-HUSKY or visit HUSKYTOOLS.COM.

Pre-Operation

PLANNING OPERATION

Read the ENTIRE IMPORTANT SAFETY INFORMATION section at the beginning of this manual, including all text under subheadings therein before set up or use of this product. Inspect this Hopper Gun before use, looking for damaged, loose, and missing parts. If any problems are found, do not use tool until repaired.

TOOLS REQUIRED



Safety goggles

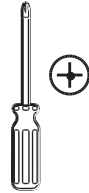

Phillips screwdriver

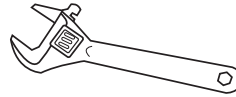

Wrench

Pre-Assembly

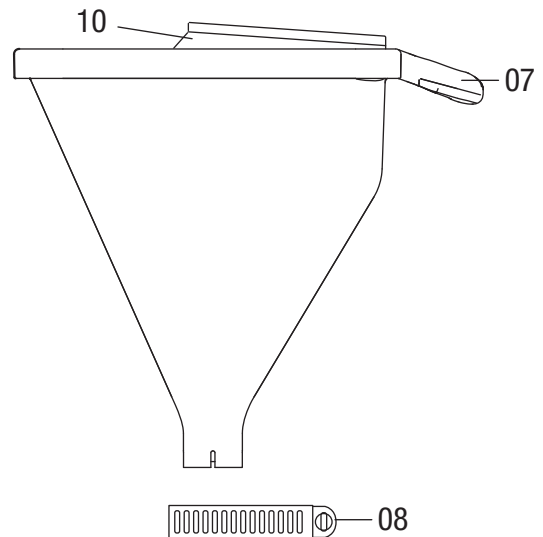
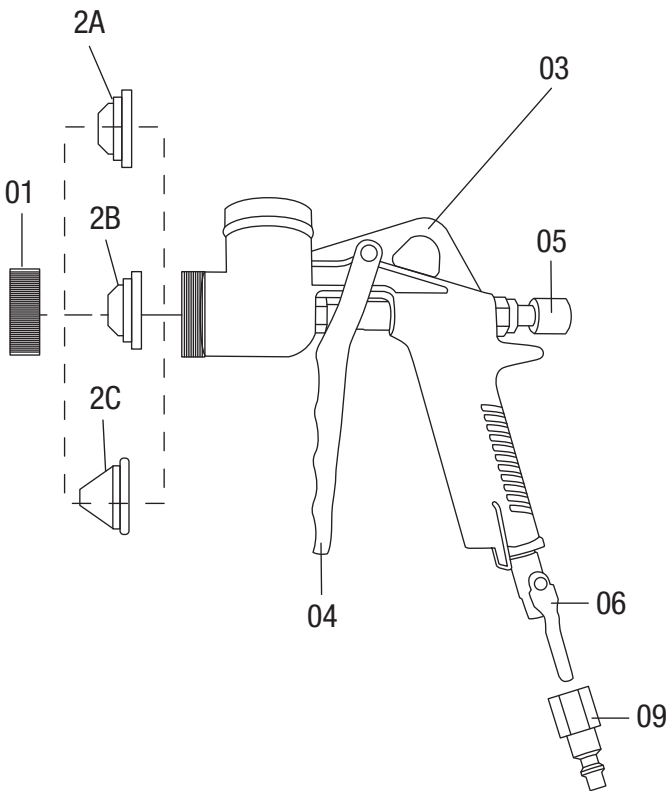

Part	Description	Quantity
01	Retaining Ring	1
2A	4.0 mm (3/16") Nozzle	1
2B	6.0 mm (1/4") Nozzle	1
2C	8.0 mm (5/16") Nozzle	1
03	Gun Body	1
04	Gun Trigger	1
05	Gun Needle	1
06	Air Valve	1
07	Plastic Hopper	1
08	Hopper Clip	1
09	Quick-Connect Adapter	1
10	Hopper Cover	1

Assembly

1 Assembling The Air Hopper And Gun

- Assemble the air hopper and gun by aligning the notched opening in the base of the hopper to the raised notch of the gun body.
- Push the hopper down over the hopper port as far as it will go and securely tighten the hopper clamp. Ensure O-ring of gun be fully covered by O-ring of hopper, so that connection is in place.

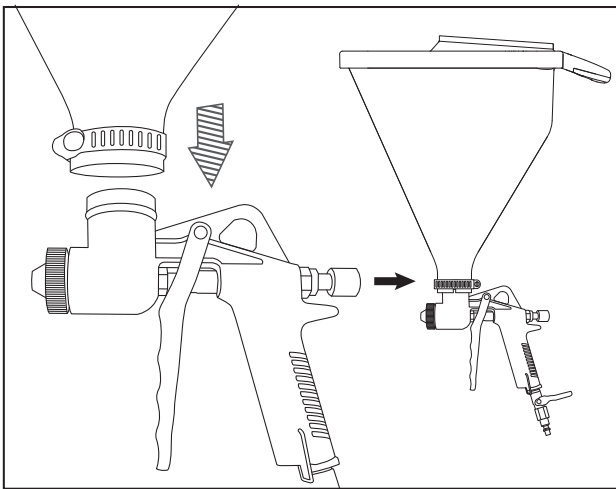

2 Attaching the spray nozzle

- Choose the properly sized nozzle (A, B or C) and install it to the hopper gun.
- Tighten the retaining ring securely.

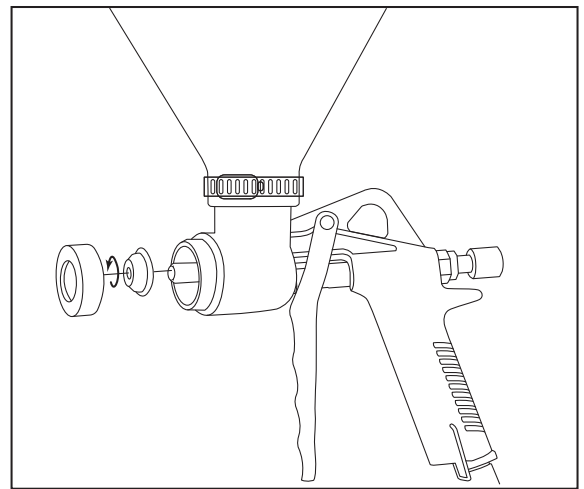

3 Connecting the air source

- Connect the air source and set the air regulator between 25 and 90 PSI.

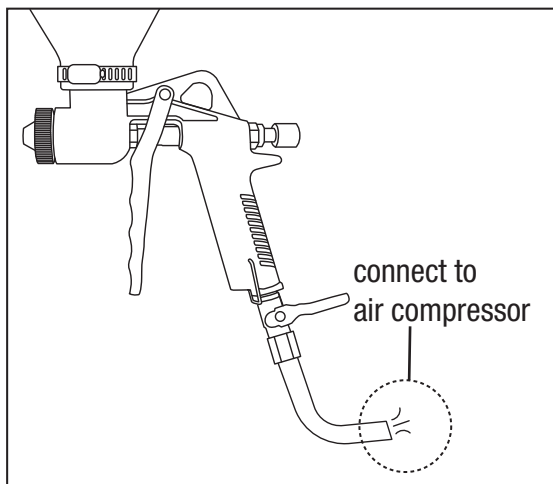

4 Filling the hopper

- Slowly fill the hopper with texture mix. Do not exceed 90% of the hopper capacity.
- Put on the hopper lid. Lid opening should be toward the handle.

 **Note:** It may take a few times to mix the proper spray solution. Do not fill the hopper until you have achieved the viscosity you need for each job.

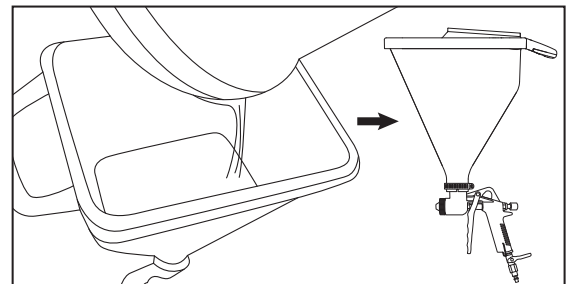

Assembly

5 Spraying

- Start with air valve and gun needle completely open. If needed, slowly close the gun air flow by screwing the needle inward until you get a good spray pattern.
- Using two hands, one to steady the hopper and the other to operate the spray gun, aim the spray gun nozzle at the surface to be covered.
- Squeeze the gun trigger and move the spray gun back and forth, releasing the gun trigger at the end of each sweep.

 **Tips:** If you want to take a break, turn off the air valve. Once restart the paint, mix the texture mix in your hopper sufficiently in case of it getting stucked.

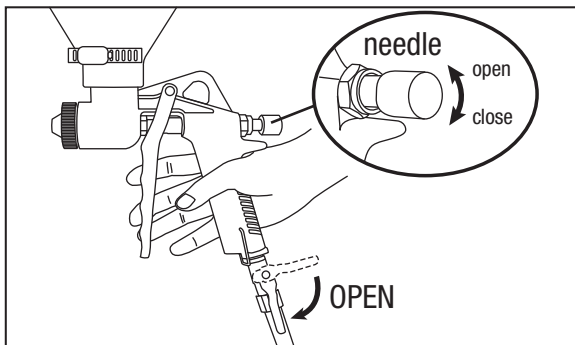

6 Adjusting

- Adjusting air compressor to adjust air pressure. If you want to stop air flow, close your air compressor.
- Adjust the needle properly to achieve a uniform, round spray pattern.
- It may be necessary to change spray nozzles to achieve the desired spray pattern.

 **Note:** If the trigger cannot be pressed, check to see if the needle is screwed inward to its minimum.

Maintenance and Cleaning

Daily Air Supply Maintenance:

Every day, perform maintenance on the air supply according to the component manufacturers' instructions.

Performing routine maintenance on the air supply will allow the tool to operate more safely and will also reduce wear on the tool.

 **Note:** Clean the spray gun immediately after use.

- When you have finished spraying shut off the compressor and disconnect the air line from the gun. Drain remaining material into a bucket until most of the texture material is out of the hopper.
- Fill the hopper with clean water. Remove the nozzle from the gun and allow water to flow through and out of the gun.
- Flush until the gun is clean.
- Remove the hopper from the gun and finish cleaning all components. A soft brush may be used to help loosen any dried on material from the surface.
- Connect the air line to the gun. Turn on the compressor. Open the gun air valve, forcing air through the tip to clear out any remaining material.
- Disconnect the compressor.

Troubleshooting

TROUBLESHOOTING

Problem	Possible Causes	Likely Solutions
Output is decreased.	<ol style="list-style-type: none"> 1. There is not enough air pressure or air flow. 2. Trigger is obstructed . 3. Air inlet screen is blocked (if equipped). 4. Air is leaking from loose attachment. 5. Mechanism is contaminated. 	<ol style="list-style-type: none"> 1. Check for loose connections and make sure that air supply is providing enough air flow (CFM) at required pressure (PSI) to the tool's air inlet. Do not exceed maximum air pressure. 2. Clean around trigger to ensure free movement. 3. Clean air inlet screen of buildup. 4. Make sure attachments are properly assembled to the housing and are tight. 5. Have qualified technician clean and lubricate mechanism. Install inline filter in air supply as stated in Initial Set Up: Air Supply.
Air leakage is severe. (Slight air leakage is normal, especially on older tools.)	<ol style="list-style-type: none"> 1. Housing components are cross-threaded. 2. Housing is loose. 3. Valve or housing is damaged. 4. Valve is worn or damaged. 5. Misleading sound from hopper 	<ol style="list-style-type: none"> 1. Check for incorrect alignment and uneven gaps. If cross-threaded, disassemble and replace damaged parts before use. 2. Tighten housing assembly. If housing cannot be tightened properly, internal parts may be misaligned. 3. Replace damaged components. 4. Clean or replace valve assembly. 5. When spraying finished, there is sound similar to "air leakage" from the hopper. Turn off the air compressor, the sound will disappear.
Product is not spraying correctly.	<ol style="list-style-type: none"> 1. Material is too thick/thin. 2. Nozzle is too large/small. 	<ol style="list-style-type: none"> 1. Check material being sprayed for proper viscosity. Ordinarily, textured products should be the consistency of heavy cream. Wall texturing products are usually a bit heavier than deck protecting products. 2. If product is spraying too heavily, try using a smaller Nozzle. Too light, change to a larger Nozzle.