

for the barn pull handle, firstly, check the door hole center. then the screw put into the copper bush (mark 1 in the picture), then screw into the door lock tightly. Secondly, put the handle into the copper bush which on the door, thirdly, use Allen to lock hexagon screw (mark 2 in picture) to the door then lock well to the copper bush, finished, thanks . the right one the same meaning.

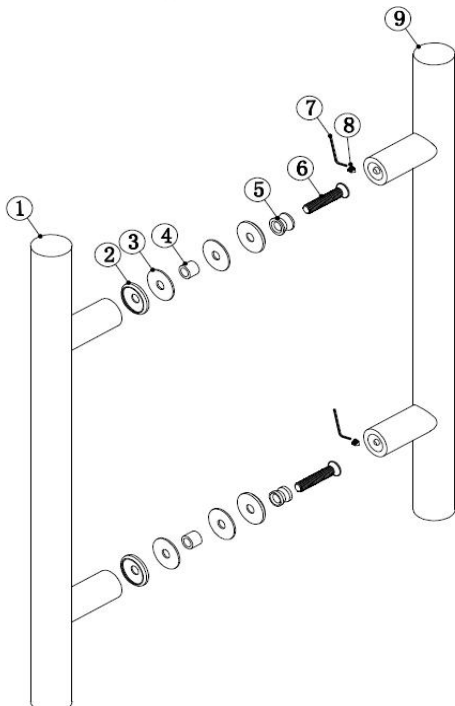

for the round washer handle. firstly, check the glass door hole center as well. then mark 2 (SUS washer) and mark 3 (round plastic washer) put into the left door side to protect the glass. the mark 4 put into the glass hole. the same meaning, the right same accessories put on the door right side. secondly, the screw (mark 6) into the mark 5 and all other accessories through the door to left side to pull handle, screw lock tightly. thirdly, the right side pull handle into the screw and copper bush. locked well by hexagon screw (mark 8), finished, thanks

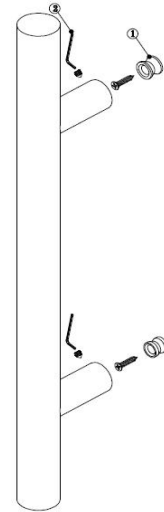
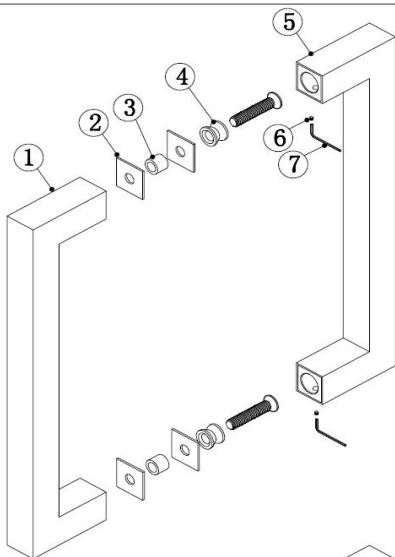

for the square washer handle. firstly, check the glass door hole center as well. then mark 2 (square plastic washer) put into the left door side to protect the glass. the mark 3 put into the glass hole. the same meaning, the right same accessories put on the door right side. secondly, the screw into the mark 4 (copper bush) and all other accessories through the door to left side to pull handle, screw lock tightly. thirdly, the right side pull handle into the screw and copper bush. locked well by hexagon screw (mark 6), finished, thanks