

PROGRAMMING HANDHELD REMOTE CONTROL*

Look in the box for:

Single Button Remote
BU100

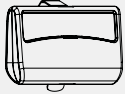

Three Button Remote
BU400 & BU800

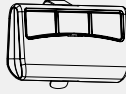

⚠ WARNING



To prevent **SERIOUS INJURY** or **DEATH**:

- Keep remote control and battery out of reach of children.
- NEVER permit children to access door control or remote control.
- Operate the door **ONLY** when it is properly adjusted, and there are no obstructions present.
- ALWAYS keep a moving door in sight until completely closed. NEVER cross the path of a moving door.

To reduce risk of fire, explosion or electric shock:

- DO NOT short circuit, recharge, disassemble or heat the battery.
- Replace with a CR2032 3 volt battery **ONLY**.

1. Press and release the "Learn" button.
2. The "OK" LED will illuminate indicating ready for programming.

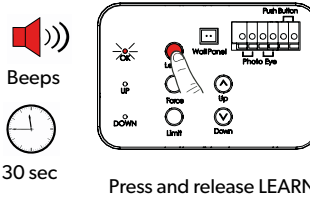

3. Press desired button on remote control within 30 seconds to program.

Additional buttons on remote can be used to program multiple beamUP garage door openers

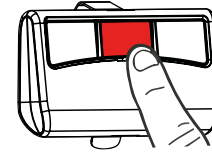

The "OK" LED flashes twice followed by two beeps to confirm remote has been programmed.

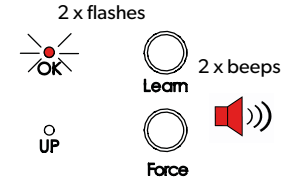

Erasing ALL remote controls from memory:

To erase ALL remote controls from memory, press and hold "Learn" button for 3 seconds. "OK" LED will flash and beep three times indicating all remotes have been erased from memory.

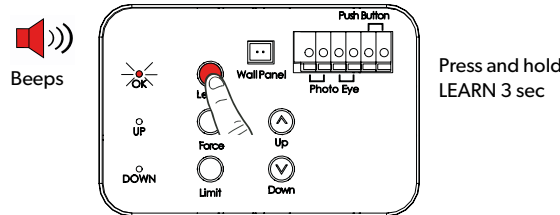

When battery of hand held remote control is low, indicator LED will become dim and/or range of remote control will decrease. To replace battery, remove battery cover from remote control. Replace with a CR2032 3 volt battery.

