

# INSTALLATION INSTRUCTIONS

## SIT Piezoelectric Igniter Replacement Kit

**Read these instructions thoroughly and understand all steps and procedures before proceeding with the installation.**

**! WARNING:** The piezoelectric igniter should be replaced by a qualified service technician. The appliance and the gas valve may be hot: wait until the temperature has dropped before touching the appliance or the gas valve.

**WHAT TO DO IF YOU SMELL GAS:**

- Do not try to light any appliance.
- Do not touch any electric switch; do not use any phone in your building.
- Immediately call your gas supplier from a neighbor's phone. Follow the gas supplier's instructions.
- If you cannot reach your gas supplier, call the fire department.

**TO TURN OFF GAS TO THE APPLIANCE:**

- 1) Turn the control knob clockwise to the OFF position.

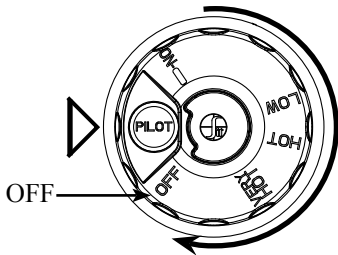

- 2) Turn off gas supply at the appliance valve.
- 3) Remove the female cable connector from the male igniter connection.

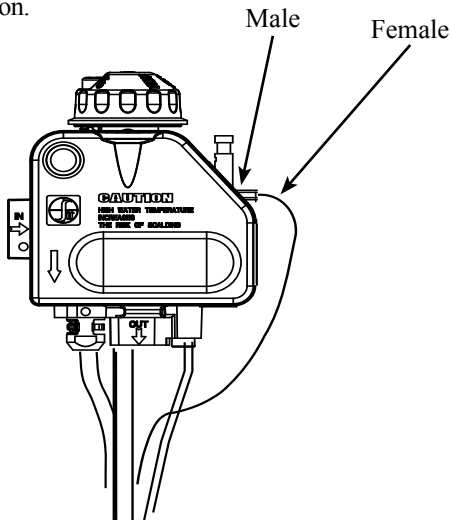

- 4) Remove the old igniter from the gas valve making lever with the a flat screwdriver of appropriate size, as shown in Figure 1 & 2. Discard the old igniter.
- 5) Position the new igniter into the seat of the gas valve, as shown in Figure 3. Apply by hand a maximum force of 44 lbf (20Kgf) on the button of the igniter. The applied force makes operating the igniter which will generate one click and one spark in air. Continuing to apply the force, a second click is made. The second click confirms full insertion and the mechanical locking of the body of the new igniter into its seat, as shown in Figure 4. Once inserted, do not remove the igniter.

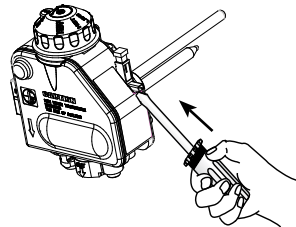

Figure 1

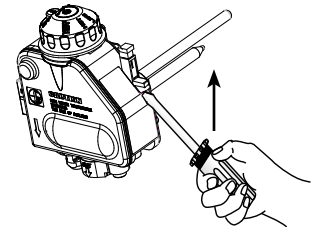

Figure 2

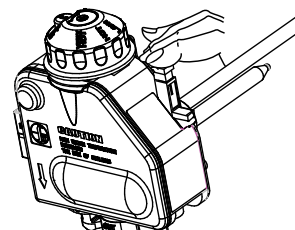

Figure 3

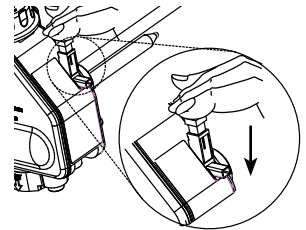

Figure 4

- 6) Reconnect the female connector to the male connector on the new igniter.
- 7) Refer to lighting instructions to relight pilot and turn unit on.

