

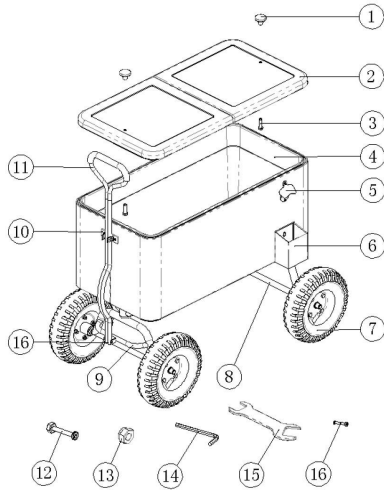

## ASSEMBLY INSTRUCTIONS:



Item	Description	Qty
1	Lid Handle	2
2	Lid	1
3	M5*35 Bolts	2
4	Body	1
5	Bottle Opener	1
6	Cap-Catcher	1
7	Wheels	4
8	Front Frame	1
9	Rear Frame	1
10	Handle card buckle	1
11	Handle	1
12	M6*16 bolts	18
13	M16 Nut	4
14	M6 Wrench	1
15	M16 Wrench	1
16	M6*40 bolts	1

1. Please make sure all parts are accounted for before beginning assembly.
2. Please put the body (part 4) upside down, connect the frame (part 8 & 9) to the body by 12pcs M6\*16 bolts (part 12), and tighten with M6 wrench (part 14). Then put the wheels (part 7) on the frame and use the M16 nut (part 13), tighten with the M16 wrench (part 15).
3. Turn over entire assembly right side-up, connect the handle card buckle (part 10) to the body with 2pcs M6\*16 bolts. And connect the handle (part 11) to the rear frame (part 9) with M6\*40 bolts, then the whole handle could be put into the card buckle.
4. Using M6\*16 bolts, connect both bottle opener (part 5) and cap-catcher (part 6) to the body.
5. The lid handle (part 1) was pre-install on the lid, just take the pre-installed M5\*35 bolts upside down and connect the lid handle.
6. Clean inside of cooler completely with soft dry towel. Place cooler lid (part 2) on top of main basin (part 4) and now your cooler is ready for use.