

BEAST Chipper Shredder Spare Parts Diagram (CH6/CH8/CH10/CH11)

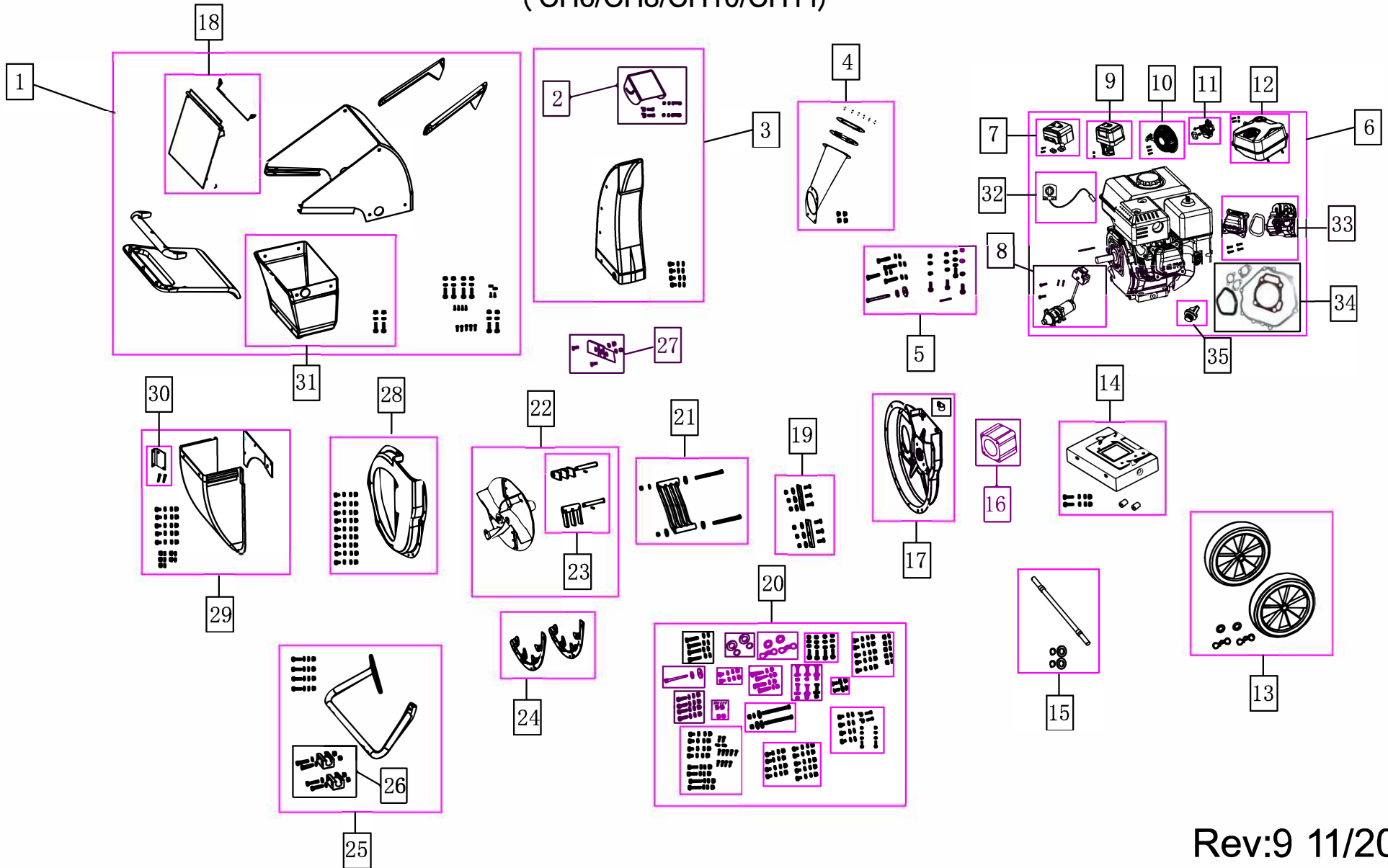

BEAST Chipper Shredder Spare Parts Key

Item #	Part Number	Description	CH6	CH8	CH10	CH11
1	LCSSP13-005	Plastic Leaf Funnel Assembly Kit (includes upper section, middle funnel, and entry shield with label for BEAST) - 2013 Upgrade	●	●	●	●
2	LCSSP11-002	Discharge Deflector with hardware and label	●	●	●	●
3	LCSSP11-028	Plastic Discharge Chute with discharge deflector, hardware, and label for BEAST	●	●	●	●
4	LCSSP11-022	Limb Chute (GREY) - 2.25" capacity with hardware and BEAST label	●			
	LCSSP11-023	Limb Chute (GREY) - 3" capacity with hardware and BEAST label		●		
	LCSSP16-065	Limb Chute (GREY) - 3.75" x 5.25" capacity with hardware and BEAST label			●	●
5	LCSSP11-004	Hardware Kit (includes engine fasteners, center blade bolt, and engine shaft key)	●	●	●	
	LCSSP16-004	Hardware Kit (includes engine fasteners, center blade bolt, and engine shaft key)				●
6	E12013	Engine Assembly with Recoil Starter (BLACK) - 212cc - labels for BEAST included	●			
	E10113	Engine Assembly with Recoil Starter (BLACK) - 270cc - labels for BEAST included		●		
	E14517	Engine Assembly with Electric Starter (BLACK) - 445cc - labels for BEAST included				●
	E14416	Engine Assembly with Recoil Starter (BLACK) - 457cc - labels for BEAST included - NO ELECTRIC START, EPA			●	
	E14516	Engine Assembly with Electric Starter (BLACK) - 457cc - labels for BEAST included				●
7	LCSSP12-047	Muffler Assembly - 208cc and 212cc - Chippers: CH2, CH6 The muffler assembly includes the muffler, muffler cover, a bracket, bolts, and gaskets.	●			
	LCSSP12-048	Muffler Assembly - 270cc - Chippers: CH7, CH8 The muffler assembly includes the muffler, muffler cover, a bracket, bolts, and gaskets.		●		
	LCSSP17-075	Muffler Assembly - 445cc - Chippers: CH10, CH11 The muffler assembly includes the muffler, muffler cover, a bracket, bolts, and gaskets.			●	●
	LCSSP16-075	Muffler Assembly - 457cc - Chippers: CH10, CH11 The muffler assembly includes the muffler, muffler cover, a bracket, bolts, and gaskets.			●	●
8	LCSSP16-076	Electric Starter - 457cc engine				●
9	LCSSP12-049	Air Filter Assembly - 208cc and 212cc (includes filter cover, filter media, housing, and bolts) - Chippers: CH2, CH6	●			
	LCSSP12-050	Air Filter Assembly - 270cc (includes filter cover, filter media, housing, and bolts) - Chippers: CH7, CH8		●		
	LCSSP17-077	Air Filter Assembly - 445cc (includes filter cover, filter media, housing, and bolts) - Chippers: CH10, CH11			●	●
	LCSSP16-077	Air Filter Assembly - 457cc (includes filter cover, filter media, housing, and bolts) - Chippers: CH10, CH11			●	●
10	LCSSP13-044	Recoil Assembly - 208cc and 212cc The recoil assembly includes the recoil housing, reel, recoil rope, pull start grip, and label.	●			
	LCSSP12-046	Recoil Assembly - 270cc The recoil assembly includes the recoil housing, reel, recoil rope, pull start grip, and label.		●		
	LCSSP17-078	Recoil Assembly - 445cc The recoil assembly includes the recoil housing, reel, recoil rope, pull start grip, and label.			●	●
	LCSSP16-078	Recoil Assembly - 457cc The recoil assembly includes the recoil housing, reel, recoil rope, pull start grip, and label.			●	●

BEAST Chipper Shredder Spare Parts Key

Item #	Part Number	Description	CH6	CH8	CH10	CH11
11	LCSSP12-053	Carburetor Assembly - 208cc and 212cc - Chippers: CH2, CH6 The carburetor assembly includes the carburetor, choke shaft, heat shield, and gaskets. Simply install the carburetor assembly onto the engine head with two bolts.	●			
	LCSSP12-054	Carburetor Assembly - 270cc - Chippers: CH7, CH8 The carburetor assembly includes the carburetor, choke shaft, heat shield, and gaskets. Simply install the carburetor assembly onto the engine head with two bolts.		●		
	LCSSP17-079	Carburetor Assembly - 445cc - Chippers: CH10, CH11 The carburetor assembly includes the carburetor, choke shaft, heat shield, and gaskets. Simply install the carburetor assembly onto the engine head with two bolts.			●	●
	LCSSP16-079	Carburetor Assembly - 457cc - Chippers: CH10, CH11 The carburetor assembly includes the carburetor, choke shaft, heat shield, and gaskets. Simply install the carburetor assembly onto the engine head with two bolts.			●	●
12	LCSSP12-040	Fuel Tank Assembly - 208cc and 212cc The fuel tank assembly includes the tank, roll-over valve, fuel cap, and label. Ready to be connected to carburetor.	●			
	LCSSP12-042	Fuel Tank Assembly - 270cc The fuel tank assembly includes the tank, roll-over valve, fuel cap, and label. Ready to be connected to carburetor.		●		
	LCSSP17-080	Fuel Tank Assembly - 445cc The fuel tank assembly includes the tank, roll-over valve, fuel cap, and label. Ready to be connected to carburetor.			●	●
	LCSSP16-080	Fuel Tank Assembly - 457cc The fuel tank assembly includes the tank, roll-over valve, fuel cap, and label. Ready to be connected to carburetor.			●	●
13	LCSSP13-020	Chipper Wheels - solid rubber, plastic rim, retaining hardware to axle, 2013 Upgrade	●	●		
	LCSSP16-066	Chipper Wheels - solid rubber, plastic rim, retaining hardware to axle			●	●
14	LCSSP12-029	Chassis with BEAST label and hardware to mount to flail housing - 208 and 212cc engine	●			
	LCSSP12-030	Chassis with BEAST label and hardware to mount to flail housing - 270cc engine		●		
	LCSSP16-067	Chassis with BEAST label and hardware to mount to flail housing - 445cc and 457cc engine			●	●
15	LCSSP11-019	Chipper Axle with Retaining Hardware	●	●		
	LCSSP16-068	Chipper Axle with Retaining Hardware			●	●
16	LCS13-039	Adapter, engine to flail housing, nylon - 208cc and 212cc	●			
	LCS13-040	Adapter, engine to flail housing, nylon - 270cc		●		
	LCS16-173	Adapter, engine to flail housing, nylon - Chipper: CH10			●	
	LCS16-195	Adapter, engine to flail housing, nylon - Chipper: CH11				●
17	LCS11-043	Flail Housing (GREY), engine side, steel - 208cc and 212cc	●			
	LCS11-089	Flail Housing (GREY), engine side - 270cc		●		
	LCSSP16-069	Flail Housing (GREY), engine side, steel - 445cc and 457cc			●	●
18	LCSSP12-034	Funnel Entry Shield with spring, BEAST label, plastic, white	●	●	●	●
19	LCSSP11-018	Blade with hardware (SET OF 2)	●	●	●	●
20	LCSSP11-016	Hardware Kit (complete assembly minus engine hardware)	●	●	●	●
21	LCSSP11-009	Discharge Screen (BLACK) with hardware, cast steel	●	●	●	●
22	LCSSP11-012	Rotor Assembly with hammers (blades not included)	●	●	●	
	LCSSP16-070	Rotor Assembly with hammers (blades not included, longer shaft)				●
23	LCSSP11-008	Chipper Hammers with pins and retainers (SET OF 2)	●	●	●	●
24	LCSSP11-015	Chipper Stationary Shredder Teeth (BLACK), steel (SET OF 2)	●	●	●	●
25	LCSSP11-027	Chipper Foot Assembly (BLACK) with rubber feet - 270cc	●	●		
	LCSSP16-071	Chipper Foot Assembly (BLACK) with rubber feet - 445cc and 457cc			●	●

BEAST Chipper Shredder Spare Parts Key

Item #	Part Number	Description	CH6	CH8	CH10	CH11
26	LCSSP11-017	Rubber Feet with Hardware	●	●	●	●
27	LCSSP11-010	Leaf Chute Blade with Hardware	●	●	●	●
28	LCSSP11-025	Flail Housing (GREY), leaf chute side	●	●	●	●
29	LCSSP13-026	Leaf Chute Base, steel, BEAST, grey with back plate and hardware with label, 2013	●			
	LCSSP12-032	Leaf Chute Base, steel, BEAST, grey with back plate and hardware with label		●		
	LCSSP16-072	Leaf Chute Base, steel, BEAST, grey with back plate and hardware with label			●	
	LCSSP16-073	Leaf Chute Base, steel, BEAST, grey with back plate and hardware with label				●
30	LCSSP16-074	Support Plate Assembly				●
31	LCSSP20-001	Funnel, middle section, plastic, black textured	●	●	●	●
32	LCSSP18-067	Switch, ON/OFF - 212cc - Chipper: CH6, 2018 Year	●			
	LCSSP18-068	Switch, ON/OFF - 270cc - Chipper: CH8, 2018 Year		●		
	LCSSP18-081	Switch, ON/OFF - 445cc and 457cc - Chippers: CH10, CH11, 2018 Year			●	●
33	LCSSP18-071	Cylinder Head Assembly - 212cc	●			
	LCSSP18-072	Cylinder Head Assembly - 270cc		●		
	LCSSP18-082	Cylinder Head Assembly - 445cc and 457cc			●	●
34	LCSSP18-073	Engine Gaskets Set - 208 and 212cc	●			
	LCSSP18-074	Engine Gaskets Set - 270cc		●		
	LCSSP18-083	Engine Gaskets Set - 445cc and 457cc			●	●
35	E06206	Oil Fill Plug	●			
36	E07206	Oil Fill Plug		●	●	●