

- 5 Operate your convertible sofa by pushing the backrest forward, this will release the sofa to the bed position. Lift the backrest up to transition from bed position to either lounge or sofa position. This sofa has a split back which will allow you to operate either the left or right side independently.

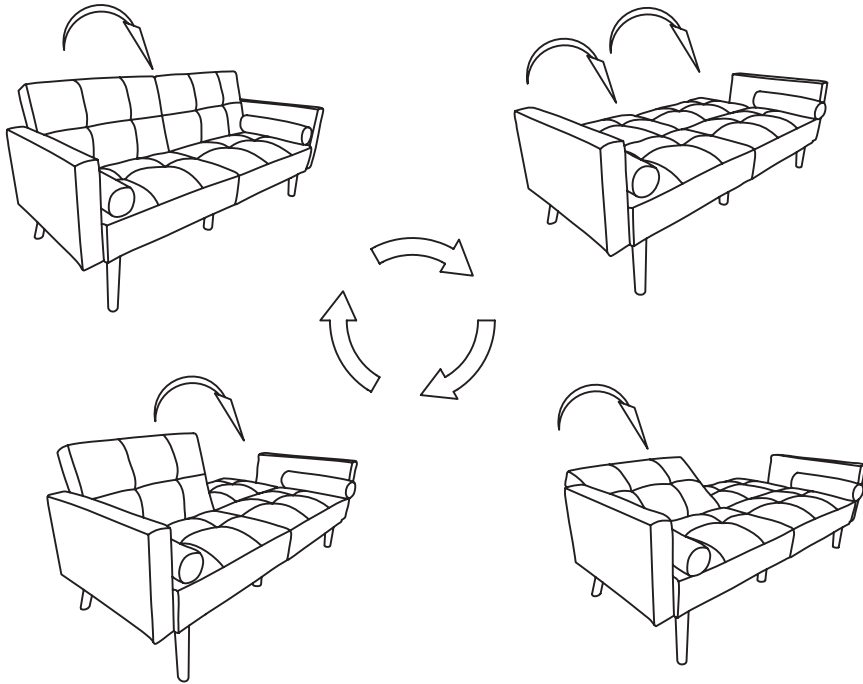

Model: \_\_\_\_\_  
Lot No: \_\_\_\_\_  
Date of Purchase: \_\_\_\_\_

## MONTREAL CONVERTIBLE SOFA

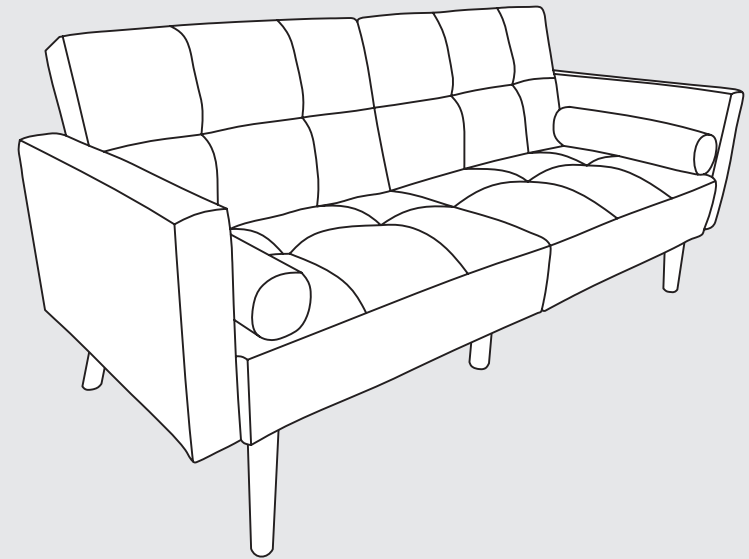

### ADULT ASSEMBLY REQUIRED

If you are missing any parts or have any questions regarding assembly, do not return this item to the retailers store. Please call our toll-free, customer service number and have this assembly manual open to the parts list ready to provide the model name, number and part name or number.

Customer Service

**1-877-864-5752**

8:30 AM PST - 4:00 PM PST (Monday-Friday)

Website: [www.dwellhom.com](http://www.dwellhom.com)

Missing Parts: [parts@dwellhom.com](mailto:parts@dwellhom.com)

Warranty Information: [www.dwellhom.com/warranty](http://www.dwellhom.com/warranty)



**WARNING:** This product may contain small components, please ensure they are kept away from small children.



### FINGER GUARD

- U.S. Patent No. 8,875,321
- Provides Users a Permanent Safety Solution
- Eliminates the Risk & Liability of an Accident
- Heavy Duty, Fully Welded, Protective Metal Plate

## PARTS

Avoid using sharp objects such as a knife to cut open packing as you may accidentally damage the upholstery.

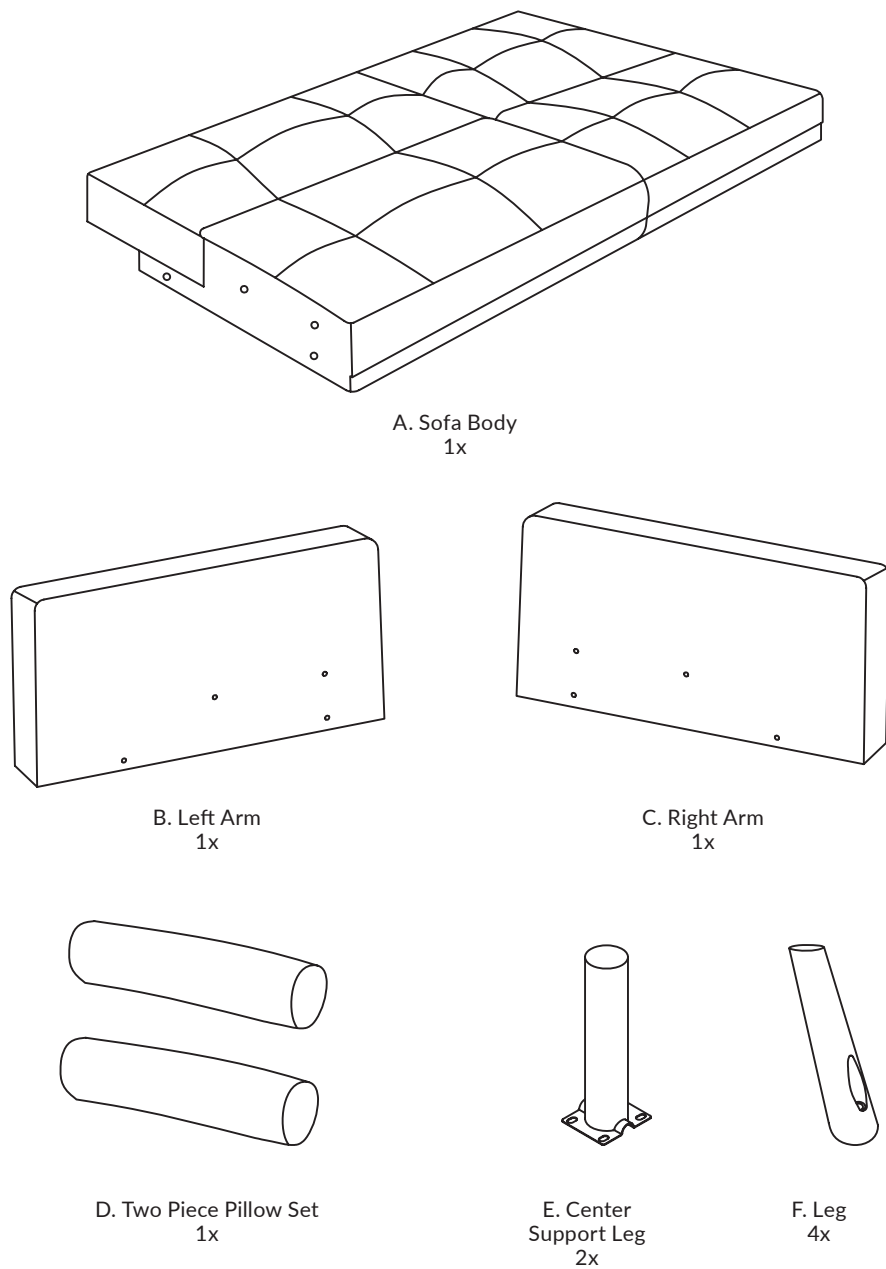

- 4** Attach Leg (F) to Sofa Body (A) using Bolt (2) and Washer (4). Tighten using provided Allen Key (5).

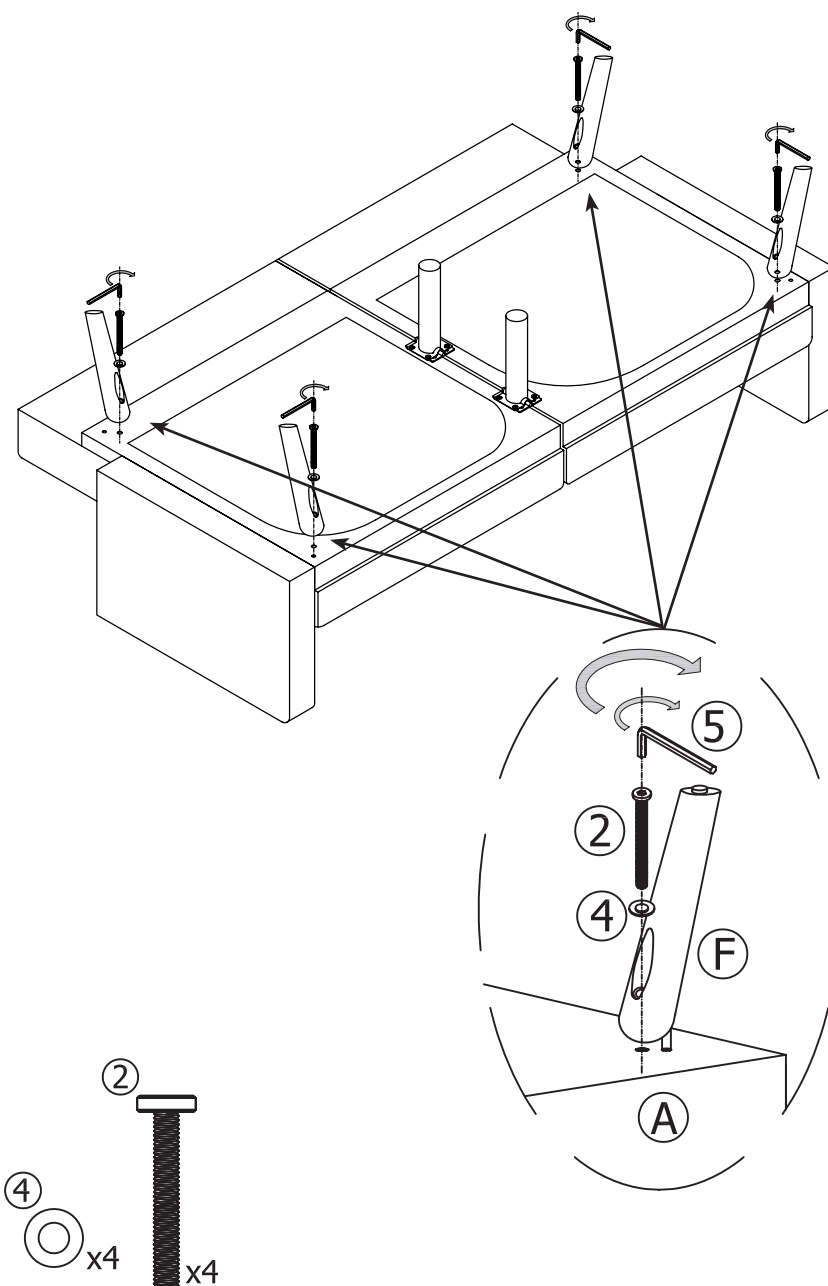

**3** 3.1: Insert Threaded Stud (1) to Left Arm (B) and Right Arm (C), then hand tighten.

3.2: Attach Left Arm (B) and Right Arm (C) to Sofa Body (A) making sure the pre-threaded studs are visible on the inside cavity Washer (4) and Nut (7). Tighten using provided Wrench (8).

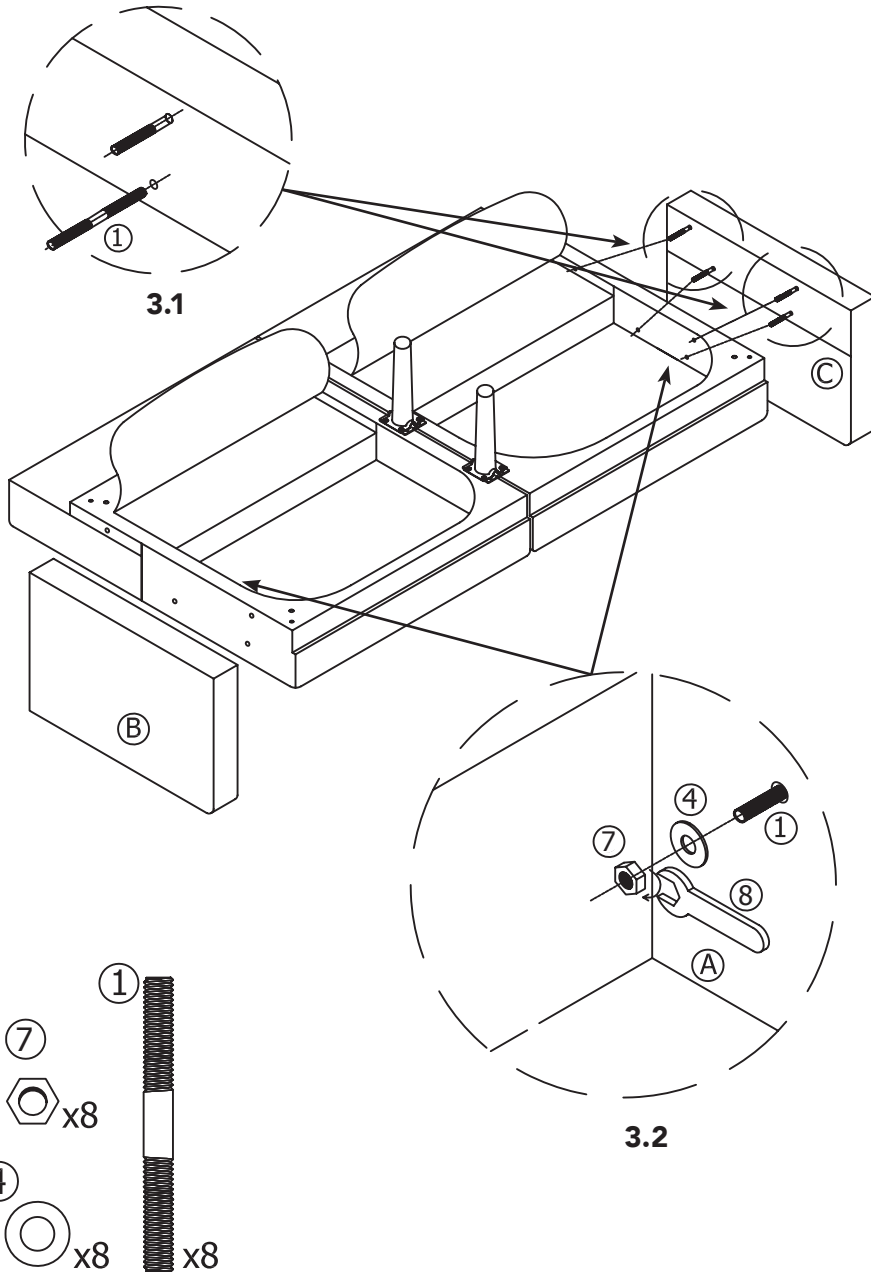

## HARDWARE

Avoid using sharp objects such as a knife to cut open packing as you may accidentally damage the upholstery.



1. Threaded stud 5/16" x 4" 8x

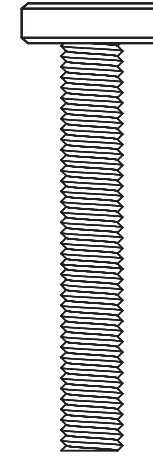

2. bolt 5/16" x 2 3/4" 4x

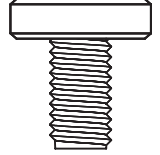

3. bolt 1/4" x 1/4" 8x

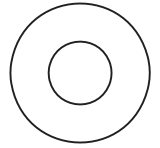

4. Washer 12x



7. Nut 8x

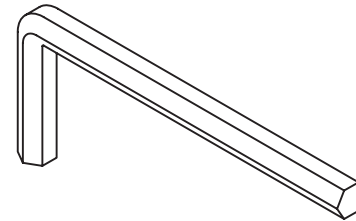

5. 5 mm Allen Key 1x

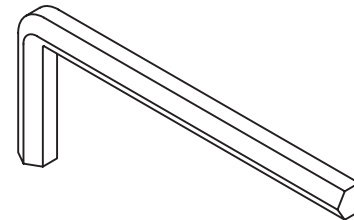

6. 4 mm allen key 1x

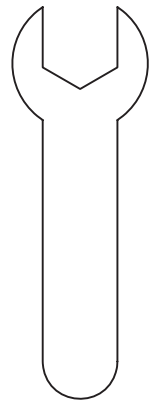

8. Wrench 1x

## ASSEMBLY INSTRUCTIONS

Do not fully tighten bolts until assembly is complete.

- 1** Flip Sofa Body (A) over.  
Pull out Hardware and Parts from the zippered compartment.

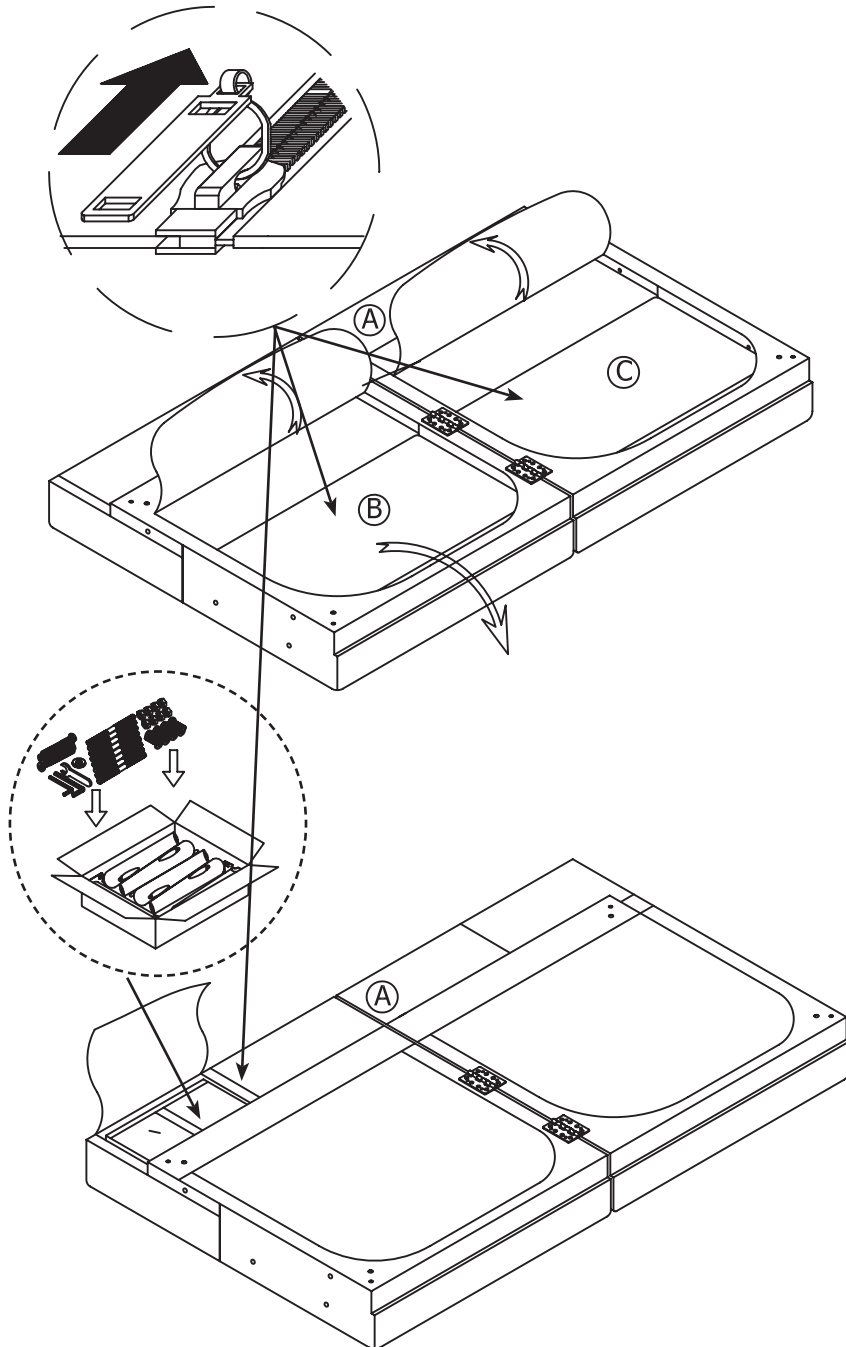

- 2** Attach Center Support Leg (E) to Sofa Body (A) using Bolt (3).  
Tighten using provided Allen Key (6).

