

# Reassembly

## To Reassemble:

1. Install the nozzle seal\* (1) with the groove (a) (slot) facing toward the nozzle (away from the front end assembly).
2. Insert the nozzle (2). Make sure to align the groove (b) and notch (c) and align the nozzle opening with the needle.
3. Put the air screen (d) in the air cap (e). Put both (3) on the nozzle (2) and secure with the connecting nut (4).

**Note:** This step is easier if the spray gun is facing up.

4. Snap the adjustment ring (5) into the connecting nut (4), enabling the adjustment lever (f) on the peg (g) to be positioned in the air cap.

**Note:** Make sure that the two recesses on the adjustment ring are engaged in the air cap tabs.

5. Reassemble the spray gun.

**Note:** Make sure the air valve tube is free of paint. If not, clean the air valve tube by following the instructions on the next page. If clean, make sure it is attached securely at both ends (see inset).

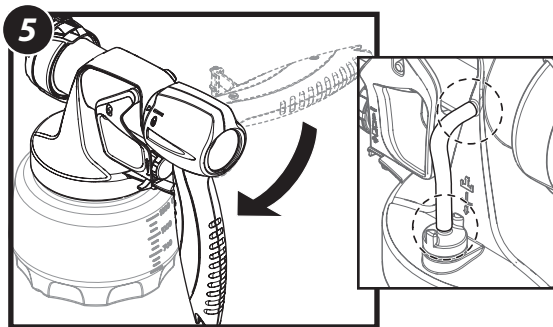
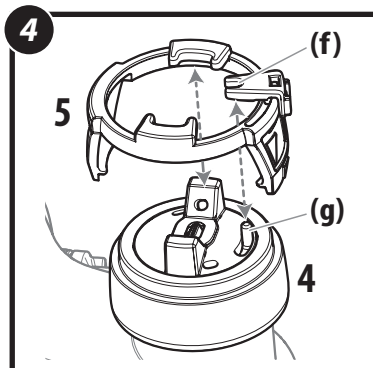
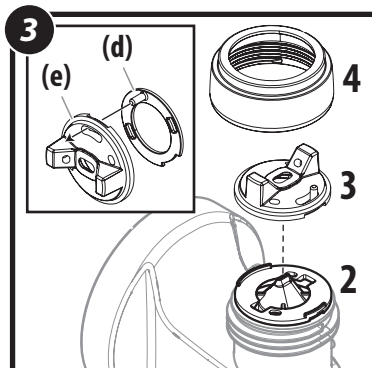
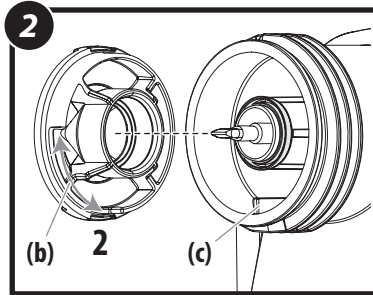
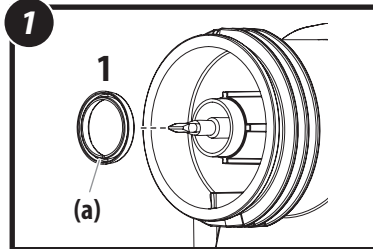

### \* Nozzle seal - DO NOT LOSE

It is important that the nozzle seal inside the nozzle be re-installed properly. Make sure the cup side of the seal (the side with the groove) is facing out towards the front of the nozzle. Improper installation will cause leakage.

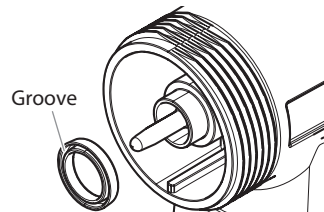

# Maintenance

## Cleaning the Filters:

**IMPORTANT:** Before every use, you should inspect the air filter in the turbine to see if it is excessively dirty. If it is dirty, follow these steps to replace it.

**IMPORTANT:** Never operate your unit without the air filter. Dirt could be sucked in and interfere with the function of the unit.

1. Press the tabs on the side of the turbine to remove the filter cover.
2. Remove the dirty filter from the turbine and replace with a new one. The smooth side of the air filter must be placed toward the turbine. Secure the cover back onto the turbine.

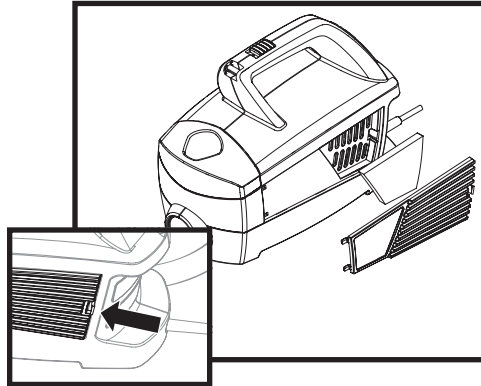

## Cleaning the Air Valve Tube:

**Note:** If paint has entered the air tube, proceed as follows.

1. Pull the air tube (a) at the top from the spray gun. Screw off the valve cover (b). Remove the valve seal (c). Clean all the parts carefully.

**IMPORTANT:** The air tube and valve seal (c) are only solvent-resistant to a limited extent. Do not immerse in solvent, only wipe.

2. Place the valve seal (c) in the valve cover (b) with the pin facing into the tube.

**Note:** Installing the valve seal into the valve cover will be much easier if the valve cover is inverted.

3. Turn the spray gun upside down and screw on the valve cover (with valve seal inside) from underneath.

**Note:** Turning the spray gun upside down will prevent the valve seal from falling out of the valve cover during reinstallation.

4. Place the air tube on the valve cover and on the nipple at the spray gun.

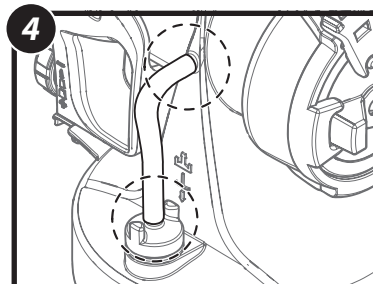
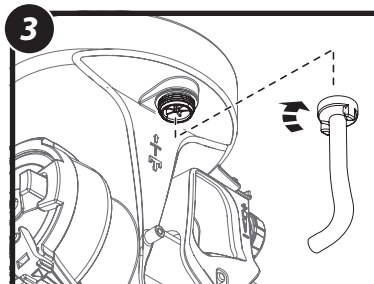
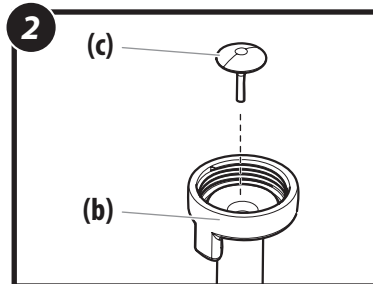
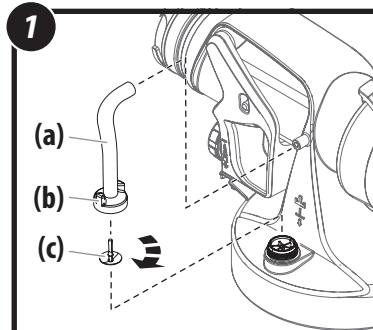

# Troubleshooting

<b>PROBLEM</b>	<b>CAUSE</b>	<b>SOLUTION</b>
<b>Problem A: Little or no material flow</b>	<ol style="list-style-type: none"> <li>1. Nozzle clogged.</li> <li>2. Suction tube clogged.</li> <li>3. Material flow setting too low.</li> <li>4. Suction tube loose.</li> <li>5. Air vent on suction tube blocked.</li> <li>6. No pressure build up in container.</li> <li>7. Air valve tube disconnected.</li> <li>8. Air filter clogged.</li> <li>9. Spray material too thick.</li> </ol>	<ol style="list-style-type: none"> <li>1. Clean.</li> <li>2. Clean.</li> <li>3. Increase material flow setting.</li> <li>4. Remove and replace as tightly as possible.</li> <li>5. Clean (see page 15)</li> <li>6. Tighten container.</li> <li>7. Reconnect both ends of the air tube.</li> <li>8. Change</li> <li>9. Thin*.</li> </ol>
<b>Problem B: Material leaking</b>	<ol style="list-style-type: none"> <li>1. Nozzle loose.</li> <li>2. Nozzle worn.</li> <li>3. Nozzle seal missing or worn.</li> <li>4. Material build-up on air cap and nozzle</li> </ol>	<ol style="list-style-type: none"> <li>1. Tighten.</li> <li>2. Replace.</li> <li>3. Replace (extras provided).</li> <li>4. Clean.</li> </ol>
<b>Problem C: Spray pattern too thick, runs and sags</b>	<ol style="list-style-type: none"> <li>1. Material flow setting too high.</li> <li>2. Air power setting too low.</li> <li>3. Applying too much material.</li> <li>4. Nozzle clogged.</li> <li>5. Air filter clogged.</li> <li>6. Too little pressure build-up in container.</li> <li>7. Spray material too thick.</li> </ol>	<ol style="list-style-type: none"> <li>1. Decrease material flow setting.</li> <li>2. Increase air power setting.</li> <li>3. Adjust material flow or increase movement of spray gun.</li> <li>4. Clean.</li> <li>5. Change.</li> <li>6. Tighten container.</li> <li>7. Thin*.</li> </ol>
<b>Problem D: Spray jet pulsates</b>	<ol style="list-style-type: none"> <li>1. Material in container running out.</li> <li>2. Air filter clogged.</li> <li>3. Air valve tube disconnected.</li> </ol>	<ol style="list-style-type: none"> <li>1. Refill.</li> <li>2. Change.</li> <li>3. Reconnect both ends of the air tube.</li> </ol>
<b>Problem E: Too much overspray</b>	<ol style="list-style-type: none"> <li>1. Gun too far from spray object.</li> <li>2. Air power setting too high.</li> </ol>	<ol style="list-style-type: none"> <li>1. Reduce distance (6"-8" is ideal).</li> <li>2. Decrease air power setting.</li> </ol>
<b>Problem F: Pattern is very light and splotchy</b>	<ol style="list-style-type: none"> <li>1. Moving the spray gun too fast.</li> <li>2. Material flow setting too low.</li> <li>3. Air power setting too high.</li> </ol>	<ol style="list-style-type: none"> <li>1. Adjust material flow or decrease movement of spray gun.</li> <li>2. Increase material flow setting.</li> <li>3. Decrease air power setting.</li> </ol>

**\*Note:** Only thin the material as a last resort to improve spray performance. Optimal spray performance should be achieved simply by adjusting the various controls on the unit.



**This unit contains no servicable electrical parts. Do not attempt to service yourself. Store indoors with the cord wrapped around the turbine handle.**



**Have you tried the recommendations above and are still having problems? In the United States, to speak to a customer service representative, call our Technical Service at 1-800-328-8251. See [www.wagnerspraytech.com](http://www.wagnerspraytech.com) in the "Contact Us" section for Technical Service hours.**